

RECOMMENDED PCB LAYOUT (THICKNESS: 1.6MM)
 DIMENSION TOLERANCE: 1 PLC: ±0.1 2PLC: ±0.05

- NOTE:
- MATERIAL:
 HOUSING: THERMOPLASTIC HIGH TEMP., UL94 V-0, COLOR: BLACK.
 CONTACT: PHOSPHOR BRONZE, H, THICKNESS: 0.35mm.
 SHELL: BRASS, THICKNESS: 0.25mm.
 - FINISH:
 CONTACT: GOLD PLATED (SEE TABLE) IN CONTACT AREA,
 GOLD FLASH ON SOLDER TAILS,
 50µ" MIN. NICKEL UNDERPLATED ALL OVER.
 SHELL: 20µ" MIN. NICKEL PLATED.
 - WAVE SOLDER CAPABLE TO 265°C PER 109-202,
 CONDITION B.

OBSOLETE	W/O	W/O	50µ"	1-1734712-4
			30µ"	1-1734712-3
			15µ"	1-1734712-2
	W/O	0.6mm	6µ"	1-1734712-1
			50µ"	1-1734712-4
			30µ"	1-1734712-3
			15µ"	1-1734712-2
			6µ"	1-1734712-1
	LED	POLARIZATION RIB THICKNESS	MIN. GOLD THICKNESS	PART NUMBER

THIS DRAWING IS A CONTROLLED DOCUMENT.

DIMENSIONS: MM	TOLERANCES UNLESS OTHERWISE SPECIFIED:	DWN O. HU 21MAR2006	TE Connectivity MODULAR JACK, RJ45/RJ11, COMBO, DIP, SIDE ENTRY.
	0 PLC ± -	CHK S. HOU 21MAR2006	
	1 PLC ± 0.3	APVD WJ. KE 21MAR2006	
	2 PLC ± 0.2	PRODUCT SPEC 108-57535	
	3 PLC ± 0.1	APPLICATION SPEC	NAME
	4 PLC ± -		SIZE CAGE CODE DRAWING NO RESTRICTED TO
	ANGLES ± -		WEIGHT 4.5 GRAMS A3 00779 C=1734712
MATERIAL SEE NOTE	FINISH SEE NOTE	CUSTOMER DRAWING	SCALE SHEET 1 OF 4 REV A2

THIS DRAWING IS UNPUBLISHED. RELEASED FOR PUBLICATION
 © COPYRIGHT 2013 BY TE CONNECTIVITY. ALL RIGHTS RESERVED.

LOC	DIST	REVISIONS					
DW	-	P	LTR	DESCRIPTION	DATE	DWN	APVD
				SEE SHEET 1			

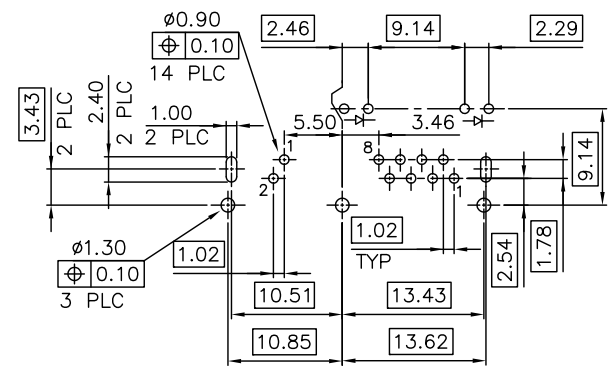
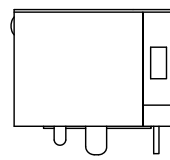
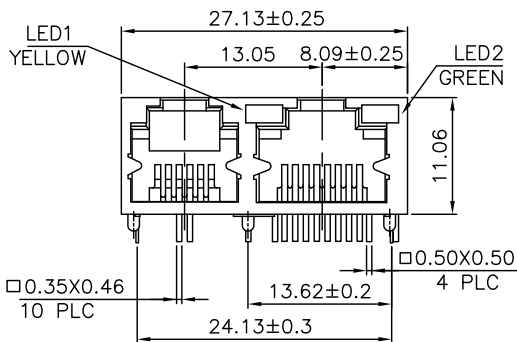
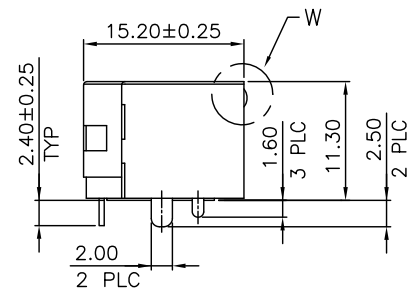
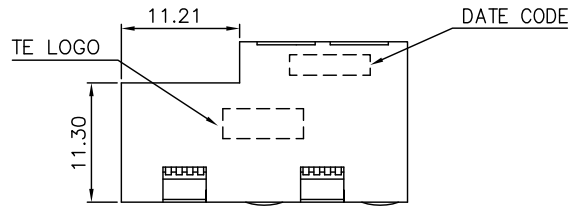
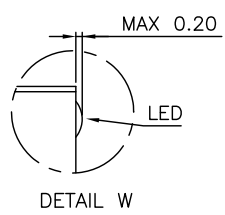

RECOMMENDED PCB LAYOUT (THICKNESS: 1.6MM)
 DIMENSION TOLERANCE: 1 PLC: ±0.1 2PLC: ±0.05

NOTE:

- MATERIAL:
 HOUSING: THERMOPLASTIC HIGH TEMP., UL94 V-0, COLOR: BLACK.
 CONTACT: PHOSPHOR BRONZE, THICKNESS: 0.35mm.
 SHELL: BRASS, THICKNESS: 0.25mm.
 LED LIGHT: EPOXY RESIN, THICKNESS: 0.50X0.50mm.
- FINISH:
 CONTACT: GOLD PLATED (SEE TABLE) IN CONTACT AREA,
 GOLD FLASH ON SOLDER TAILS,
 50u" MIN. NICKEL UNDERPLATED ALL OVER.
 SHELL: 20u" MIN. NICKEL PLATED.
- LED MUST BE REFLOW COMPATIBLE TO FOLLOWING TEMPERATURE PROFILE (FOR 1 CYCLE): ABOVE 160°C FOR 120 SECONDS, PEAKING AT 245°C FOR 20~40 SECONDS.
- LED DEFECT RATE IS 6000 PPM MAX. AFTER IR REFLOW PROCESS AS NOTE 3.
- WAVE SOLDER CAPABLE TO 265°C PER 109-202, CONDITION B.

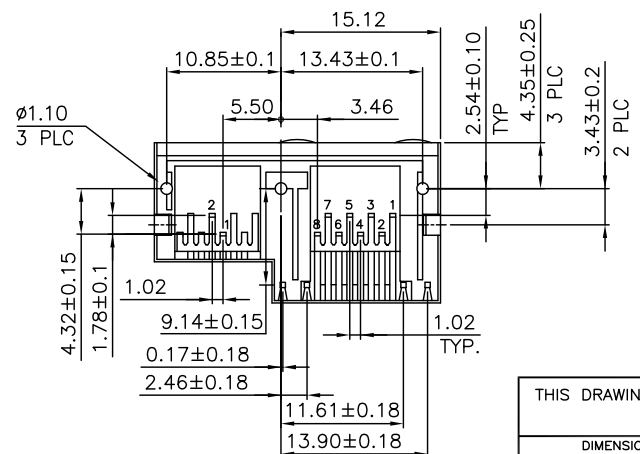

OBSOLETE	W/	50μ"	2-1734712-4
		30μ"	2-1734712-3
		15μ"	2-1734712-2
OBSOLETE		6μ"	2-1734712-1
	LED	MIN. GOLD THICKNESS	PART NUMBER

THIS DRAWING IS A CONTROLLED DOCUMENT.		DWN	-	TE Connectivity MODULAR JACK, RJ45/RJ11, COMBO, DIP, SIDE ENTRY.	
DIMENSIONS: MM		CHK	-		
TOLERANCES UNLESS OTHERWISE SPECIFIED:		APVD	-		
0 PLC ± - 1 PLC ± 0.3 2 PLC ± 0.2 3 PLC ± 0.1 4 PLC ± - ANGLES ± ±		PRODUCT SPEC	-		
MATERIAL SEE NOTE		FINISH SEE NOTE		APPLICATION SPEC	-
		WEIGHT -		SIZE	A3
		CUSTOMER DRAWING		CAGE CODE	00779
				DRAWING NO	C=1734712
				RESTRICTED TO	-
				SCALE	-
				SHEET	2 of 4
				REV	A2

THIS DRAWING IS UNPUBLISHED. RELEASED FOR PUBLICATION
 © COPYRIGHT 2013 BY TE CONNECTIVITY. ALL RIGHTS RESERVED.

LOC	DIST	REVISIONS					
DW	-	P	LTR	DESCRIPTION	DATE	DWN	APVD
				SEE SHEET 1			

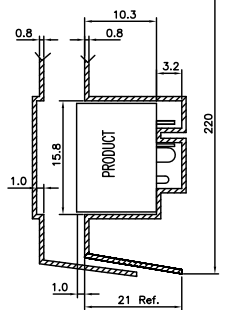
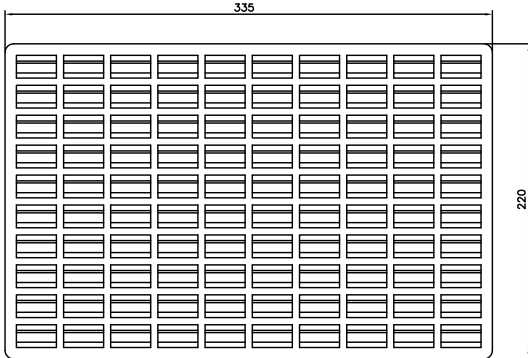

NOTE: 1. MATERIAL: PET T: 0.8mm.

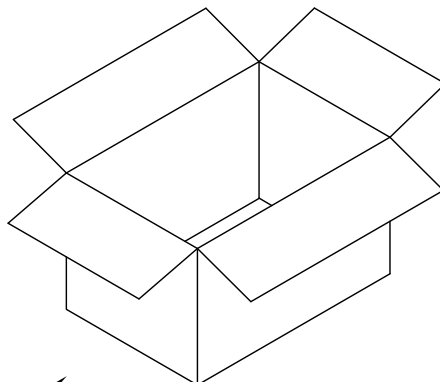

TOP COVER
(ONLY FOR TOP TRAY)

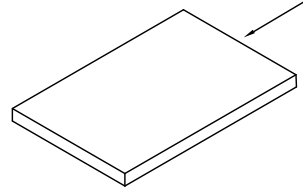

CARTON
 345mm(L)X235mm(W)X195mm(H)
 11 TRAY/CARTON
 TOTAL: 1100 PCS
 GROSS WEIGHT: 7Kg

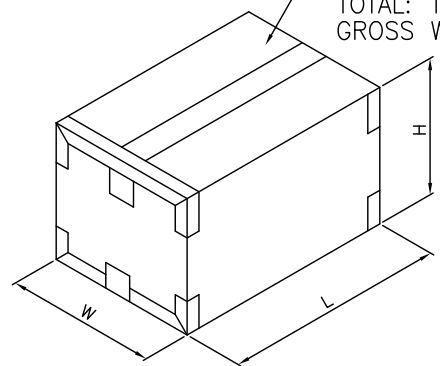

MODULAR JACK

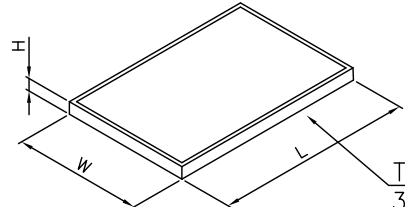
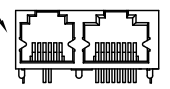

TRAY
 335mm(L)X220mm(W)X21mm(H)
 100 PCS/TRAY

THIS DRAWING IS A CONTROLLED DOCUMENT.		DWN	-	TE Connectivity MODULAR JACK, RJ45/RJ11, COMBO, DIP, SIDE ENTRY.					
DIMENSIONS: MM		CHK	-			NAME			
TOLERANCES UNLESS OTHERWISE SPECIFIED:		APVD	-			PRODUCT SPEC			
0 PLC ± - 1 PLC ± - 2 PLC ± - 3 PLC ± - 4 PLC ± - ANGLES ± -		APPLICATION SPEC	-			SIZE A3			
MATERIAL	FINISH	WEIGHT	-	CAGE CODE	00779	DRAWING NO	C=1734712	RESTRICTED TO	-
CUSTOMER DRAWING			SCALE	-	SHEET	4 of 4	REV	A2	