

THIS DRAWING IS UNPUBLISHED. RELEASED FOR PUBLICATION BY TYCO ELECTRONICS CORPORATION. ALL RIGHTS RESERVED.

LOC	DIST	REVISONS	
AD 00	P LTR	DESCRIPTION	DATE
	E1	REVISED PER ECO-06-002581	20JUN06 SSK JO

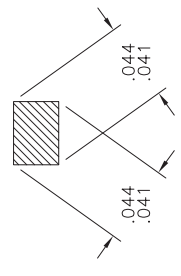
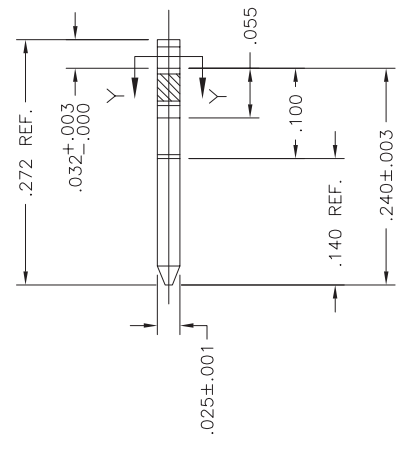
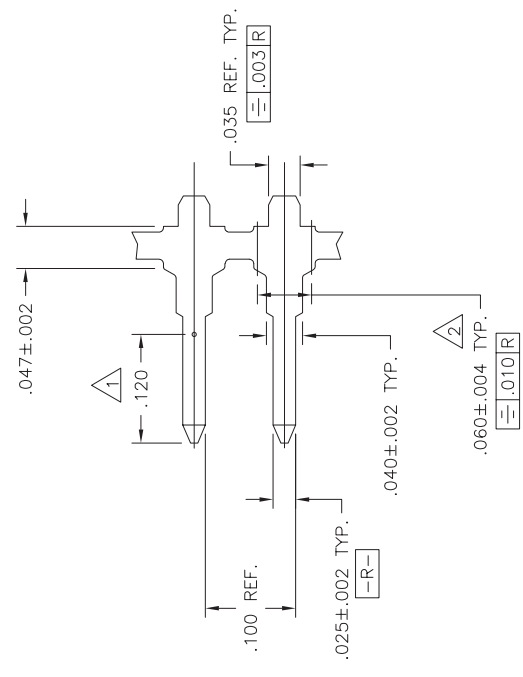

SECTION Y-Y
SCALE 20:1

1. POINT OF MEASUREMENT FOR PLATING THICKNESS
2. CUSTOMERS APPLICATOR CUT-OFF DIMENSION
3. .000100-.000200 TIN-LEAD OVER .000050-.000100 NICKEL
4. RECOMMENDED HOLE SIZE - .040±.002 FOR .100 STACKING HEIGHT
- .050±.002 FOR .050 STACKING HEIGHT
5. ALL PARTS MUST MEET SOLDERABILITY SPEC 109-11-5. ALL PARTS MUST MEET SOLDERABILITY SPEC 109-11-1; USING ONE SAMPLE REPEAT 109-11-1 FIVE (5) TIMES FLUXING PRIOR TO EACH DIP.
6. MATERIAL: BRASS, #4 HARD PER AMP SPEC 100-86.
7. .000100-.000200 MATTE TIN OVER .000050-.000100 NICKEL
8. ROHS 2002/95/EC COMPLAINT

THIS DRAWING IS A CONTROLLED DOCUMENT.		EN 20MAR01	20MAR01	20MAR01	20MAR01	20MAR01	20MAR01												
DRAWN BY: BROWN		21MAR01	21MAR01	21MAR01	21MAR01	21MAR01	21MAR01												
CHECKED BY: SIMPSON		APPROVED BY: SIMPSON		PRODUCT SPEC		APPLICATION SPEC													
DIMENSIONS: INCHES		TOLERANCES UNLESS OTHERWISE SPECIFIED:		WEIGHT		CUSTOMER DRAWING													
<table border="1"> <tr><td>Ø</td><td>±</td></tr> <tr><td>H</td><td>±</td></tr> <tr><td>F</td><td>±</td></tr> <tr><td>PLC</td><td>± .005</td></tr> <tr><td>ANGLES</td><td>±</td></tr> <tr><td>FINISH</td><td>±</td></tr> </table>		Ø	±	H	±	F	±	PLC	± .005	ANGLES	±	FINISH	±	SIZE		CASE CODE		DRAWING NO	
Ø	±																		
H	±																		
F	±																		
PLC	± .005																		
ANGLES	±																		
FINISH	±																		
MATERIAL		SCALE		10:1		SHEET 1 OF 1													
FINISH		PART NO.		STACKING POST, MOD II		RESTRICTED TO													
8 7 3		5-104126-1		104126-1		A2 00779 104126													
Tyco Electronics Corporation		Harrisburg, Pa 17105-3608		Tyco Electronics Corporation		Harrisburg, Pa 17105-3608													