

PART NO.

**RFD-1605-2-X**

| REV | DESCRIPTION                               | DWN | DATE     | APPROVED |
|-----|---|-----|----------|----------|
| A   | CHANGED FERRULE STUD & UPDATED DWG FORMAT | CZS | 03/12/15 | JDMc     |

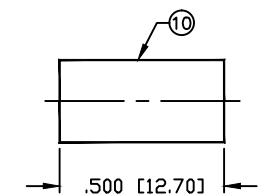
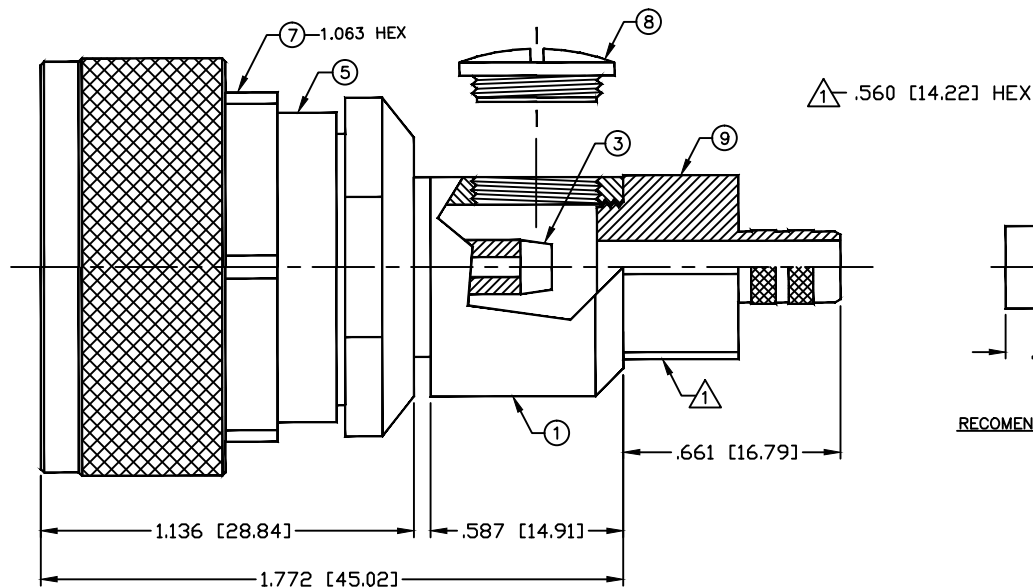

RECOMENDED CRIMP DIE: .255"

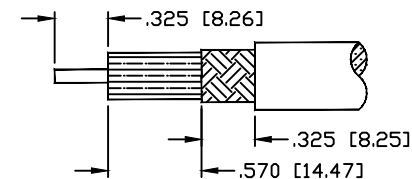

SUGGESTED STRIPPING INSTRUCTIONS [STRAIGHT]

NTS

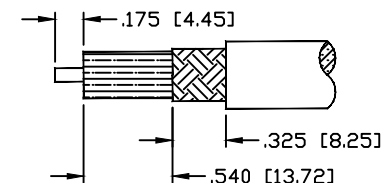

SUGGESTED STRIPPING INSTRUCTIONS [R/ANGLE]

NTS

**SPECIFICATIONS:**

IMPEDANCE: 50 Ohms

FREQUENCY RANGE: 0-7.5 GHz

PEAK POWER: 13.2 Kw max.

AVERAGE POWER: 3.0 Kw max.

TEMPERATURE RANGE: -55°C TO 150°C

FOR RG-8/X, BELDEN 9258, MAXRAD MBX-100 &amp;

MBX-1000, MICRO 8/U, REMEE 1600, SAXTON 8315 &amp;

TIMES LMR-240 &amp; LMR-240 ULTRAFLEX CABLE

|    |             |   |        |                    |
|----|-------------|---|--------|--------------------|
| 1  | BODY        | 1 | BRASS  | SILVER, 80 $\mu$ " |
| 2  | PIN         | 1 | BRASS  | SILVER, 80 $\mu$ " |
| 3  | CONTACT     | 1 | BRASS  | SILVER, 80 $\mu$ " |
| 4  | INSULATOR   | 1 | PTFE   | ---                |
| 5  | GROUND RING | 1 | BRASS  | SILVER, 80 $\mu$ " |
| 6  | GASKET      | 1 | RUBBER | ---                |
| 7  | SHELL       | 1 | BRASS  | SILVER, 80 $\mu$ " |
| 8  | SCREW CAP   | 1 | BRASS  | SILVER, 80 $\mu$ " |
| 9  | BACK NUT    | 1 | BRASS  | SILVER, 80 $\mu$ " |
| 10 | FERRULE     | 1 | BRASS  | SILVER, 80 $\mu$ " |

| # | DESCRIPTION | QTY | MATERIAL | FINISH |
|---|-------------|-----|----------|--------|
|---|-------------|-----|----------|--------|

CUSTOMER  
OUTLINE DRAWINGALL DIMENSIONS  
ARE REFERENCE ONLYUNLESS OTHERWISE SPECIFIED:  
DIMENSIONS ARE IN INCHES  
AND [MILLIMETERS]DRAWN  
C. ZUNIGA 03/12/15  
CHECKEDORJ DRAWN  
C. ZUNIGA 05/08/03**RoHS  
COMPLIANT**PROPRIETARY AND CONFIDENTIAL  
THIS DRAWING CONTAINS  
INFORMATION PROPRIETARY TO  
RF INDUSTRIES. ANY  
UNAUTHORIZED USE OF THIS  
DRAWING IS EXPRESSLY  
PROHIBITED WITHOUT WRITTEN  
PERMISSION FROM RF  
INDUSTRIES. ANY VIOLATION IS  
PUNISHABLE UNDER U.S.  
COPYRIGHT LAWS.**RFconnectors**7610 MIRAMAR RD.  
SAN DIEGO, CA 92126  
(858) 549-6340  
DIVISION OF RF INDUSTRIES, LTD. (858) 549-6345 FAX**7/16 DIN PLUG CRIMP**

STRAIGHT / RIGHT ANGLE COMBO

| SIZE   | CABLE GROUP     | DWG NO.             | REV          |
|--------|-----------------|---------------------|--------------|
| A      | X               | <b>RFD-1605-2-X</b> | A            |
| SCALE: | ENGINEERING ID: | 000000              | SHEET 1 OF 1 |
| NTS    |                 |                     |              |