

DO NOT SCALE DRAWING DIMENSION IN METRIC

PROJECT NO. SIMILAR ITEM DWG. NO. SD-35028-\*\*\*\*\*

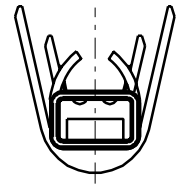
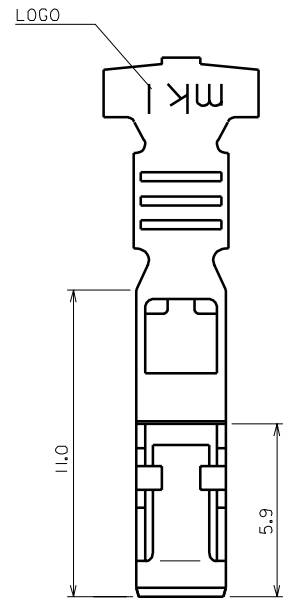
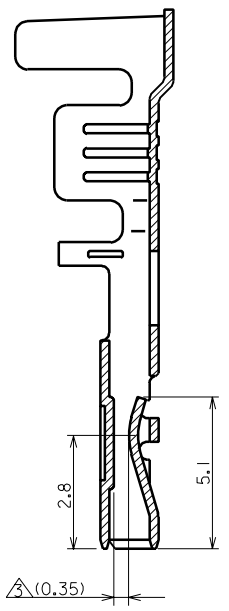
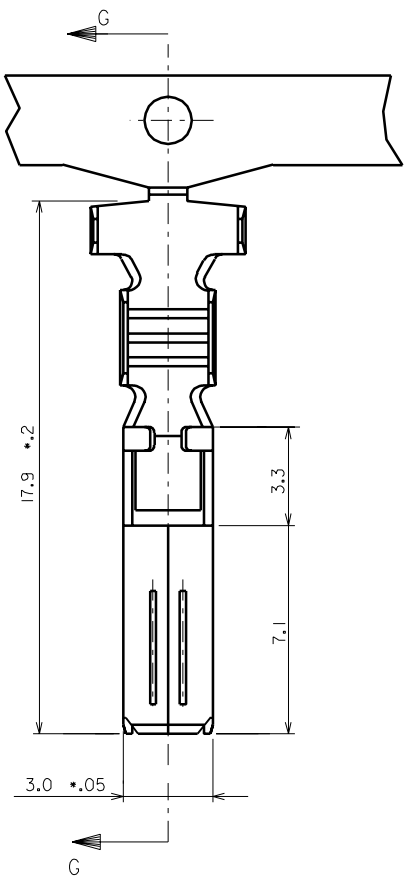
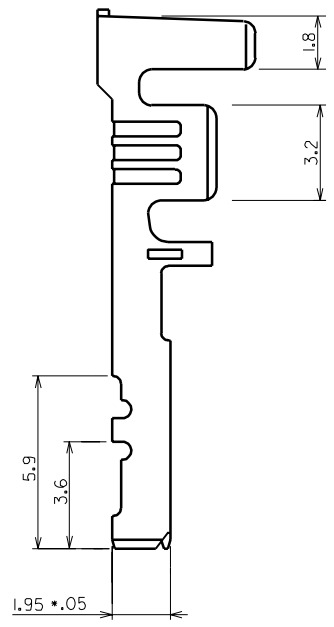

NOTES

- MATERIAL: PHOSPHOR BRONZE  
THICKNESS : 0.30 ± 0.02  
WIDTH : 22.8 ± 0.08
- PLATING: PREPLATING (REFLOW TREATMENT)
- MALE TAB (THICK 0.6 ± 0.05) FIT.  
- INSERTION FORCE: 0.8Kgf. MAX.  
- RETENTION FORCE: 0.3Kgf. MIN.
- WIRE SIZE : AWG #20 × 2 35028-9502  
AWG #18 × 22 35028-9010  
AWG #14 × 20 35028-1111

REVISED EC NO. KOR2002-0074 DRWN: C.B.CHIN 02/02/19 CHK: W.Y.YANG APPR: C.W.LEE	DESCRIPTION MAJOR = 0 CRITICAL = 0	GENERAL TOLERANCES: (UNLESS SPECIFIED)		SCALE 6:1	DESIGN UNITS <input checked="" type="checkbox"/> mm <input type="checkbox"/> INCH	THIRD ANGLE PROJECTION	DIMENSIONS: <input type="checkbox"/> mm <input type="checkbox"/> INCH		SHT	REV
		mm	INCH	DRAWN BY & DATE H.J.KIM 94/06/25	TITLE: .070 FEMALE TERMINAL	<input type="checkbox"/> mm <input type="checkbox"/> INCH	<input checked="" type="checkbox"/> mm ONLY	REVISE ON CAD ONLY		
H	REV	4 PLACES	±0.	±.	CHECKED BY & DATE B.K.CHOI 94/06/25	APPROVED BY & DATE				
		3 PLACES	±0.	±.	MATERIAL NO. SEE NOTES					
		2 PLACES	±0.15	±.	CAD FILENAME S35028.DGN		DRAWING NO. SD-35028-****	SHEET NO. 10F1		SIZE B
		1 PLACE	±0.15	±.	DRAWING NO. SD-35028-****		SHEET NO. 10F1		THIS DRAWING CONTAINS INFORMATION THAT IS PROPRIETARY TO MOLEX INCORPORATED AND SHOULD NOT BE USED WITHOUT WRITTEN PERMISSION.	
		ANGULAR: ± 0.5°		DRAFT WHERE APPLICABLE MUST REMAIN WITHIN DIMENSIONS		MATERIAL NO. SEE NOTES		DRAWING NO. SD-35028-****		SHEET NO. 10F1