

DESCRIPTION: COAXIAL/SIGNAL SOLDER CUP

FACE VIEW OF RECEPTACLE IS SHOWN

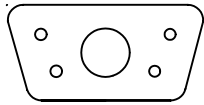

5W1

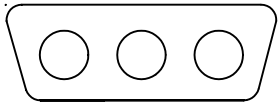

3W3

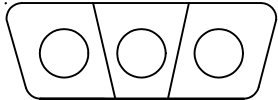

3W3K

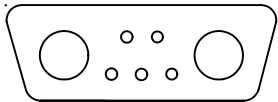

7W2

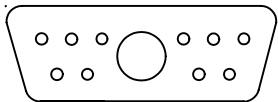

11W1

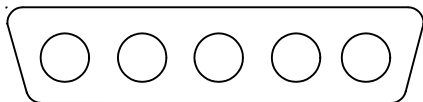

5W5

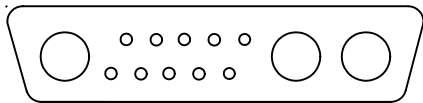

13W3

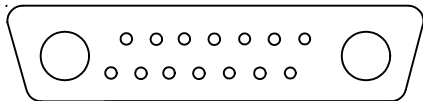

17W2

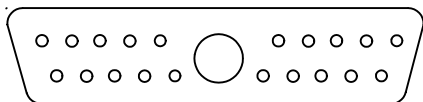

21W1

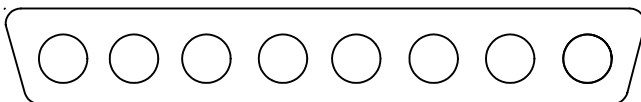

8W8

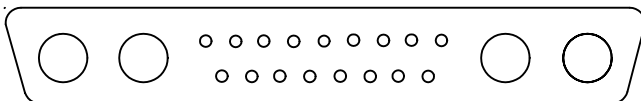

21WA4

PART NUMBER KEY

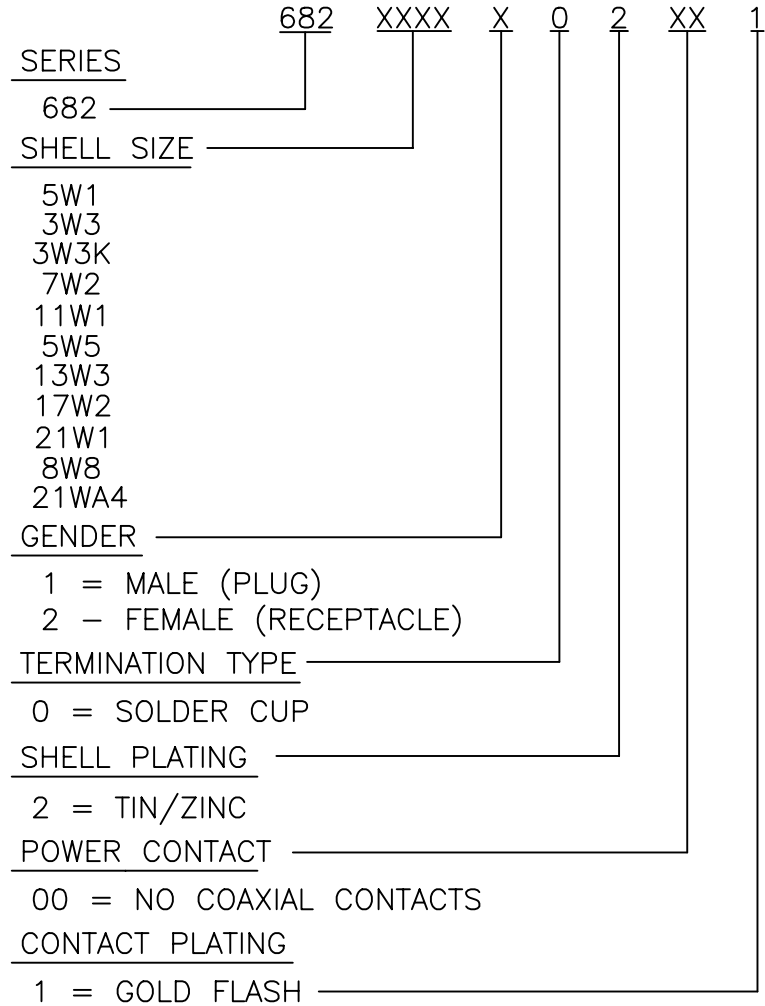

68221WA4 PART NUMBERS = 68221WA4P001 (MALE)  
68221WA4S001 (FEMALE)

	THESE DRAWINGS AND SPECIFICATIONS ARE THE PROPERTY OF NorComp AND SHALL NOT BE REPRODUCED, COPIED OR USED AS THE BASIS FOR THE MANUFACTURE OR SALE OF APPARATUS WITHOUT WRITTEN PERMISSION.		DRAWN: PAM JENKINS	DATE: 6-5-02
	<h1>NorComp</h1>		CHECKED:	DATE:
SCALE:			SHEET 1 OF 1	REV 2
DWG NO.			682 SERIES CONNECTORS	

DESCRIPTION: SIGNAL/COAXIAL CONTACTS

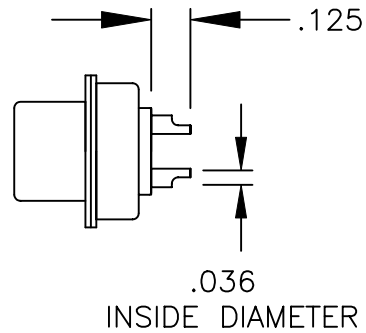

SIGNAL CONTACTS  
ACCEPTS UP TO 20 AWG WIRE

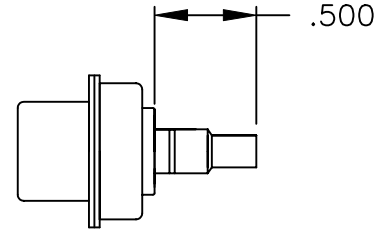

COAXIAL CONTACT  
ACCEPTS 75 OHM COAX, RG 179/U

NOTE: SIGNAL CONTACTS COME PRE-LOADED INTO INSULATOR.  
COAXIAL CONTACTS MUST BE PURCHASED SEPARATELY.

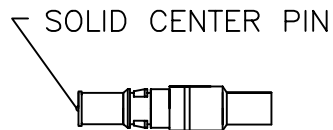

MALE COAXIAL CONTACT  
PART NUMBER: 682001170001

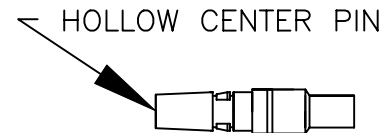

FEMALE COAXIAL CONTACT  
PART NUMBER: 682002170001

	THESE DRAWINGS AND SPECIFICATIONS ARE THE PROPERTY OF NorComp AND SHALL NOT BE REPRODUCED, COPIED OR USED AS THE BASIS FOR THE MANUFACTURE OR SALE OF APPARATUS WITHOUT WRITTEN PERMISSION.		DRAWN: PAM JENKINS	DATE: 6-5-02
			CHECKED:	DATE:
<h1>NorComp</h1>		SCALE:	SHEET 1 OF 1	REV 2
		DWG NO. 682 XXXX X 0 2 XX 1		