

PART NUMBER	REV	FIRST USED
567952-1	C	854040-3

TERMINAL NAME: BLADE		286750	VISIBLE PAD LTR	CRIMP DATA (NON-AMP TERM-CUST SPEC)	
				CRIMP HEIGHT	WIRE SIZE
AMP P/N	MFG P/N			A	.053 ±.002 [1.35 ±0.05mm]
286750	LTP-1811-58AU			B	NOT USED
				C	NOT USED
				D	NOT USED
				CRIMP WIRE	SIZE TYPE RANGE
				.094	[2.39mm] F 20
				.110	[2.79mm] F 20
WIRE STRIP LENGTH	TERM APPL SPEC	FEED	APPL INSTRUCTION	SET UP GAGE	LAYOUT
.203-.218	NONE	.600	SEE CUSTOMER MANUAL	NONE	L2115

SIM TO HDM NONE					70
					69
					68
					67
					66
					65
					64
					63
					62
					61
					60
					59
					58
					57
REF	-	B	694433-8	PAWL, FEED	56
					55
					54
					53
					52
1	-	A	811242-2	BUMPER, HOLDDOWN	51
1	-	A	690753-1	SPACER, TONKER	50
					49
1	-	A	690602-6	CAM, PRE-FEED 1.62 STROKE	48
					47
					46
1	-	A	690191-1	PLUG, NYLON	45
1	-	C	819307-4	RAM	44
1	-	A	690125-1	WASHER, LAMINATED	43
1	-	A	690124-1	WASHER, RAM	42
1	-	A	7-21002-9	BOLT, CRIMPER (5/16x1.00)	41
1	-	A	23241-6	BALL, STEEL	40
1	-	A	690170-1	SPRING, COMPRESSION	39
1	-	C	690142-4	DISC, INSULATION	38
1	-	D	354777-1	WIRE DISC, PLASTIC	37
1	-	A	22480-5	WASHER, SPRING	36
1	-	B	690212-1	POST, RAM	35
1	-	B	690786-1	SUPPORT, TERMINAL	34
1	-	C	462544-1	PLATE, BASE SPECIAL	33
1	-	A	690432-3	SCREW, ADJUSTMENT	32
1	-	B	462543-1	BLOCK, SCREW SPECIAL	31
1	-	B	455689-1	BLOCK, STRIP GUIDE ADJ	30
1	-	C	458144-1	PLATE, STRIP GUIDE	29
1	-	C	1-455888-5	SPACER, FRONT SHEAR DEP	28
2	-	A	1-22284-0	SPRING, DRAG	27
1	-	B	240793-1	LEVER, DRAG RELEASE	26
1	-	B	240792-1	DRAG, TERMINAL	25
1	-	D	90765-4	GUIDE, STRIP (REAR)	24
1	-	A	690438-1	GUIDE, STRIP (FRONT)	23
					22
1	-	A	463756-1	GUIDE, SCRAP	21
					20
1	-	C	904458-1	STRIPPER	19
1	-	B	904225-1	JAW ASSY	18
					17
					16
					15
					14
					13
1	-	A	5-22280-0	SPRING, SHEAR	12
1	-	B	1-690461-6	STOP, SHEAR (FRONT)	11
1	-	B	462548-1	HOLDER, SHEAR (FRONT) SP	10
1	-	B	462547-2	SHEAR, FLOAT (FRONT) SP	9
1	-	C	2-662520-3	ANVIL	8
1	-	C	240641-1	SPACER, DEPRESSOR (REAR)	7
					6
1	-	A	462838-1	DEPRESSOR, SHEAR (FRONT) SP	5
1	-	B	238011-2	SPACER, BLOCK CRIMPER	4
1	-	C	1-456134-5	CRIMPER, INSULATION	3
1	-	C	455888-5	SPACER, CRIMPER	2
1	-	C	1-568176-1	CRIMPER, WIRE	1

2	-	C	3-354779-6	PIN, WIRE DISC (.3170)C	129
					128
					127
					126
1	-	A	986950-1	WASHER, FLAT PRECISION	125
1	-	A	217238-3	GENERAL INSTRUCTION PACKAGE	124
					123
					122
1	-	A	4-21028-0	PIN, SLT SPR (Ø.093x.75) ST 60E PL	121
1	-	B	690701-2	PLATE, SERIAL NO.	120
2	-	A	21899-2	WASHER, FLAT (#10) 5 G ADJ BLK	119
					118
2	-	A	21024-5	WASHER, LOCK (#10) ADJ BLOCK	117
					116
					115
2	-	A	21024-2	WASHER, LOCK (#4) FRONT STP GUIDE	114
REF	-	A	21024-4	WASHER, LOCK (#8) FEED FINGER	113
2	-	A	21024-4	WASHER, LOCK (#8) DEP-HOLD	112
REF	-	A	21024-4	WASHER, LOCK (#8) STRIPPER	111
					110
					109
1	-	A	21018-5	NUT, HEX (#6) HOLD DOWN	108
					107
					106
1	-	A	22353-8	SCR, SHLD (Ø.187x.25) DRAG LEVER	105
					104
1	-	A	21009-2	SCR, SKT 5ET (1/4-20x.25 LW) RAM	103
					102
4	-	A	21017-2	SCR, DRIVE (#2x.19) ID PLATE	101
1	-	B	819347-1	PLATE, IDENTIFICATION	100
2	-	A	3-21002-0	SCR, BHC (10-32x.88) DRAG	99
1	-	A	22733-8	SCR, BHC (8-32x.38 LW) ANVIL	98
					97
1	-	A	3-21000-8	SCR, SHC (10-32x.88) MOUNTING	96
1	-	A	2-21002-7	SCR, BHC (10-32x.50) 5G ADJ BLK	95
6	-	A	2-21002-2	SCR, BHC (8-32x.50) SHEAR-TERM SUP	94
					93
					92
1	-	A	1-21002-7	SCR, SHC (6-32x.50) CAM	91
2	-	A	2-21000-7	SCR, SHC (8-32x.50) SCR BLK	90
2	-	A	2-21000-9	SCR, SHC (8-32x.75) HLD DWN	89
					88
					87
REF	-	A	2-22603-0	SCR, HEX HD (8-32x.31) FEED FINGER	86
2	-	A	1-21000-3	SCR, SHC (4-40x.25) F ST GUIDE	85
REF	-	A	22733-9	SCR, BHC (8-32x.50 SL) STRIPPER	84
					83
					82
1	-	A	3-22603-1	SCR, HEX (10-32x.38) 5G ADJ BL	81
					80
					79
					78
2	-	B	463310-5	BLADE, STRIPPING (#20)	77
					76
					75
1	-	A	690603-1	SPRING, ASSIST	74
1	-	A	23030-1	SCR, SKT CAP (6-32x.25) CP DSC	73
					72
					71

QTY	REQD PER ASSY	DWG SIZE	PART NO	DESCRIPTION	ITEM NO

QTY	REQD PER ASSY	DWG SIZE	PART NO	DESCRIPTION	ITEM NO

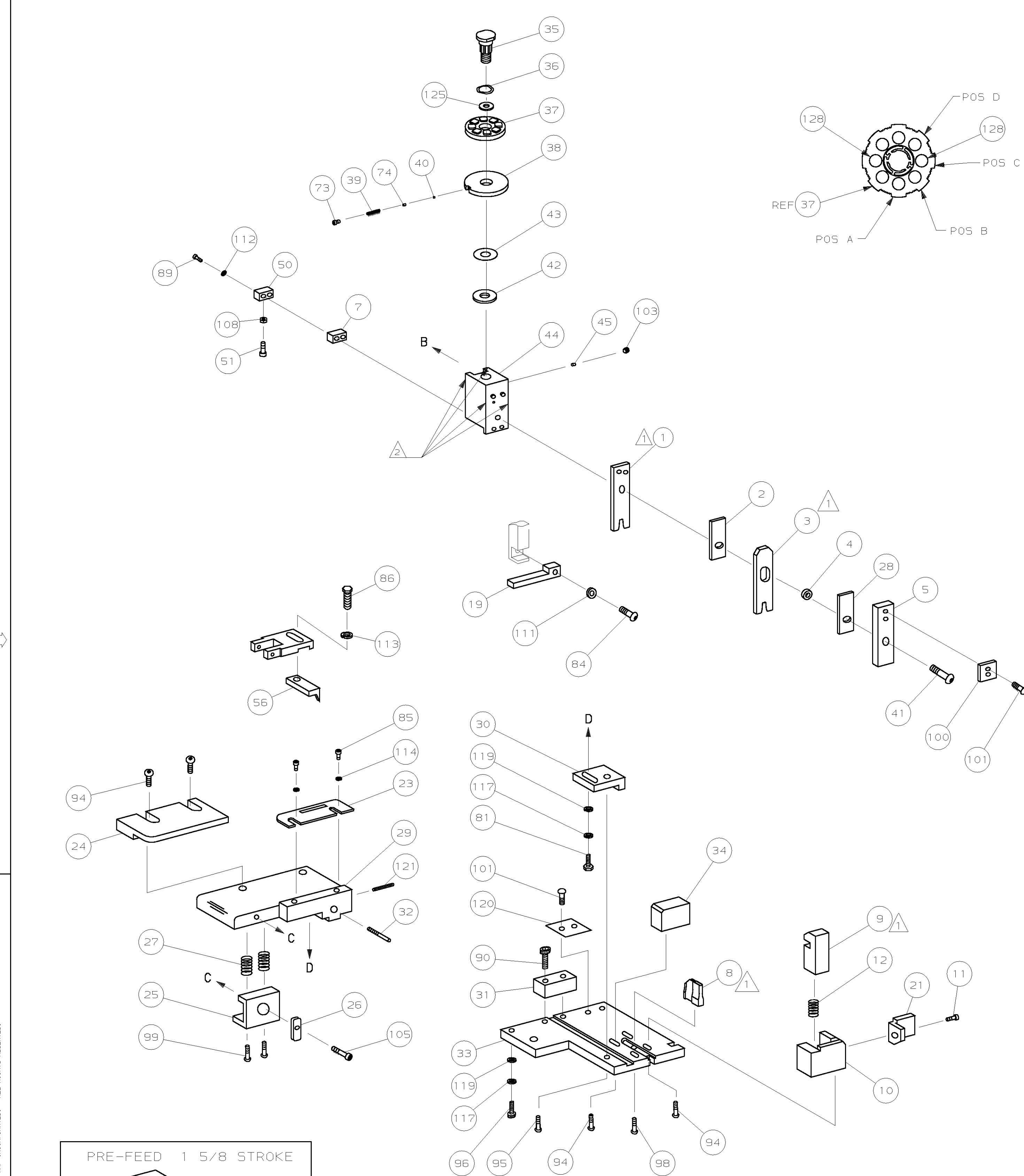

1 RECOMMENDED SPARE PARTS.
 2 GREASE LIGHTLY.
 3 ITEM NOT SHOWN
 4 INS RANGE TO BE DETERMINED AT SET-UP.
 5 CUT TO LENGTH AT ASSEMBLY.

6. ON THE STRIPPER CRIMPER MACHINE, POSITION THE FRONT METAL GUARD ON THE FRONT SIDE OF THE LEXAN DOOR

PRE-FEED 1 5/8 STROKE
 ROTATED 180°

THIS DRAWING IS A CONTROLLED DOCUMENT.

RELEASED FOR PUBLICATION JUL 22, 1995 BY AMP INCORPORATED. ALL RIGHTS RESERVED.

DIMENSIONS IN INCHES. DO NOT SCALE PRINT. TOLERANCES UNLESS OTHERWISE SPECIFIED:
 2 PLC DEC ±
 3 PLC DEC ±
 4 PLC DEC ±
 ANGLES ±
 SURF TEXTURE: ✓
 REMOVE BURRS, BREAK SHARP EDGES R.015 MAX

DR	01SEP98	APP	01SEP98		
B.HIGMAN		T.ELBIN			
CHK	01SEP98	REL			
C.ERISMAN					

NAME: STRIPPER CRIMPER APPLICATOR MACHINE REF: STRIPPER CRIMPER
 SCALE: - DWG NO: 567952 SHEET: 1 OF 1 REV: C1

CASE CODE: 00779 CUSTOMER AND ASSEMBLY DRAWING RESTRICTED TO