

- 1
- 2
- 3
- 4
- 5
- 6
- 7
- 8
- 9
- 10
- 11
- 12
- 13
- 14
- 15
- 16
- 17
- 18

STANDARD EXECUTION

(AlNiCo) Aluminium-nickel-cobalt magnet, resistant to temperatures up to 450°C.

See Guidelines for the choosing (on page 1180).

FEATURES AND APPLICATIONS

RML-US retaining magnets are unshielded cylindric magnets.

They are mostly attached by gluing.

When used without air gap, RML-US unshielded magnets have lower adhesive forces than the magnet systems RML (see page 1197) in which magnetic shielding increases enormously the intensity of the adhesive force acting on the surface.

SPECIAL EXECUTIONS ON REQUEST

Different lengths.



| Conversion Table | |
|-------------------|------|
| 1 mm = 0,039 inch | |
| d1 | |
| mm | inch |
| 3 | 0.12 |
| 4 | 0.16 |
| 5 | 0.20 |
| 6 | 0.24 |
| 8 | 0.31 |
| 10 | 0.39 |
| 12 | 0.47 |
| 15 | 0.59 |
| 20 | 0.79 |
| 34 | 1.34 |

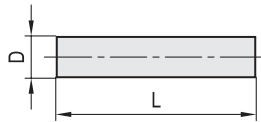

METRIC

| Code | Description | D+0-0.2 | L±0.1 | Temperature max. [°C] | Nominal adhesive forces* [N] | ⚖️ |
|--------|-----------------|---------|-------|-----------------------|------------------------------|-----|
| 502041 | RML-US-AN-3-10 | 3 | 10 | 450 | 1.1 | 1 |
| 502043 | RML-US-AN-3-12 | 3 | 12 | 450 | 1.3 | 1 |
| 502045 | RML-US-AN-4-16 | 4 | 16 | 450 | 1.9 | 1 |
| 502047 | RML-US-AN-4-20 | 4 | 20 | 450 | 2 | 2 |
| 502049 | RML-US-AN-5-20 | 5 | 20 | 450 | 2.3 | 3 |
| 502051 | RML-US-AN-6-15 | 6 | 15 | 350 | 2.8 | 3 |
| 502053 | RML-US-AN-6-24 | 6 | 24 | 450 | 2.8 | 4 |
| 502055 | RML-US-AN-6-30 | 6 | 30 | 450 | 2.8 | 6 |
| 502057 | RML-US-AN-8-25 | 8 | 25 | 450 | 3.8 | 9 |
| 502059 | RML-US-AN-8-32 | 8 | 32 | 450 | 3.8 | 11 |
| 502061 | RML-US-AN-10-20 | 10 | 20 | 350 | 5 | 11 |
| 502063 | RML-US-AN-10-40 | 10 | 40 | 450 | 7 | 23 |
| 502065 | RML-US-AN-12-40 | 12 | 40 | 450 | 8 | 33 |
| 502067 | RML-US-AN-12-48 | 12 | 48 | 450 | 8 | 39 |
| 502069 | RML-US-AN-15-30 | 15 | 30 | 350 | 10 | 39 |
| 502071 | RML-US-AN-15-60 | 15 | 60 | 450 | 11 | 76 |
| 502073 | RML-US-AN-20-40 | 20 | 40 | 350 | 17 | 92 |
| 502075 | RML-US-AN-34-80 | 34 | 80 | 350 | 61 | 527 |