

NOTES:

1. MATERIALS OF CONSTRUCTION:
 BODY = BRASS (ASTM-B16 H02, C36000), NICKEL PLATED (.000100 MIN THICK),
 CONTACT PIN = BRASS (ASTM-B16 H02, C36000), GOLD PLATED (.000003 MIN THICK),
 INSULATORS (2) = PTFE, ASTM D 1710 OR EQUIV
2. DO NOT SCALE THIS DRAWING.
3. UNLESS OTHERWISE SPECIFIED, ALL DIMENSIONS ARE AFTER PLATING.
4. PACKAGE CONNECTOR IN BAG.
5. ELECTRICAL:
 A. IMPEDANCE: NON-CONSTANT
 B. FREQUENCY RANGE: DC - 300 MHZ
 C. DIELECTRIC WITHSTANDING VOLTAGE: 500 VRMS, MIN.
6. PHYSICAL:
 A. TEMPERATURE RANGE: -55°C TO +85° C

83-1J-RFX		REVISIONS			
DRAWING NO.	REV	DESCRIPTION	DATE	ECO	APPR
THIRD ANGLE PROJ.	A	RELEASE TO MFG.	5/3/91	38063	DR
	C	RE-RELEASE TO EAR 967091-0	10/16/98	42692	CPM/
	D	SEE SHEET 1	3/26/03	44411	CPM/

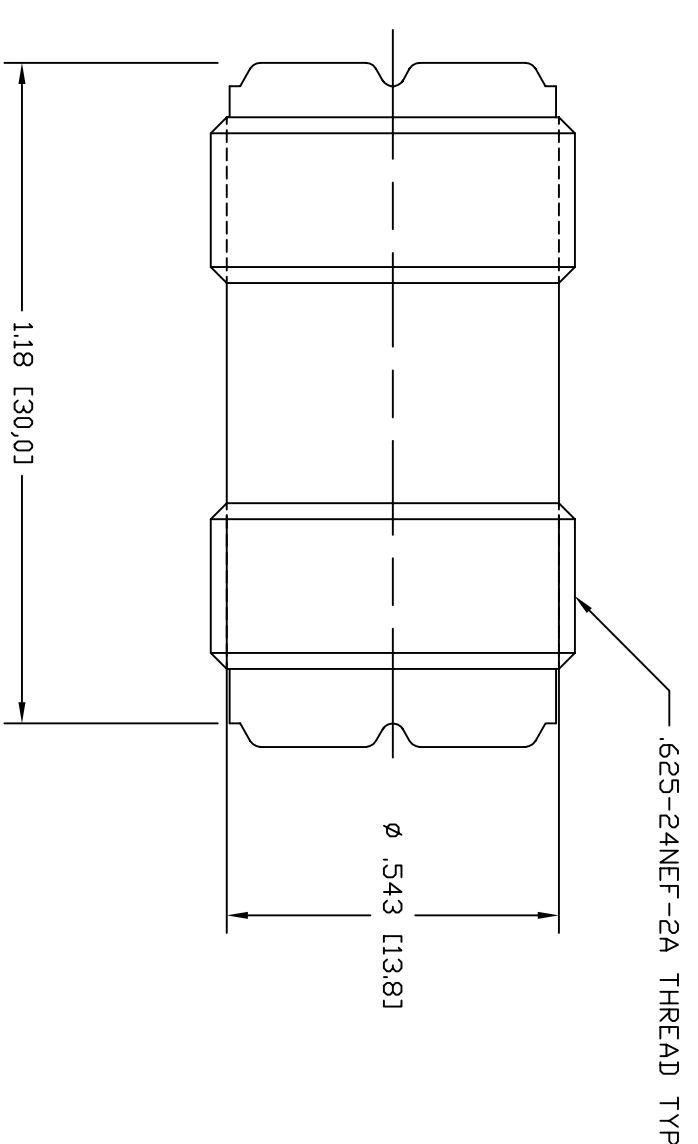

CUSTOMER OUTLINE DRAWING
 ALL OTHER SHEETS ARE FOR INTERNAL USE ONLY

UNLESS OTHERWISE SPECIFIED, DIMENSIONS ARE IN INCHES AND TOLERANCES ARE:
 2 PLACE DECIMAL ±.015 (0,381 mm)
 3 PLACE DECIMAL ±.005 (0,127 mm)
 ANGLES ± 1°

NOTICE - These drawings, specifications, or other data (1) are, and remain the property of Amphenol Corp. (2) must be returned upon request; and (3) are confidential and not to be disclosed to any person other than those to whom they are given by Amphenol Corp. The furnishing of these drawings, specifications, or other data by Amphenol Corp., or to any other person to anyone for any purpose is not to be regarded by implication or otherwise in any manner licensing, granting rights or permitting such holder or any other person to manufacture, use or sell any product, process or design, patented or otherwise, that may in any way be related to or disclosed by said drawings, specifications, or other data.

MATERIAL	REFERENCE
	EAR 962370-0 EAR 967091-0

DRAWN	T. ALBERA	DATE	4/12/91
ENGINEER	D. ROYCE	DATE	4/27/91
APPROVED	D. BARTHELMES	DATE	3/26/03
CAD FILE	H:\DEPT611\UHF\ASSY\1JRFXSH2		

TITLE	UHF FEMALE TO FEMALE ADAPTOR
CODE ID	74868
DWG SIZE	B
DRAWING NO.	83-1J-RFX

Amphenol	
Amphenol Corporation RF/Microwave Operations Danbury, Conn. U.S.A. 06810	
SCALE: 3:1	SHEET 2 OF 2
REV	D