

# CTSPMA6010F Series

From .47 $\mu$ H to 10 $\mu$ H

## SPECIFICATIONS

Parts are available in  $\pm 20\%$  inductance tolerance only

Part Number	Inductance ( $\mu$ H)	L Test Condition	DCR Max. (m $\Omega$ )	Isat Max. (A)	Irms Max. (A)
CTSPMA6010F-R47M	0.47	100KHz, 1V	41.2	9.4	4.2
CTSPMA6010F-R68M	0.68	100KHz, 1V	43.0	8.5	4.2
CTSPMA6010F-1R0M	1.00	100KHz, 1V	54.0	7.2	4.0
CTSPMA6010F-1R5M	1.50	100KHz, 1V	74.0	6.8	3.1
CTSPMA6010F-2R2M	2.20	100KHz, 1V	83.0	5.2	2.9
CTSPMA6010F-3R3M	3.30	100KHz, 1V	99.0	4.5	2.8
CTSPMA6010F-4R7M	4.70	100KHz, 1V	133.0	4.1	2.5
CTSPMA6010F-6R8M	6.80	100KHz, 1V	173.0	3.2	2.0
CTSPMA6010F-100M	10	100KHz, 1V	240.0	2.2	1.7



## PHYSICAL DIMENSIONS

Size	A	B	C	D	E	F
mm	7.1 $\pm$ 0.2	6.7 $\pm$ 0.2	7.1	1.0	2.7	2.7
inches	0.28 $\pm$ 0.008	0.26 $\pm$ 0.008	0.28	0.039	0.106	0.106
Size	G	H	I	J	K	
mm	1.5	1.65 $\pm$ 0.1	3.8	1.85 $\pm$ 0.1	3.0	
inches	0.059	0.065 $\pm$ 0.004	0.150	0.073 $\pm$ 0.004	0.118	

## CHARACTERISTICS

**Description:** SMD (shielded) Power Inductors

**Applications:** Smart phones, Notebook PC's, Tablets, HDD's, Servers, VRM's, Compact power supply modules, etc.

**Saturation Rated Current (Isat):** The DC current when the when the inductance becomes 30% lower than its initial value. (Ta=25°C)

**Temperature Rise Current (Irms):** The actual current when temperature of coil becomes  $\Delta T 40^\circ\text{C}$ . (Ta=25°C)

**Operating Temperature Range:** -55°C to 155°C

**Markings:** Inductance Code

**Miscellaneous:** RoHS compliant

**Samples available. See website for ordering information.**

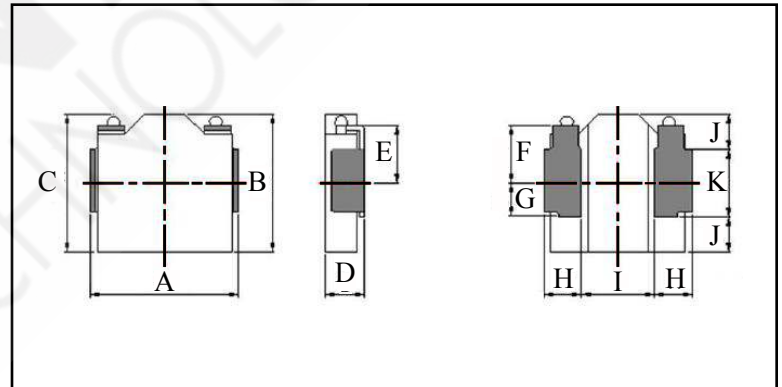

## PAD LAYOUT

