

LOADING PATTERN MATING SIDE

R = CUSTOMER SPECIAL CONTACT  
 MATING LEVEL 6.7 MM / SHORT TERMINATION 3.7MM  
 (NOT IN ACCORDANCE WITH IEC 1076-4-101)

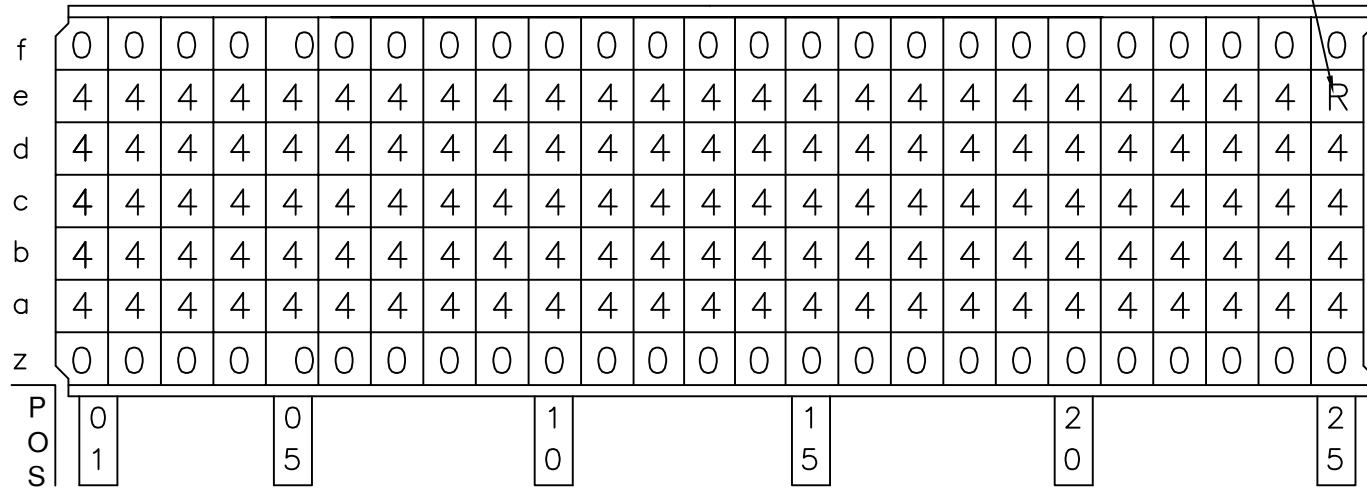

LOADED CONNECTOR ASSEMBLY  
 (FOR EXAMPLE)

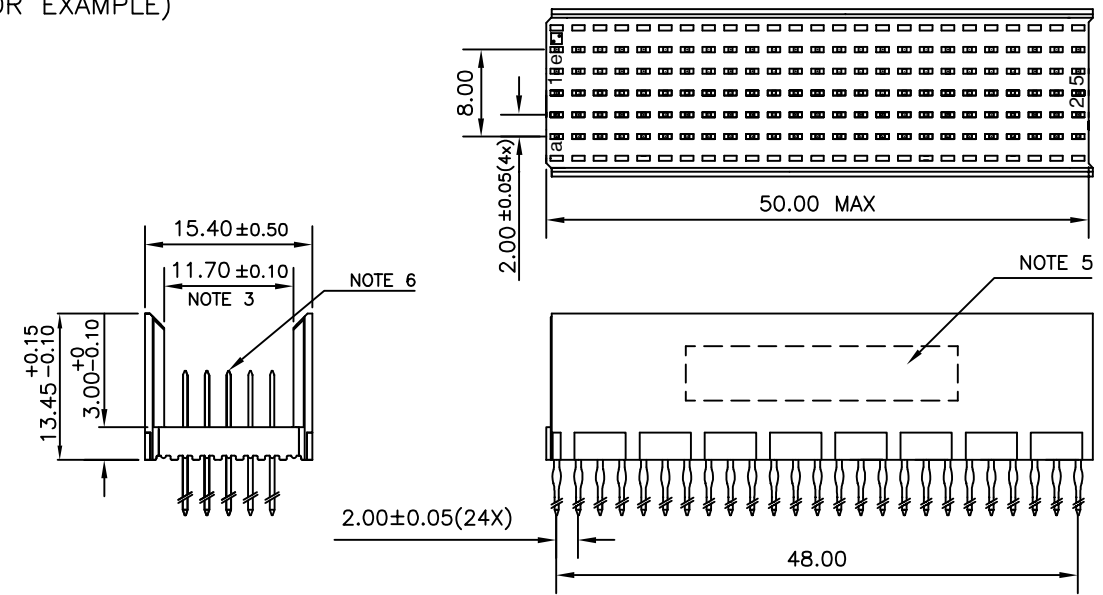

CONTACT OVERVIEW

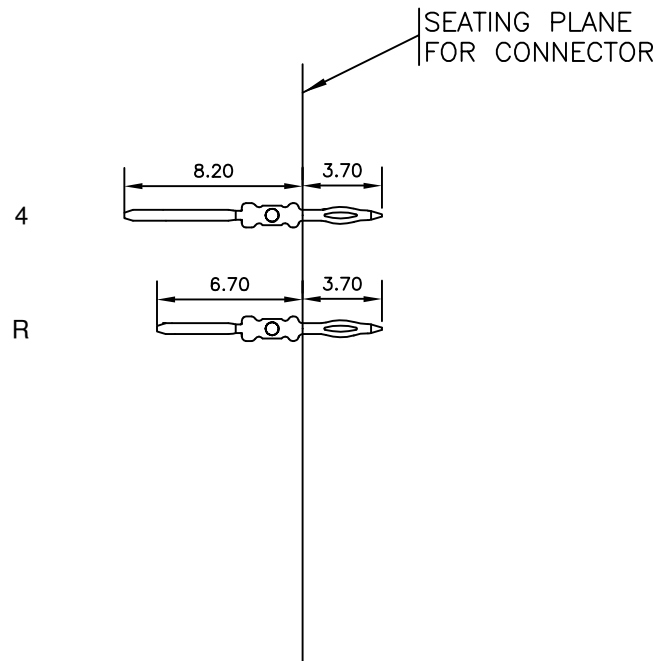

LAY-OUT P.C.B.-HOLE

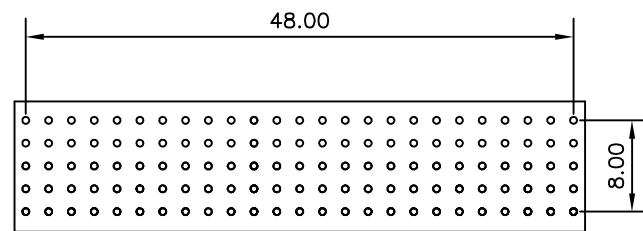

HM2P08PDR1F0 LEAD FREE INDICATOR : LF = LEAD FREE (DIGIT 15 & 16)  
 PLATING CODE (DIGIT 13 AND 14) (REF DRW NO. BS,C , 201844 , 003)

NOTES

- THIS PRODUCT IS CSA APPROVED.
- THIS PRODUCT IS UL RECOGNIZED.
- MEASURED AT THE BOTTOM.
- MATERIAL CONTACT: PHOSPHORBRONZE  
 HOUSING: CREAM WHITE GLASS FILLED POLYESTER UL-94V0
- CONNECTOR PRINTED WITH P/N AND DATE CODE.
- FOR ACTUAL CONTACT LOADINGS, SEE LOADING PATTERN MATING SIDE.
- SHAPE OF CONNECTOR HOUSING CAN ALTER DEPENDING ON PRODUCTION LOCATION
- THE PRODUCT (LF) MEETS EUROPEAN UNION DIRECTIVES AND OTHER COUNTRY REGULATIONS AS DESCRIBED IN GS-22-008
- FOR RECOMMENDED PTH DIMENSIONS REFER DRAWING : BS, A , 201572 , 001

CATALOG NO: HM2P08PDR1F0- - -

mat'l. code SEE NOTE 4				surface ISO 1302 <input checked="" type="checkbox"/>		tolerance ISO 406 ISO 1101		projection 		product family MILLIPACS					
litr				ecn no		dr		date		tolerances unless otherwise specified					
A				105-0207		MNI		2005-10-27		angles		linear		.0±0.2	
B				106-0122		MNI		2006-07-20		0°±1°		linear		.00±0.1	
										scale		-			
						dr		MNI K VANDANATH		2005-10-27		dwg no		sheet 1 of 1 size	
						enr		BJU K PAUL		2005-10-27		BS, C ,203028,311		A3	
						chr		BJU K PAUL		2006-07-20		type		Product Customer Drawing	
						appd		BJU K PAUL		2006-07-20					
sheet index		revision sheet		B		1									



FCIconnect.com

Copyright FCI