

Flush-type connector - SACC-E-M12MS-5CON-M12 PSCUP - 1436437

Please be informed that the data shown in this PDF Document is generated from our Online Catalog. Please find the complete data in the user's documentation. Our General Terms of Use for Downloads are valid (<http://download.phoenixcontact.com>)



Sensor/actuator flush-type connector, male connector, 5-pos., M12, A-encoded, front/screw mounting with M12 thread, with solder cups, plastic version

Key commercial data

| | |
|------------------------|--|
| Packing unit | 0 |
| Minimum order quantity | 1 |
| Catalog page | Page 36 (PC-2011) |
| GTIN |  4 046356 438384 |
| Custom tariff number | 85366990 |
| Country of origin | GERMANY |

Technical data

General data

| | |
|---------------------------------|--|
| Rated current at 40°C | 4 A |
| Rated voltage | 60 V |
| Number of positions | 5 |
| Volume resistance | ≤ 3 mΩ |
| Insulation resistance | ≥ 100 MΩ |
| Ambient temperature (operation) | -25 °C ... 85 °C (Male connector / female connector) |

General characteristics

| | |
|--------------------------|--------------------------------------|
| Standards/regulations | M12 connector IEC 61076-2-101 |
| Coding | A - standard |
| Surge voltage category | II |
| Pollution degree | 3 |
| Degree of protection | IP67 |
| Contact material | CuZn |
| Contact surface material | Au |
| Contact carrier material | PA 66 |
| Material, knurls | PA 66 |
| Sealing material | Viton |
| Mounting type | Front mounting M12 x 1 With flat nut |

Flush-type connector - SACC-E-M12MS-5CON-M12 PSCUP - 1436437

Technical data

General characteristics

| | |
|-------------------|------------|
| Connection method | Solder cup |
| Status display | No |

Classifications

eclass

| | |
|------------|----------|
| eCl@ss 4.0 | 27250313 |
| eCl@ss 4.1 | 27250313 |
| eCl@ss 5.0 | 27143423 |
| eCl@ss 5.1 | 27143423 |
| eCl@ss 6.0 | 27143423 |
| eCl@ss 7.0 | 27449001 |

etim

| | |
|----------|----------|
| ETIM 3.0 | EC002061 |
| ETIM 4.0 | EC002061 |

unspsc

| | |
|---------------|----------|
| UNSPSC 6.01 | 31251501 |
| UNSPSC 7.0901 | 31251501 |
| UNSPSC 11 | 31251501 |
| UNSPSC 12.01 | 31251501 |
| UNSPSC 13.2 | 31251501 |

Approvals

Approvals

Approvals

GOST

Ex Approvals

Approvals submitted

Approval details

Flush-type connector - SACC-E-M12MS-5CON-M12 PSCUP - 1436437

Approvals



Drawings

Dimensioned drawing

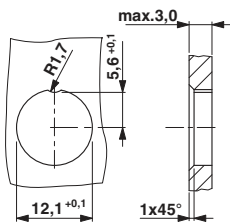

Schematic diagram

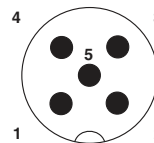

Pin assignment M12 male connector, 5-pos., A-coded, male side

Housing cutout for M12 fastening thread, mounting panel with feed-through hole

Dimensioned drawing

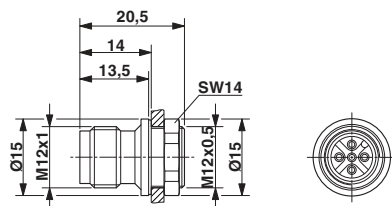

M12 flush-type connector