

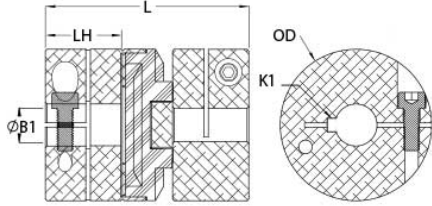

MOCC25-10-SS

Ruland MOCC25-10-SS, 10mm Oldham Coupling Hub, 303 Stainless Steel, Clamp Style With Keyway, 25.4mm OD, 11.9mm Length



Description

Ruland MOCC25-10-SS is a clamp oldham coupling hub with a 10mm bore, 3mm keyway, 25.4mm OD, and 11.9mm length. It is a component of a three-piece design consisting of two stainless steel hubs press fit onto a center disk. This three-piece design allows for a highly customizable coupling that easily combines clamp or set screw hubs with inch, metric, keyed, and keyless bores. Disks are available in three materials allowing the user to tailor coupling performance to their application. MOCC25-10-SS can accommodate all forms of misalignment and is especially useful in applications with high parallel misalignment (up to 10% of the OD). It operates with low bearing loads protecting sensitive system components such as bearings and has a balanced design for reduced vibration at speeds up to 6,000 RPM. Hardware is metric and tests beyond DIN 912 12.9 standards for maximum torque capabilities. MOCC25-10-SS is machined from bar stock that is sourced exclusively from North American mills and is RoHS3 and REACH compliant. It is manufactured in our Marlborough, MA factory under strict controls using proprietary processes.

Product Specifications

Bore (B1)	10 mm	Keyway (K)	3 mm
Outer Diameter (OD)	25.4 mm	B1 Max Shaft Penetration	11.9 mm
Bore Tolerance	+0.03 mm / -0.00 mm	Hub Width (LH)	11.85 mm
Length (L)	31.8 mm	Recommended Shaft Tolerance	+0.000 mm / -0.013 mm
Forged Clamp Screw	M3	Number of Screws	1 ea
Screw Material	18-8 300 Series Stainless Steel	Screw Finish	Bright
Seating Torque	1.1 Nm	Hex Wrench Size	2.5 mm
Torque Specifications	Torque ratings vary with insert selection	Angular Misalignment	0.5°
Parallel Misalignment	0.008 in (0.20 mm)	Max Parallel Misalignment	0.100 in (2.54 mm)
Axial Motion	0.004 in (0.10 mm)	Moment of Inertia	3.716 x 10 ⁻⁶ kg-m ²
Maximum Speed	4,500 RPM	Recommended Inserts	OD16/25-AT , OD16/25-NL , OD16/25-PEK
Full Bearing Support Required?	Yes	Zero-Backlash?	Yes
Balanced Design	Yes	Mechanical Fuse?	Yes
UPC	634529238516	Country of Origin	USA
Material Specification	Type 303 Austenitic, Non-Magnetic Bar	Finish	Bright
Finish Specification	Bright, No Plating	Manufacturer	Ruland Manufacturing
Temperature	Acetal Disk -10°F to 150°F (-23°C to 65°) Nylon Disk -10°F to 130°F (-23°C to 54°C) PEEK Disk -10°F to 300°F (-23°C to 148°C)	Weight (lbs)	0.087700
Tariff Code	8483.60.8000	UNSPC	31163015
Note 1	"Performance ratings are for guidance only. The user must determine suitability for a particular application."		
Note 2	"Torque ratings for the couplings are based on the physical limitations/failure point of the torque disks. Under normal/typical conditions the hubs are capable of holding up to the rated torque of the disks. Please consult technical support for more assistance."		
Prop 65	⚠️ WARNING This product can expose you to the chemical Nickel (metallic), known to the State of California		

Installation Instructions

1. Align the bores of the MOCC25-10-SS oldham coupling hubs on the shafts that are to be joined and determine if the misalignment parameters are within the limits of the coupling. (*Angular Misalignment: 0.5° Parallel Misalignment: 0.008 in (0.20 mm), Axial Motion: 0.004 in (0.10 mm)*)
 2. Rotate the hubs on the shaft so the drive tenons are located 90° from each other.
 3. Place a torque disk so one groove fits over the drive tenons of a hub and center the disk by hand.
 4. Insert a shim with the thickness of the coupling's axial motion rating into the groove of the torque disk.
 5. Slide the tenons of the second hub into the mating groove in the disk until it touches the shim stock.
 6. Fully tighten the M3 screw(s) on each hub to the recommended seating torque of 1.1 Nm using a 2.5 mm hex torque wrench.
 7. Remove the shim stock to leave a small gap between the top of the drive tenons and the torque disk to allow for axial movement.
-