

REV	ECN NUMBER	DR	DATE
A	---	ERIC	2013-05-13

NOTE:

1. Material:

HOUSING: HIGH TEMPERATURE THERMOPLASTIC,
UL 94 V-0 FLAME RETARDANT.

TERMINAL: HIGH CONDUCTIVITY COPPER ALLOY.

PLATING SPEC AS BELOW:

Ni 50u" UNDER PLATED.

Au 30u" OVER CONTACT AREA.(ONE SIDE)

Matte Tin 120u" OVER SOLDERING AREA.)

2. PACKING SPEC. GS-14-937.

3. PRODUCT SPEC. GS-12-338.

4. PART NUMBER SCHEME:(EX. 10046971-031 LF)

5. PART NUMBER 10046971-024LF MEETS EUROPEAN UNION DIRECTIVE AND OTHER COUNTRY
REGULATIONS AS DESCRIBED IN GS-22-008.

THE HOUSING WILL WITHSTAND EXPOSURE TO 260°C PEAK TEMPERATURE FOR 10 SECONDS IN A
WAVE SOLDER APPLICATION WITH A CIRCUIT BOARD.

LEAD FREE

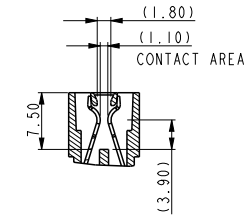
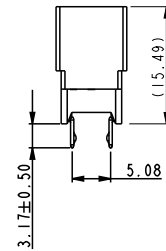
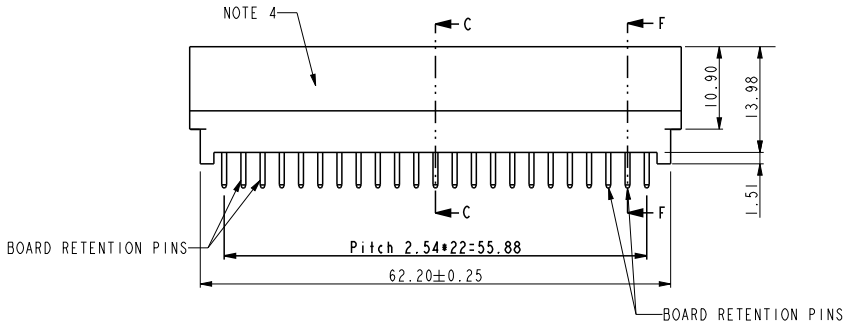
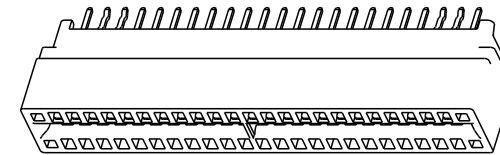
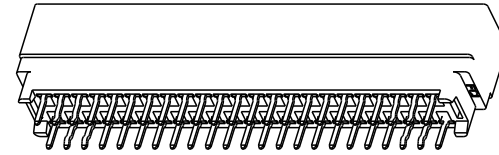
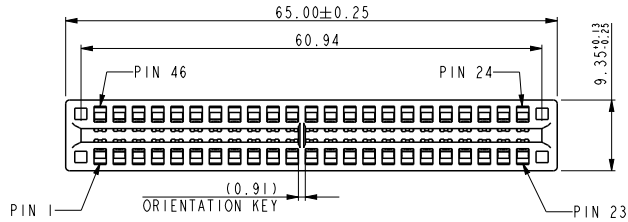

SECTION C-C



BOARD RETENTION PINS
SECTION F-F

spec ref	*	dr	Wei-Long Zhang	2011/06/30	projection	mm	size	A4	scale	1.000
tolerance std	TOLERANCES UNLESS OTHERWISE SPECIFIED	eng	Eric Jiang	2013/05/15			ecn no	-	rel level	Released
ASME Y14.5		chr	-	-						
surface	linear	appr	Pei-Ming Zheng	2013/05/15	product family	PEC	rev	10046971-031	A	
ASME Y14.5	angular	www.fci.com	cat. no.	*	Product - Customer Drw	sheet 1 of 2				
	0.X	± 0.50								
	0.XX	± 0.25								
	0.XXX	± 0.13								
	0°	± 2°								



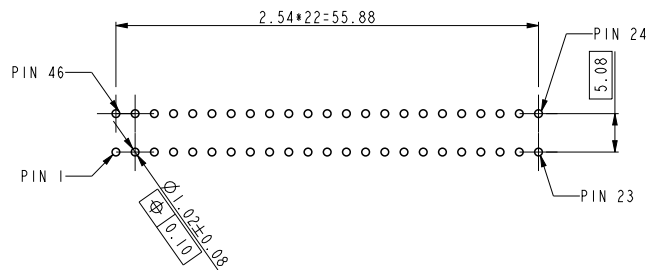
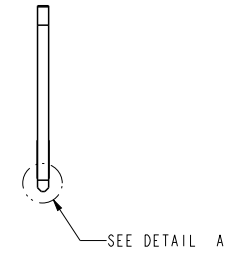
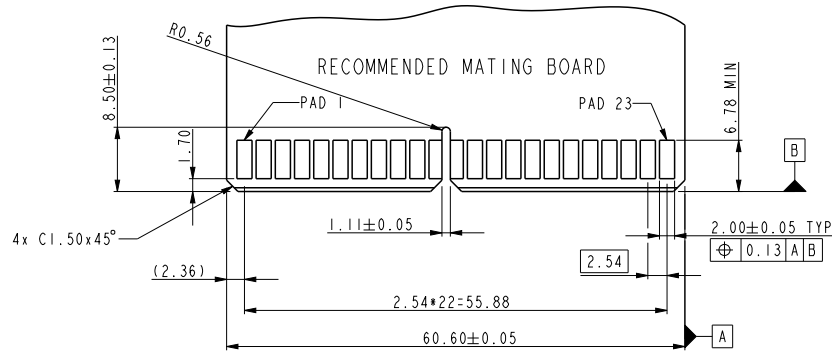

RECOMMENDED PC BOARD LAYOUT
AND THE THICKNESS IS 2.36mm

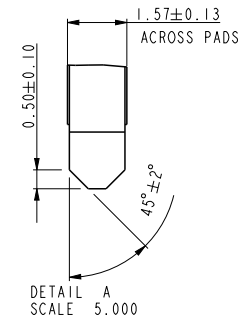

dr	Wei-Long Zhang	2011/06/30	projection 	mm ←→	size	A4	scale	1.000	
eng	Eric Jiang	2013/05/15			ecn no	-			
chr	-	-			rel level	Released			
appr	Pei-Ming Zheng	2013/05/15	product family	PEC					
	title	VERTICAL TYPE 23PX2 POWER EDGE CARD			dwg no	10046971-031		rev	A
www.fci.com	cat. no.	*	Product - Customer Drw			sheet 2 of 2			