

PRODUCT NUMBER

10029449-X01XLF

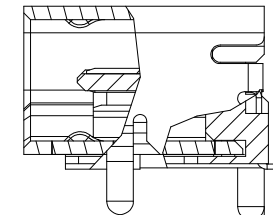
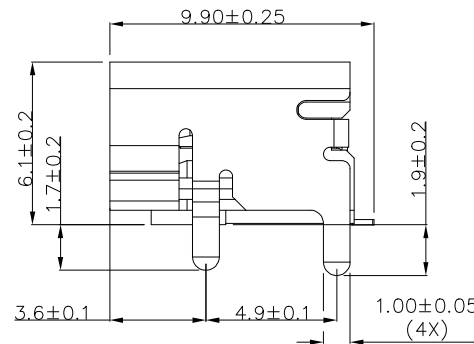
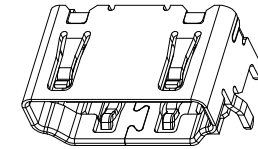
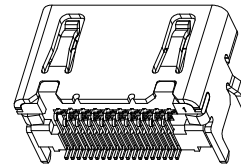
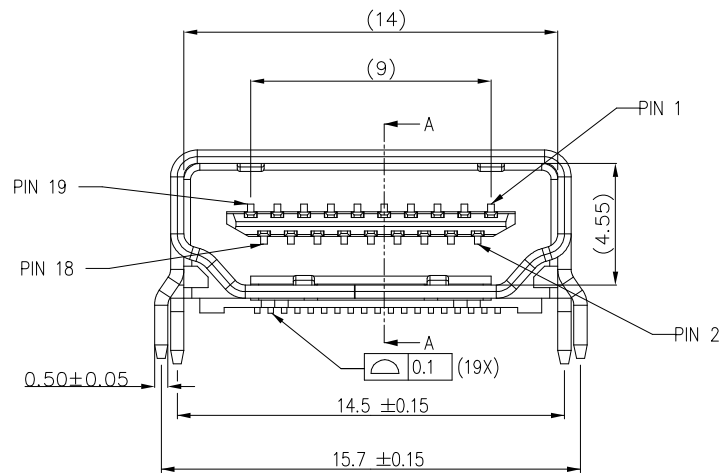
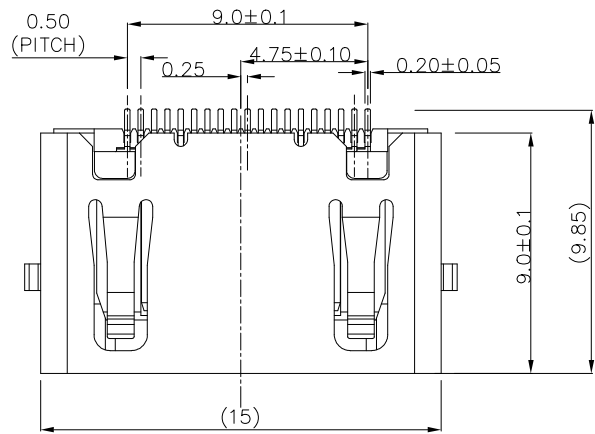

SECTION A-A

Amphenol FCI

© 2016 AFCI

mat'l. code		surface ISO 1302 ✓		tolerance ISO 406 ISO 1101		projection		product family	
ltr		ecn no		dr		date		HDMI	
W		ELX-N-34628		Jason		2019-08-27		title	
X		ELX-N-38366		Jason		2020-09-16		HDMI TYPE A RECEPTACLE	
Y		ELX-N-46981		TY		2022-01-11		scale 4:1	
dr		TONY LENG		2017-05-22		TY.Tang		2023-01-11	
chr		-		-		-		-	
appd		TIM YAO		2020-09-16		-		-	
sheet index		revision sheet		Y		1		-	



dwg no 10029449 sheet 1 of 5 size A3
type Product Customer Drawing

PRODUCT NUMBER
10029449-002XLF

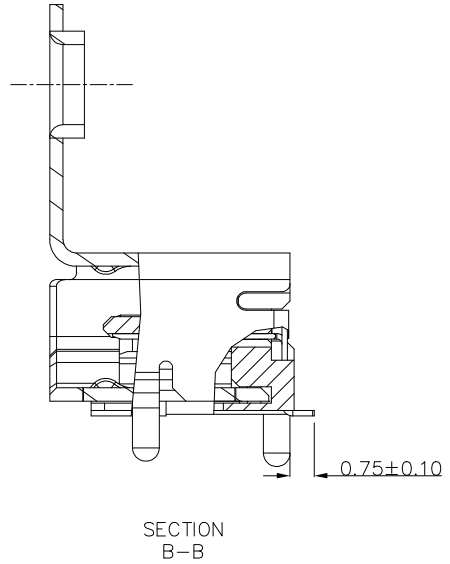
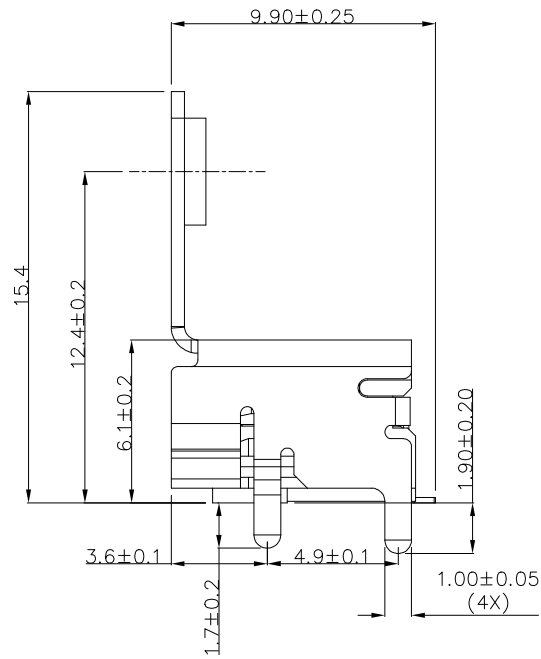
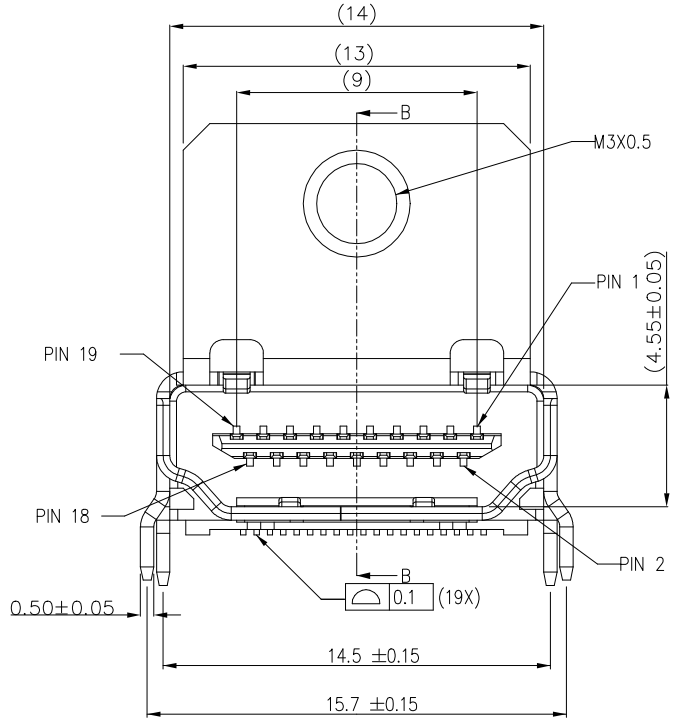
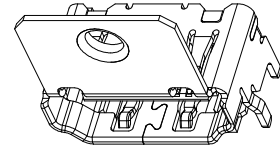
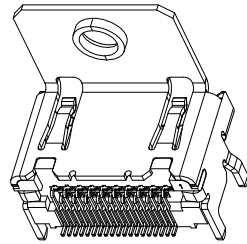
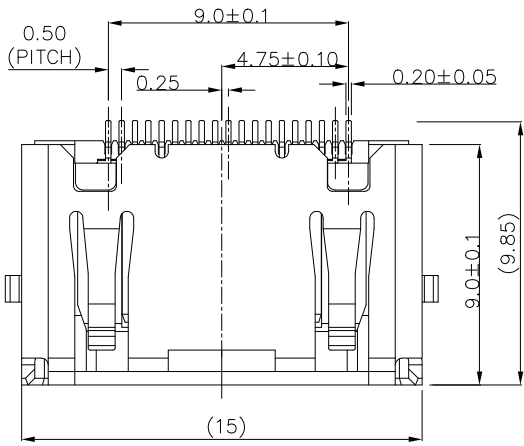

Amphenol
FCI

© 2016 AFCI

mat'l. code		surface ISO 1302 ✓		tolerance ISO 406 ISO 1101		projection 1101		product family HDMI		
ltr	ecn no	dr	date	tolerances unless otherwise specified		mm		title		
				angles	linear	mm		HDMI TYPE A RECEPTACLE		
				0°±x'	.X±.3 .XX±.15 .XXX±.05	scale 4:1		dwg no		
				dr	TY. Tang	2017-05-22		sheet 2 of 5		
				engr	-	2023-01-11		size		
				chr	-	-		A3		
				appd	TIM YAO	2020-09-16		type Product Customer Drawing		
sheet index	revision sheet	Y	2							

PRODUCT NO.	CONTACT AREA PLATING	SHIELD FIGURE	PACKING
10029449-001TLF	30u" GXT MINIMUM	WITHOUT FLANGE	TRAY
10029449-001RLF	30u" GXT MINIMUM	WITHOUT FLANGE	TAPE AND REEL
10029449-101TLF	GOLD FLASH 3u" MIN	WITHOUT FLANGE	TRAY
10029449-101RLF	GOLD FLASH 3u" MIN	WITHOUT FLANGE	TAPE AND REEL
10029449-002TLF	30u" GXT MINIMUM	WITH FLANGE	TRAY
10029449-002RLF	30u" GXT MINIMUM	WITH FLANGE	TAPE AND REEL
10029449-002FLF	GOLD FLASH 3u" MIN	WITH FLANGE	TAPE AND REEL

NOTE:

1.MATERIAL:

- 1-1 HOUSING: GLASS FIBER HIGH-TEMP. RESIN.(UL94V-0)
- 1-2 CONTACT: BRASS
- 1-3 SHELL: STEEL

2.FINISH

- 2-1 CONTACT: Ni UNDER PLATED ALL OVER 50u" MIN
CONTACT AREA SEE TABLE
- 2-2 SHELL: Ni 100u" MIN

3.PACKAGING:

PACKAGING SPECIFICATION GS-14-939

4.PRODUCT SPEC:

PRODUCT SPECIFICATION GS-12-309

5.RoHS STANDARD SPECIFICATION ACCORDING TO FCI GS-22-008

6.PARTS MEET REFLOW APPLICATION PEAK TEM. 260°C, 10 SECONDS MAX.

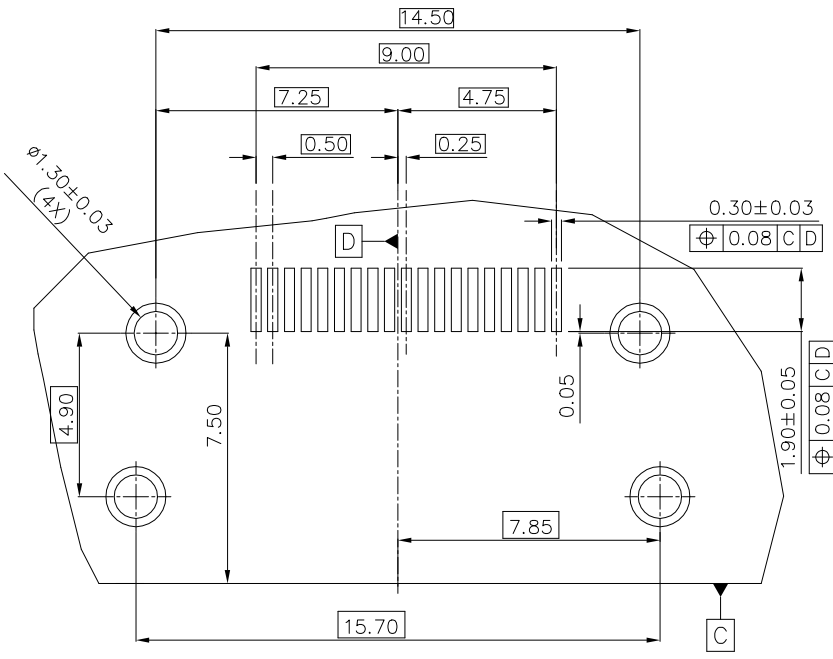

RECOMMENDED PCB PATTERN LAYOUT
(t=1.6mm)

mat'l. code		surface	tolerance	projection	product family
ISO 1302		ISO 406	ISO 1101	HDMI	
ltr	ecn no	dr	date	tolerances unless otherwise specified	title
				linear	HDMI TYPE A RECEPTACLE
				angles	
				0°±x'	mm
				.X±.3	scale 4:1
				.XX±.15	
				.XXX±.05	
		dr	TONY LENG	2017-05-22	dwg no
		engr	TY.Tang	2023-01-11	sheet 3 of 5
		chr	-	-	size
		appd	TIM YAO	2020-09-22	A3
					type Product Customer Drawing

sheet	revision	Y																		
index	sheet	3																		

PRODUCT NO.	CONTACT AREA PLATING	SHIELD FIGURE	DIM "A"	PACKING
10029449-111RLF	GOLD FLASH 3u" MIN	WITHOUT FLANGE	1.95±0.20	TAPE AND REEL
10029449-111FLF	GOLD FLASH 3u" MIN	WITHOUT FLANGE	1.95±0.20	TAPE AND REEL, OPPOSITE DIRECTION
10029449-113RLF	GOLD FLASH 3u" MIN	WITHOUT FLANGE	0.90±0.20	TAPE AND REEL

NOTE:
 1.MATERIAL:
 HOUSING: HIGH TEMP.THERMOPLASTIC, UL 94V-0
 COLOR: BLACK.
 CONTACT: PHOSPHOR BRONZE
 SHIELD: BRASS
 2.FINISH:
 SEE NOTES.
 3.TERMINAL RETENTION FORCE TO BE 0.3kgf MIN.
 4.TERMINAL CUT-OFF BURR TO BE 0.05MAX.

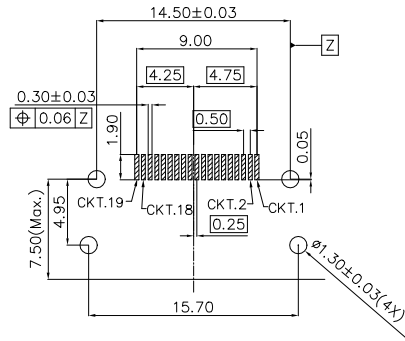
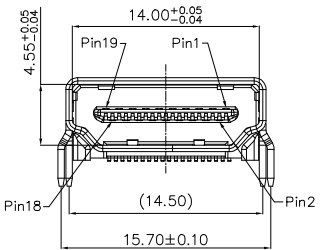
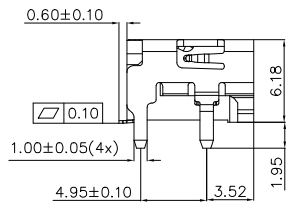
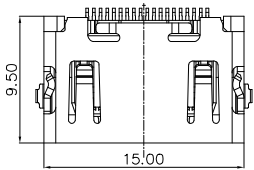

Recommended PCB Layout Connector Side
 (General Tolerance: ±0.05)

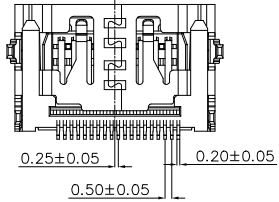

mat'l. code		surface ISO 1302 ✓		tolerance ISO 406 ISO 1101		projection		product family	
ltr		ecn no		dr		date		HDMI	
X		ELX-N-38366		Jason		2020/9/16		title	
				tolerances unless otherwise specified		mm		HDMI TYPE A RECEPTACLE	
				angles		linear		scale 2:1	
				0°±x'		.X±.3		sheet 4 of 5	
				dr		TONY LENG		2017-05-22	
				engr		TY.Tang		2023-01-11	
				chr		-		Amphenol FCI	
				appd		TIM YAO		2020-09-16	
sheet index		revision sheet		Y		4		dwg no	
								10029449	
								type Product Customer Drawing	
								size A3	

Amphenol FCI

© 2016 AFCI

PRODUCT NO.	CONTACT AREA PLATING	SHIELD FIGURE	PACKAGING
10029449-112TLF	GOLD FLASH 3u" MIN	WITH FLANGE	TRAY
10029449-112RLF	GOLD FLASH 3u" MIN	WITH FLANGE	TAPE AND REEL

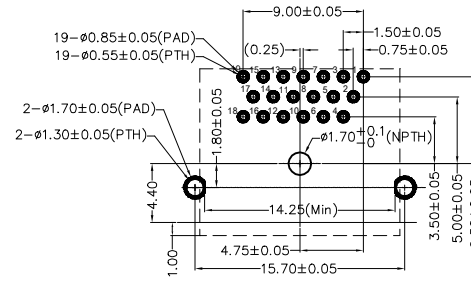
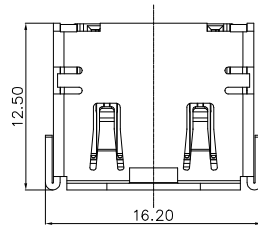

RECOMMENDED PCB LAYOUT($t=1.60\pm 0.15$)
COMPONENT SIDE

NOTE:

1.MECHANICAL CHARACTERISTICS

- INSERTION FORCE: 44.1N MAX
- WITHDRAWAL FORCE: 9.8N MIN, 39.2N MAX
- MATING CYCLE:10000 CYCLES
- CONTACT PULL OUT FORCE: 1.96N/PIN MIN

2.ELECTRICAL CHARACTERISTICS

- RATING CURRENT: 0.5A
- RATING VOLTAGE: 40V
- CONTACT RESISTANCE: 10 MILLOHMS OHMS MAX (EXCLUDING CONDUCTOR RESISTANCE)
- INSULATION RESISTANCE:
 - a, UNMATED: 100M OHMS MIN AT 500 VDC
 - b, MATED: 10M OHMS MIN AT 150 VDC
- DIELECTRIC WITHSTANDING VOLTAGE: 300V AC/1MINUTE
- OPERATING TEMPERATURE: -20°C--+85°C
- STORAGE TEMPERATURE: -20°C--+65°C

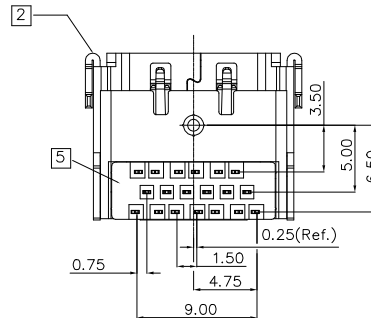
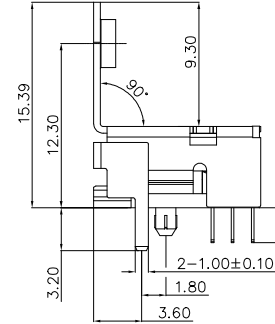
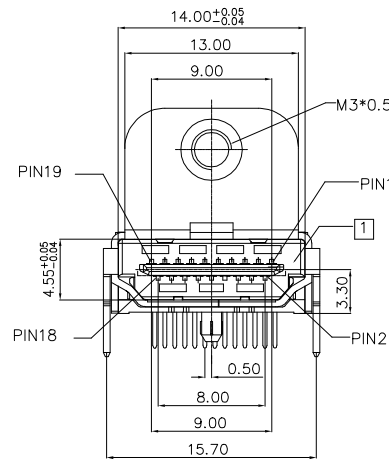
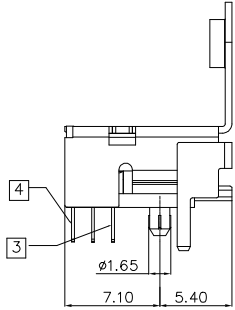

mat'l. code	surface ISO 1302 ✓	tolerance ISO 406 ISO 1101	projection	product family
ltr	ecn no	dr	date	HDMI
				title
				HDMI TYPE A RECEPTACLE
				angles linear
				.X±.3
				.XX±.15
				.XXX±.05
				scale 2:1
				dr TONY LENG 2017-05-22
				engr TY.Tang 2023-01-11
				chr -
				appd TIM YAO 2020-09-16
sheet	revision	Y		Amphenol FCI
index	sheet	5		dwg no 10029449 sheet 5 of 5 size A3
				type Product Customer Drawing