

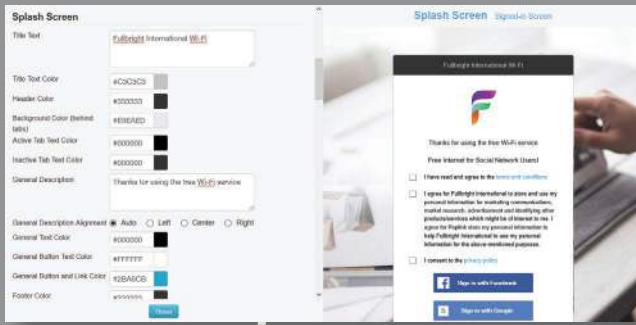

# Turnkey or Custom Captive Portals

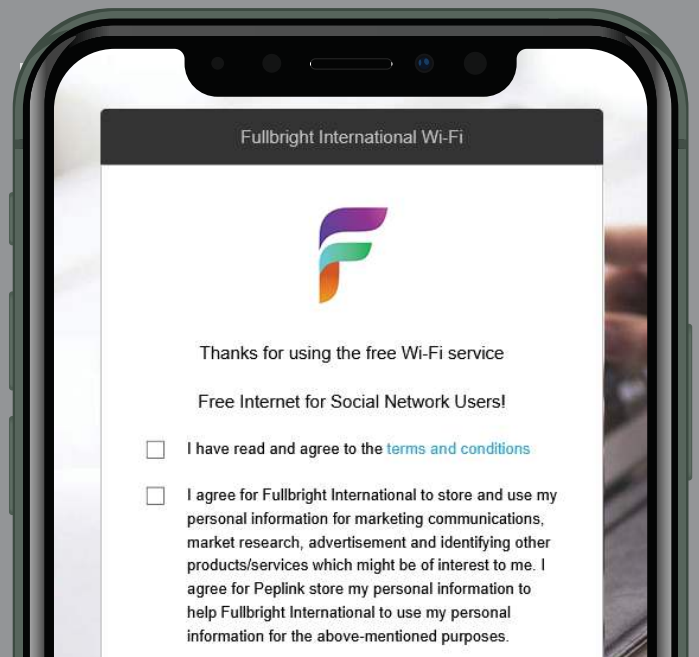

Offer users a more branded experience by customizing captive portals through InControl.

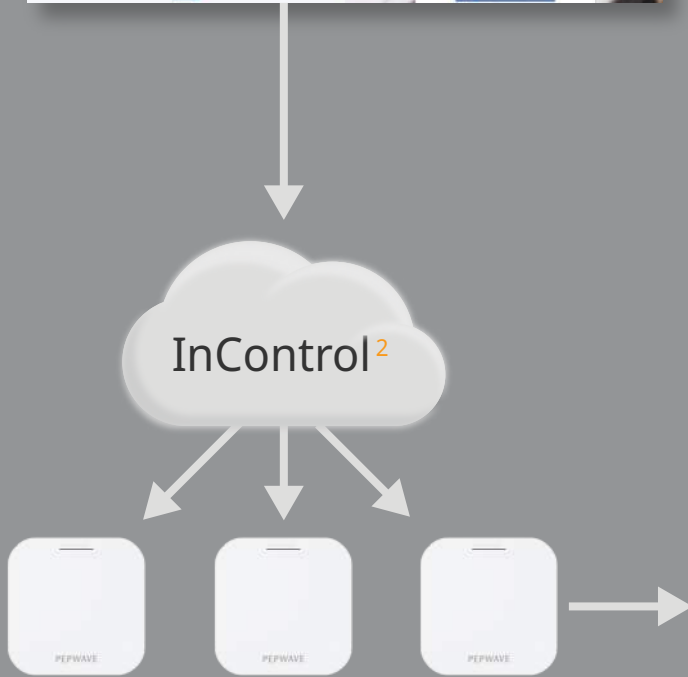

## Wi-Fi Just Got Better

Integrated Wi-Fi 6 is 45% faster than the average Wi-Fi 5, has 4 more device capacity and consumes less power for connected devices.

**Enterprise-Grade Roaming Speeds**  
Supports 802.11k/v/r, providing users a seamless roaming experience between access points.



# Seamless Peplink SD-WAN Integration

Effortlessly integrate Peplink solutions with **AP One AX Lite** to provide unique network capabilities and network flexibility, making the whole experience more user friendly.

## Centrally Managed with InControl

Monitor network health on a single dashboard. Push configuration profiles on multiple devices at once. Remotely access the Web Admin of any device.

## Balance/MAX/FusionHub

Provides unbreakable connectivity by combining multiple WANs. Works with InControl to centralize VLAN, firewall, and outbound policies.

## SD-Switch

Works with InControl to remotely configure and activate PoE ports. Monitor power consumption.

## AP One

Works with InControl to centralize SSIDs, radio settings, and deliver captive portals.

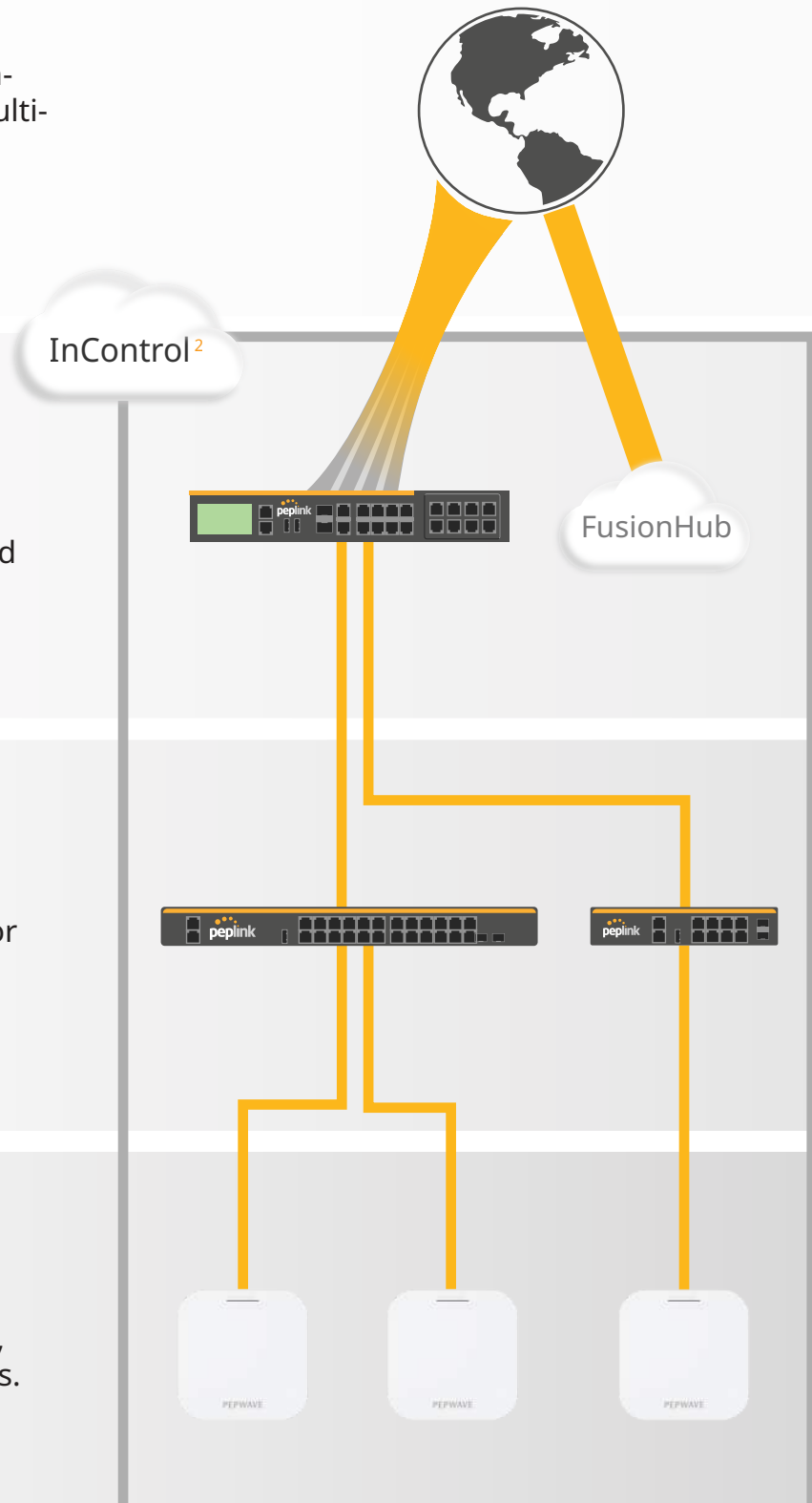

# AP One AX Lite

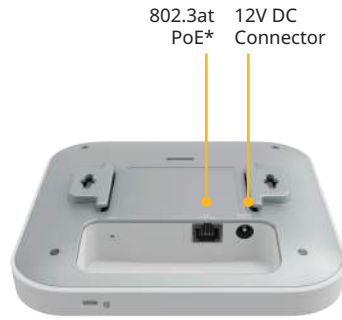

## Specifications

<b>Ethernet Ports</b>	1 x 1 Gbps Gigabit Ethernet	<b>Network</b>	Bridge Mode Router (NAT) Mode Mesh Wireless Distribution System (WDS) Support for PPPoE, Static IP, DHCP Management VLAN Spanning Tree Protocol
<b>Wi-Fi Standard</b>	Simultaneous 1 x 2.4GHz 802.11b/g/n/ax 1 x 5GHz 802.11a/n/ac/ax	<b>Radio</b>	Multiple SSID Auto Channel Selection Transmit Power Adjustment Neighbor AP Detection
<b>Radio Chains/Streams</b>	2 x 2:2	<b>AP Security</b>	Open WPA/WPA2/WPA3-Personal WPA/WPA2-Enterprise
<b>Data Rates</b>	2.4 GHz: up to 574 Mbps 5 GHz: up to 1200 Mbps	<b>Device Management</b>	Web Administrative Interface InControl Cloud Management Peplink AP Controller SNMP v1, v2c and v3
<b>Channel Width</b>	20/40/80 MHz	<b>Client Management</b>	Per SSID VLAN with QoS (802.1p/802.1q) Bandwidth Control MAC Address Filtering Layer 2 Client Isolation Limit on Max. Number of Clients
<b>Recommended clients per Radio</b>	256		Per Client VLAN with RADIUS VLAN with VLAN Pool Bandwidth Control Multicast Filter IGMP Snooping/Multicast Enhancement
<b>SSID Per Radio</b>	16	<b>Captive Portal by InControl</b>	
<b>Transmit Power</b>	2412 – 2472 MHz: 24dBm 5180 – 5825 MHz: 25dBm	<b>Package Contents</b>	AP One AX Lite, Ceiling Mount Base (9/16" T-Rail), Ceiling Mount Base (15/16" T-Rail), Mounting Screw Set
<b>Antenna</b>	Built-in Omni antenna: 2 x 3dBi - 2.4GHz 2 x 3dBi - 5GHz		
<b>Enclosure</b>	Plenum-rated enclosure		
<b>Dimensions</b>	5.9 x 5.9 x 1.3 inches 160 x 160 x 33 mm		
<b>Weight</b>	0.84 pounds / 382 grams		
<b>Power Input</b>	12V DC Jack (Plug 5.5 x 2.1 mm, center positive)* 802.3af PoE*		
<b>Power Consumption</b>	14.5W (max.)		
<b>Operating Temperature</b>	32°F - 104°F 0°C - 40°C		
<b>Certifications</b>	FCC, CE, RoHS		
<b>Warranty</b>	1 Year Limited Warranty		

\* AC/DC adapter and PoE Injector are not included.

## Ordering information

Product Code	Description
APO-AX-LITE	2 x 2 MU-MIMO Wi-Fi 6 AP for business, manageable by InControl. Simultaneous Dual-Band 802.11ax/ac/b/g/n

## Feature Add-on

Product Code	Description
ACW-107	802.3af/at PoE Injector. Compatible with MAX Hotspot and AP One AX Series
ACW-602	1x12V3A Power Supply. Compatible with MAX HD2 and AP One AX Series