

REV.	DATE	DESCRIPTION
NC	06/06/04	INITIAL RELEASE

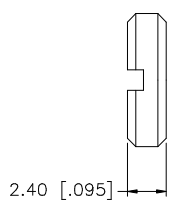
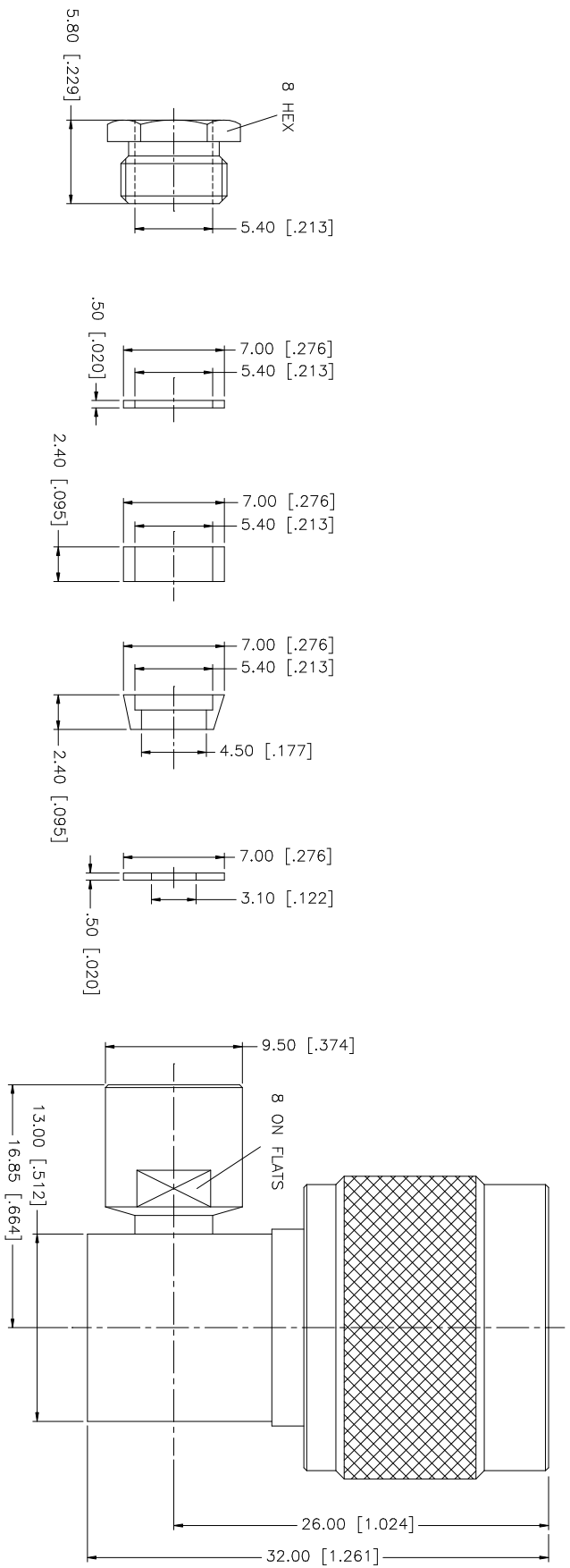

NOTE:
1. CONTACT PIN TO SOLDER

QTY	FINISH	MATERIAL	DESCRIPTION
1	NEXCOTE	BRASS	8 NUT
1	NEXCOTE	BRASS	7 END CAP/ HEX NUT
1	NEXCOTE	BRASS	6 WASHER
1	RED	SILICONE	5 GASKET
1	NEXCOTE	BRASS	4 WASHER
1	GOLD	BRASS	3 CONTACT PIN
1	NATURAL	TEFLON	2 INSULATOR
1	NEXCOTE	BRASS	1 SHELL/BODY

APPROVALS	DATE
DRAWN G.R.S.	06/06/04
CHECKED	
ISSUED	
SHEET 1 OF 1	

PART NO.	DWG. NO.	REV.	SIZE	SCALE
172316	172316.DWG	NC	A	NA

DO NOT SCALE DRAWING	UNLESS OTHERWISE SPECIFIED DIMENSIONS ARE IN MILLIMETERS DIMENSIONS IN [] ARE IN INCHES AND FOR CUSTOMER REFERENCE ONLY.
UNLESS OTHERWISE SPECIFIED TOLERANCES FOR MILLIMETERS ARE: 0.5 - 8mm ± 0.20mm 8 - 30mm ± 0.40mm 30 - 120mm ± 0.50mm	UNLESS OTHERWISE SPECIFIED TOLERANCES FOR INCHES ARE: .020 - .315 = ± 0.007" .315 - 1.180 = ± 0.015" 1.180 - 4.724 = ± 0.020"

Amphenol Connex

N R/A CLAMP PLUG
(FOR RG58C/U, 58/U, 142A/U, 223/U)