

THIS DRAWING IS UNPUBLISHED. RELEASED FOR PUBLICATION
 © COPYRIGHT 19 BY AMP INCORPORATED, HARRISBURG, PA. ALL INTERNATIONAL RIGHTS RESERVED. AMP PRODUCTS MAY BE COVERED BY U.S. AND FOREIGN PATENTS AND/OR PATENTS PENDING.

| LOC | | DIST | | P | | F | | ZONE | | LTR | | REVISIONS | | | |
|-----|--|------|--|---|--|---|--|------|--|-----|--|-------------|-----------------------|----------|-------|
| AF | | 58 | | | | | | | | | | DESCRIPTION | DATE | APPROVED | |
| | | | | | | | | | | | | D | REV & REL PER AF-7947 | 4/27/82 | JR/GY |

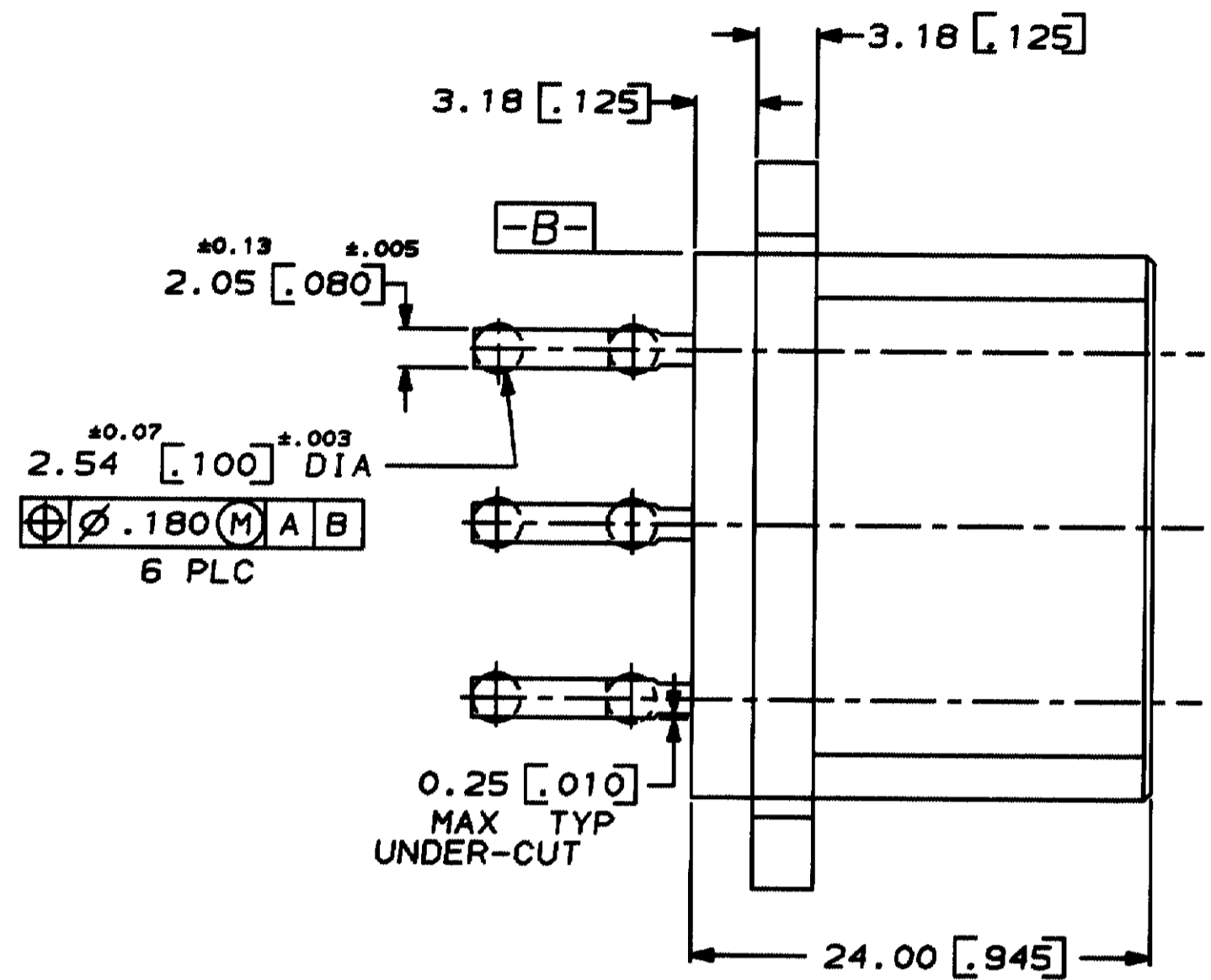

1 - DIMENSIONS IN BRACKETS ARE IN INCHES.

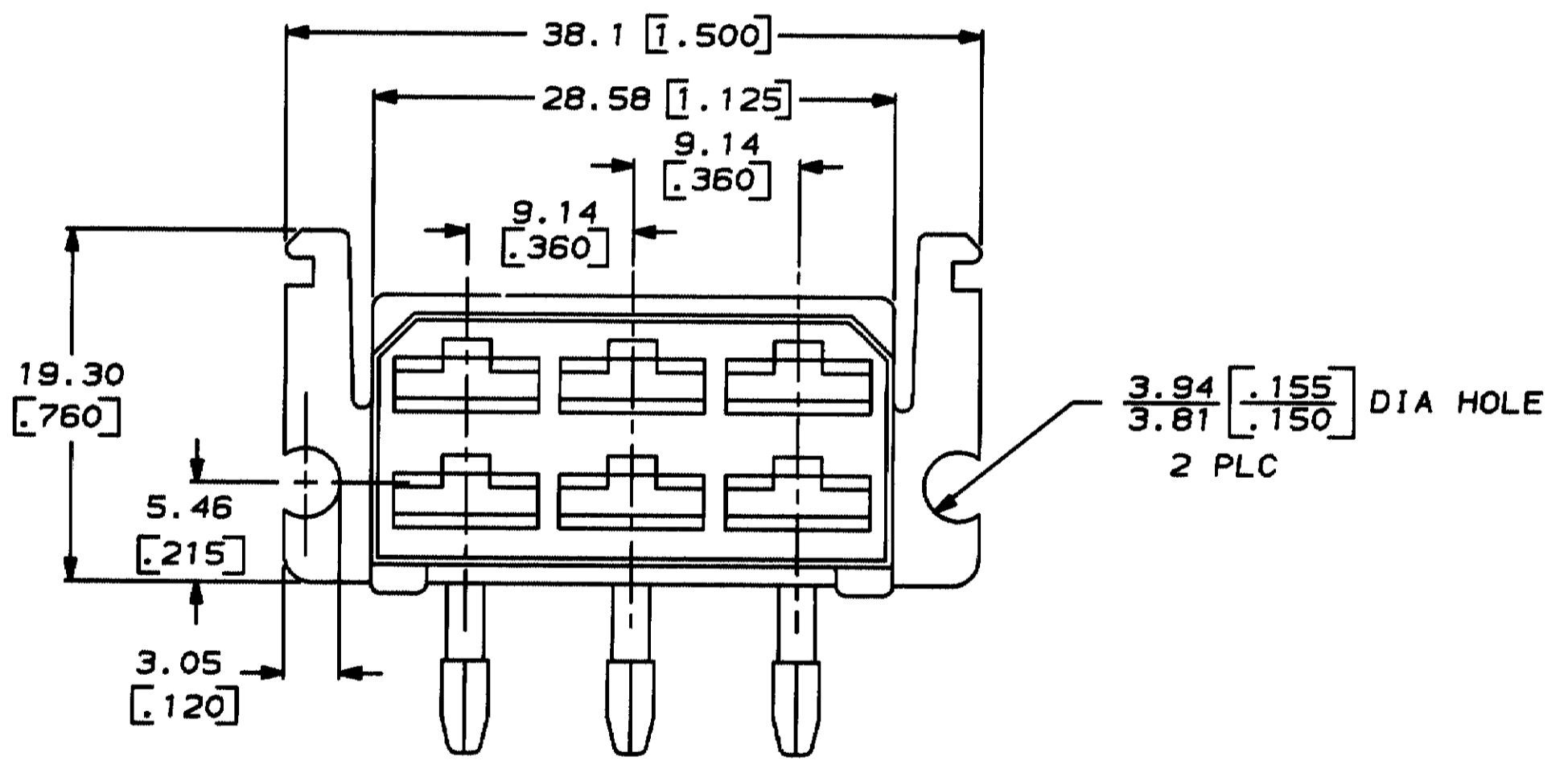
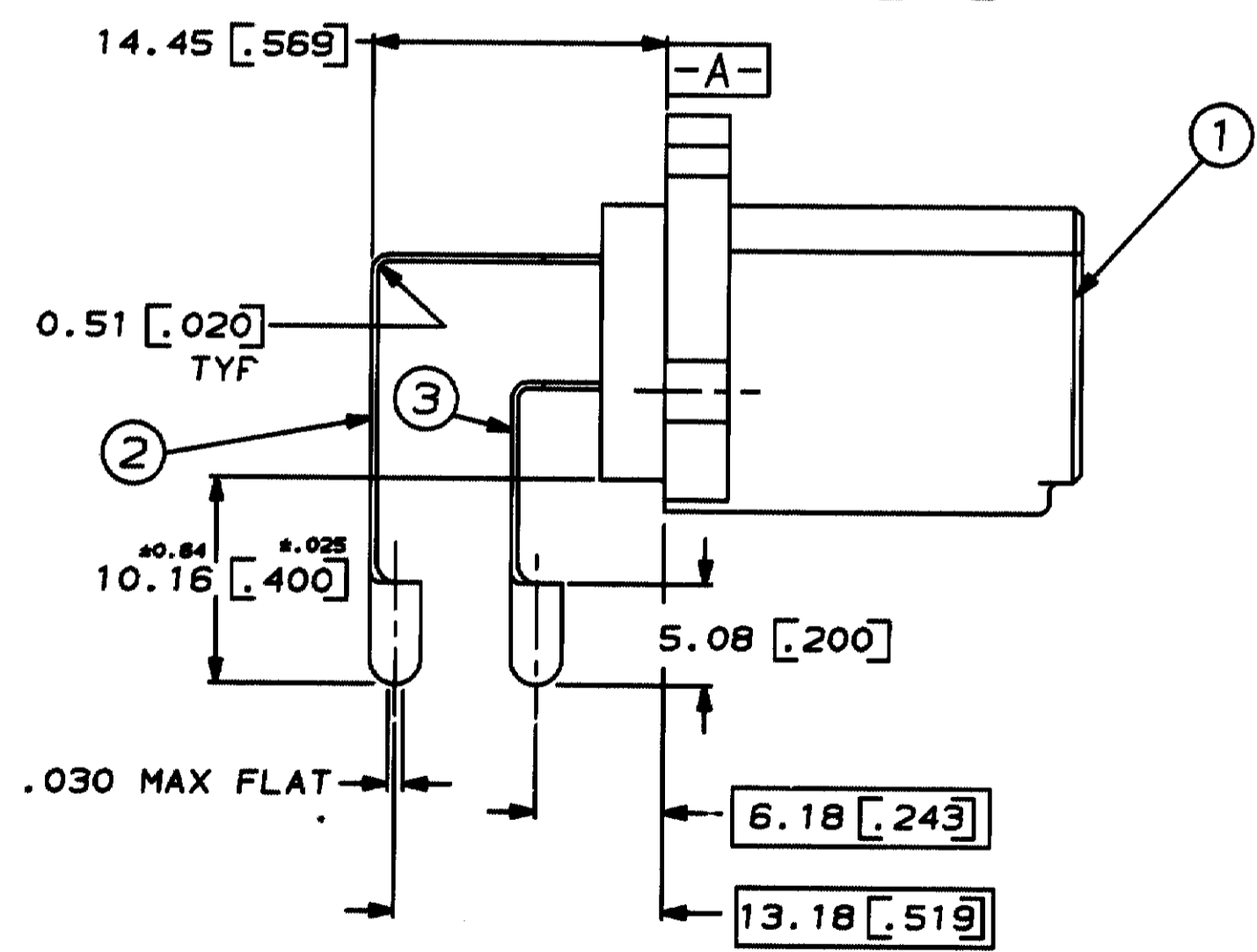

| FINISH | MATERIAL | QUANTITY | DESCRIPTION | ITEM NO |
|-----------------|--------------|----------|-----------------------------------|---------|
| TIN OVER COPPER | BRASS | 3 | .250 FASTIN-FASTON W/PIN | 3 |
| TIN OVER COPPER | BRASS | 3 | .250 FASTIN-FASTON W/PIN | 2 |
| NATURAL | NYLON 6/6 V2 | 1 | .250 6 CIRCUIT FASTIN-FASTON HSG. | 1 |
| FINISH | MATERIAL | -1 | DESCRIPTION | ITEM NO |

| | | | |
|---|-----------|--------------------------|--|
| UNLESS OTHERWISE SPECIFIED DIMENSIONS ARE IN INCHES TOLERANCES ON : | | DR 12/1/86 JR R' TH | |
| 2 PL DEC ± - | | CHK 12/1/86 MS FEHER | |
| 3 PL DEC ± 0.25 [0.010] | | APPD 12/1/86 J GILLESPIE | |
| ANGLES ± - | | APPD 12/1/86 R KUZO | |
| MATERIAL | SEE TABLE | PRODUCT SPEC | |
| FINISH | SEE TABLE | APPLICATION SPEC | |
| WEIGHT | - | - | |

| | | |
|---|---------------|-------------------|
| AMP INCORPORATED Harrisburg, Pa. 17105 | | |
| NAME RECEPTACLE ASS'Y, FASTIN-FASTON, .250 SERIES PCB MOUNT, 6 POSITION | | |
| SIZE C | FSCM NO 00779 | DRAWING NO 520875 |
| SCALE NTS | SHEET 1 OF 1 | |

METRIC