

Recommended P.C. Board Layout
SCALE 4:1

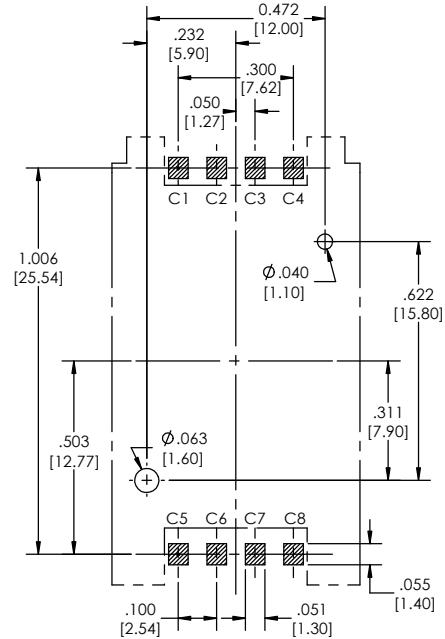

SIMS48 - - - - -
(A) (B) (C) (D) (E) (F)

- A. Number of Contacts
- 6 or 8
- B. Height
- See Height options below
- C. Switch
- 1= Without Switch
- D. Locating Peg
- 1= With Locating Peg
- 2= Without Locating Peg
- E. Packing Information
- C= Tube and Tray
- F= Reel
- F. Lead Free

	Height	
2.2mm	(1.170L X 0.677W X 0.087H inches)	22
	(29.70L X 17.20W X 2.20H mm)	

Specifications:

Weight: Approx. 0.80g
 Contact Principle: Landed Contact Technology
 Operating Position: Shaft up/ Down/ Horizontal
 Durability: 10,000 Cycles Min.
 Insulation Material: Thermoplastic, U194V-0
 Contact Material: Gold Plating with 3µ Min.
 Contact Resistance: 50mΩ typical/ 100mΩ Max.
 Insulation Resistance: >1000 MΩ/ 500 VDC
 Wave: N/A
 VaporPhase: 215°C, 30 sec. Max.
 IR Reflow: 230°C, 15 sec. Max.
 Manual Soldering: 360°C, 3 sec. Max.
 Operating Temperature: -40°C, +85°C
 Operating Humidity: 10% -95% RH

Storage Temperature: -40°C, +85°C
 Storage Humidity: 10% -95% RH
 Thermal Shock: -40°C, +85°C, 5 cycles
 Damp Heat: 40°C, 90% RH, 500HR
 Salt-Mist: 35°C, 5% NaCl, 48HR

Tails may be clipped to achieve specific dimensions.
 Products cut to specific sizes are uncancellable/ nonreturnable.
 Parts are subject to change without notice.

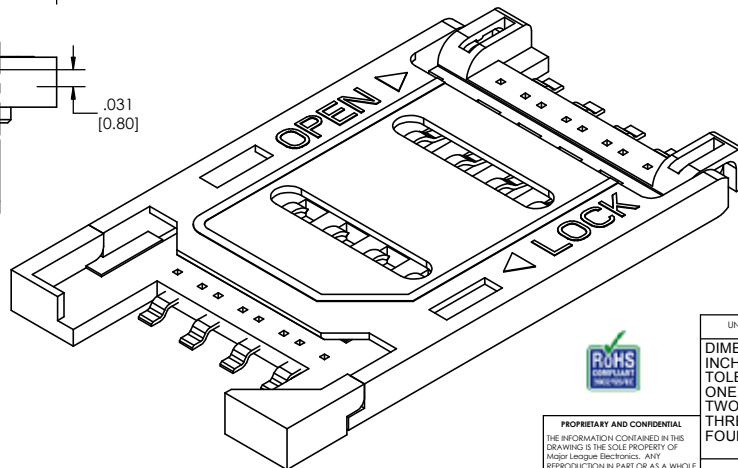

PROPRIETARY AND CONFIDENTIAL
 THE INFORMATION CONTAINED IN THIS DRAWING IS THE SOLE PROPERTY OF Major League Electronics. ANY REPRODUCTION IN PART OR AS A WHOLE WITHOUT THE WRITTEN PERMISSION OF Major League Electronics IS PROHIBITED.

UNLESS OTHERWISE SPECIFIED:		NAME	DATE		TITLE: SIMS48 Series		
DIMENSIONS ARE IN INCHES		DRAWN	EOW		04/08/14	SIZE	DWG. NO.
TOLERANCES:		CHECKED	GWE		04/08/14	C	REV A
ONE DECIMALS ±.100		ENG APPR.					
THREE DECIMAL ±.005		MFG APPR.			SCALE 6:1	SHEET 1 OF 1	
FOUR DECIMAL ±.002		ADDRESS:	2533 Centennial Blvd. Jeffersonville, IN 47130 Phone: 812-670-4174 Fax: 812-670-4175 E-Mail: mle@mlelectronics.com				
INTERPRET GEOMETRIC TOLERANCING PER:	MATERIAL:	FINISH:	APPLICATION		DO NOT SCALE DRAWING		