

THIS DRAWING IS UNPUBLISHED. RELEASED FOR PUBLICATION  
 © COPYRIGHT - By - TE CONNECTIVITY ALL RIGHTS RESERVED.

LOC		DIST		REVISIONS			
P	LTR	DESCRIPTION		DATE	DWN	APVD	
HB	-	G	CHANGE LOGO&ADD LINE IDENTIFICATION ECO-12-003498 &ADD CCC SYMBOL P-11-003756	02Nov2012	YS.H	BH.Y	

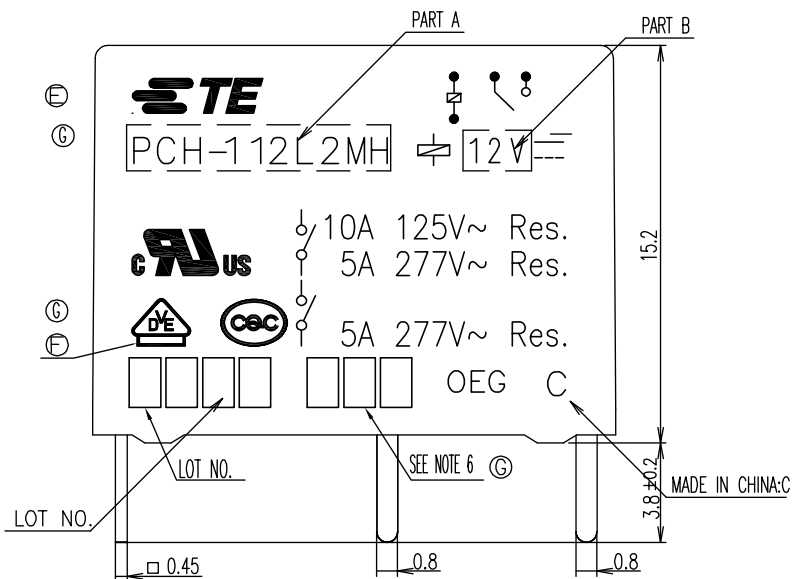

CONNECTION DIAGRAM (BOTTOM VIEW)

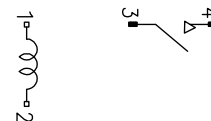

DRILLING DIAGRAM (BOTTOM VIEW)

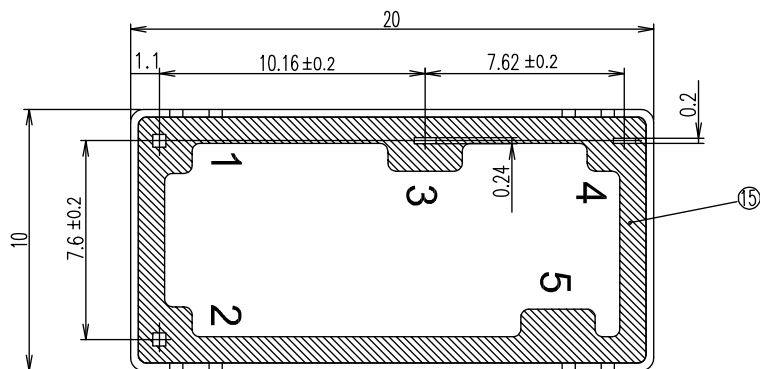
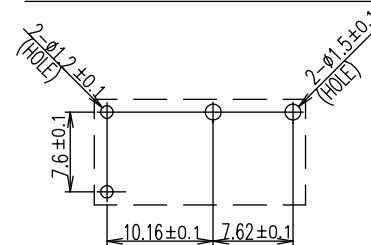

Diagram dimension	Tolerance
0.99mm max.	±0.1mm
1 - 2.99mm	±0.2mm
3mm min.	±0.3mm

THIS DRAWING IS A CONTROLLED DOCUMENT.		DWN	H.SASAKI		TE Connectivity
DIMENSIONS: mm		CHK	N.FUNAYAMA		
TOLERANCES UNLESS OTHERWISE SPECIFIED:		APVD	A.NAGAI		NAME
0 PLC ± -		PRODUCT SPEC	SEE PRODUCT SPEC		PCH-D2M CUSTOMER DRAWING
1 PLC ± -		APPLICATION SPEC	-		
2 PLC ± -		SIZE	CAGE CODE	DRAWING NO	RESTRICTED TO
3 PLC ± -		---	A3	00779	G= 1461351
4 PLC ± -		WEIGHT	-		---
5 PLC ± -		CUSTOMER DRAWING		SCALE	5:1
ANGLES ± -		SHEET		1 of 2	REV
FINISH		-			G

THIS DRAWING IS UNPUBLISHED. RELEASED FOR PUBLICATION  
 © COPYRIGHT - By - TE CONNECTIVITY ALL RIGHTS RESERVED.

LOC	DIST	REVISIONS					
HB	-	P	LTR	DESCRIPTION	DATE	DWN	APVD
		-	-	SEE SHEET 1	-	-	-

107-79019	1461351-7	PCH-148D2MH	108-79657	48V	PCH-148D2MH	g
	1461351-6	PCH-124D2MH	108-79656	24V	PCH-124D2MH	f
	1461351-5	PCH-112D2MH	108-79655	12V	PCH-112D2MH	e
	1461351-4	PCH-109D2MH	108-79654	9V	PCH-109D2MH	d
	1461351-3	PCH-106D2MH	108-79653	6V	PCH-106D2MH	c
	1461351-2	PCH-105D2MH	108-79652	5V	PCH-105D2MH	b
1461351-1	PCH-103D2MH	108-79651	3V	PCH-103D2MH	a	
PACKAGE SPEC	TE PART NO	TE TYPE NAME	PRODUCT SPEC	PART B	PART A	TYPE

RELAY TYPE

NOTES:

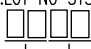
- 1.LAST SUFFIX NON : WASHABLE TYPE
- 2.LOT NO SYSTEM AS FOLLOWING:  

WEEK  
YEAR

6.ADD LOT NO. SYSTEM AS FOLLOWING;



- I, DIGITS FOR DAY OF THE WEEK  
 1...MONDAY IN THIS WEEK;  
 2...TUESDAY IN THIS WEEK;  
 .....  
 7...SUNDAY IN THIS WEEK
- II, DIGITS FOR SHIFT OF THE DAY  
 1...DAY SHIFT IN THIS DAY;  
 2...NIGHT SHIFT IN THIS DAY;
- III, ONE CHARACTER DISTINGUISH THE LINE IDENTITY, SUCH AS: A,B,....Z

- 3.TERMINAL DIMENSION IS BEFORE SOLDER DIP;
- 4.FOR THE TIN-PLATING OF THE PINS:  
 +0.1mm FOR WIDTH,THICKENSS AND DIAMETER.  
 +0.5mm FOR LENGTH.
- 5.MARKING FROM INK TO LASER.

		UV RESIN	UV SEAL(VENT HOLE)	16
		EPOXY RESIN	SEAL	15
CLASS E		UEW	MAGNETIC WIRE	14
	SOLDER DIP	CP WIRE	COIL TERMINAL	13
		Ag ALLOY	STATONARY CONTACT	12
		Ag ALLOY	MOVABLE CONTACT	11
		Cu ALLOY	HINGE SPRING	10
	SOLDER DIP	Cu ALLOY	NO TERMINAL	9
	SOLDER DIP	Cu ALLOY	MOVABLE SPRING	8
UL 94V-0		PA NYLON	CARD	7
UL 94V-0		PBT	CASE	6
UL 94HB		PA NYLON	BOBBIN	5
UL 94V-0		PBT	BASE	4
		Ni PLATED	STEEL CORE	3
		CuNi PLATED	STEEL ARMATURE	2
		CuNi PLATED	STEEL YOKE	1
INCOMBUSTIBILITY	TREATMENT	MATERIAL	DESCRIPTION	ITEM

THIS DRAWING IS A CONTROLLED DOCUMENT.		DWN	H.SASAKI	-												
		CHK	N.FUNAYAMA	-												
DIMENSIONS: mm		APVD	A.NAGAI	-												
TOLERANCES UNLESS OTHERWISE SPECIFIED:		PRODUCT SPEC	SEE PRODUCT SPEC													
<table border="0"> <tr><td>0 PLC</td><td>±-</td></tr> <tr><td>1 PLC</td><td>±-</td></tr> <tr><td>2 PLC</td><td>±-</td></tr> <tr><td>3 PLC</td><td>±-</td></tr> <tr><td>4 PLC</td><td>±-</td></tr> <tr><td>ANGLES</td><td>±-</td></tr> </table>		0 PLC	±-	1 PLC	±-	2 PLC	±-	3 PLC	±-	4 PLC	±-	ANGLES	±-	APPLICATION SPEC	-	
0 PLC	±-															
1 PLC	±-															
2 PLC	±-															
3 PLC	±-															
4 PLC	±-															
ANGLES	±-															
MATERIAL	FINISH	WEIGHT	-													
		SIZE	A3													
		CAGE CODE	00779													
		DRAWING NO	G= 1461351													
		RESTRICTED TO	-													
CUSTOMER DRAWING		SCALE	5:1													
		SHEET	2 of 2													
		REV	G													



PCH-D2M CUSTOMER DRAWING