

PART NUMBER	REV	FIRST USED
567921-1	A	854040-3

TERMINAL NAME: POST CONTACT					
VISIBLE PAD LTR	CRIMP HEIGHT	WIRE SIZE			
		A	.022 ± .002 [0.57 ± 0.05mm]	26	
B	.020 ± .002 [0.52 ± 0.05mm]	28			
C	.019 ± .002 [0.48 ± 0.05mm]	30			
D	NOT USED				
CRIMP WIRE	SIZE	TYPE	RANGE		
	.033 [0.80mm]	F	30-26		
INSUL	.046 [1.18mm]	F	ø.027-.038		
WIRE STRIP LENGTH	TERM APPL SPEC	FEED	APPL INSTRUCTION	SET UP GAGE	LAYOUT
-	114-5212	.315	SEE CUSTOMER MANUAL	NONE	L1779

REF	QTY	REV	DESCRIPTION	ITEM NO
				70
				69
				68
				67
				66
				65
				64
				63
				62
				61
				60
				59
				58
				57
				56
				55
				54
				53
				52
				51
				50
				49
				48
				47
				46
				45
				44
				43
				42
				41
				40
				39
				38
				37
				36
				35
				34
				33
				32
				31
				30
				29
				28
				27
				26
				25
				24
				23
				22
				21
				20
				19
				18
				17
				16
				15
				14
				13
				12
				11
				10
				9
				8
				7
				6
				5
				4
				3
				2
				1

QTY	REV	DESCRIPTION	ITEM NO
2	-	C 4-354779-4 PIN, WIRE DISC (.3210)D	129
2	-	C 3-354779-9 PIN, WIRE DISC (.3185)C	128
			127
2	-	C 4-354779-4 PIN, WIRE DISC (.3300)A	126
1	-	A 986950-1 WASHER, FLAT PRECISION	125
1	-	A 217238-3 GENERAL INSTRUCTION PACKAGE	124
			123
			122
1	-	A 4-21028-0 PIN, SLT SPR (ø.093x.75) ST GDE PL	121
1	-	B 690701-2 PLATE, SERIAL NO.	120
2	-	A 21899-2 WASHER, FLAT (#10) S G ADJ BLK	119
			118
2	-	A 21024-5 WASHER, LOCK (#10) ADJ BLOCK	117
			116
			115
2	-	A 21024-2 WASHER, LOCK (#4) FRONT STP GUIDE	114
REF	-	A 21024-4 WASHER, LOCK (#8) FEED FINGER	113
			112
2	-	A 21024-4 WASHER, LOCK (#8) HOLD DOWN	111
			110
			109
			108
			107
			106
			105
			104
1	-	A 21009-2 SCR, SKT SET (1/4-20x.25 LW) RAM	103
			102
4	-	A 21017-2 SCR, DRIVE (#2x.19) ID PLATE	101
1	-	B 819347-1 PLATE, IDENTIFICATION	100
2	-	A 3-21002-0 SCR, BHC (10-32x.88) DRAG	99
1	-	A 22733-8 SCR, BHC (8-32x.38 LW) ANVIL	98
			97
1	-	A 3-21000-8 SCR, SHC (10-32x.88) MOUNTING	96
1	-	A 2-21002-7 SCR, BHC (10-32x.50) S6 ADJ BLK	95
4	-	A 2-21002-2 SCR, BHC (8-32x.50) SHEAR-TERM SUP	94
2	-	A 2-21000-5 SCR, SHC (8-32x.50) TERM H DWN	93
			92
1	-	A 1-21002-7 SCR, SHC (6-32x.50) CAM	91
2	-	A 2-21000-7 SCR, SHC (8-32x.50) SCR BLK	90
			89
			88
			87
REF	-	A 2-22603-0 SCR, HEX HD (8-32x.31) FEED FINGER	86
2	-	A 1-21000-3 SCR, SHC (4-40x.25) F ST GUIDE	85
REF	-	A 22733-9 SCR, BHC (8-32x.50 SL) STRIPPER	84
			83
			82
1	-	A 3-22603-1 SCR, HEX (10-32x.38) S6 ADJ BL	81
			80
			79
			78
2	-	B 463310-9 BLADE, STRIPPING (#28)	77
			76
			75
1	-	A 690603-1 SPRING, ASSIST	74
1	-	A 23030-1 SCR, SKT CAP (6-32x.25) CP DSC	73
			72
			71

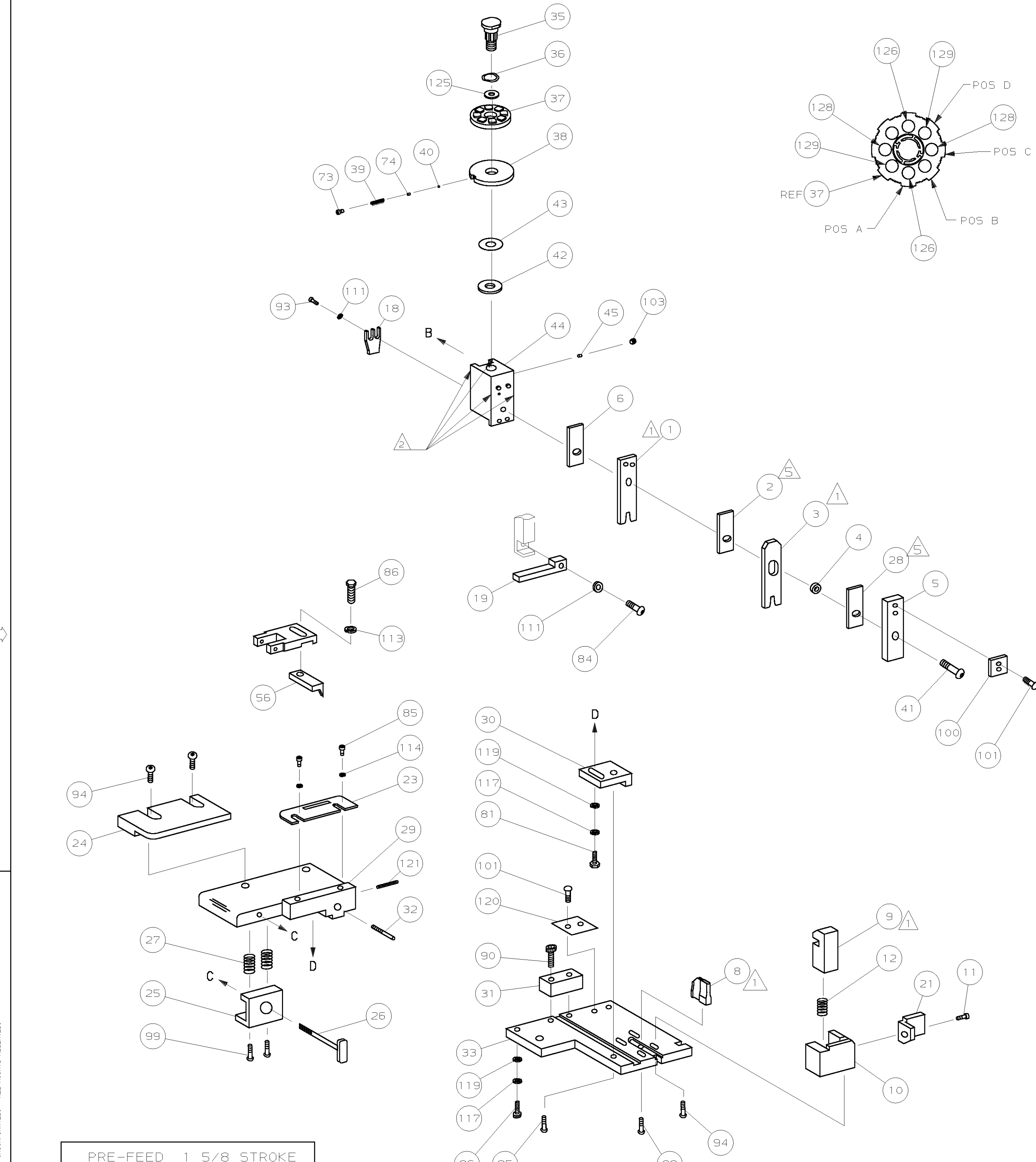

QTY	REV	DESCRIPTION	ITEM NO
-1	U/M	DWG SIZE	
		PART NO	
		DESCRIPTION	

QTY	REV	DESCRIPTION	ITEM NO
-1	U/M	DWG SIZE	
		PART NO	
		DESCRIPTION	

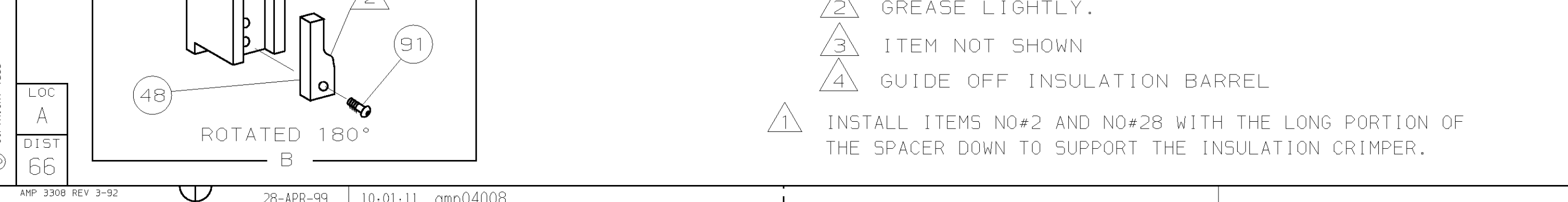

DIMENSIONS IN INCHES. DO NOT SCALE PRINT. TOLERANCES UNLESS OTHERWISE SPECIFIED:		MATERIAL		FINISH	
2 PLC DEC ±	3 PLC DEC ±	DR P.MATHIAS	5/30/96	HT TR	FIN
4 PLC DEC ±	ANGLES ±	CHK C.ERISMAN	6-5-96		
SURF TEXTURE: ✓	REMOVE BURRS, BREAK SHARP EDGES R.015 MAX	REL -	T.ELBIN		
NAME: STRIPPER CRIMPER APPLICATOR		MACHINE REF: STRIPPER CRIMPER			
SCALE: -	DWG NO: 567921	SHEET 1 OF 1		REV A	

THIS DRAWING IS A CONTROLLED DOCUMENT.

RELEASED FOR PUBLICATION 28-APR-99 BY AMP INCORPORATED. ALL RIGHTS RESERVED.

LOC A
DST 66

567921