

FOR -5, -6, -11 & -12 ONLY

DETAIL G
2 PLC

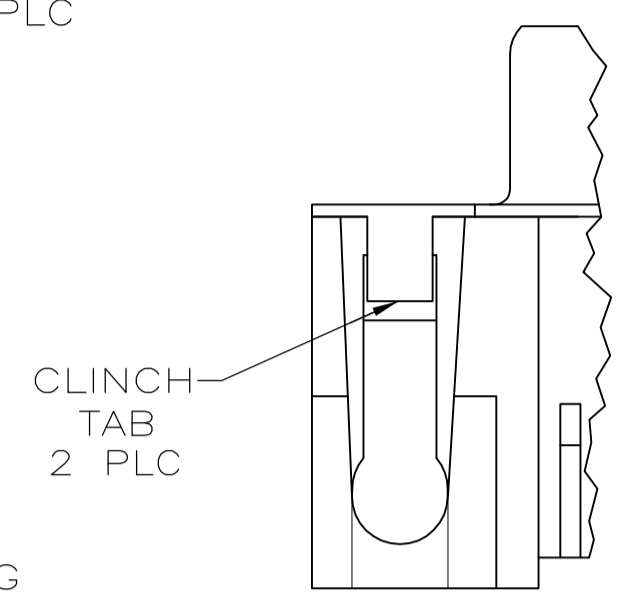
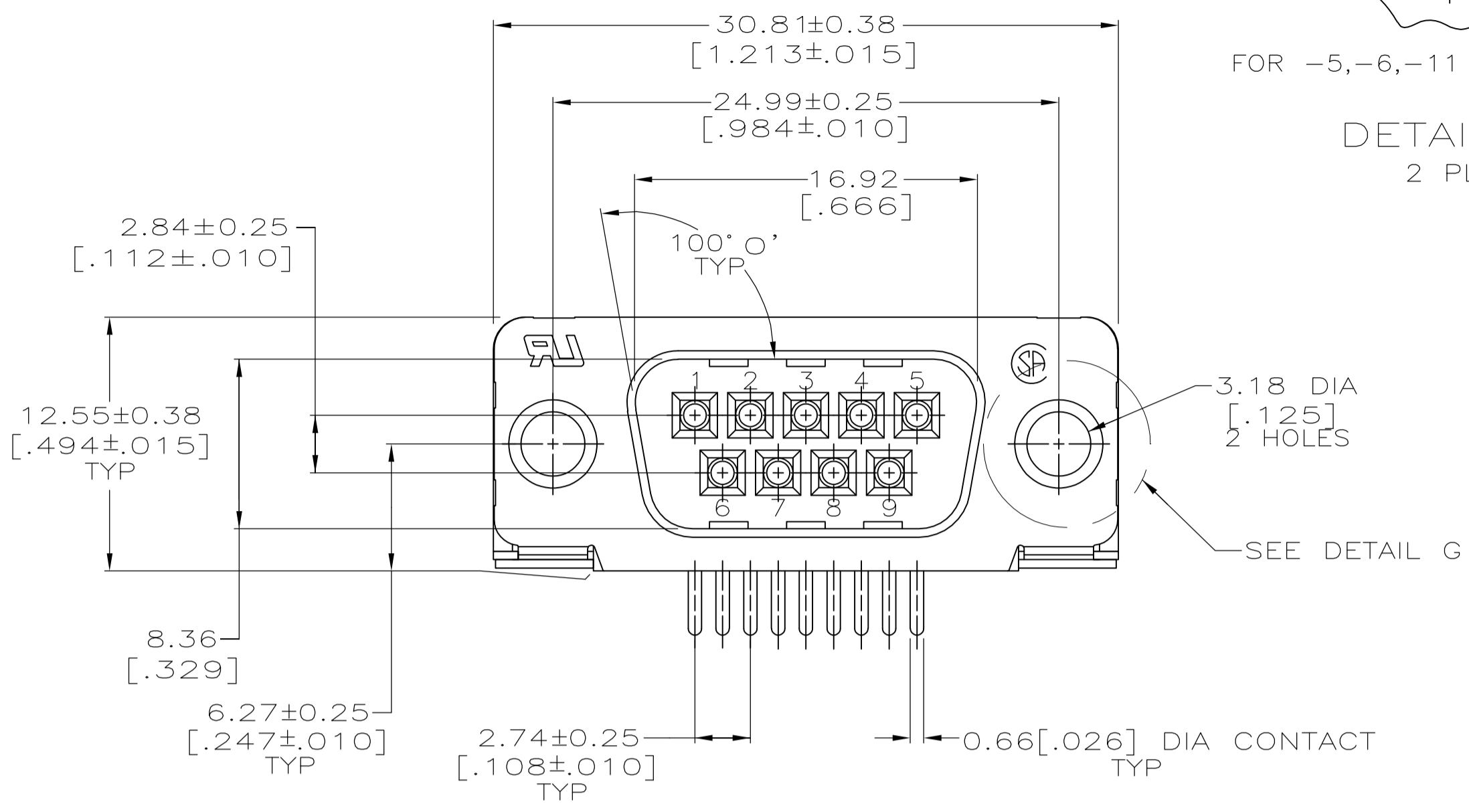

DETAIL B

- △ HOUSING: BLACK NYLON OR POLYESTER, FLAME RETARDANT, UL 94V-0 RATED, GLASS FILLED
- CONTACTS: BRASS
- SHELLS: CARBON STEEL
- EYELETS: BRASS
- △ GOLD FLASH ON THE MATING SURFACES, 2.54µm[.000100] MIN TIN OR TIN-LEAD PLATE ON THE SOLDER END, 1.27µm[.000050] MIN NICKEL UNDERPLATE ON THE ENTIRE CONTACT.
- △ 0.76µm[.000030] MIN GOLD PLATE ON THE MATING SURFACES, 2.54µm[.000100] MIN TIN OR TIN-LEAD PLATE ON THE SOLDER END, 1.27µm[.000050] MIN NICKEL UNDERPLATE ON THE ENTIRE CONTACT
- OR-
- GOLD FLASH OVER PALLADIUM-NICKEL PLATE, 0.76µm[.000030] MIN TOTAL ON THE MATING SURFACES, 2.54µm[.000100] MIN TIN OR TIN-LEAD PLATE ON THE SOLDER END, 1.27µm[.000050] MIN NICKEL UNDERPLATE ON THE ENTIRE CONTACT.
- △ SHELLS: 2.54µm[.000100] MIN TIN OVER 1.27µm[.000050] MIN COPPER
- EYELETS: 5.08µm[.000200] MIN TIN OVER COPPER FLASH
- CONTACTS: SEE TABLE
- SCREWLOCK AND INSERT: CLEAR CHROMATE
- △ THIS CONNECTOR IS COMPATIBLE WITH TYPICAL SURFACE MOUNT SOLDERING PROCESSES CONSISTING OF 418°F MAX TEMPERATURE AND 3 MINUTES MAX EXPOSURE TIME.
- △ SCREWLOCKS AND LOCKWASHERS FOR 1-747250-3 ASSEMBLY WILL BE BULK PACKED AND SHIPPED WITH ASSEMBLIES.
- △ OBSOLETE PART NUMBER.
- △ SUPERSEDED BY 747250-2.
- △ SUPERSEDED BY 747250-6.

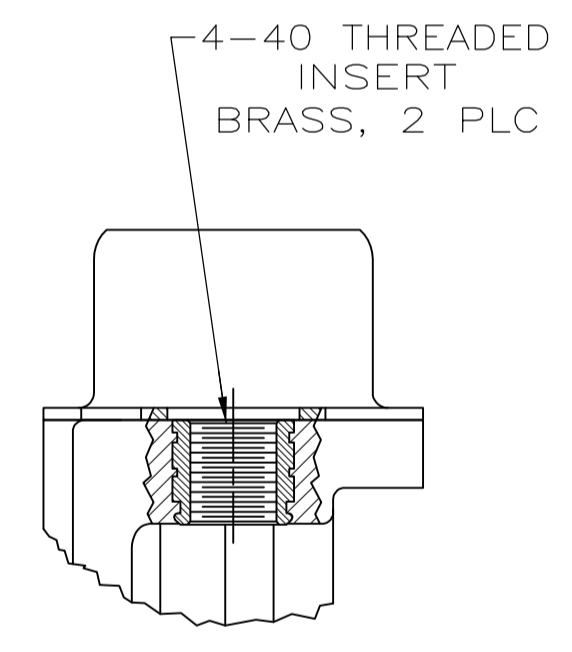
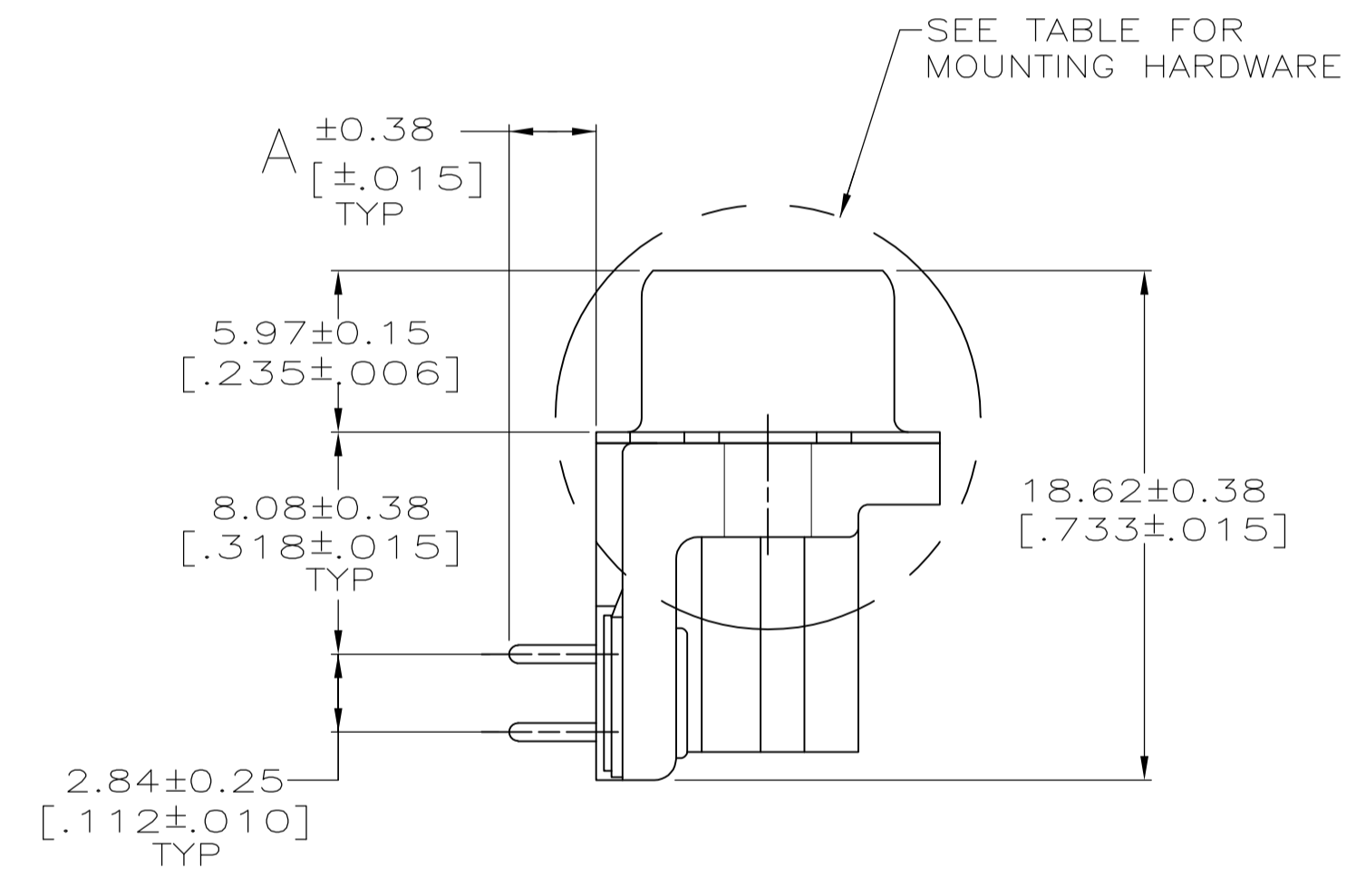
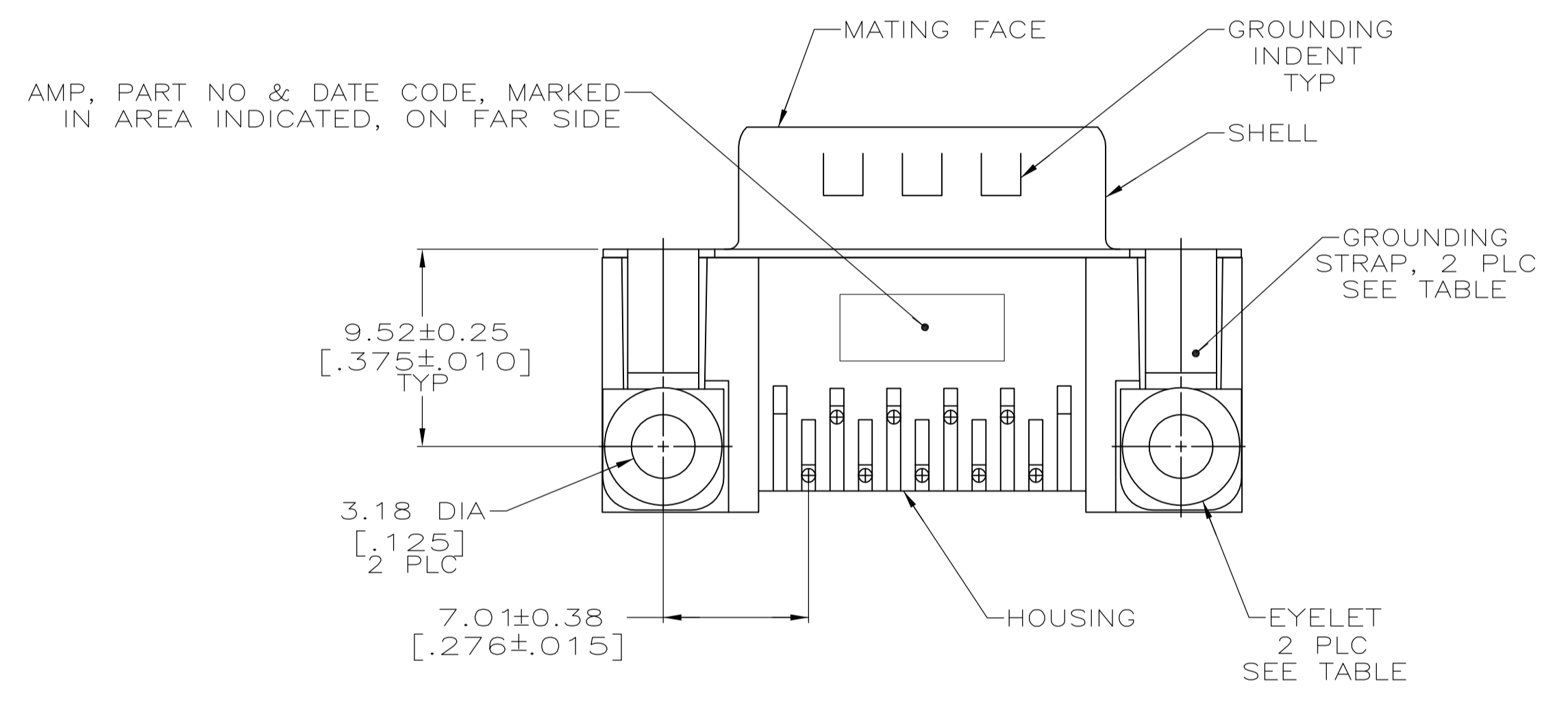

DETAIL C

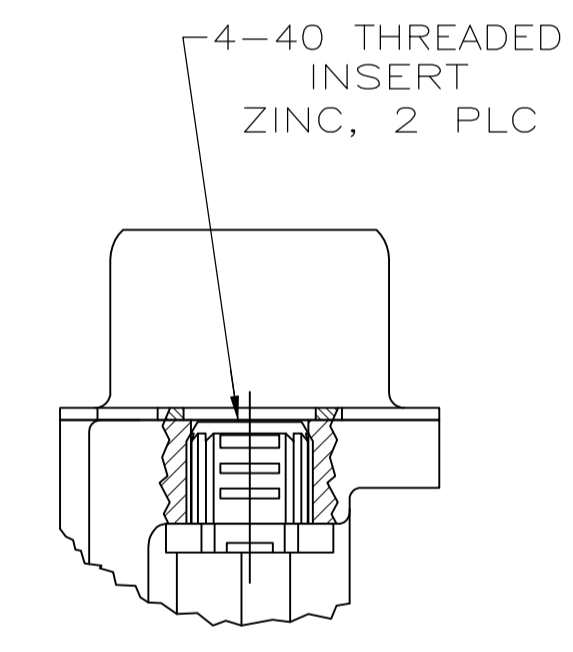

DETAIL D

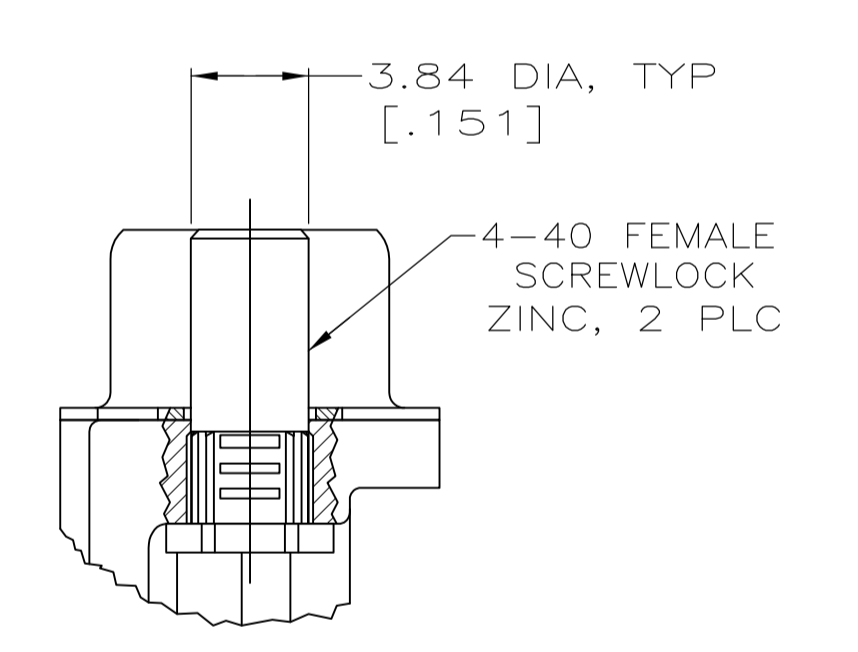

DETAIL E

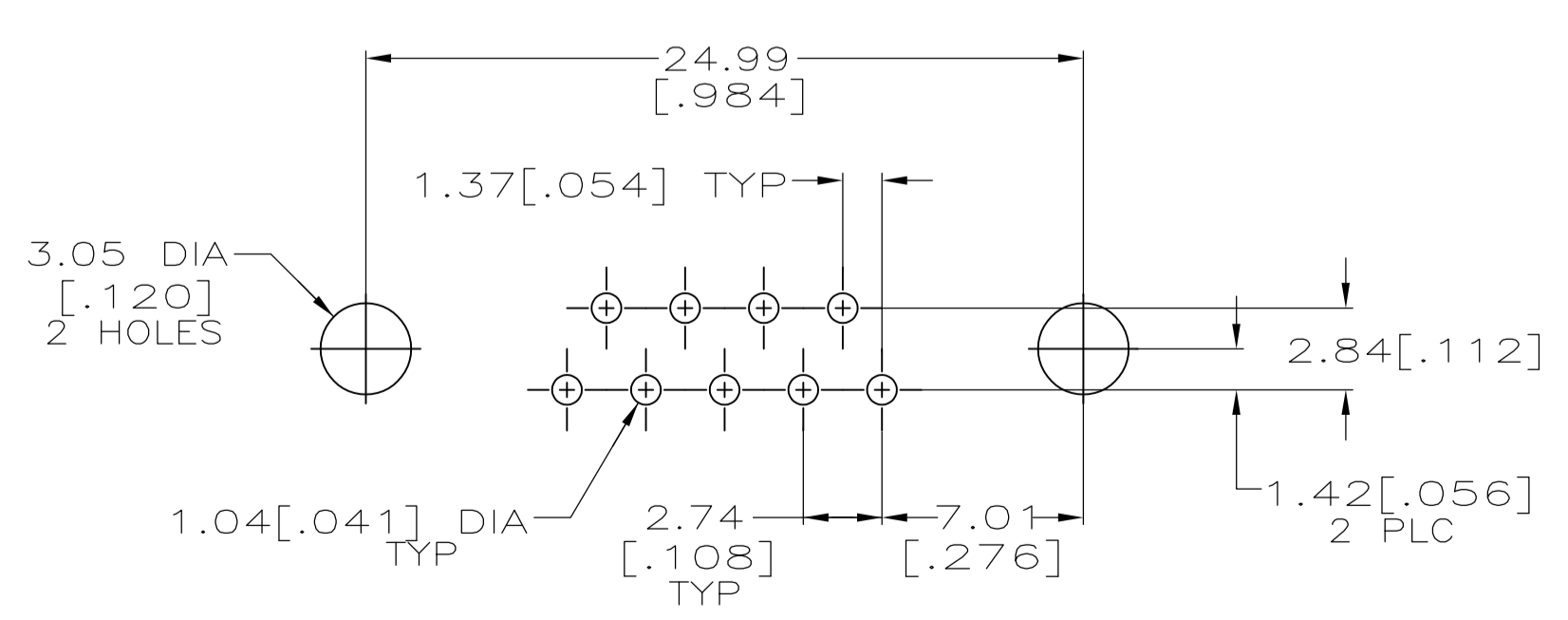

P.C. BOARD MOUNTING DIMENSIONS

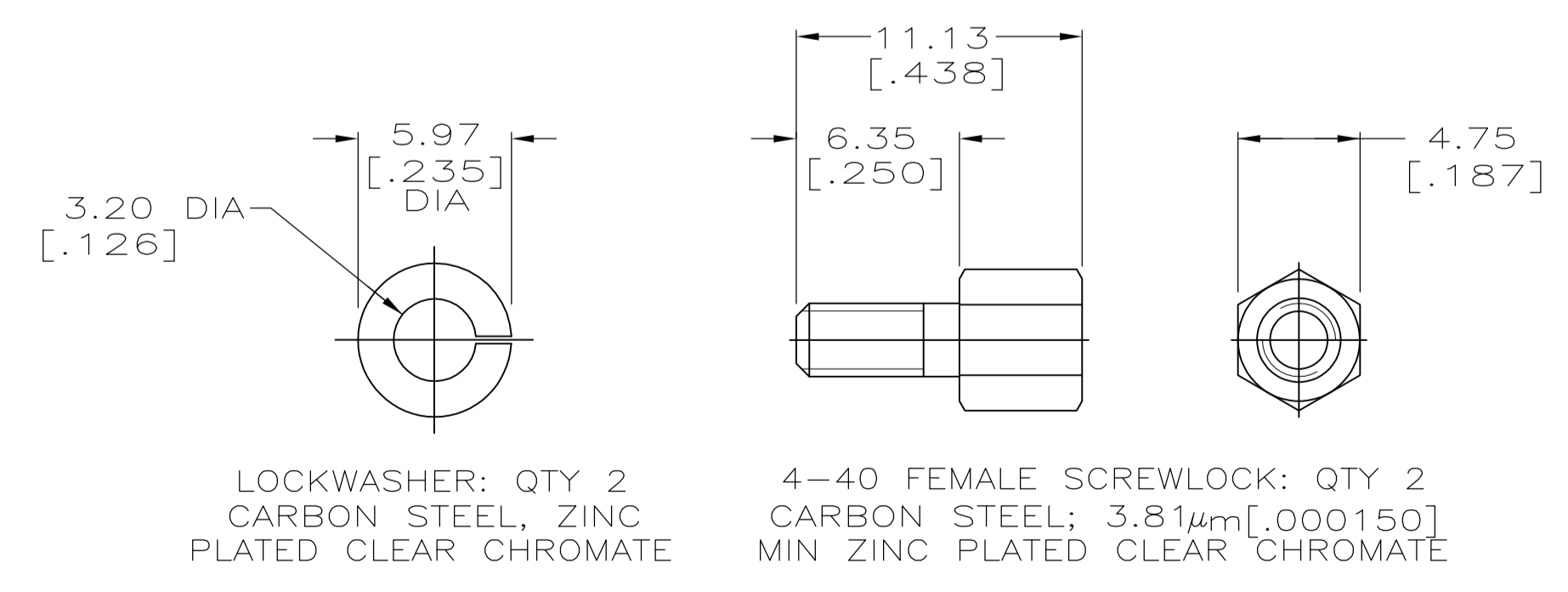

△ 6 DETAIL F

△ 3	3.56 [.140]	YES	YES	-	△ 3	△ 1-747250-5
				SEE DETAIL C	△ 3	△ 1-747250-4
				SEE DETAILS D AND F	△ 3	△ 1-747250-3
				SEE DETAIL E	△ 3	△ 1-747250-2
				SEE DETAIL D	△ 2	△ 1-747250-1
				-	△ 3	△ 1-747250-0
				-	△ 2	△ 747250-9
				-	△ 2	△ 747250-8
				-	△ 2	△ 747250-7
				-	△ 2	△ 747250-6
A	GROUNDING STRAPS	NO SEE DETAIL B	NO	SEE DETAIL E	△ 3	△ 747250-5
				SEE DETAIL D	△ 3	△ 747250-4
				-	△ 3	△ 747250-3
				-	△ 2	△ 747250-2
A	GROUNDING STRAPS	YES	YES	SEE DETAIL E	△ 3	△ 747250-1
				SEE DETAIL D	△ 3	△ 747250-1

THIS DRAWING IS A CONTROLLED DOCUMENT. DIMENSIONING AND TOLERANCING PER ASME Y14.5M-2009

DIMENSIONS:	TOLERANCES UNLESS OTHERWISE SPECIFIED:	APPROVED:	DATE:
mm [INCHES]	0 PLC ± -	W.G. LENKER	05 OCT 89
1 PLC ± -	1 PLC ± -	R. STONE	06 FEB 90
2 PLC ± -	2 PLC ± -	M.D. GALLOWAY	06 FEB 90
3 PLC ± -	3 PLC ± 0.13[.005]		
4 PLC ± -	4 PLC ± -		
ANGLES	± 2°		

MATERIAL: △ 1 FINISH: △ 4

W.G. LENKER 05 OCT 89
R. STONE 06 FEB 90
M.D. GALLOWAY 06 FEB 90

NAME: PLUG ASSEMBLY, SIZE 1, 9 POSITION, RIGHT ANGLE, FRONT METAL SHELL, .318 SERIES, AMPLITE® HD-20

PRODUCT SPEC: 108-40025
APPLICATION SPEC: 114-40010

SIZE: A1
CAGE CODE: 00779
DRAWING NO: 747250
RESTRICTED TO: -

CUSTOMER DRAWING SCALE: 4:1 SHEET: 1 OF 1 REV: W