

NOTES:

1. MATERIALS:

HOUSING:

- *BLANK*=NYLON 6/6, UNFILLED UL94 V-2, COLOR: NATURAL
- *130*=GLASS FILLED LCP, UL94 V-0, COLOR: BLACK
IEC 60335-1, 5TH EDITION GLOW WIRE CAPABLE
- *210*=NYLON 6/6, UNFILLED UL94 V-0, COLOR: NATURAL
- *BL*=NYLON 6/6, UNFILLED UL94 V-2, COLOR: BLACK
- *400*=NYLON 6/6, UNFILLED UL94 V-0, COLOR: BLACK

TERMINALS:

BRASS

2. TERMINAL PLATING:

- *BLANK*=.000035/(0.00090) MIN. REFLOWED MATTE TIN OVER .000020/(0.00050) MIN. COPPER (PREPLATE) (FINISH IS BRIGHT IN APPEARANCE, THICKNESS AS APPLIED PRIOR TO REFLOW)

GS2=.000015/(0.00038) MIN. SELECT GOLD AND .000100/(0.00254) MIN. SELECT MATTE TIN OVER .000050/(0.00127) MIN. NICKEL OVERALL

GS=.000030/(0.00076) MIN. SELECT GOLD AND .000100/(0.00254) MIN. SELECT MATTE TIN OVER .000050/(0.00127) MIN. NICKEL OVERALL

S=.000100/(0.00254) MIN. BRIGHT TIN OVER .000050/(0.00127) MIN. NICKEL

MS=.000100/(0.00254) MIN. MATTE TIN OVER .000050/(0.00127) MIN. NICKEL

3. PRODUCT SPECIFICATION: PS-5556-001

4. PACKAGING: TRAY PACKED PER PK-5556-002

5. PART MATES WITH MINI-FIT JR. RECEPTACLE NO. 5557.

6. PART IS NOT DESIGNED FOR CURRENT SHARING.

7. PARTS ARE NOT TO BE MATED OR UN-MATED WHILE CIRCUITS ARE LIVE.

8. PART CONFORMS TO CLASS "B" REQUIREMENTS OF COSMETIC SPECIFICATION PS-45499-002.

9. 5 CIRCUIT PARTS HAVE PEG DESIGN B. ALL OTHER CIRCUIT SIZES HAVE PEG DESIGN A.

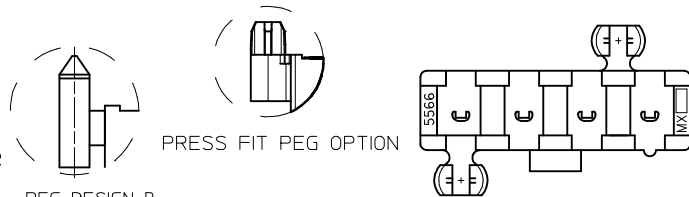

PEG DESIGN B SEE NOTE 9

PEG DESIGN A SEE NOTE 9

PRESS FIT PEG OPTION

.073 (1.85)

.14 (3.5)

.504 (12.80)

2 CIRCUIT

LOCK OPTION

POSITIVE LOCK

PASSIVE LOCK

.1654 (4.200) TYP.

CIRCUIT NO. 1

.213 (5.40)

.370 (9.40)

DIM B

DIM A

LEGEND:

5566 - N A * * * *

CIRCUIT SIZE (04-12)

PEG AND LOCK OPTION
 3=MTG. PEGS, POSITIVE LOCK
 4=MTG. PEGS, PASSIVE LOCK
 15=MTG. PRESS FIT PEGS, POSITIVE LOCK

PLATING (SEE NOTE 2)

HOUSING MAT'L (SEE NOTE 1)

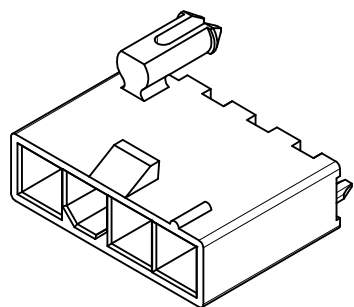

FIX "PEG A" VIEWS IEC NO: UCP2017-2789 DRW: NGUYEN CHKD: JELL APPR: FSMITH 2014/11/14 2014/11/14 2017/06/28	QUALITY SYMBOLS 	GENERAL TOLERANCES (UNLESS SPECIFIED)		DIMENSION STYLE IN/MM		SCALE 4:1	DESIGN UNITS METRIC	THIRD ANGLE PROJECTION			
		4 PLACES ± --- ± ---	3 PLACES ± --- ± .015	DRAWN BY KSS	DATE 1989/02/19	TITLE VERTICAL HEADER ASSY WITH PEGS MINI-FIT JR SINGLE ROW					
		2 PLACES ± 0.38 ± .020	1 PLACE ± 0.50 ± ---	CHECKED BY JTR	DATE 1989/02/19	APPROVED BY FSMITH					
		0 PLACE ± --- ± ---	ANGULAR ±1/2°	MATERIAL NO. SEE CHART		DATE 2012/05/04	DOCUMENT NO. SDA-5566-NL*		SHEET NO. 1 OF 3		
DRAFT WHERE APPLICABLE MUST REMAIN WITHIN DIMENSIONS		SIZE C		THIS DRAWING CONTAINS INFORMATION THAT IS PROPRIETARY TO MOLEX INCORPORATED AND SHOULD NOT BE USED WITHOUT WRITTEN PERMISSION							

CKT SIZE	DIM A	DIM B
2	.378 (9.60)	.165 (4.20)
4	.709 (18.00)	.496 (12.60)
5	.874 (22.20)	.661 (16.80)
6	1.039 (26.40)	.827 (21.00)
7	1.205 (30.60)	.992 (25.20)
8	1.370 (34.80)	1.157 (29.40)
9	1.535 (39.00)	1.323 (33.60)
10	1.701 (43.20)	1.488 (37.80)
11	1.866 (47.40)	1.654 (42.00)
12	2.031 (51.60)	1.819 (46.20)

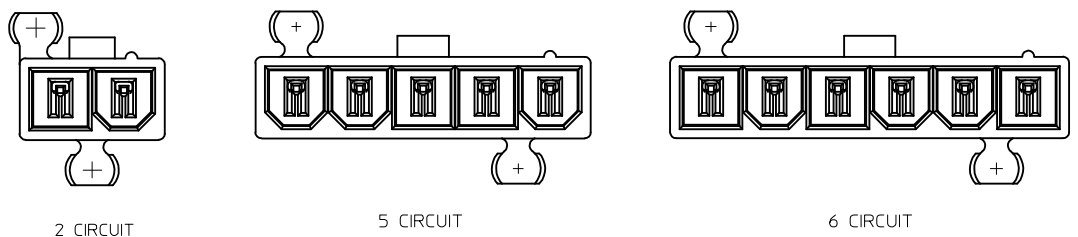

POLARIZATION

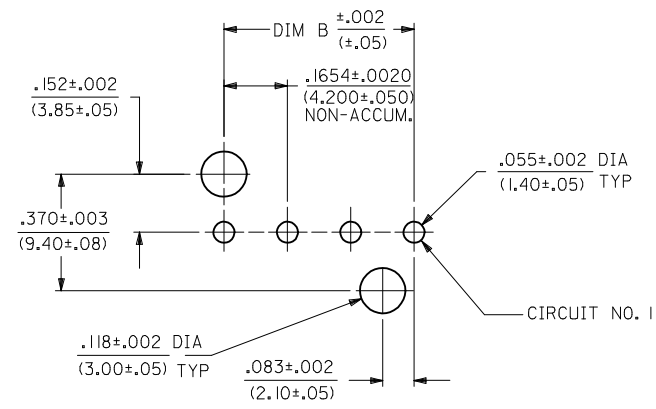

RECOMMENDED HOLE LAYOUT FOR
.070/(1.78) MAX. THICK P. C. BOARD
VIEWED FROM COMPONENT SIDE
4-12 CIRCUIT PART

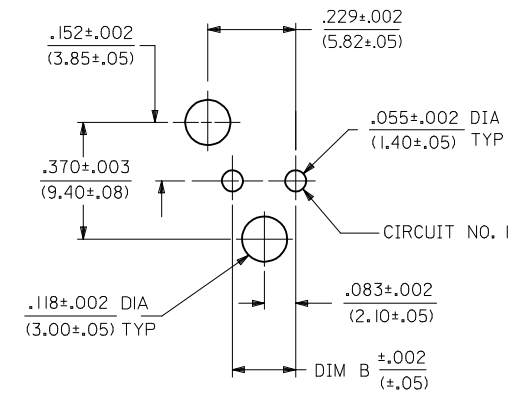

RECOMMENDED HOLE LAYOUT FOR
.070/(1.78) MAX. THICK P. C. BOARD
VIEWED FROM COMPONENT SIDE
2 CIRCUIT PART

SEE SHEET 1 EC NO: UCP2017-2789 DRAWN: NGUYEN 2014/11/14 CHKD: J. BELL 2014/11/14 APPR: FSMITH 2017/06/28 REV M7	QUALITY SYMBOLS ▽=0 ▽=0 ▽=0	GENERAL TOLERANCES (UNLESS SPECIFIED) mm INCH 4 PLACES ± --- ± --- 3 PLACES ± --- ± .015 2 PLACES ± 0.38 ± .020 1 PLACE ± 0.50 ± --- 0 PLACE ± --- ± ---	DIMENSION STYLE IN/MM DRAWN BY DATE KSS 1989/02/19 CHECKED BY DATE JTR 1989/02/19 APPROVED BY DATE FSMITH 2012/05/04	SCALE 4:1 DESIGN UNITS METRIC THIRD ANGLE PROJECTION	TITLE VERTICAL HEADER ASSY WITH PEGS MINI-FIT JR SINGLE ROW molex	MATERIAL NO. SEE CHART	DOCUMENT NO. SDA-5566-NL*	SHEET NO. 2 OF 3
	ANGULAR ±1/2°		DRAFT WHERE APPLICABLE MUST REMAIN WITHIN DIMENSIONS		THIS DRAWING CONTAINS INFORMATION THAT IS PROPRIETARY TO MOLEX INCORPORATED AND SHOULD NOT BE USED WITHOUT WRITTEN PERMISSION			

	13	12	11	10	9	8	7	6	5	4	3	2	1	
J	POSITIVE LOCK WITH MTG. PEGS, 94V-2 HOUSING MATERIAL				POSITIVE LOCK WITH PRESS FIT PEGS, 94V-0 LCP				PASSIVE LOCK WITH MTG. PEGS, 94V-2 HOUSING MATERIAL					
	PART NO	ENG NO	CKT SIZE	PLATING OPTION	PART NO	ENG NO	CKT SIZE	PLATING OPTION	PART NO	ENG NO	CKT SIZE	PLATING OPTION		
	39-30-1049	5566-04A3	4	TIN OVER COPPER	46999-0679	5566-02A15GS-130	2	30 M.I. SELECT GOLD	NO E.D.P.	5566-04A4GS	4	30 M.I. SELECT GOLD		
	39-30-1059	5566-05A3	5	TIN OVER COPPER	46999-0681	5566-04A15GS-130	4	30 M.I. SELECT GOLD	NO E.D.P.	5566-05A4GS	5	30 M.I. SELECT GOLD		

I	46999-0669	5566-02A3GS	2	30 M.I. SELECT GOLD	46999-0682	5566-05A15GS-130	5	30 M.I. SELECT GOLD	PASSIVE LOCK WITH MTG. PEGS, 94V-0 HOUSING MATERIAL												
	39-30-2041	5566-04A3GS	4	30 M.I. SELECT GOLD	46999-0683	5566-06A15GS-130	6	30 M.I. SELECT GOLD													
	39-30-2051	5566-05A3GS	5	30 M.I. SELECT GOLD	46999-0684	5566-02A15MS-130	2	MATTE TIN OVER NICKEL													
	39-30-2061	5566-06A3GS	6	30 M.I. SELECT GOLD	46999-0686	5566-04A15MS-130	4	MATTE TIN OVER NICKEL													
H	50-36-2453	5566-04A3S	4	BRIGHT TIN OVER NICKEL	46999-0687	5566-05A15MS-130	5	MATTE TIN OVER NICKEL	<table border="1"> <tr> <td>PART NO</td> <td>ENG NO</td> <td>CKT SIZE</td> <td>PLATING OPTION</td> </tr> <tr> <td>NO E.D.P.</td> <td>5566-04A4GS-210</td> <td>4</td> <td>30 M.I. SELECT GOLD</td> </tr> <tr> <td>NO E.D.P.</td> <td>5566-05A4GS-210</td> <td>5</td> <td>30 M.I. SELECT GOLD</td> </tr> </table>	PART NO	ENG NO	CKT SIZE	PLATING OPTION	NO E.D.P.	5566-04A4GS-210	4	30 M.I. SELECT GOLD	NO E.D.P.	5566-05A4GS-210	5	30 M.I. SELECT GOLD
	PART NO	ENG NO	CKT SIZE	PLATING OPTION																	
	NO E.D.P.	5566-04A4GS-210	4	30 M.I. SELECT GOLD																	
	NO E.D.P.	5566-05A4GS-210	5	30 M.I. SELECT GOLD																	
50-36-2454	5566-05A3S	5	BRIGHT TIN OVER NICKEL	46999-0688	5566-06A15MS-130	6	MATTE TIN OVER NICKEL														
46999-0673	5566-02A3MS	2	MATTE TIN OVER NICKEL																		
46999-0610	5566-04A3MS	4	MATTE TIN OVER NICKEL																		
46999-0611	5566-05A3MS	5	MATTE TIN OVER NICKEL																		
46999-0674	5566-06A3MS	6	MATTE TIN OVER NICKEL																		

POSITIVE LOCK WITH MTG. PEGS, 94V-2 BLACK HOUSING			
PART NO	ENG NO	CKT SIZE	PLATING OPTION
50-29-1528	5566-04A3-BL	4	TIN OVER COPPER
50-29-1529	5566-05A3-BL	5	TIN OVER COPPER
26-01-3162	5566-04A3S-BL	4	BRIGHT TIN OVER NICKEL
26-01-3163	5566-05A3S-BL	5	BRIGHT TIN OVER NICKEL

G	POSITIVE LOCK WITH MTG. PEGS, 94V-0 HOUSING MATERIAL			
	PART NO	ENG NO	CKT SIZE	PLATING OPTION
	39-30-2040	5566-04A3-210	4	TIN OVER COPPER
	39-30-2050	5566-05A3-210	5	TIN OVER COPPER
F	46999-0670	5566-02A3GS-210	2	30 M.I. SELECT GOLD
	39-30-2042	5566-04A3GS-210	4	30 M.I. SELECT GOLD
	39-30-2052	5566-05A3GS-210	5	30 M.I. SELECT GOLD
	39-30-2062	5566-06A3GS-210	6	30 M.I. SELECT GOLD
E	50-36-2356	5566-04A3S-210	4	BRIGHT TIN OVER NICKEL
	50-36-2452	5566-05A3S-210	5	BRIGHT TIN OVER NICKEL
	46999-0675	5566-02A3MS-210	2	MATTE TIN OVER NICKEL
	46999-0627	5566-04A3MS-210	4	MATTE TIN OVER NICKEL
D	46999-0628	5566-05A3MS-210	5	MATTE TIN OVER NICKEL
	46999-0676	5566-06A3MS-210	6	MATTE TIN OVER NICKEL

C	POSITIVE LOCK WITH MTG. PEGS, 94V-0 BLACK HOUSING			
	PART NO	ENG NO	CKT SIZE	PLATING OPTION
	46999-0671	5566-02A3GS-400	2	30 M.I. SELECT GOLD
	46999-0506	5566-04A3GS-400	4	30 M.I. SELECT GOLD
B	46999-0507	5566-05A3GS-400	5	30 M.I. SELECT GOLD
	46999-0672	5566-06A3GS-400	6	30 M.I. SELECT GOLD
	46999-0677	5566-02A3MS-400	2	MATTE TIN OVER NICKEL
	46999-0577	5566-04A3MS-400	4	MATTE TIN OVER NICKEL
A	46999-0578	5566-05A3MS-400	5	MATTE TIN OVER NICKEL
	46999-0678	5566-06A3MS-400	6	MATTE TIN OVER NICKEL

SEE SHEET 1 EC NO: UCP2017-2789 DRAWING NO: 2014/11/14 CHKD: J.BELL APPR: F.SMITH 2014/11/14 2017/06/28	QUALITY SYMBOLS 	GENERAL TOLERANCES (UNLESS SPECIFIED)		DIMENSION STYLE IN/MM		SCALE 1:1	DESIGN UNITS METRIC	THIRD ANGLE PROJECTION		
						DRAWN BY KSS	DATE 1989/02/19	TITLE VERTICAL HEADER ASSY WITH PEGS MINI-FIT JR SINGLE ROW 		
						CHECKED BY JTR	DATE 1989/02/19			
						APPROVED BY FSMITH		DATE 2012/05/04		
		ANGULAR ±1/2°		MATERIAL NO.		DOCUMENT NO.		SHEET NO.		
		DRAFT WHERE APPLICABLE MUST REMAIN WITHIN DIMENSIONS		SEE CHART		SDA-5566-NL*		3 OF 3		
				SIZE		THIS DRAWING CONTAINS INFORMATION THAT IS PROPRIETARY TO MOLEX INCORPORATED AND SHOULD NOT BE USED WITHOUT WRITTEN PERMISSION				