

| REVISIONS | | | |
|-----------|---------------------------|----------|-------|
| REV | DESCRIPTION, ECN, EAR NO. | DATE | APP'D |
| A | INITIAL RELEASE | DEC11/20 | K.T |
| B | UPDATE VOLTAGE | JUN16/21 | K.T |

NOTES

- ELECTRICAL:**
- 60 VDC WITH MAXIMUM POWER 100 W
 - INSULATING RESISTANCE : 500 MEGAOHMS MINIMUM.
 - DIELECTRIC STRENGTH : 1000 VAC 60Hz, 1MIN.
 - CATEGORY 6A CHARACTERISTIC

| FREQUENCY MHZ | NEAR-END CROSSTALK dB,MIN. | RETURN LOSS dB, MIN. | INSERTION LOSS dB,MAX. |
|---------------|----------------------------|----------------------|------------------------|
| 1.0 | 75.0 | 30.0 | 0.1 |
| 4.0 | 75.0 | 30.0 | 0.1 |
| 8.0 | 75.0 | 30.0 | 0.1 |
| 10.0 | 74.0 | 30.0 | 0.1 |
| 16.0 | 69.9 | 30.0 | 0.1 |
| 20.0 | 68.0 | 30.0 | 0.1 |
| 25.0 | 66.0 | 30.0 | 0.1 |
| 31.25 | 64.1 | 30.0 | 0.11 |
| 62.5 | 58.1 | 30.0 | 0.16 |
| 100.0 | 54.0 | 28.0 | 0.20 |
| 200.0 | 48.0 | 22.0 | 0.28 |
| 250.0 | 46.0 | 20.0 | 0.32 |
| 300.0 | 42.9 | 18.5 | 0.35 |
| 400.0 | 37.9 | 16.0 | 0.40 |
| 500.0 | 34.0 | 14.0 | 0.45 |

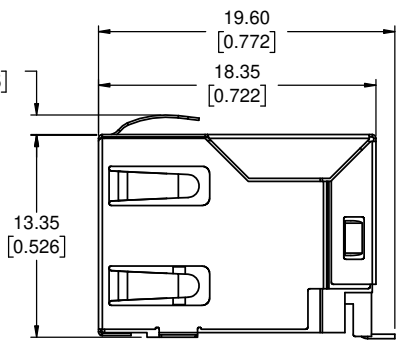
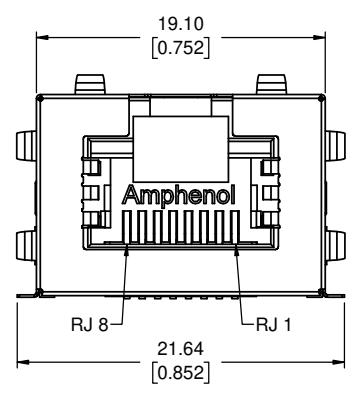
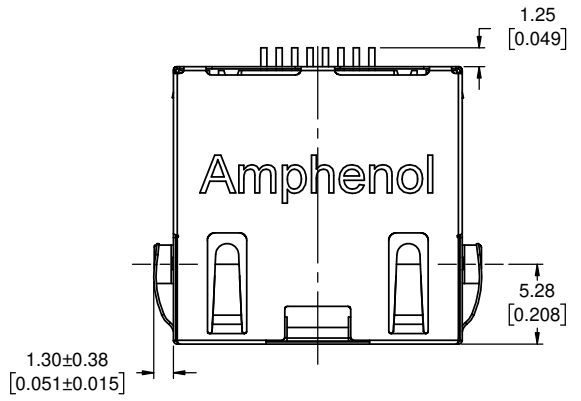
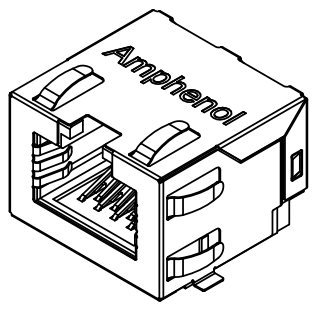

MECHANICAL:

- SHIELD: STAINLESS STEEL WITH 100u" MATTE TIN OVER 20u" MIN. NICKEL UNDERPLATE
- HOUSING: HIGH TEMP THERMOPLASTIC. UL 94V-0.
- CONTACT: PHOSPHOR BRONZE
SELECTIVE GOLD PLATING FOR MATING SURFACE,
50u" MIN. NICKEL UNDERPLATE
100u" MATTE TIN PLATING ON CONTACT SOLDER TAIL
- COPLANARITY:
THE MAXIMUM GAP BETWEEN ALL TERMINAL TAILS IS 0.10 [0.004]

ENVIRONMENTAL:

- STORAGE: -40 °C TO +85 °C
- OPERATION: -55 °C TO +85 °C
- MATES WITH MODULAR PLUG CONFORMING TO TIA 1096 STANDARD.
- RECOMMENDED SOLDER PROCESS:
REFLOW SOLDER, PEAK TEMPERATURE 260 °C FOR 10 SECONDS MAX.

RJ CONNECTOR CONFORMS TIA-1096 STANDARD

AMPHENOL PART NUMBER DESCRIPTION: RJE3C-188-1X01

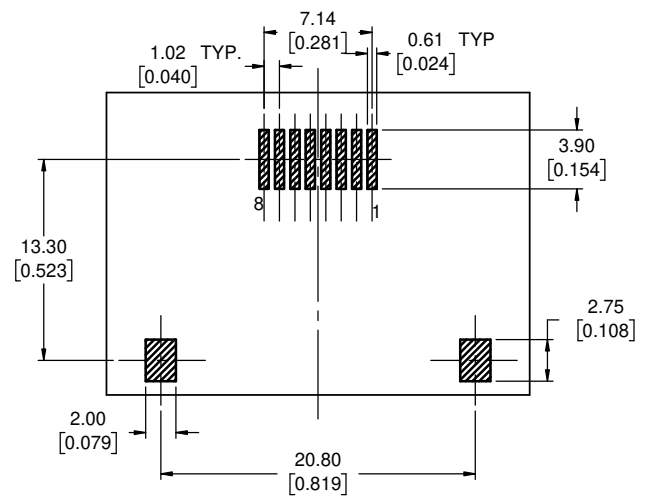

RECOMMENDED PCB LAYOUT VIEW FROM COMPONENT SIDE
TOLERANCE: +/- 0.05 [0.002]

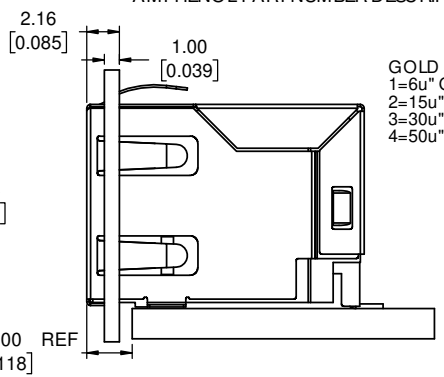
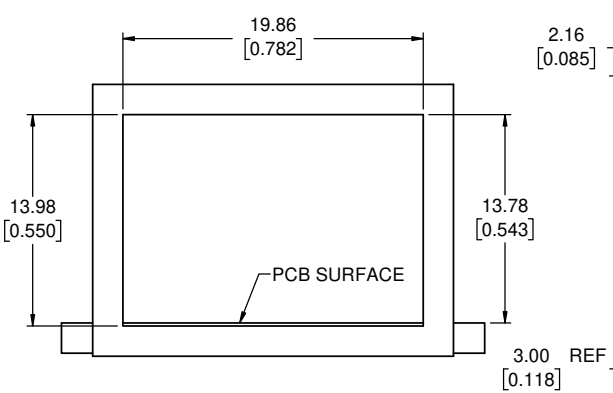

GOLD PLATING OPTION
1=6u" GOLD PLATING
2=15u" MIN GOLD PLATING
3=30u" MIN GOLD PLATING
4=50u" MIN GOLD PLATING

| | | | |
|----------------------------|------------------------|-----------|----------|
| UNLESS SPECIFIED OTHERWISE | DRAWN | JAMISON.C | DEC11/20 |
| PRIMARY UNITS MILLIMETERS | CHECKED | L.CHAN | DEC11/20 |
| SECONDARY INCHES | M.E. APP'D | | |
| REFERENCE IN PARENTHESES | Q.A. APP'D | | |
| GENERAL TOLERANCES | DWG APPR. | | |
| 1 DECIMAL PLACE ±0.38 | ENG. REL. NO. | | |
| 2 DECIMAL PLACES ±0.25 | REF. | | |
| 3 DECIMAL PLACES ±0.13 | | | |
| ANGULAR DEGREES ±1° | THIRD ANGLE PROJECTION | | |
| | DO NOT SCALE DRAWING | | |

Amphenol Canada Corp.
Commercial Products

MODULAR JACK, SINGLE PORT, 8P8C, SHIELDED, TAB UP, WITHOUT LED, CAT 6A---RoHS COMPLIANT

DWG. NO. **P-RJE3C-188-1X01** REV **B**

CODE ID NO. 03554 | DWG SIZE: N/A | SCALE: FIT | SHEET 1 OF 2

| REVISIONS | | | |
|-----------|---------------------------|----------|-------|
| REV | DESCRIPTION, ECN, EAR NO. | DATE | APP'D |
| A | INITIAL RELEASE | DEC11/20 | K.T |
| B | UPDATE VOLTAGE | JUN16/21 | K.T |

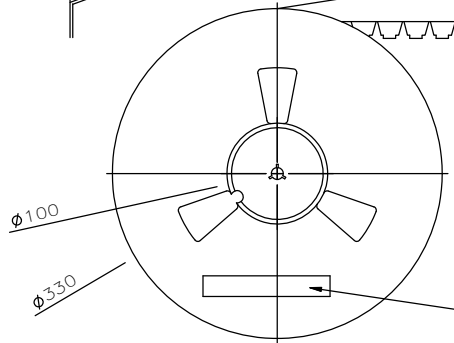
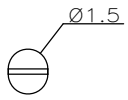
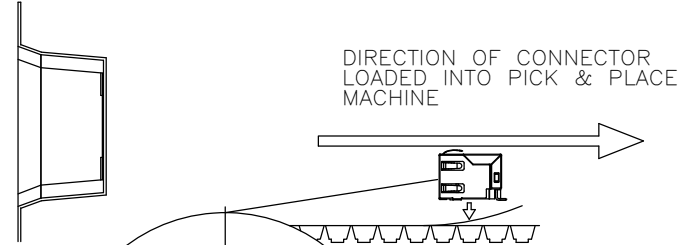
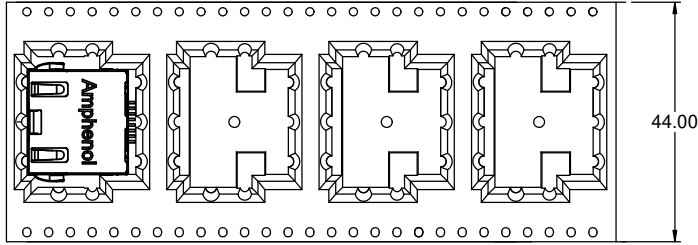

AMPHENOL P/N: RJE3C188XX01
 LOT# [Barcode] DATE CODE [Barcode] CTY OF ORIGIN: CN

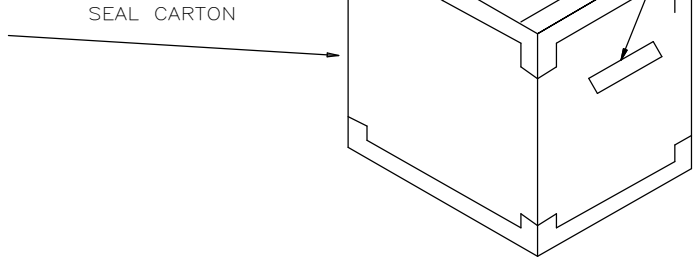
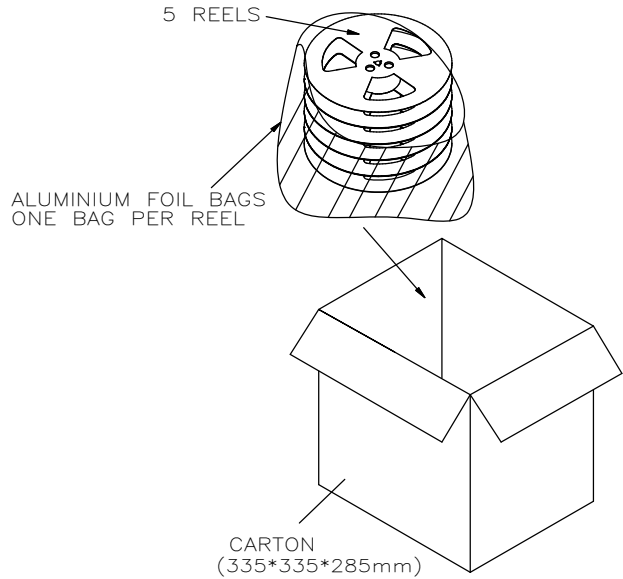

NOTES:

1. FINISHED CONNECTORS (AFTER FINAL INSPECTION) TO BE PACKED INTO CONDUCTIVE HIPS TAPE AND REEL. ONE REEL SHOULD HOLD 140 CONNECTORS.
2. 13 EMPTY POCKETS SEALED OF TAPE LEADER AND 7 EMPTY POCKETS SEALED OF TAPE TRAILER.
3. A FULLY LOADED CARTON SHOULD CONTAIN 5 REELS (700 PCS) OF CONNECTOR.

| | | | |
|----------------------------|------------------------|-----------|----------|
| UNLESS SPECIFIED OTHERWISE | DRAWN | JAMISON.C | DEC11/20 |
| PRIMARY UNITS MILLIMETERS | CHECKED | L.CHAN | DEC11/20 |
| SECONDARY INCHES | M.E. APP'D | | |
| REFERENCE IN PARENTHESES | Q.A. APP'D | | |
| GENERAL TOLERANCES | DWG APPR. | | |
| 1 DECIMAL PLACE ±0.38 | ENG. REL. NO. | | |
| 2 DECIMAL PLACES ±0.25 | REF. | | |
| 3 DECIMAL PLACES ±0.13 | THIRD ANGLE PROJECTION | | |
| ANGULAR DEGREES ±1° | DO NOT SCALE DRAWING | | |

Amphenol Canada Corp.
 Commercial Products

MODULAR JACK, SINGLE PORT, 8P8C, SHIELDED, TAB UP, WITHOUT LED, CAT 6A---RoHS COMPLIANT

DWG. NO. **P-RJE3C-188-1X01** REV **B**

CODE ID NO. 03554 | DWG SIZE: N/A | SCALE: FIT | SHEET 2 OF 2