

PART NUMBER	REV	FIRST USED
567960-1	A	854040-3

WIRE STRIP LENGTH		TERM APPL SPEC	FEED	APPL INSTRUCTION	SET UP GAGE	LAYOUT
.094-.126		114-19048	.472	SEE CUSTOMER MANUAL	NONE	L1768

VISIBLE PAD LTR	CRIMP HEIGHT	WIRE SIZE
A	.031 ±.002 [0.79 ±0.05mm]	22
B	.027 ±.002 [0.69 ±0.05mm]	24
C	.025 ±.002 [0.64 ±0.05mm]	26
D	NOT	USED

CRIMP	SIZE	TYPE	RANGE
WIRE	.048 [1.22mm]	F	26-22
INSUL	.080 [2.03mm]	F	φ.047-.069

SIM TO HDM 680307

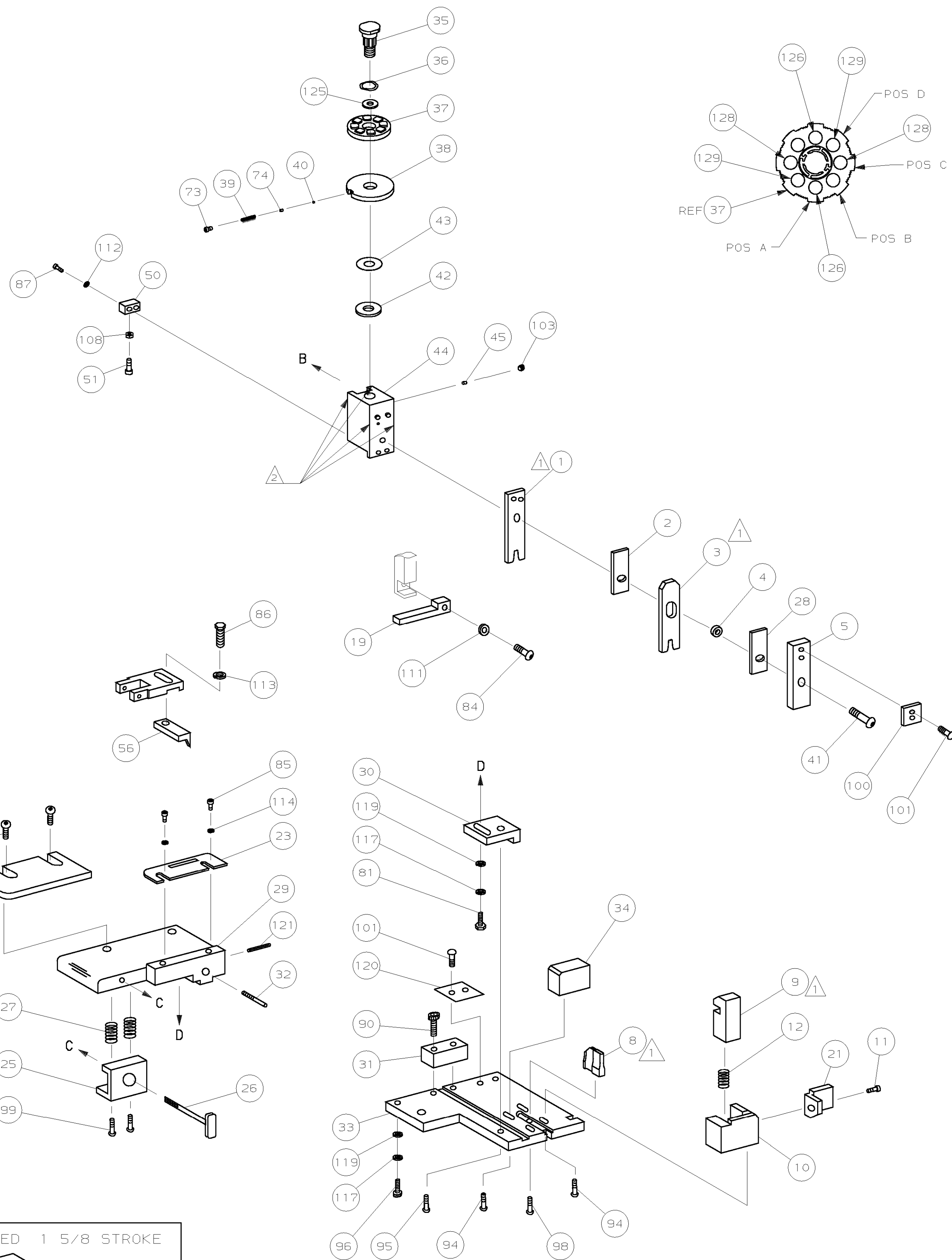

QTY	REV	TERM	APPL SPEC	FEED	APPL INSTRUCTION	SET UP GAGE	LAYOUT
2	-	C	6-354779-8		PIN, WIRE DISC (.3330)D		129
2	-	C	6-354779-0		PIN, WIRE DISC (.3290)C		128
2	-	C	7-354779-2		PIN, WIRE DISC (.3350)A		126
1	-	A	986950-1		WASHER, FLAT PRECISION		125
1	-	A	217238-3		GENERAL INSTRUCTION PACKAGE		124
1	-	A	4-21028-0		PIN, SLT SPR (φ.093x.75) ST GDE PL		121
1	-	B	690701-2		PLATE, SERIAL NO.		120
2	-	A	21899-2		WASHER, FLAT (#10) S G ADJ BLK		119
2	-	A	21024-5		WASHER, LOCK (#10) ADJ BLOCK		117
2	-	A	21024-2		WASHER, LOCK (#4) FRONT STP GUIDE		114
REF	-	A	21024-4		WASHER, LOCK (#8) FEED FINGER		113
2	-	A	21024-4		WASHER, LOCK (#8) DEP-HOLD		112
REF	-	A	21024-4		WASHER, LOCK (#8) STRIPPER		111
1	-	A	21018-5		NUT, HEX (#6) HOLD DOWN		108
1	-	A	21009-2		SCR, 5KT SET (1/4-20x.25 LW) RAM		103
4	-	A	21017-2		SCR, DRIVE (#2x.19) ID PLATE		101
1	-	B	819347-1		PLATE, IDENTIFICATION		100
2	-	A	3-21002-0		SCR, BHC (10-32x.88) DRAG		99
1	-	A	22733-8		SCR, BHC (8-32x.38 LW) ANVIL		98
1	-	A	3-21000-8		SCR, SHC (10-32x.88) MOUNTING		96
1	-	A	2-21002-7		SCR, BHC (10-32x.50) SG ADJ BLK		95
6	-	A	2-21002-2		SCR, BHC (8-32x.50) SHEAR-TERM SUP		94
1	-	A	1-21002-7		SCR, SHC (6-32x.50) CAM		91
2	-	A	2-21000-7		SCR, SHC (8-32x.50) SCR BLK		90
REF	-	A	2-21000-7		SCR, SHC (8-32x.48) DEP-HOLD DOWN		87
REF	-	A	2-22603-0		SCR, HEX HD (8-32x.31) FEED FINGER		86
2	-	A	1-21000-3		SCR, SHC (4-40x.25) F ST GUIDE		85
REF	-	A	22733-9		SCR, BHC (8-32x.50 SL) STRIPPER		84
1	-	A	3-22603-1		SCR, HEX (10-32x.38) SG ADJ BL		81
2	-	B	463310-7		BLADE, STRIPPING (#24)		77
1	-	A	690603-1		SPRING, ASSIST		74
1	-	A	23030-1		SCR, 5KT CAP (6-32x.25) CP DSC		73

QTY	REV	TERM	APPL SPEC	FEED	APPL INSTRUCTION	SET UP GAGE	LAYOUT
70	-						
69	-						
68	-						
67	-						
66	-						
65	-						
64	-						
63	-						
62	-						
61	-						
60	-						
59	-						
58	-						
57	-						
56	-	B	694433-8		PAWL, FEED		
55	-						
54	-						
53	-						
52	-						
51	-	A	811242-2		BUMPER, HOLDDOWN		
50	-	A	690753-1		SPACER, TONKER		
49	-						
48	-	A	690602-6		CAM, PRE-FEED 1.62 STROKE		
47	-						
46	-						
45	-	A	690191-1		PLUG, NYLON		
44	-	C	455673-1		RAM		
43	-	A	690125-1		WASHER, LAMINATED		
42	-	A	690124-1		WASHER, RAM		
41	-	A	7-21002-9		BOLT, CRIMPER (5/16x1.00)		
40	-	A	23241-6		BALL, STEEL		
39	-	A	690170-1		SPRING, COMPRESSION		
38	-	C	690142-1		DISC, INSULATION		
37	-	D	354777-1		WIRE DISC, PLASTIC		
36	-	A	22480-5		WASHER, SPRING		
35	-	B	690212-1		POST, RAM		
34	-	B	690786-1		SUPPORT, TERMINAL		
33	-	C	462544-1		PLATE, BASE SPECIAL		
32	-	A	690432-3		SCREW, ADJUSTMENT		
31	-	B	462543-1		BLOCK, SCREW SPECIAL		
30	-	B	455689-1		BLOCK, STRIP GUIDE ADJ		
29	-	C	455671-1		PLATE, STRIP GUIDE		
28	-	C	1-455888-7		SPACER, FRONT SHEAR DEP		
27	-	A	1-22284-0		SPRING, DRAG		
26	-	B	690546-1		LEVER, DRAG RELEASE		
25	-	B	240792-1		DRAG, TERMINAL		
24	-	D	6-690504-3		GUIDE, STRIP (REAR)		
23	-	A	690438-1		GUIDE, STRIP (FRONT)		
22	-						
21	-	A	463756-1		GUIDE, SCRAP		
20	-						
19	-	C	462615-1		STRIPPER		
18	-						
17	-						
16	-						
15	-						
14	-						
13	-						
12	-	A	5-22280-0		SPRING, SHEAR		
11	-	B	1-690461-6		STOP, SHEAR (FRONT)		
10	-	B	462548-1		HOLDER, SHEAR (FRONT) SP		
9	-	B	462547-1		SHEAR, FLOAT (FRONT) SP		
8	-	C	8-189717-0		ANVIL		
7	-						
6	-						
5	-	A	462838-1		DEPRESSOR, SHEAR (FRONT) SP		
4	-	B	2-238011-5		SPACER, BLOCK CRIMPER		
3	-	C	9-456134-4		CRIMPER, INSULATION		
2	-	C	455888-4		SPACER, CRIMPER		
1	-	C	568176-6		CRIMPER, WIRE		

QTY	REV	TERM	APPL SPEC	FEED	APPL INSTRUCTION	SET UP GAGE	LAYOUT
-1	U/M	DWG SIZE	PART NO		DESCRIPTION		ITEM NO

QTY	REV	TERM	APPL SPEC	FEED	APPL INSTRUCTION	SET UP GAGE	LAYOUT
-1	U/M	DWG SIZE	PART NO		DESCRIPTION		ITEM NO

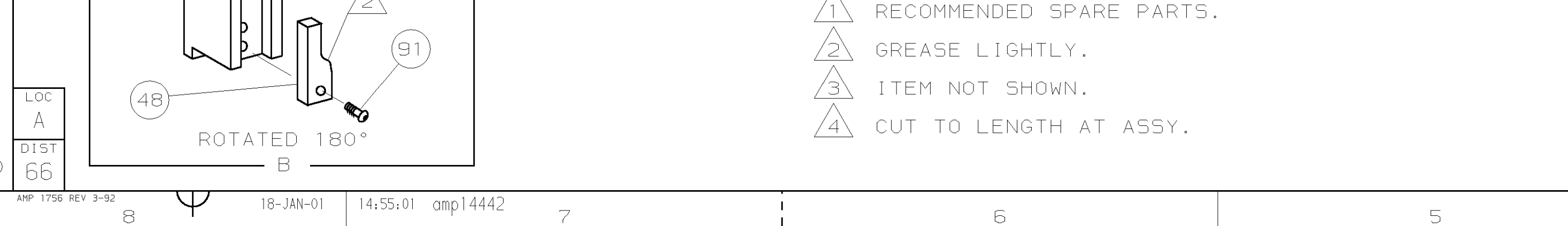

DIMENSIONS IN INCHES. DO NOT SCALE PRINT. TOLERANCES UNLESS OTHERWISE SPECIFIED:		MATERIAL		FINISH	
2 PLC DEC ±	3 PLC DEC ±	HT TR			
4 PLC DEC ±					
REMOVE BURRS, BREAK SHARP EDGES R.015 MAX		DR: W.HOOVER 26FEB99 APP: T.ELBIN 26FEB99 CHK: C.ERISMAN 26FEB99 REL: - NAME: STRIPPER CRIMPER APPLICATOR SCALE: DWG NO 567960 MACHINE REF: STRIPPER CRIMPER SHEET: 1 OF 1 REV: A2 RESTRICTED TO:			