

THIS DRAWING CONTAINS INFORMATION PROPRIETARY TO RF INDUSTRIES.  
 ANY UNAUTHORIZED USE OF THIS DRAWING IS EXPRESSLY PROHIBITED  
 WITHOUT WRITTEN PERMISSION FROM RF INDUSTRIES.  
 ANY VIOLATION IS PUNISHABLE UNDER U.S. COPYRIGHT LAWS.

ALL DIMENSIONS ARE REFERENCE ONLY

PART NO.

**RFE-6150**

REV	DESCRIPTION	DWN	DATE	APPROVED
-	ENGINEERING RELEASE	CZS	7/13/81	JDMc

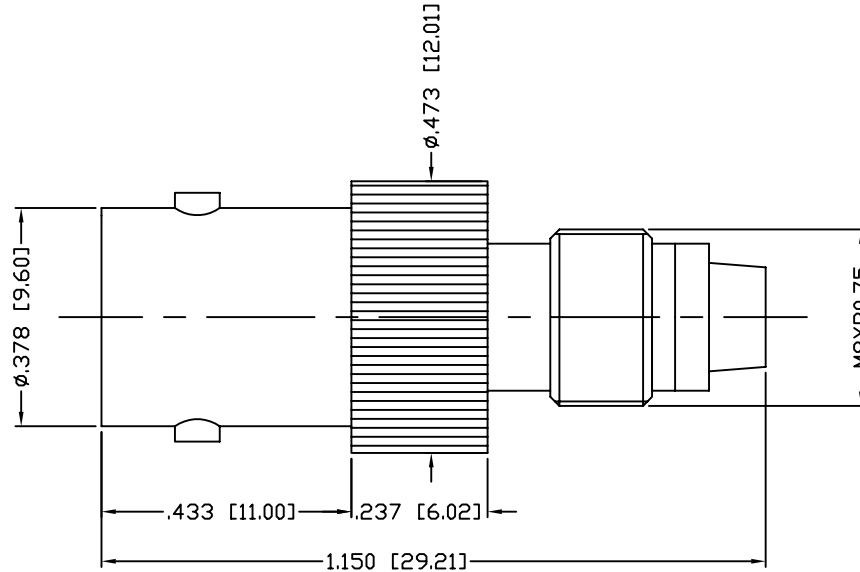

SPECIFICATIONS:

IMPEDANCE: 50 Ohms  
 FREQUENCY RANGE: 0-200 MHz  
 TEMPERATURE RANGE: -65°C TO +85°C

1	WASHER	1	BRASS	NICKEL	007777	UNLESS OTHERWISE SPECIFIED:
2	INSULATOR	1	PTFE	---		
3	CONTACT	1	BRASS	GOLD		
4	FERRULE STUD	1	BRASS	NICKEL		
5	INSULATOR	1	PTFE	---		
6						
7						
8						
9						
10					DRAWN	DIMENSIONS ARE IN INCHES AND [MILLIMETERS] UNLESS OTHERWISE NOTED TOLERANCES ARE: DECIMALS      DIAMETER
11				C. ZUNIGA	3/29/06	
12				CHECKED		
13				ORJ DRAWN	3/29/06	
14				C. ZUNIGA		
#	DESCRIPTION	QTY	MATERIAL	FINISH	APPROVALS	DATE

**RFconnectors**  
 DIVISION OF RF INDUSTRIES, LTD.

7610 MIRAMAR RD  
 SAN DIEGO, CA 92126  
 (858) 549-6340  
 (858) 549-6345 FAX

**FME JACK TO  
 BNC JACK ADAPTER**

SIZE A	CABLE GROUP N/A	DWG NO. RFE-6150	REV -
SCALE: NTS		CAD FILE OUTLINE	SHEET 1 OF 1