

SECTION A-A

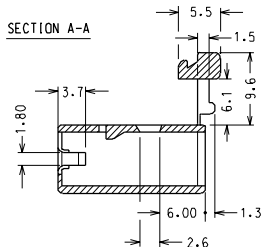

SECTION B-B

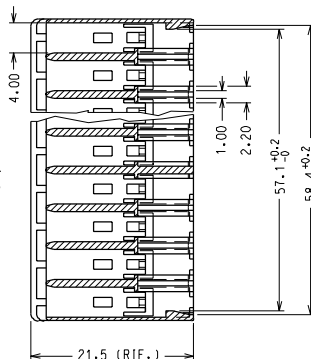
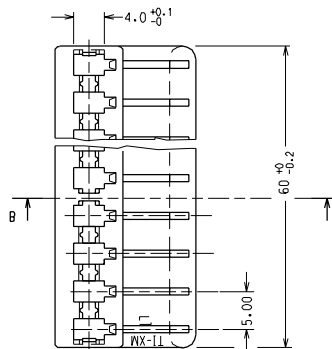
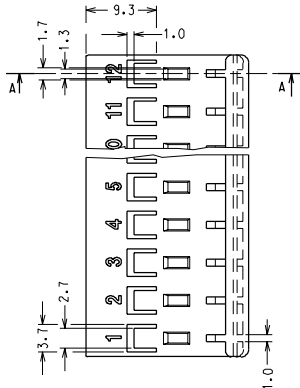
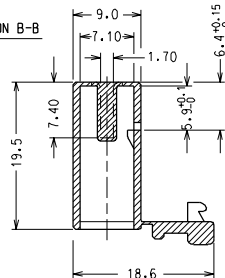

DIMA 12 VIE PER C.S. spess. 1.5±0.1  
VISTA LATO COMPONENTI  
RECOMMENDED PCB LAYOUT, PCB THICK.: 1.5±0.1  
VIEW FROM COMPONENT SIDE

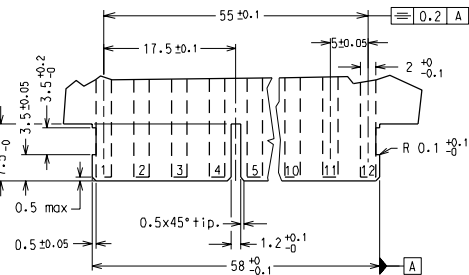

MATERIALE: NYLON 66 NERO V2, GWT 850 °C  
MATERIAL: NYLON 66 BLACK V2, GWT 850 °C

NOTA: LE DIMENSIONI VANNO MISURATE CON CORPI  
STABILIZZATI SECONDO NG 2301.  
(AUMENTO IN PESO DEL 2.7 %)

NOTE: PARTS SHALL BE DIMENSIONALLY CHECKED AFTER  
ATTAINING EQUILIBRIUM CONDITIONS E.G. 27 % INCREASE  
IN WEIGHT FOR HUMIDITY ABSORPTION FROM DRY STATUS.

CARATTERISTICHE PRODOTTO SECONDO PS-94529  
PRODUCT CHARACTERISTICS ACCORDING TO PS-94529 E

CONFEZIONE: 1800 pz in scatola  
PACKAGING: 1800 pcs in carton box

SPQ: 1800 pz.

Descr.Std: HSG FOR FORK TERMINAL 12 CKT

REV	QUALITY SYMBOLS	GENERAL TOLERANCES: (UNLESS SPECIFIED)		SCALE 2:1	DESIGN UNITS <input checked="" type="checkbox"/> mm <input type="checkbox"/> INCH	FIRST ANGLE PROJECTION	DIMENSIONS:			SHT	REV
		mm	INCH				mm	INCH	mm		
A1	MAJOR M = SIGNIF. S = CRITICAL C =	4 PLACES	±0.1	±.	DRAWN BY & DATE F.Gottardo 25-01-00	<input type="checkbox"/> mm <input type="checkbox"/> INCH <input checked="" type="checkbox"/> mm <input type="checkbox"/> INCH	TITLE: HOUSING 12 VIE PER CONTATTO A FORCELLA DIRITTO - POL. 4/5 12 CKT HOUSING FOR STRAIGHT FORK TERMINAL - POL.4/5	<input type="checkbox"/> mm <input type="checkbox"/> INCH <input checked="" type="checkbox"/> mm <input type="checkbox"/> INCH	SD-94529-017	SHEET NO. 1 / 1	REVISE ON CAD ONLY
	3 PLACES	±0.1	±.	CHECKED BY & DATE M.Testaguzza25-01-00							
	2 PLACES	±0.10	±.	APPROVED BY & DATE R.Martucci 25-01-00							
	1 PLACE	±0.20	±.	CAD FILENAME 94529017.dgn							
	ANGULAR: ±	2°	±.	MATERIAL NO. 94529-8212							
DRAFT WHERE APPLICABLE MUST REMAIN WITHIN DIMENSIONS						THIS DRAWING CONTAINS INFORMATION THAT IS PROPRIETARY TO MOLEX INCORPORATED AND SHOULD NOT BE USED WITHOUT WRITTEN PERMISSION.					