

PART NUMBER	REV	TERMINATOR	FEED TYPE	DESCRIPTION
1426603-1	A	LEADMAKER	MECH POST FEED	CUTS CARRIER
1426603-2	A	BENCH	MECH PRE FEED	CUTS CARRIER
1426603-6	A	LEADMAKER	MECH POST FEED	CONTINUOUS CARRIER
7-1426603-1	A	LEADMAKER	MECH POST FEED	-1 AND SPARE PARTS
7-1426603-2	A	BENCH	MECH PRE FEED	-2 AND SPARE PARTS
7-1426603-6	A	LEADMAKER	MECH POST FEED	-6 AND SPARE PARTS
7-1426603-7	A	-	-	SPARE PARTS KIT

WIRE	SIZE	TYPE	RANGE
WIRE	1.07 [.042 IN]	F	28-24 AWG
INSUL	1.57 [.062 IN]	O	0.90-1.10 [.035-.043 IN]
WIRE STRIP LENGTH	2.10-2.90 [.083-.114 IN]		APPL INSTRUCTIONS 408-8322

TERMINAL APPL SPEC	FEED
NONE.	7.62 [.300 IN]

TYCO TERM PIN	MANUF TERM PIN	TYCO TERM SKT	MANUF TERM SKT
1572978-1	0967 000 7265	1572979-1	0967 000 7165
1572978-2	0967 000 7267	1572979-2	0967 000 7167
1572978-3	0967 000 7268	1572979-3	0967 000 7168

WIRE SIZE	CRIMP HEIGHT	PINPN & LENGTH [IN]
24 AWG	0.74 ±0.05 [.029 ±.002 IN]	5-354779-7 [.3275]
26 AWG	0.66 ±0.05 [.026 ±.002 IN]	6-354779-3 [.3305]
28 AWG	0.64 ±0.05 [.025 ±.002 IN]	6-354779-5 [.3315]

- △ RECOMMENDED SPARE PARTS.
- 2. GREASE RAM, CAM, CAM FOLLOWER AND FEED ROD LIGHTLY.
- △ CERTAIN TERMINALS REQUIRE LUBRICATION. REFER TO THE APPLICATOR INSTRUCTION SHEET FOR MORE INFORMATION.
- 4. LUBRICATE DAILY PER THE APPLICATOR INSTRUCTION SHEET SUPPLIED WITH THE APPLICATOR.
- △ ALL CRIMP DATA CALCULATED BY TYCO ELECTRONICS UK LTD.
- 6. ADJUSTMENT OF FEED TRACK MAY BE REQUIRED WHEN CHANGING FROM PIN TO SOCKET.

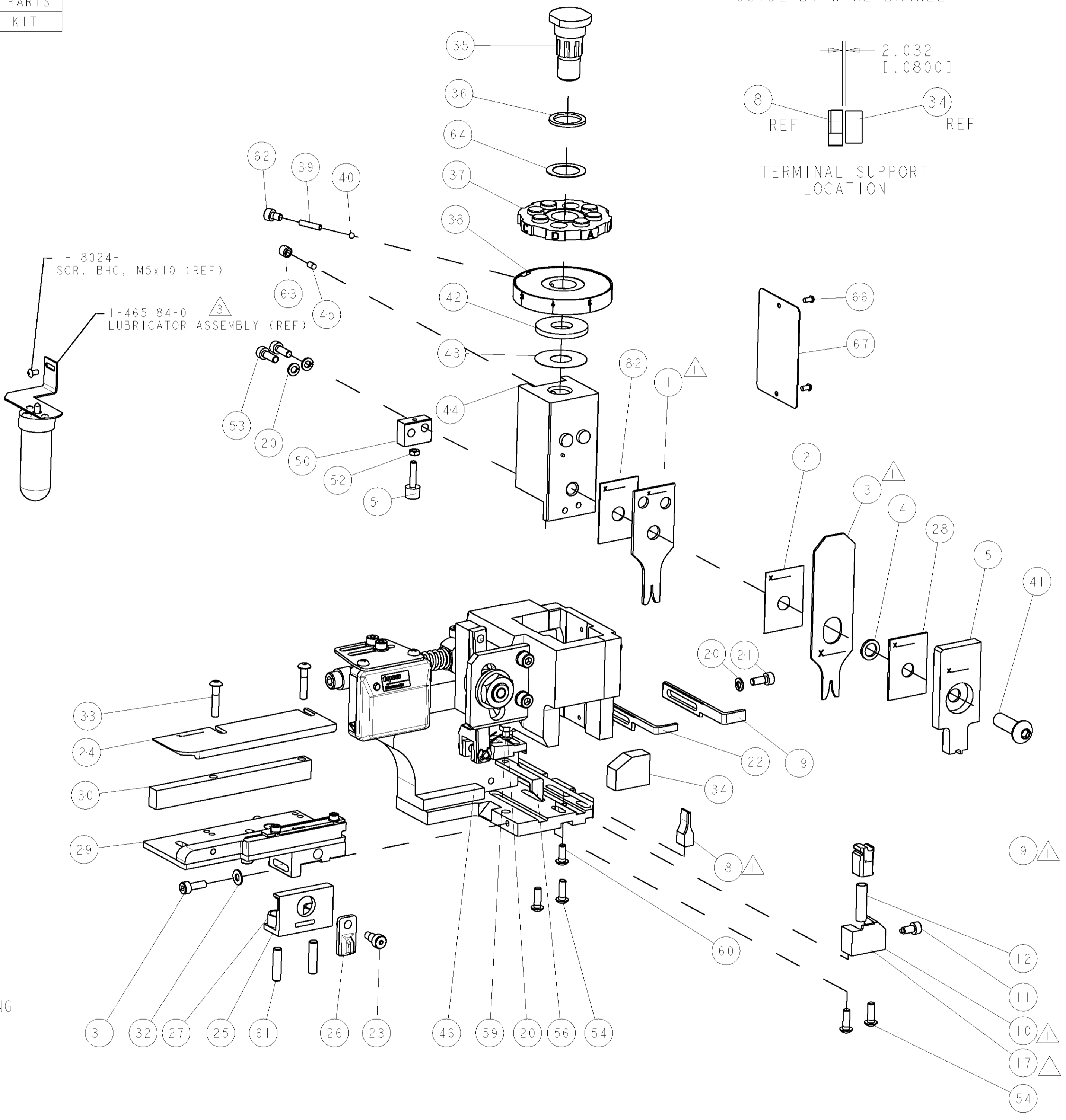
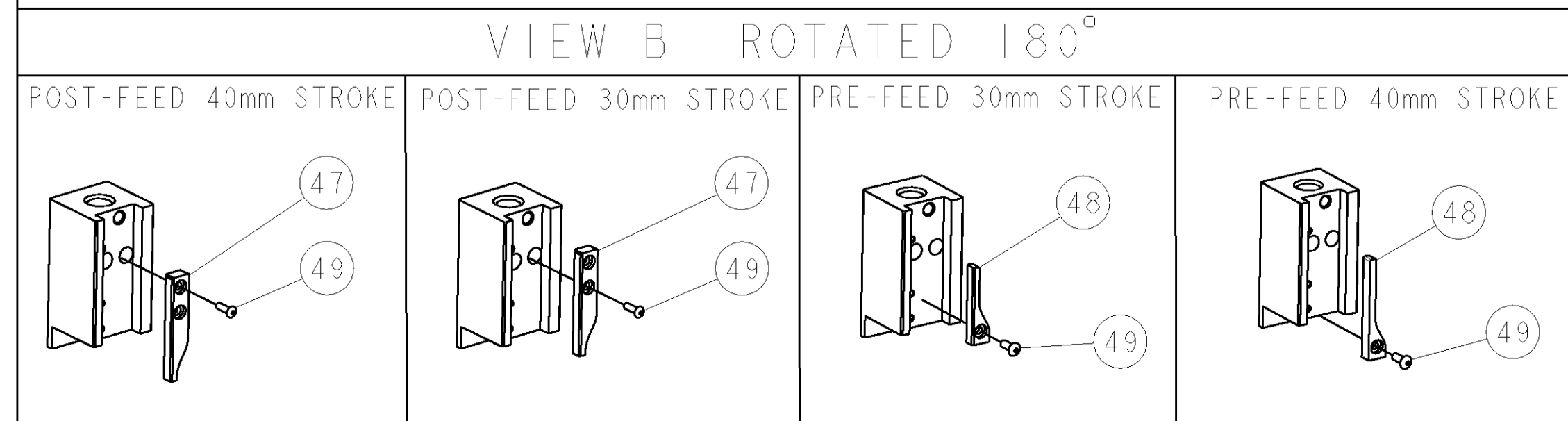

LOC	DIST	REV	DESCRIPTION	DATE	BY	APPD
A	66		SEE ECO-06-008989	18APR2006	LJL	MC

-	-	-	-	-	-	-	-	-	-	73
-	-	-	-	-	-	-	-	-	-	72
-	1	1	1	1	1	1	1338705-1	DOCUMENTATION PACKAGE		71
-	-	-	-	-	-	-	-	-	-	70
-	-	-	-	-	-	-	-	-	-	69
-	-	-	-	-	-	-	-	-	-	68
-	1	1	1	1	1	1	461264-1	PLATE, IDENTIFICATION		67
-	2	2	2	2	2	2	21017-2	SCREW, DRIVE		66
-	-	-	-	-	-	-	-	-	-	65
-	1	1	1	1	1	1	986950-1	WASHER, FLAT PRECISION		64
-	1	1	1	1	1	1	3-18031-0	SCR, SET, CUP POINT M6 X 6.0		63
-	1	1	1	1	1	1	18023-9	SCR, SKT HD CAP M4 X 6.0		62
-	2	2	2	2	2	2	2-18032-5	SCR, SET, FLT POINT M5 X 20.0		61
-	1	1	1	1	1	1	18024-7	SCR, BTN SKT HD CAP (M4 X 10.0)		60
-	1	1	1	1	1	1	5-18022-2	SCR, HEX HD CAP M4 X 8.0		59
-	-	-	-	-	-	-	-	-	-	58
-	-	-	-	-	-	-	-	-	-	57
-	1	1	1	1	1	1	1338685-1	PAWL, FEED		56
-	-	-	-	-	-	-	-	-	-	55
-	4	4	4	4	4	4	18024-8	SCR, BTN SKT HD CAP (M4 X 12.0)		54
-	2	2	2	2	2	2	1-18023-2	SCR, SKT HD CAP M4 X 12.0		53
-	1	1	1	1	1	1	18030-1	NUT, HEX, REG M3		52
-	1	1	1	1	1	1	811242-5	BUMPER, HOLD DOWN		51
-	1	1	1	1	1	1	690753-2	SPACER, TONKER		50
-	1	1	1	1	1	1	18024-3	SCR, BTN SKT HD CAP (M3 X 10.0)		49
-	-	-	-	-	-	-	1338675-1	CAM, UNIVERSAL PRE FEED		48
-	1	1	1	1	1	1	1338676-1	CAM, UNIVERSAL POST-FEED		47
-	1	1	1	1	1	1	1320999-3	APPLICATOR SUBASSEMBLY, HDI		46
-	1	1	1	1	1	1	690191-1	PLUG, NYLON		45
-	1	1	1	1	1	1	1338660-1	RAM		44
-	1	1	1	1	1	1	690125-1	SHIM SUB-ASSY		43
-	1	1	1	1	1	1	690124-1	WASHER, RAM (.115)		42
-	1	1	1	1	1	1	2-18024-6	SCR, BTN SKT HD CAP (M8 X 25.0)		41
-	1	1	1	1	1	1	23241-1	BALL, STEEL		40
-	1	1	1	1	1	1	2-22278-7	SPRING, COMPRESSION		39
-	1	1	1	1	1	1	1320922-1	DISC, ADJUST, INSULATION CRIMP		38
-	1	1	1	1	1	1	354777-1	WIRE DISC, ASSEMBLY		37
-	1	1	1	1	1	1	22480-5	SPRING, COMPRESSION		36
-	1	1	1	1	1	1	690212-1	POST, RAM		35
-	1	1	1	1	1	1	2-1320934-5	SUPPORT, TERMINAL		34
-	2	2	2	2	2	2	1-18024-0	SCR, BTN SKT HD CAP (M4 X 20.0)		33
-	1	1	1	1	1	1	18027-2	WASHER, FLAT, REG M4		32
-	1	1	1	1	1	1	1-18023-2	SCR, SKT HD CAP M4 X 12.0		31
-	1	1	1	1	1	1	1320908-4	SPACER, STRIP GUIDE		30
-	1	1	1	1	1	1	1633073-1	STRIP GUIDE ASSEMBLY		29
-	1	1	1	1	1	1	1-455888-0	SPACER, CRIMPER		28
-	2	2	2	2	2	2	1-22284-0	SPRING, COMPRESSION		27
-	1	1	1	1	1	1	356835-1	LEVER, DRAG RELEASE		26
-	1	1	1	1	1	1	240792-1	DRAG, TERMINAL		25
-	1	1	1	1	1	1	1320928-1	PLATE, STRIP GUIDE		24
-	1	1	1	1	1	1	980371-4	SCR, SKT HD SHLDR 5.0 DIA X 6.0		23
-	1	1	1	1	1	1	690472-2	STRIPPER		22
-	1	1	1	1	1	1	1-18023-1	SCR, SKT HD CAP M4 X 10.0		21
-	4	4	4	4	4	4	18025-2	WASHER, SPRG LOCK, REG M4		20
-	-	-	-	-	-	-	690472-1	STRIPPER		19
-	-	-	-	-	-	-	-	-	-	18
-	1	1	1	1	1	1	1338684-1	SHEAR HOLDER, FRONT		17
-	-	-	-	-	-	-	-	-	-	16
-	-	-	-	-	-	-	-	-	-	15
-	-	-	-	-	-	-	-	-	-	14
-	-	-	-	-	-	-	-	-	-	13
-	1	1	1	1	1	1	3-22280-3	SPRING, COMPRESSION		12
-	1	1	1	1	1	1	356885-4	STOP, SHEAR		11
-	-	-	-	-	-	-	1320921-1	SHEAR HOLDER, FRONT, CUT		10
-	1	1	1	1	1	1	462006-1	FLOATING SHEAR, FRONT		9
-	1	2	2	2	1	1	1633127-3	ANVIL, COMBINATION .042		8
-	-	-	-	-	-	-	-	-	-	7
-	-	-	-	-	-	-	-	-	-	6
-	1	1	1	1	1	1	2-455889-0	DEPRESSOR, SHEAR		5
-	1	1	1	1	1	1	2-238011-0	BLOCK, CRIMPER SPACER		4
-	1	2	2	2	1	1	5-456135-7	CRIMPER, INSULATION O PREMIUM		3
-	1	1	1	1	1	1	455888-2	SPACER, CRIMPER		2
-	1	2	2	2	1	1	456401-5	CRIMPER, WIRE PREMIUM		1

-	-	-	-	-	-	-	-	-	-	84
-	-	-	-	-	-	-	-	-	-	83
-	1	1	1	1	1	1	455888-6	SPACER, CRIMPER		82
-	-	-	-	-	-	-	-	-	-	81
-	-	-	-	-	-	-	-	-	-	80
-	-	-	-	-	-	-	-	-	-	79
-	-	-	-	-	-	-	-	-	-	78
-	-	-	-	-	-	-	-	-	-	77
-	-	-	-	-	-	-	-	-	-	76
-	-	-	-	-	-	-	-	-	-	75
-	-	-	-	-	-	-	-	-	-	74
-77	-76	-72	-71	-6	-2	-1	PART NO	DESCRIPTION	ITEM NO	

DATE	BY	APPD	NAME	SIZE	CAGE CODE	DRAWING NO	RESTRICTED TO
18-Apr-06	JL LOFTHOUSE	18-Apr-06	M CLIFFORD	A	00779	1426603	