

PART NO. 92311-0002
 DWG. NO. SDA-92311-0002

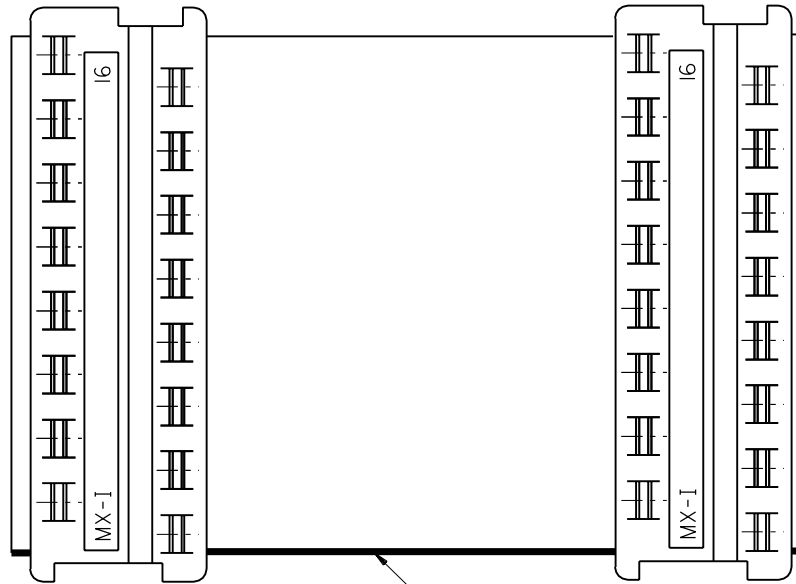
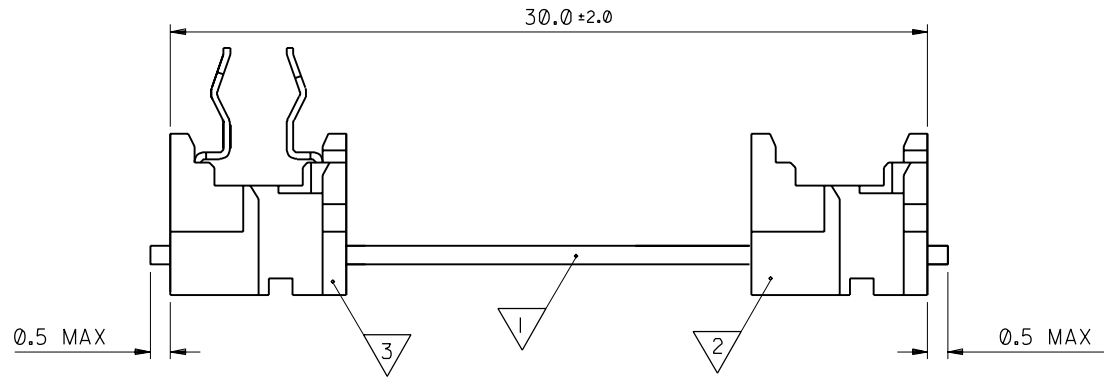

CIRCUIT IDENTIFICATION

ITEM	COMPONENT	DESCRIPTION	QUANTITY	NOTE
▽	99026-0001	16 CKT 28 AWG STRANDED TINNED RIBBON CABLE	1	1, 4, 5
▽	90327-0316	PICOFLEX FEMALE IDT CONNECTOR	1	1, 2, 5
▽	90584-1316	PICOFLEX BOARD-IN IDT CONNECTOR	1	1, 3, 5

- NOTES:
- SEE PRODUCT SPECIFICATION PS-99020-0011.
 - SEE TERMINATION SPECIFICATION ES-99033-0001.
 - SEE TERMINATION SPECIFICATION ES-99033-0002.
 - SEE CABLE SPECIFICATION ES-99027-0006.
 - HARNESSES TO BE 100% ELECTRICALLY TESTED.

THIRD ANGLE PROJECTION REVISE ONLY ON CAD SYSTEM SH. REV.

DIMENSIONS SHOWN (METRIC) INCH
 UNLESS OTHERWISE SPECIFIED
 TOLERANCES: ANGULAR ±2°

PLACE	TOLERANCE	UNIT
3 PLACE	±	
2 PLACE	±	
1 PLACE	±	

DRAFT WHERE APPLICABLE MUST
 REMAIN WITHIN DIMENSIONS

DESIGN DIMENSION (MM)
 (PRIMARY) IN.
 EQUIVALENT DIMENSION (MM)
 (SECONDARY) IN.

DRWG BY
AMc

CHK'D BY

APP'D BY

SCALE

5:1

CAD/CAM FILENAME
 S92311X2
 DGN THIS DRAWING CONTAINS INFORMATION THAT IS PROPRIETARY TO
 MOLEX INC. & SHOULD NOT BE USED WITHOUT WRITTEN PERMISSION

TITLE
**16CKT PICOFLEX CABLE
 HARNESS**

MOLEX EUROPE SHEET NO. DATE
 10F1 97/04/07

PART NO. DWG NO. SIZE
 92311-0002 SDA-92311-0002 B