

REVISIONS			
REV	DESCRIPTION, ECN, EAR NO.	DATE	APP'D
A	PROPOSAL DRAWING	MAR 05/21	KELVIN.T

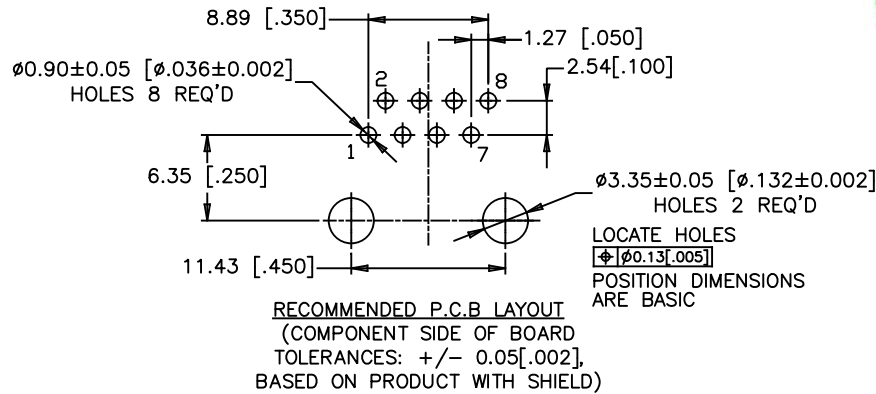
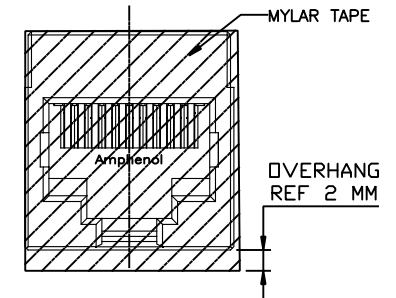
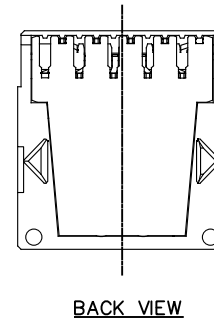
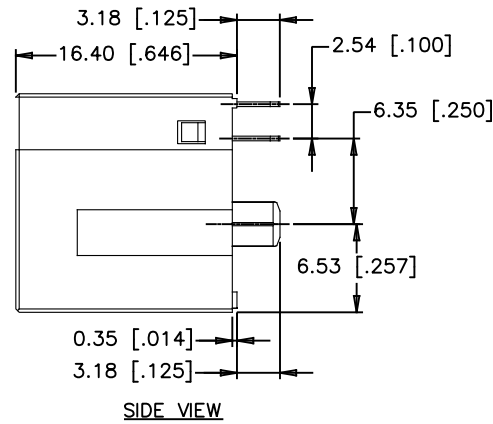
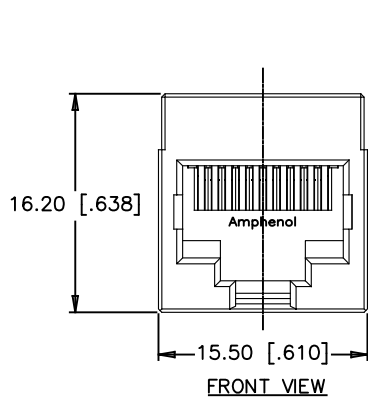

NOTES:

1. MATERIALS:

PLASTIC HOUSING: ENGINEERING THERMOPLASTIC
FLAMMABILITY RATING UL 94V-0
COLOUR: BLACK
CONTACTS: PHOSPHOR BRONZE
PLATING: SELECTIVE GOLD PLATING
ON MATING SURFACE SEE
PART NO. FOR THICKNESS,
100u" [2.54 MICRONS] MINIMUM
MATTE TIN ON CONTACT TAILS,
50u" [1.27 MICRONS] MINIMUM
NICKEL UNDERPLATE

2. AMPHENOL PART NUMBER: RJE74-188-0X10-X

GOLD PLATING OPTIONS:

- 1 = 6u" GOLD PLATING
- 2 = 15u" GOLD PLATING
- 3 = 30u" GOLD PLATING
- 4 = 50u" GOLD PLATING

BLANK= PBT, TRAY PACKAGING, W/O MYLAR.
A= HIGH TEMP. MATERIAL, TRAY PACKAGING, W/O MYLAR.
H= HIGH TEMP. MATERIAL, TAPE/REEL PACKAGING, WITH MYLAR.
T= HIGH TEMP. MATERIAL, TAPE/REEL PACKAGING, W/O MYLAR.
F= HIGH TEMP. MATERIAL, TRAY PACKAGING, W/O MYLAR, HALOGEN FREE.

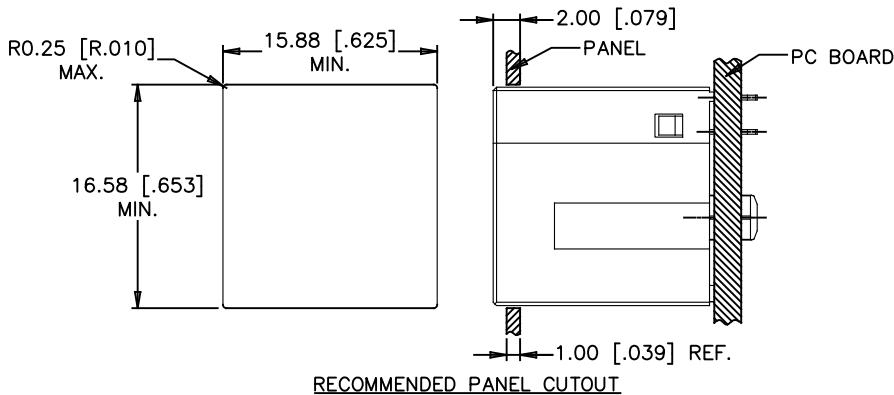

UNLESS SPECIFIED OTHERWISE	DRAWN STEVE.X	MAR05/21	Amphenol Canada Corp. Commercial Products
PRIMARY UNITS MILLIMETERS	CHECKED L.CHAN	MAR05/21	
SECONDARY INCHES	M.E. APP'D		MODULAR JACK, 10 POSITION 8 CONTACT, UNSHIELDED, MYLAR & PACKAGE OPTION - RoHS COMPLIANT
REFERENCE IN PARENTHESES	Q.A. APP'D		
GENERAL TOLERANCES	DWG APP'D		DWG NO. P-RJE74-188-0X10-X
1 DECIMAL PLACE ±0.38	ENG. REL. NO.		
2 DECIMAL PLACES ±0.25	REF.		REV A
3 DECIMAL PLACES ±0.20	THIRD ANGLE PROJECTION	DO NOT SCALE DRAWING	CODE ID NO. 03554 DWG SIZE X SCALE N/A SHEET 1 OF 3
ANGULAR DEGREES ±1.5°			

REVISIONS			
REV	DESCRIPTION, ECN, EAR NO.	DATE	APP'D
A	PROPOSAL DRAWING	MAR 05/21	KELVIN.T

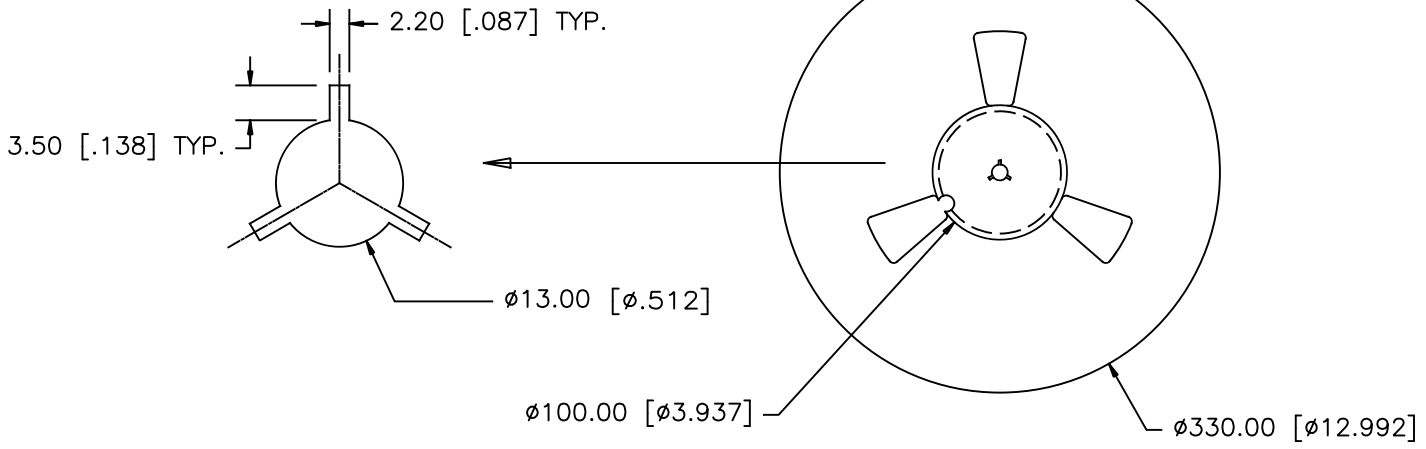
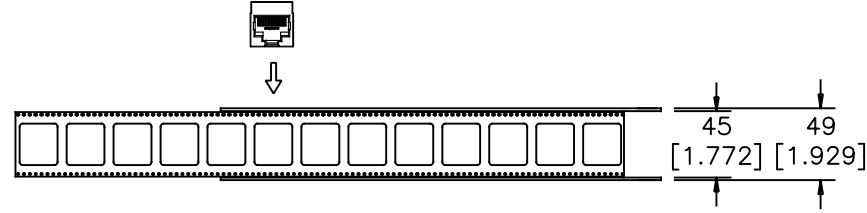
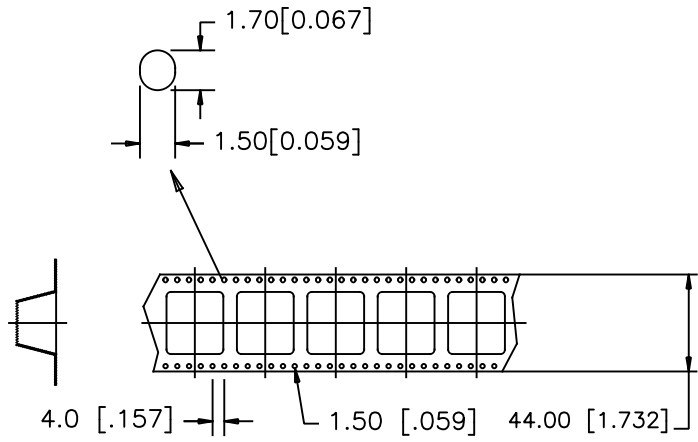

PACKAGING NOTES:

- ONE REEL SHOULD HOLD 85 CONNECTORS.
- 15 EMPTY CAVITIES FOR TOP LEADER AND 7 EMPTY CAVITIES FOR TAPE TRAILER.
- A FULLY LOADED CARTON SHOULD CONTAIN 5 REELS (425 PCS) OF CONNECTOR.

UNLESS SPECIFIED OTHERWISE		DRAWN STEVE.X	MAR05/21	Amphenol Canada Corp. Commercial Products	
PRIMARY UNITS MILLIMETERS		CHECKED L.CHAN	MAR05/21		
SECONDARY INCHES		M.E. APP'D		MODULAR JACK, 10 POSITION 8 CONTACT, UNSHIELDED,MYLAR&PACKAGE OPTION - RoHS COMPLIANT	
REFERENCE IN PARENTHESES		Q.A. APP'D			
GENERAL TOLERANCES		DWG APP'D		DWG NO. P-RJE74-188-0X10-X	
1 DECIMAL PLACE ±0.38		ENG. REL. NO.			
2 DECIMAL PLACES ±0.25		REF.		REV A	
3 DECIMAL PLACES ±0.20		THIRD ANGLE PROJECTION	DO NOT SCALE DRAWING	CODE ID NO. 03554 DWG SIZE X SCALE N/A SHEET 2 OF 3	
ANGULAR DEGREES ±1.5°					

THIS DOCUMENT CONTAINS PROPRIETARY INFORMATION AND SUCH INFORMATION MAY NOT BE DISCLOSED TO OTHERS FOR ANY PURPOSE OR USED FOR MANUFACTURING PURPOSES WITHOUT WRITTEN PERMISSION FROM AMPHENOL CANADA CORP.

REVISIONS			
REV	DESCRIPTION, ECN, EAR NO.	DATE	APP'D
A	PROPOSAL DRAWING	MAR 05/21	KELVIN.T

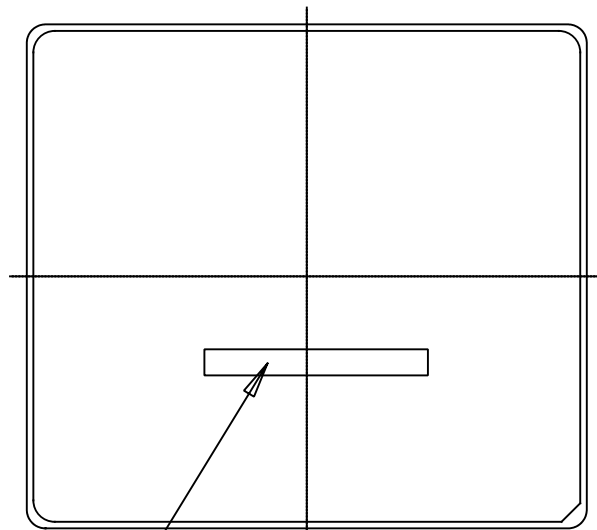

LABEL

COVER TRAY

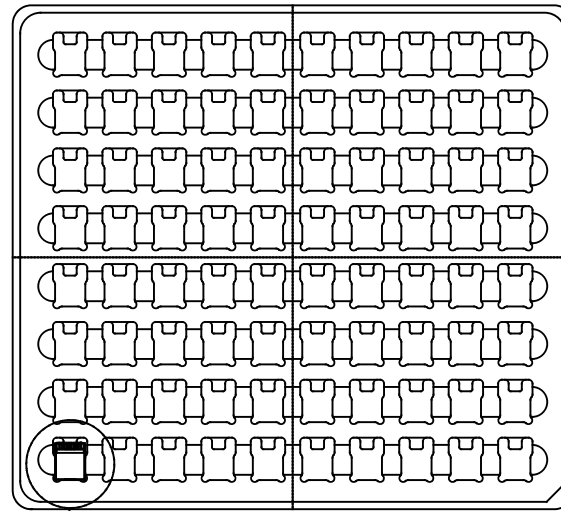

BASE TRAY

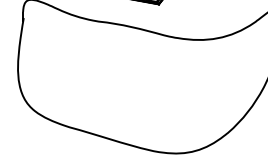
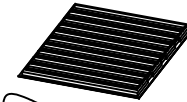
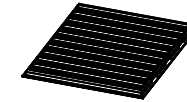

TOTAL 12 LAYERS

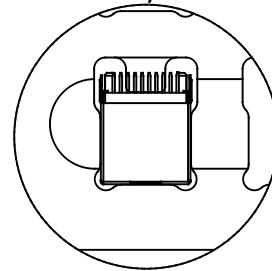

LABEL

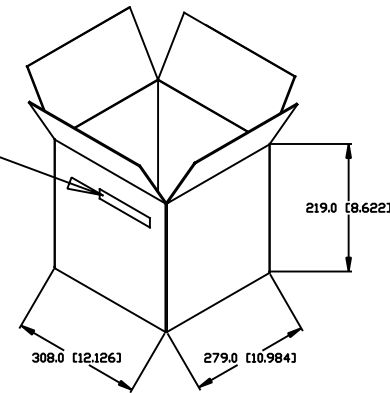

PACKAGING NOTES:

1. 80PCS CONNECTORS PER TRAY
2. 12 TRAY PER CARTON (960 PCS CONNECTORS PER CARTON)

UNLESS SPECIFIED OTHERWISE	DRAWN STEVE.X	MAR05/21	Amphenol Canada Corp.	
PRIMARY UNITS MILLIMETERS	CHECKED L.CHAN	MAR05/21	Commercial Products	
SECONDARY INCHES	M.E. APP'D		MODULAR JACK, 10 POSITION 8 CONTACT, UNSHIELDED,MYLAR&PACKAGE OPTION - RoHS COMPLIANT	
REFERENCE IN PARENTHESES	Q.A. APP'D		DWG NO.	REV
GENERAL TOLERANCES	DWG APP'D		P-RJE74-188-0X10-X	A
1 DECIMAL PLACE ±0.38	ENG. REL. NO.		CODE ID NO. 03554	DWG SIZE X
2 DECIMAL PLACES ±0.25	REF.		SCALE N/A	SHEET 3 OF 3
3 DECIMAL PLACES ±0.20	THIRD ANGLE PROJECTION		DO NOT SCALE DRAWING	
ANGULAR DEGREES ±1.5°				