

THIS DRAWING IS UNPUBLISHED. RELEASED FOR PUBLICATION
 © COPYRIGHT - By - ALL RIGHTS RESERVED.

LOC	DIST	REVISIONS					
CE	00	P	LTR	DESCRIPTION	DATE	DWN	APVD
		B		ECR-11-018563	29SEP2011	BB	SM

NOTE :

- CONNECTOR KEYING CONFORMS TO ANSI X3T9.5/84-48.
- LED IS 'ON' WHEN IN INSERTED STATE.
- THIS PRODUCT HAS NOT COMPLETED VALIDATION TESTING.
- OBSOLETE PARTS: OBSOLETE CIS STREAMLINING PER D.RENAUD/D.SINISI

SPECIFICATIONS :

SWITCH LEGEND			
PI = PRIMARY IN	PTx = PRIMARY TRANSMIT		
SO = SECONDARY OUT	STx = SECONDARY TRANSMIT		
PO = PRIMARY OUT	PRx = PRIMARY RECEIVE		
SI = SECONDARY IN	SRx = SECONDARY RECEIVE		

PART No.	FIBER TYPE	"A" LENGTH	PIGTAIL STRAIN RELIEF/CONNECTOR
5209174-3	62.5/125/250	1000mm	STRAIGHT ST
5209174-4	62.5/125/250	1000mm	STRAIGHT ST
5209174-6	62.5/125/250	1000mm	STRAIGHT ST
3-5209174-4	62.5/125/250	3000mm	STRAIGHT ST

INSERTION LOSS

INSERTION LOSS DATA INCLUDES TWO CONNECTED PAIRS TESTED PER FOTP-34 METHOD A2

OPERATE MODE, POWER ON

PI LINE TO PRX STATION	1.8 DB MAX
SI LINE TO SRX STATION	1.8 DB MAX
PTX STATION TO PO LINE	1.8 DB MAX
STX STATION TO SO LINE	1.8 DB MAX

BYPASS MODE, POWER OFF

PI LINE TO PO LINE	1.8 DB MAX
SI LINE TO SO LINE	1.8 DB MAX
PTX STATION TO PRX STATION	5.0 DB MAX
STX STATION TO SRX STATION	5.0 DB MAX

OPTICAL CROSSTALK </= -45 DB, PER FOTP-42

OPERATING WAVE LENGTH 750 TO 1450nm

TESTED WAVELENGTH 1300nm

POWER REQUIREMENTS 4.0 TO 5.5 VDC

190 MA MAX AT 5.0 VDC W/ LED

SWITCHING SPEED 10 MILLISECONDS MAX

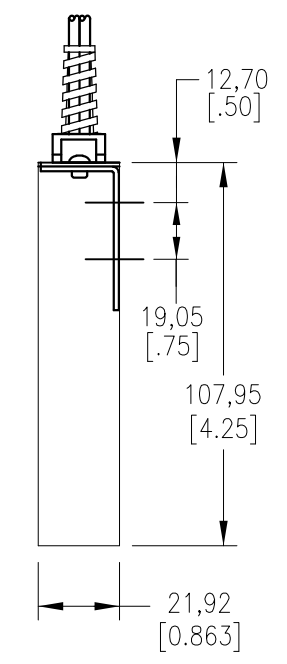
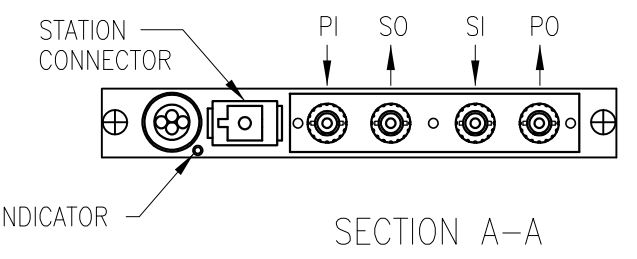
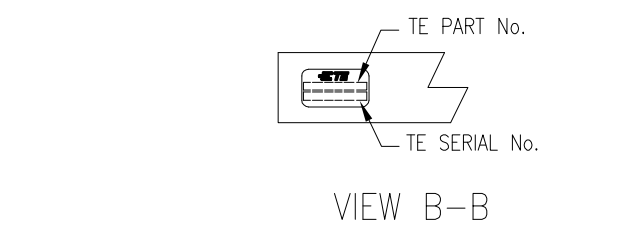
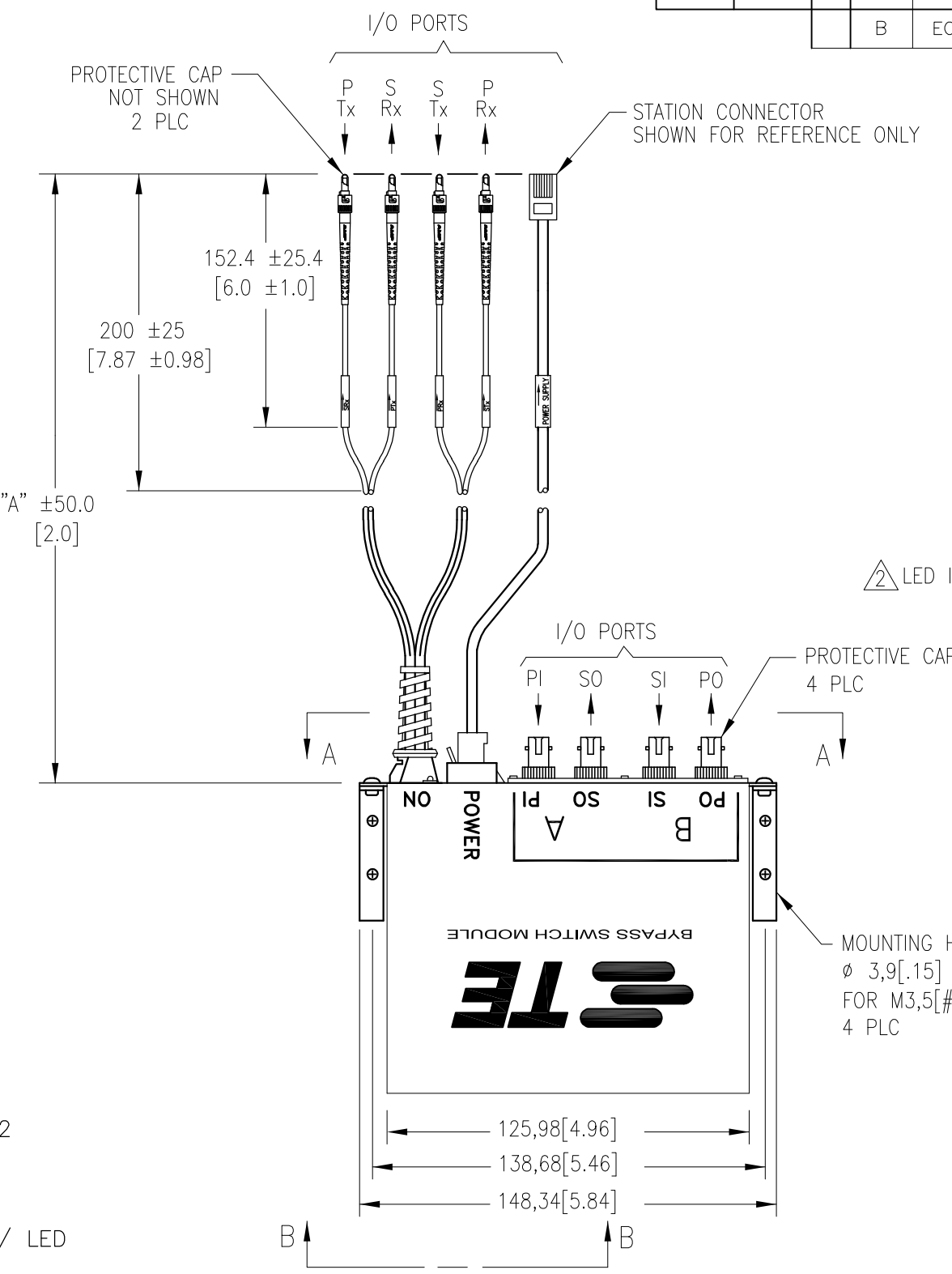

KIT P/N	MODULE P/N	POWER CORD P/N	STATION CONNECTOR TYPE
5209174-3	5209664-3	5209503-1	6 POS. SHIELDED MOD PLUG
5209174-4	5209664-3	5209504-1	6 POS. SHIELDED MINI DIN
5209174-6	5209664-3	5209506-1	4 POS. MOD PLUG
3-5209174-4	5209664-6	5209504-6	6 POS. SHIELDED MINI DIN

THIS DRAWING IS A CONTROLLED DOCUMENT.

DIMENSIONS: mm [INCHES]	TOLERANCES UNLESS OTHERWISE SPECIFIED:
	0 PLC ± -
	1 PLC ± 0.5 [.020]
	2 PLC ± 0.38 [.015]
	3 PLC ± -
	4 PLC ± -
	ANGLES ± 2°
MATERIAL	FINISH
-	-

DWN S. MONGOLD 01FEB06	<p>TE Connectivity</p>	NAME	
CHK R. PAUL 01FEB06		-	
APVD F. ABENDSCHEIN 01FEB06		BYPASS SWITCH KIT, ST, ADAPTOR/ST PIGTAILS	
PRODUCT SPEC		-	
APPLICATION SPEC	SIZE	CAGE CODE	DRAWING NO
WEIGHT	A3	00779	5209174
CUSTOMER DRAWING	SCALE	SHEET	REV
	1:1	1 OF 1	B