



### Main

|                               |                              |
|-------------------------------|------------------------------|
| Range of Product              | Harmony XB5                  |
| Product or Component Type     | Head for selector switch     |
| Device short name             | ZB5                          |
| Bezel material                | Dark grey plastic            |
| Mounting diameter             | 1.18 in (30 mm)              |
| Head type                     | Built-in-flush               |
| Sale per indivisible quantity | 1                            |
| Shape of signaling unit head  | Round                        |
| Type of operator              | Left to centre spring return |
| Operator profile              | Black knurled knob           |
| Operator position information | 3 positions +/- 45°          |

### Complementary

|                             |   |
|-----------------------------|---|
| CAD overall width           | 1.46 in (37 mm)   |
| CAD overall height          | 1.46 in (37 mm)   |
| CAD overall depth           | 1.81 in (46 mm)   |
| Net Weight                  | 0.07 lb(US) (0.034 kg)  |
| Mechanical durability       | 1000000 cycles  |
| Electrical composition code | C4 6 single and double front mounting<br>C5 5 single front mounting<br>C6 5 single and double front mounting<br>C7 4 single front mounting<br>C8 4 single and double front mounting<br>C11 3 single front mounting<br>C3 6 single front mounting<br>SF1 3 single front mounting |

### Environment

|                                       |   |
|---------------------------------------|---|
| Protective treatment                  | TH  |
| Ambient Air Temperature for Storage   | -40...158 °F (-40...70 °C)  |
| Ambient Air Temperature for Operation | -40...158 °F (-40...70 °C)  |
| Overvoltage category                  | Class II IEC 60536  |
| IP degree of protection               | IP69<br>IP69K<br>IP66 IEC 60529<br>IP67   |
| NEMA degree of protection             | NEMA 13<br>NEMA 4X  |
| Resistance to high pressure washer    | 1015.26 psi (7000000 Pa) 131 °F (55 °C) 0.1 m   |
| IK degree of protection               | IK03 IEC 50102  |
| Standards                             | EN/IEC 60947-5-4<br>EN/IEC 60947-5-1<br>JIS C8201-5-1<br>UL 508<br>EN/IEC 60947-1<br>CSA C22.2 No 14<br>JIS C8201-1 |

|                        |  |
|------------------------|--|
| Product Certifications | UL Listed<br>CSA<br>BV<br>GL<br>DNV<br>LROS (Lloyds register of shipping)  |
| Vibration resistance   | 5 gn 2...500 Hz)IEC 60068-2-6  |
| Shock resistance       | 30 gn 18 ms) half sine wave acceleration IEC 60068-2-27<br>50 gn 11 ms) half sine wave acceleration IEC 60068-2-27 |

## Ordering and shipping details

|                       |                                     |
|-----------------------|-------------------------------------|
| Category              | 22467-PUSHBUTTONS,22MM(PLASTIC) NEW |
| Discount Schedule     | CS2                                 |
| GTIN                  | 3606481340016                       |
| Nbr. of units in pkg. | 1                                   |
| Package weight(Lbs)   | 0.78 oz (22.0 g)                    |
| Returnability         | No                                  |
| Country of origin     | FR                                  |

## Packing Units

|                        |                   |
|------------------------|-------------------|
| Unit Type of Package 1 | PCE               |
| Package 1 Height       | 2.15 in (5.45 cm) |
| Package 1 width        | 1.69 in (4.3 cm)  |
| Package 1 Length       | 2.05 in (5.2 cm)  |

## Offer Sustainability

|                            |   |
|----------------------------|---|
| Sustainable offer status   | Green Premium product   |
| California proposition 65  | WARNING: This product can expose you to chemicals including: Di-isodecyl phthalate (DIDP), which is known to the State of California to cause birth defects or other reproductive harm. For more information go to <a href="http://www.P65Warnings.ca.gov">www.P65Warnings.ca.gov</a> |
| REACH Regulation           | <a href="#">REACH Declaration</a>   |
| REACH free of SVHC         | Yes   |
| EU RoHS Directive          | Pro-active compliance (Product out of EU RoHS legal scope) <a href="#">EU RoHS Declaration</a>  |
| Toxic heavy metal free     | Yes   |
| Mercury free               | Yes   |
| RoHS exemption information | <a href="#">Yes</a>   |
| China RoHS Regulation      | <a href="#">China RoHS Declaration</a>  |
| Environmental Disclosure   | <a href="#">Product Environmental Profile</a>   |
| Circularity Profile        | <a href="#">End Of Life Information</a>   |

Dimensions

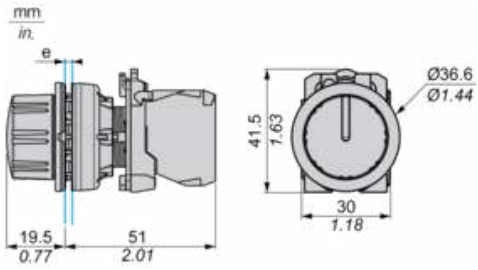

e: Clamping thickness: 1 to 6 mm / 0.04 to 0.24 in.

Panel Cut-out for Pushbuttons, Switches and Pilot Lights (Finished Holes, Ready for Installation)

Connection by Screw Clamp Terminals or Plug-in Connectors



(1) Diameter on finished panel or support

(2)  $\text{Ø}30.75 \text{ mm}$  recommended ( $\text{Ø}30.5 \text{ }_0^{+0.5}$ ) /  $\text{Ø}1.21 \text{ in.}$  recommended ( $\text{Ø}1.20 \text{ in. }_0^{+0.0196}$ )

| Connections                                   | a in mm | a in in. | b in mm | b in in. |
|---|---------|----------|---------|----------|
| By screw clamp terminals or plug-in connector | 40      | 1.57     | 40      | 1.57     |
| By Faston connectors                          | 45      | 1.77     | 40      | 1.57     |

---

Electrical Composition Corresponding to Code C3

---

Electrical Composition Corresponding to Code C4

---

Electrical Composition Corresponding to Code C5

---

Electrical Composition Corresponding to Code C6

---

Electrical Composition Corresponding to Code C7

---

## Electrical Composition Corresponding to Code C8

---

## Electrical Composition Corresponding to Codes C9, C11, SF1 and SR1

---

## Electrical Composition Corresponding to Code C15

---

1 N/O

1 N/C

1 N/O + N/C or 1 N/O + N/O or 1 N/C + N/C

## Legend

---

Single contact

Double contact

Light block

Possible location



## Sequence of Contacts Fitted to 2-position Selector Switch Body

### Position 315°



|          |          |        |        |        |      |
|----------|----------|--------|--------|--------|------|
| Push     | Position | Top    |        |        |      |
| Bottom   |          |        |        |        |      |
| Location |          | Left   | Centre | Right  |      |
| State    |          | 0      | 0      | 0      |      |
| Contacts | N/O      |        | open   | open   | open |
| N/C      |          | closed | closed | closed |      |

### Position 45°



|          |          |      |        |        |        |
|----------|----------|------|--------|--------|--------|
| Push     | Position | Top  |        |        |        |
| Bottom   |          |      |        |        |        |
| Location |          | Left | Centre | Right  |        |
| State    |          | 1    | 1      | 1      |        |
| Contacts | N/O      |      | closed | closed | closed |
| N/C      |          | open | open   | open   |        |