

THIS DRAWING IS A CONTROLLED DOCUMENT.

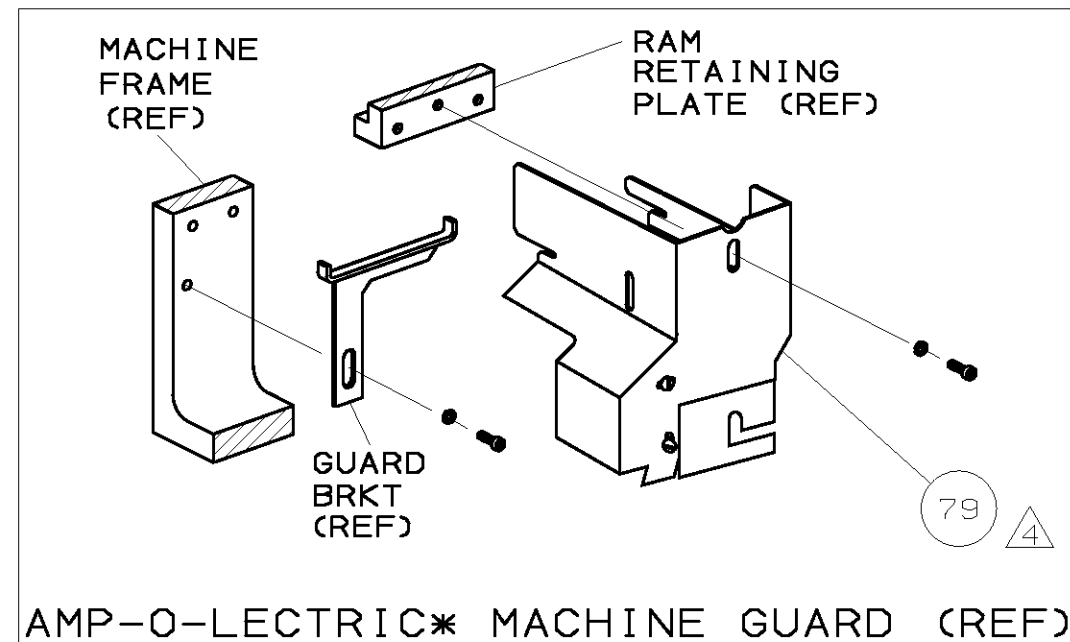

AMP-O-ELECTRIC* MACHINE GUARD (REF)

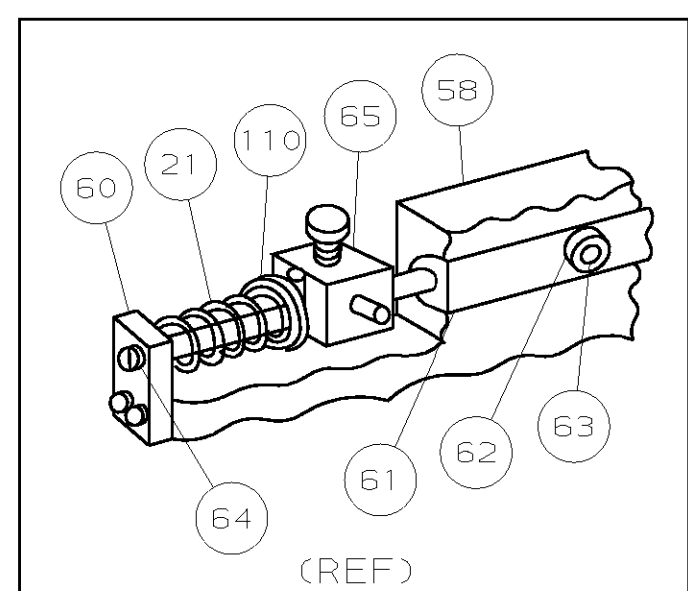
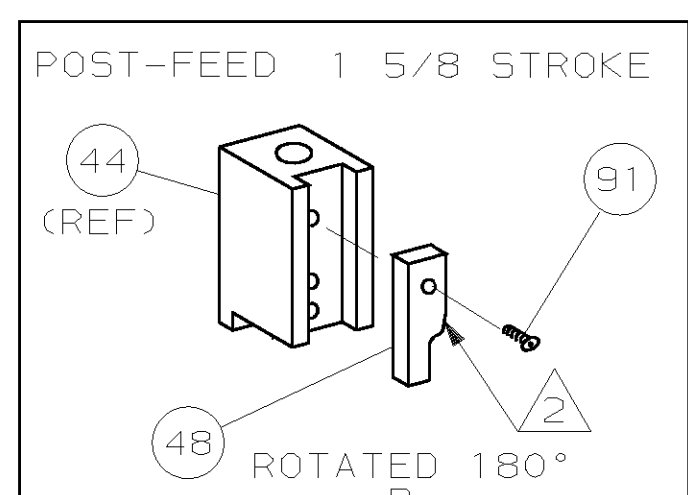
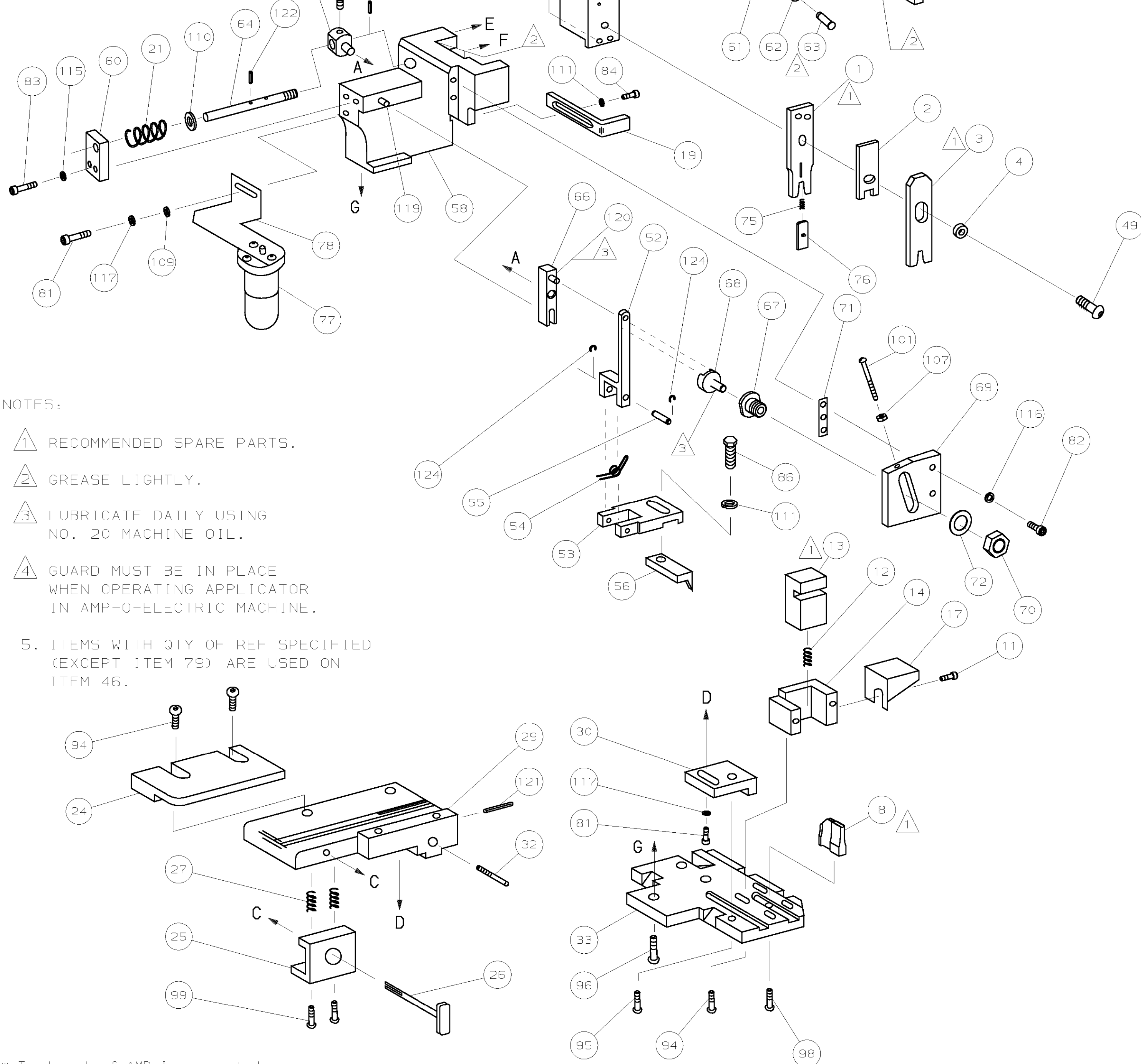

- NOTES:
- ① RECOMMENDED SPARE PARTS.
 - ② GREASE LIGHTLY.
 - ③ LUBRICATE DAILY USING NO. 20 MACHINE OIL.
 - ④ GUARD MUST BE IN PLACE WHEN OPERATING APPLICATOR IN AMP-O-ELECTRIC MACHINE.

5. ITEMS WITH QTY OF REF SPECIFIED (EXCEPT ITEM 79) ARE USED ON ITEM 46.

| QTY | PART NO | DESCRIPTION | ITEM NO |
|---------------------|--------------|---|-----------------------|
| REF | 21045-3 | RING, RET "C" (.187ø) FEED FINGER PIN | 124 |
| REF | 5-21028-1 | PIN, SLT SPR (.125øx.50) ADJ ROD | 123 |
| 1 | 4-21028-0 | PIN, SLT SPR (.093øx.75) ST GUIDE PL | 122 |
| REF | 1-21030-1 | PIN, DOWEL (.187øx.50) LEVER | 121 |
| REF | 1-21030-6 | PIN, DOWEL (.187øx1.25) HOUSING | 120 |
| 2 | 21024-5 | WASHER, LOCK (NO.10) ADJ BLOCK | 119 |
| REF | 21024-5 | WASHER, LOCK (NO.10) ADJ PLATE | 118 |
| REF | 21024-5 | WASHER, LOCK (NO.10) FEED GUIDE ROD | 117 |
| 114 | 1 | 7-21002-9 BOLT, CRIMPER (5/16-24x1.00) | 116 |
| 113 | 1 | 690501-4 CAM, POST-FEED 1 5/8 STROKE | 115 |
| 112 | | | 114 |
| 4 | 21024-4 | WASHER, LOCK (NO.8) STRIPPER | 111 |
| REF | 21899-4 | WASHER, FLAT (5/16 DIA) SCREW ADJ | 110 |
| 1 | 21899-2 | WASHER, FLAT (NO.10) LUB ASSY | 109 |
| REF | 21018-5 | NUT, HEX (6-32) FEED ADJ | 108 |
| 107 | 1 | 1-690124-3 WASHER, LAMINATED | 107 |
| 106 | | | 106 |
| 105 | 2 | 23241-6 BALL, STEEL | 105 |
| 104 | 2 | 690170-1 SPRING, COMPRESSION | 104 |
| 103 | 1 | 690142-4 DISC, INSULATION | 103 |
| 102 | 1 | 4-692155-0 DISC, WIRE | 102 |
| 101 | 1 | 22480-5 WASHER, SPRING | 101 |
| 100 | 1 | 690212-1 POST, RAM | 100 |
| 99 | 1 | 455675-1 PLATE, BASE | 99 |
| REF | 2-21002-9 | SCR, BHC (10-32x.75) DRAG | 98 |
| 97 | 1 | 690432-3 SCREW, ADJUSTMENT | 97 |
| 96 | 1 | 2-22733-8 SCR, BHC (10-32x.75) CAP | 96 |
| REF | 2-22733-8 | SCR, BHC (1/4-20x.62) HOUSING | 95 |
| REF | 2-21002-7 | SCR, BHC (10-32x.50) SG ADJ BLOCK | 94 |
| 4 | 2-21002-2 | SCR, BHC (8-32x.50) SHEAR | 93 |
| 92 | 2 | 1-22284-0 SPRING, DRAG | 92 |
| 91 | 1 | 690546-1 LEVER, DRAG RELEASE | 91 |
| 90 | 1 | 1-690754-7 DRAG, STOCK | 90 |
| 89 | 1 | 856167-1 GUIDE, STRIP (REAR) | 89 |
| 88 | | | 88 |
| 87 | 2 | 2-21000-6 SCR, SKT CAP (8-32x.38) DEP-HOLD DOWN | 87 |
| 86 | 1 | 2-22603-0 SCR, HEX HEAD (8-32x.31) FEED FINGER | 86 |
| 85 | | | 85 |
| 84 | 1 | 2-21000-7 SCR, SKT CAP (8-32x.50) STRIPPER | 84 |
| REF | 3-21000-7 | SCR, SKT CAP (10-32x.75) FEED ROD GD | 83 |
| REF | 3-21000-6 | SCR, SKT CAP (10-32x.62) FEED ADJ BLK | 82 |
| 2 | 3-21000-4 | SCR, SKT CAP (10-32x.38) SG ADJ BL | 81 |
| REF | 3-21000-4 | SCR, SKT CAP (10-32x.38) PIVOT BLOCK | 80 |
| REF | 455755-1 | GUARD, GUARD | 79 |
| 78 | 1 | 690462-1 HOLDER, SHEAR (REAR) | 78 |
| 77 | 1 | 690463-1 SHEAR, FLOAT (REAR) | 77 |
| 76 | 1 | 5-22280-0 SPRING, SHEAR | 76 |
| 75 | 1 | 690461-1 STOP, SHEAR | 75 |
| 74 | | | 74 |
| 73 | 2 | 690603-1 SPRING, ASSIST | 73 |
| REF | 23030-1 | SCR, SKT CAP (6-32x.25) CP DISC | 72 |
| REF | 458109-1 | WASHER, SPECIAL | 71 |
| REF | 690517-1 | SPACER | 70 |
| REF | 22594-8 | NUT, HEX | 69 |
| REF | 240628-1 | PLATE, ADJUSTMENT | 68 |
| REF | 240626-1 | SHAFT, PIVOT | 67 |
| REF | 240633-1 | BUSHING | 66 |
| REF | 455680-1 | LEVER, INTERMEDIATE | 65 |
| REF | 240629-1 | BLOCK, PIVOT | 64 |
| REF | 240632-2 | SCREW, ADJUSTMENT FEED ROD | 63 |
| REF | 240659-3 | PIN, CAM ROLLER | 62 |
| REF | 240658-1 | ROLLER, CAM | 61 |
| REF | 454398-2 | ROD, FEED | 60 |
| REF | 454178-1 | GUIDE, FEED ROD | 59 |
| 79 | | | 79 |
| 78 | | | 78 |
| 77 | | | 77 |
| 76 | | | 76 |
| 75 | | | 75 |
| 74 | | | 74 |
| 73 | | | 73 |
| 72 | | | 72 |
| 71 | | | 71 |
| 70 | | | 70 |
| 69 | | | 69 |
| 68 | | | 68 |
| 67 | | | 67 |
| 66 | | | 66 |
| 65 | | | 65 |
| 64 | | | 64 |
| 63 | | | 63 |
| 62 | | | 62 |
| 61 | | | 61 |
| 60 | | | 60 |
| 59 | | | 59 |
| 58 | | | 58 |
| 57 | | | 57 |
| 56 | | | 56 |
| 55 | | | 55 |
| 54 | | | 54 |
| 53 | | | 53 |
| 52 | | | 52 |
| 51 | | | 51 |
| 50 | | | 50 |
| 49 | | | 49 |
| 48 | | | 48 |
| 47 | | | 47 |
| 46 | | | 46 |
| 45 | | | 45 |
| 44 | | | 44 |
| 43 | | | 43 |
| 42 | | | 42 |
| 41 | | | 41 |
| 40 | | | 40 |
| 39 | | | 39 |
| 38 | | | 38 |
| 37 | | | 37 |
| 36 | | | 36 |
| 35 | | | 35 |
| 34 | | | 34 |
| 33 | | | 33 |
| 32 | | | 32 |
| 31 | | | 31 |
| 30 | | | 30 |
| 29 | | | 29 |
| 28 | | | 28 |
| 27 | | | 27 |
| 26 | | | 26 |
| 25 | | | 25 |
| 24 | | | 24 |
| 23 | | | 23 |
| 22 | | | 22 |
| 21 | | | 21 |
| 20 | | | 20 |
| 19 | | | 19 |
| 18 | | | 18 |
| 17 | | | 17 |
| 16 | | | 16 |
| 15 | | | 15 |
| 14 | | | 14 |
| 13 | | | 13 |
| 12 | | | 12 |
| 11 | | | 11 |
| 10 | | | 10 |
| 9 | | | 9 |
| 8 | | | 8 |
| 7 | | | 7 |
| 6 | | | 6 |
| 5 | | | 5 |
| 4 | | | 4 |
| 3 | | | 3 |
| 2 | | | 2 |
| 1 | | | 1 |
| QTY | PART NO | DESCRIPTION | ITEM NO |
| CRIMPING DATA | | | |
| PAD LTR | CRIMP HEIGHT | WIRE SIZE | APPLICATOR WILL APPLY |
| A | .030 | 26 | 170355-1 |
| B | .027 | 28 OR 30 | |
| C | NOT USED | | |
| D | NOT USED | | |
| CRIMP | SIZE | TYPE | FEED |
| WIRE | .042 | F | .295 |
| INSUL | .070 | F | A1 8040 |
| WIRE RANGE | 30-26 | INSULATION RANGE | .039-.059 |
| MACHINE NO | - | | |
| REMARKS | | | |
| AMPOMATOR POST FEED | | | |

RELEASED FOR PUBLICATION 2/FEB/1999 BY AMP INCORPORATED. ALL RIGHTS RESERVED. © COPYRIGHT 1999

* Trademark of AMP Incorporated