

DO NOT SCALE FROM THIS PRINT

TABLE 1				
ITEM	COMPONENT	-HN	-GN	*-MN
1	HEX NUT		BTNC-NUT-001-N	
2	LOCK WASHER		BTNC-LWAS-001-N	
3	GASKET		BTNC-GKT-001	
4	SUB ASSEMBLY	SUB-TNC-J-C-N-ST-BH1		
5	SKT	BTNC-SKT-003-H	BTNC-SKT-003-G	
6	INSULATOR		BTNC-INS-003	
7	INNER FERRULE		BTNC-FER-002-N	
8	OUTER FERRULE		BNC-FER-002-N	

GENDER -J: JACK
 TYPE -C: CABLE
 TERMINATION -BH1: BULKHEAD 1 (RG174 OR RG316)
 ORIENTATION -ST: STRAIGHT

PLATING SPECIFICATION
 -HN: 30μ" GOLD CENTER CONTACT, 100μ" NICKEL OUTER CONTACT
 -GN: 10μ" GOLD CENTER CONTACT, 100μ" NICKEL OUTER CONTACT
 *-MN: 10μ" GOLD CENTER CONTACT, 100μ" NICKEL OUTER CONTACT (SEE TABLE 1)
 *=FOR EXISTING CUSTOMERS ONLY

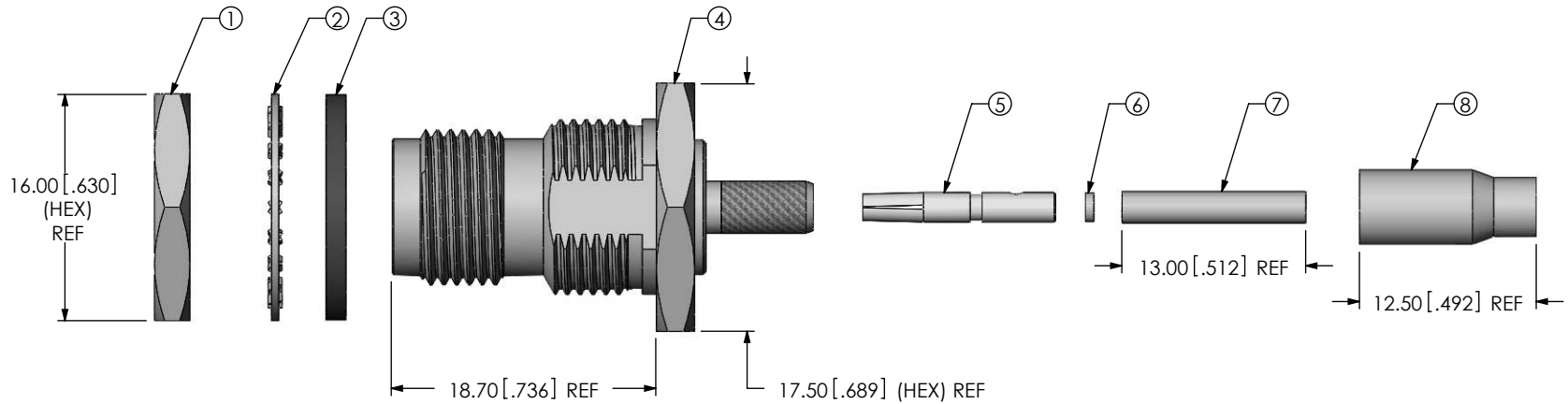

RECOMMENDED MOUNTING HOLE
 4.00 [.157] MAX PANEL THICKNESS

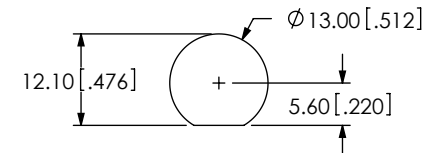

NOTES:

- Ⓢ REPRESENTS A CRITICAL DIMENSION.
- NOTE DELETED.
- NOTE DELETED.
- NOTE DELETED.
- TO PRODUCT TO BE PACKAGED PER PACKAGING STANDARD CO-HD-WI-3040-M.
- NOTE DELETED.
- NOTE DELETED.
- NOTE DELETED.
- NOTE DELETED.

UNLESS OTHERWISE SPECIFIED DIMENSIONS ARE IN MILLIMETERS [INCHES]	PROPRIETARY NOTE THIS DOCUMENT CONTAINS INFORMATION CONFIDENTIAL AND PROPRIETARY TO SAMTEC, INC. AND SHALL NOT BE REPRODUCED OR TRANSFERRED TO OTHER DOCUMENTS OR DISCLOSED TO OTHERS OR USED FOR ANY PURPOSE OTHER THAN THAT WHICH IT WAS OBTAINED WITHOUT THE EXPRESSED WRITTEN CONSENT OF SAMTEC, INC.	 520 PARK EAST BLVD, NEW ALBANY, IN 47150 PHONE: 812-944-6733 FAX: 812-948-5047 e-Mail: info@SAMTEC.com code 55322
TOLERANCES ARE: DECIMALS ANGLES .X: ±0.3 [.01] 5° .XX: ±0.13 [.005] .XXX: ±0.051 [.0020]	MATERIAL: DO NOT SCALE DRAWING SHEET SCALE: 2:1 SHELL, FERRULE, NUT, WASHER: BRASS CONTACT: COPPER ALLOY DIELECTRIC: PTFE GASKET: SILICON	
DESCRIPTION: TNC STRAIGHT CABLE JACK, RG174 & RG316 - 50 OHM		DWG. NO. TNC-J-C-XX-ST-BH1 BY: R MUSSER 09-09-2010 SHEET 1 OF 2

REVISION N

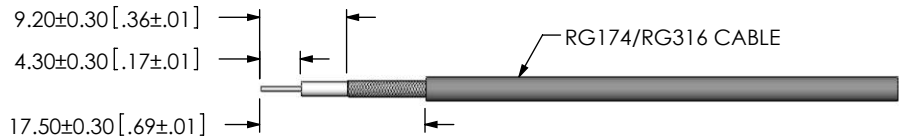

IN PROCESS 1
STRIP AND TIN INNER
CONDUCTOR

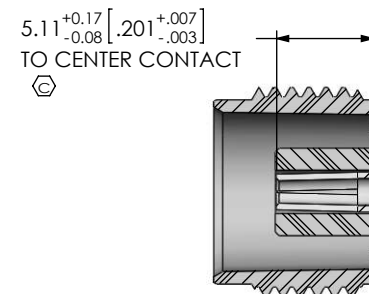

DETAIL 'A'
SCALE 2.5 : 1

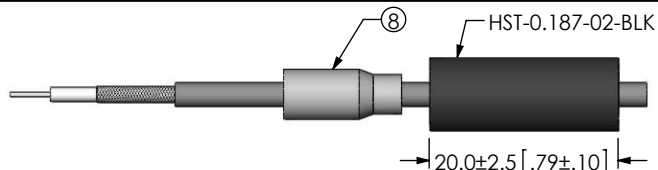

IN PROCESS 2
ADD HEAT SHRINK
TUBE AND FERRULE

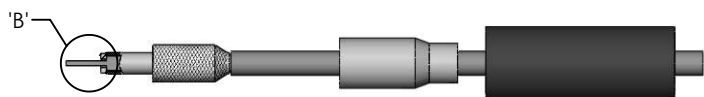

IN PROCESS 3
FLARE SHIELD, ADD INNER
FERRULE AND INSULATOR

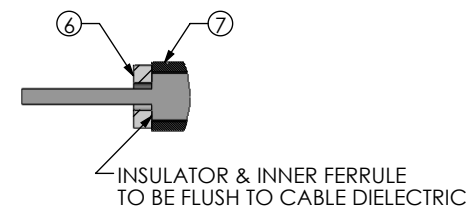

DETAIL 'B'
SCALE 4 : 1

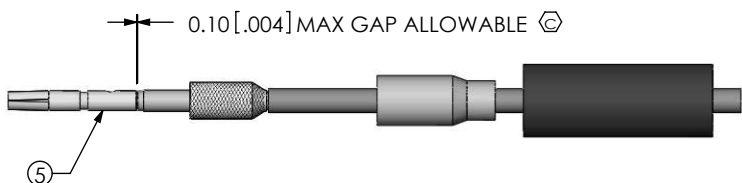

IN PROCESS 4
SOLDER SIGNAL SOCKET

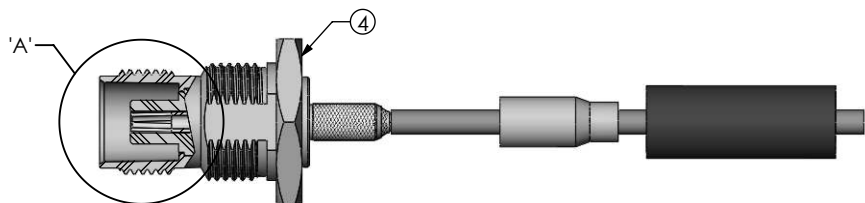

IN PROCESS 5
ADD SUB ASSEMBLY

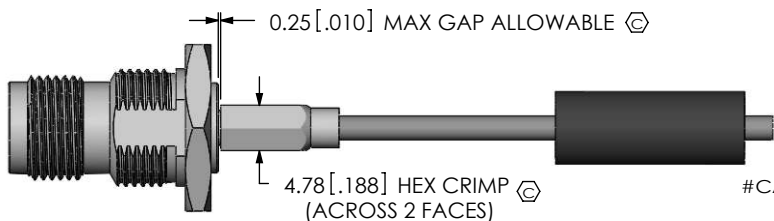

IN PROCESS 6
CRIMP FERRULE
(USE RF CRIMP HAND TOOL
#CAT-HT-126667-21 OR EQUIVALENT)
(USE .178 HEX DIE)

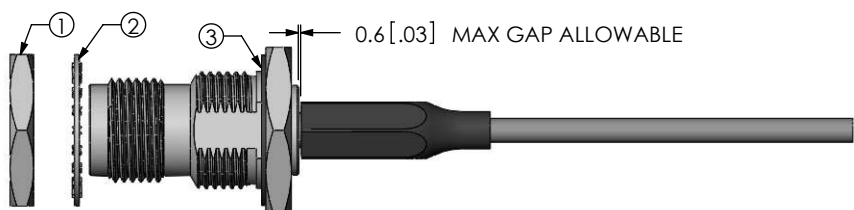

IN PROCESS 7
APPLY HEAT SHRINK TUBE
& ADD GASKET

C:\EnterpriseVault\DWG\MISC\MKTG\TNC-J-C-XX-ST-BH1-MKT.SLDDRW

PROPRIETARY NOTE

THIS DOCUMENT CONTAINS INFORMATION
CONFIDENTIAL AND PROPRIETARY TO
SAMTEC, INC. AND SHALL NOT BE REPRODUCED
OR TRANSFERRED TO OTHER DOCUMENTS OR
DISCLOSED TO OTHERS OR USED FOR ANY
PURPOSE OTHER THAN THAT WHICH IT WAS
OBTAINED WITHOUT THE EXPRESSED WRITTEN
CONSENT OF SAMTEC, INC.



520 PARK EAST BLVD, NEW ALBANY, IN 47150
PHONE: 812-944-6733 FAX: 812-948-5047
e-Mail info@SAMTEC.com code 55322

DO NOT SCALE DRAWING

SHEET SCALE: 5:4

DESCRIPTION:
TNC STRAIGHT CABLE JACK, RG174 & RG316 - 50 OHM

DWG. NO.
TNC-J-C-XX-ST-BH1

BY: R MUSSER 09-09-2010 SHEET 2 OF 2