

MATED WITH HEADER ASSEMBLY
[REFERENCE]

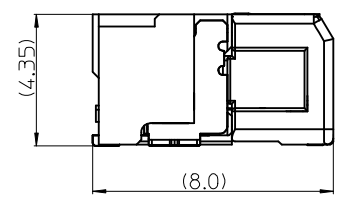
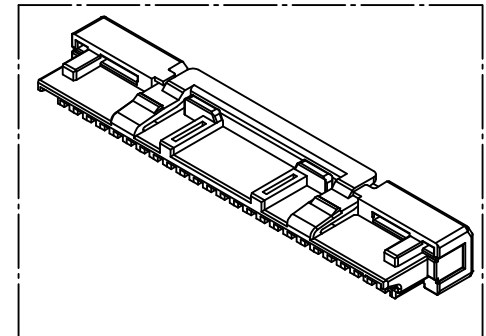

MATED WITH HEADER ASSEMBLY
[REFERENCE]

NOTES.

1. MATERIAL : LIQUID CRYSTAL POLYMER(LCP), GLASS FILLED, UL94 V-0, COLOR: NATURAL(IVORY)
2. PRODUCT SPECIFICATION : PS-104091-001
3. PACKAGING SPECIFICATION : PK-104091-001
4. MATED WITH :
HEADER ASS'Y: 104091-2520
TERMINAL : 502381-6001, 104521-6001

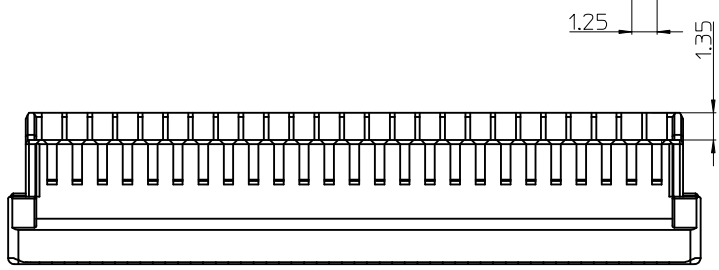
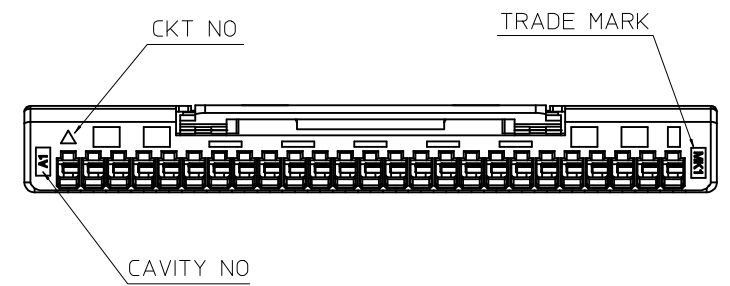
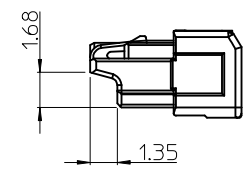
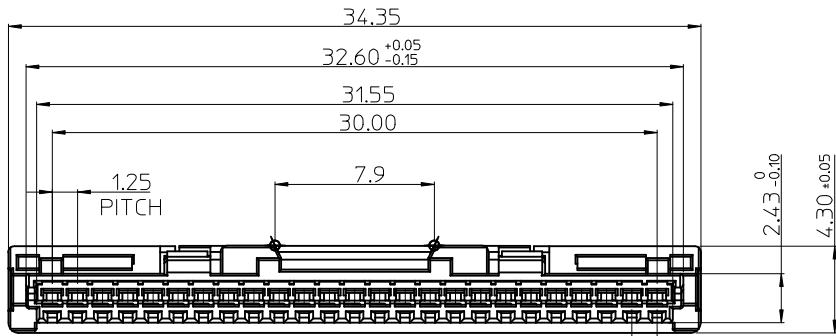

RELEASED
EC NO: KOR2012-0127
DRWN:SKCHU 2012/06/25
CHKD:SHCHU 2012/06/25
APPR:YSK1M02 2012/08/06

REV	DESCRIPTION
A	

QUALITY SYMBOLS	
	=0
	=0
GENERAL TOLERANCES (UNLESS SPECIFIED)	
	mm INCH
4 PLACES	± --- ± ---
3 PLACES	± --- ± ---
2 PLACES	± 0.15 ± ---
1 PLACE	± 0.20 ± ---
ANGULAR ± 1 °	
DRAFT WHERE APPLICABLE MUST REMAIN WITHIN DIMENSIONS	

DIMENSION STYLE	
MM ONLY	
DRAWN BY	DATE
JHPARK	2011/04/11
CHECKED BY	DATE
SHCHU	2011/04/11
APPROVED BY	DATE
YSK1M02	2012/08/06
MATERIAL NO.	
1040922500	
SIZE	
A3	

ORDER NO	104092-2500
SCALE	4/1
DESIGN UNITS	METRIC
THIRD ANGLE PROJECTION	
TITLE	
1.25 WTB CONN. R/A -25P PLUG HOUSING	
MOLEX INCORPORATED	
MATERIAL NO.	SD-104092-007
DOCUMENT NO.	
SHEET NO.	1 OF 1
THIS DRAWING CONTAINS INFORMATION THAT IS PROPRIETARY TO MOLEX INCORPORATED AND SHOULD NOT BE USED WITHOUT WRITTEN PERMISSION	