

PRODUCT DESCRIPTION CODE :

10155500-AXXXK LF

CODING TYPE :  
 A = CODING A  
 B = CODING B  
 C = CODING C

RoHS COMPATIBLE, SEE NOTE 4  
 FOR CUSTOMER CODE :  
 BLANK = GENERAL USE  
 PACKAGING :  
 K = TAPE & REEL  
 NUMBER OF POSITIONS : 02 TO 16  
 PLATING :  
 1 = 3µm MIN MATTE TIN (PREPLATED)  
 2 = 3µm MIN MATTE TIN (POST-PLATED)  
 3 = 0.76µm MIN GOLD (CONTACT AREA)  
 ALL OVER 1.27µm MIN NICKEL UNDERLAYER

NOTES:

- 1 - MATERIAL:  
 HOUSING : HIGH TEMPERATURE THERMOPLASTIC  
 COLOR BLACK UL94 V-0  
 PIN : HIGH CURRENT COPPER ALLOY
- 2 - TO BE MATED WITH MINITEK MicroSpaceXS RECEPTACLE SERIES 10155504
- 3 - PRODUCT SPECIFICATION : GS-12-1634  
 APPLICATION SPECIFICATION: GS-20-0657  
 PACKAGING SPECIFICATION : GS-14-2777
- 4 - RoHS COMPATIBLE PRODUCT SPECIFICATIONS
  - a - PLATING:  
 "LF" MEANS THE PRODUCT IS LEAD FREE,  
 3µm MINIMUM MATTE TIN OVER 1.27µm MINIMUM NICKEL UNDERPLATE.
  - b - MANUFACTURING PROCESS COMPATIBILITY:  
 THE HOUSING WILL WITHSTAND EXPOSURE TO 260°C PEAK TEMPERATURE FOR 30 SECONDS MAX IN A CONVECTION, INFRA-RED OR VAPOR PHASE OR REFLOW OVEN.
  - c - LABELLING :  
 MEETS PACKAGING SPECS AS PER GS-14-920
  - d - LEGAL STATEMENT :  
 SEE GS-47-0004.

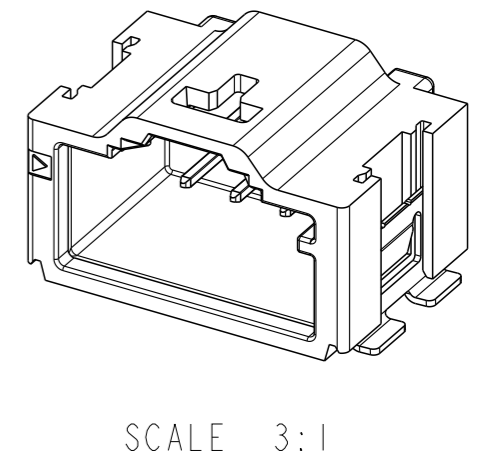
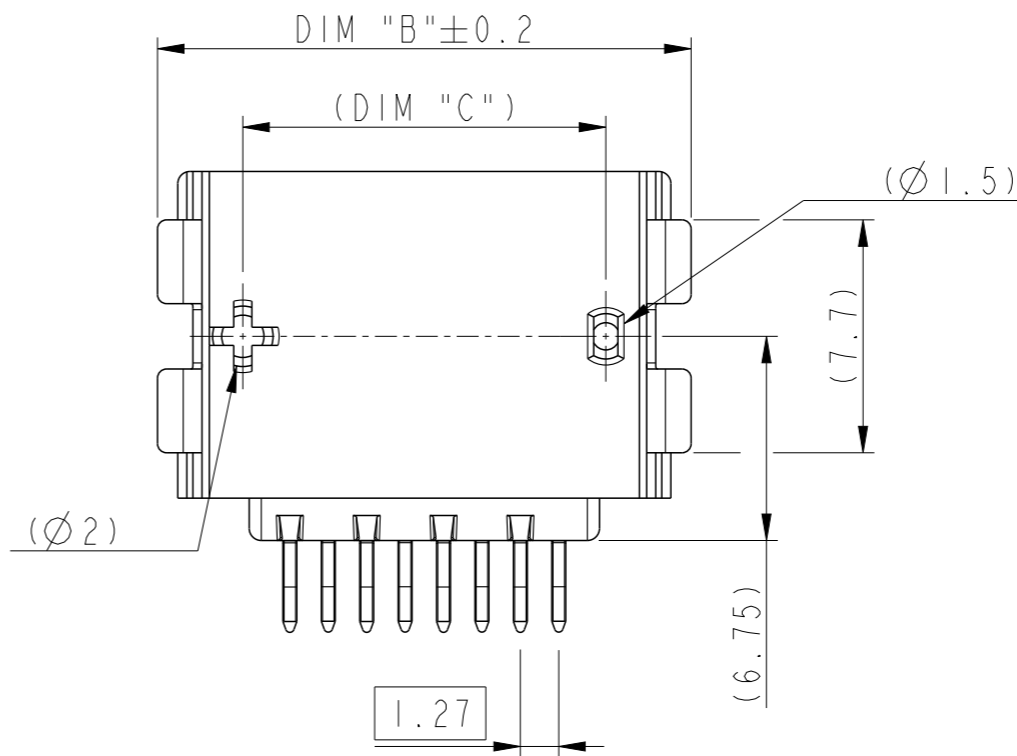
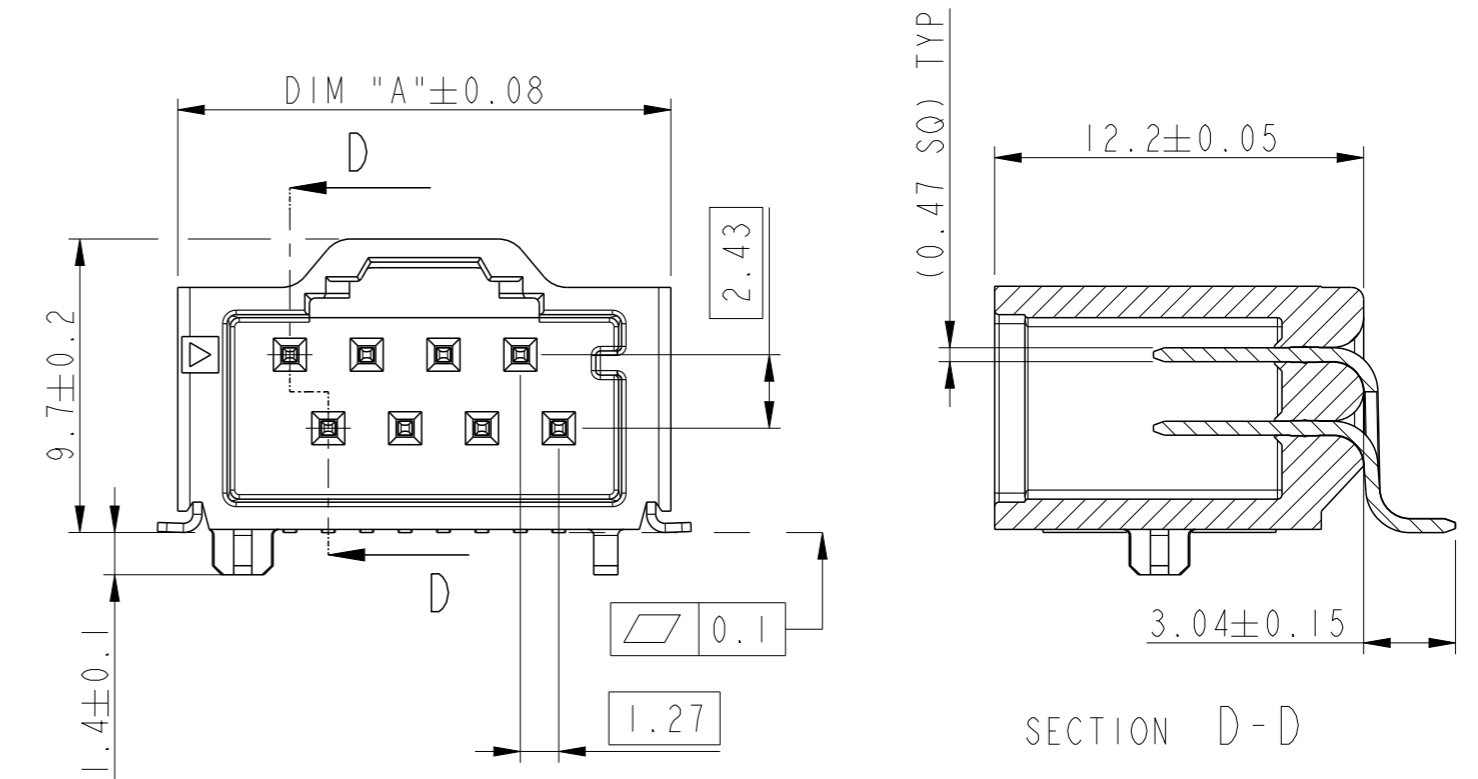

spec ref	dr	Sawanth, Ambaa	2020/06/01	projection	mm	size	A3	scale	4:1
tolerance std	eng	Canque, Vincen	2023/04/24			ecn no	ELX-F-47927-1	rel level	Released
ISO 406 ISO 1101	chr	Hyppias, Arnau	2023/04/28						
surface	linear	0.X	±0.3		product family	cat. no.	-	Product - Customer Drw	sheet 1 of 4
		0.XX	±0.1						
ISO 1302	angular	0°	±2°	TITLE HEADER ASSY STG TOP LATCH MINITEK MicroSpaceXS	dwg no 10155500	rev E			

Amphenol FCI

© 2020 Amphenol Corporation

COD A VIEWS AND DIMENSIONS

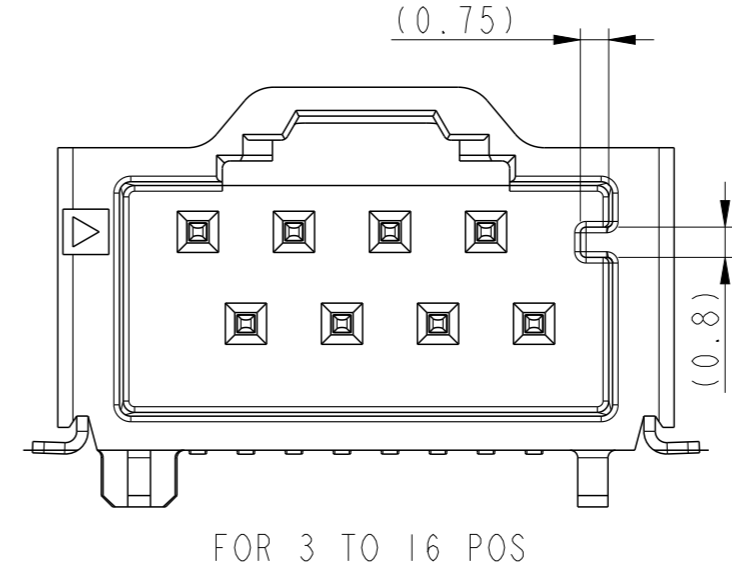
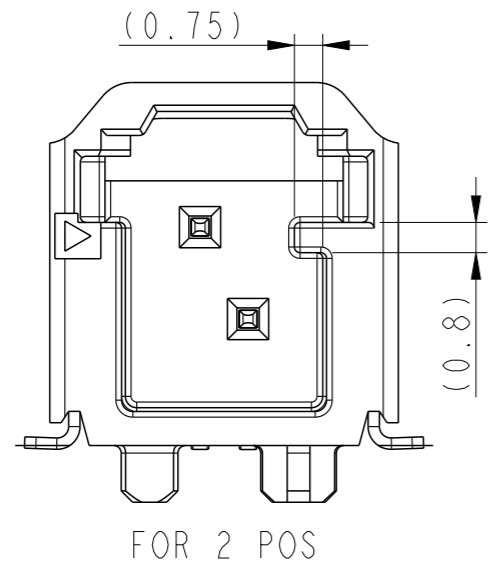

COD B VIEWS AND DIMENSIONS

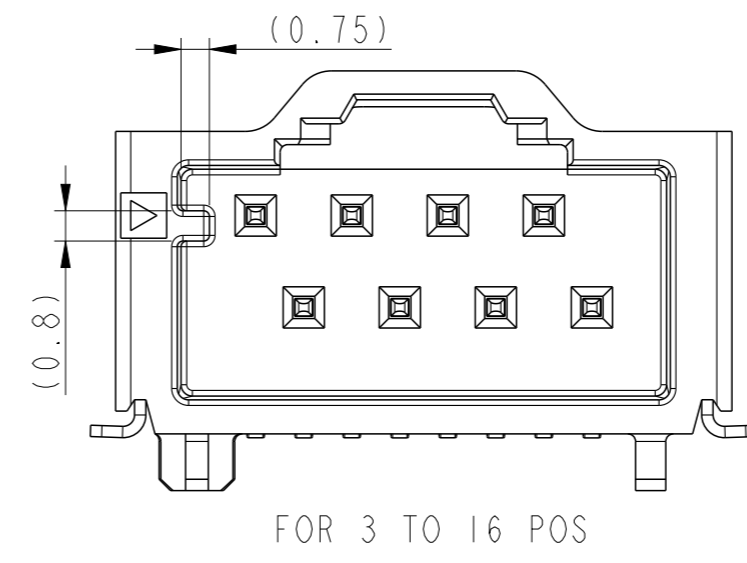
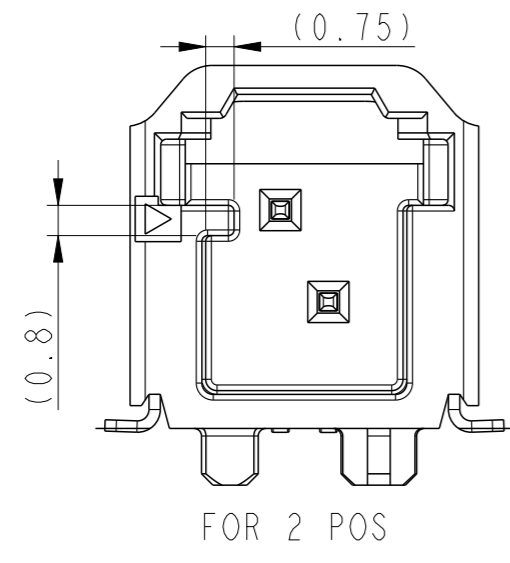

COD C VIEWS AND DIMENSIONS

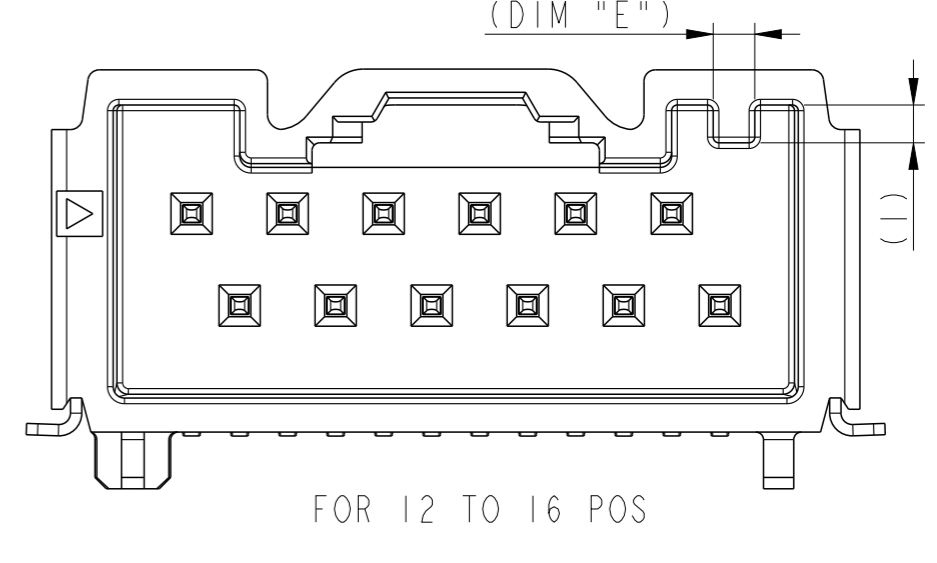
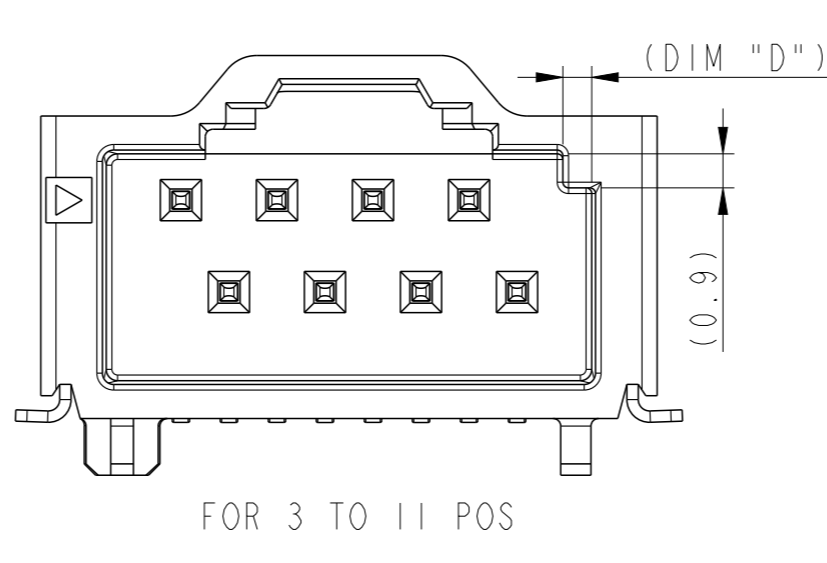
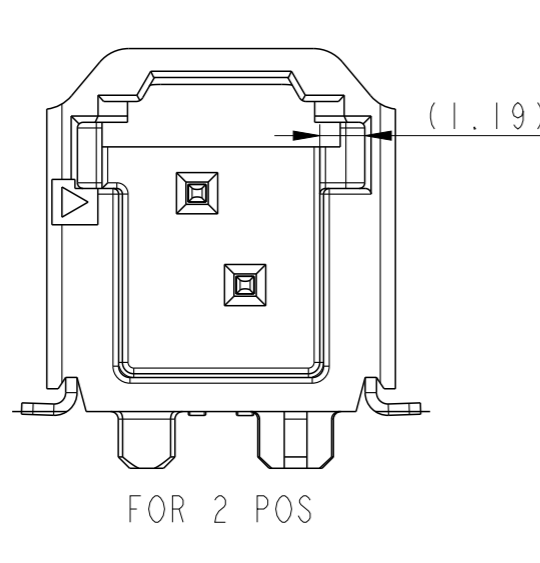

spec ref	GS-12-1634	dr	Sawanth, Ambaa	2020/06/01	projection	mm	size	A3	scale	5:1
tolerance std	ISO 406 ISO 1101	eng	Canque, Vincen	2023/04/24			ecn no	ELX-F-47927-1		
TOLERANCES UNLESS OTHERWISE SPECIFIED		chr	Hyppias, Arnau	2023/04/28			rel level	Released		
surface	linear	0.X	±0.3		product family		-		cat. no. - Product - Customer Drw	sheet 2 of 4
		0.XX	±0.1		HEADER ASSY STG TOP LATCH		dwg no 10155500	rev E		
	angular	0°	±2°		MINITEK MicroSpaceXS					
ISO 1302										

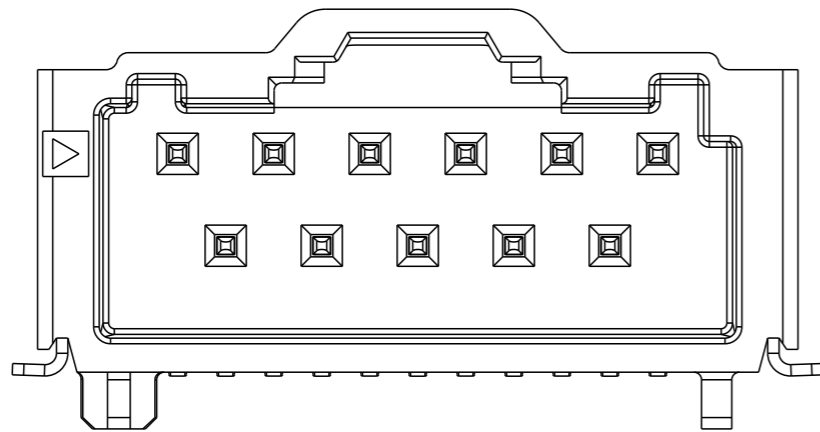
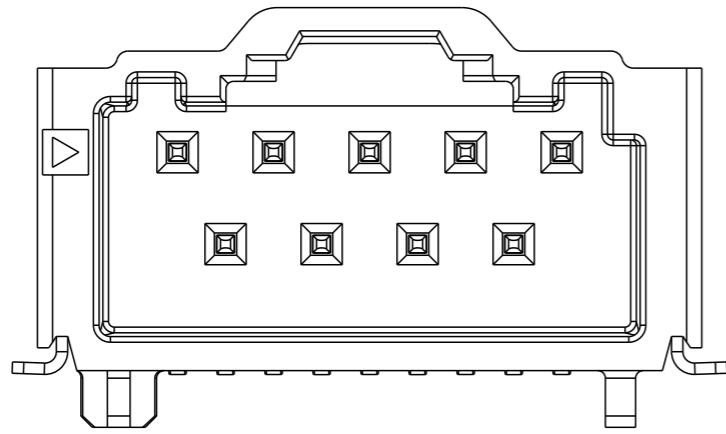

GROOVES ILLUSTRATION : FOR 09 TO 11-POS VERSION

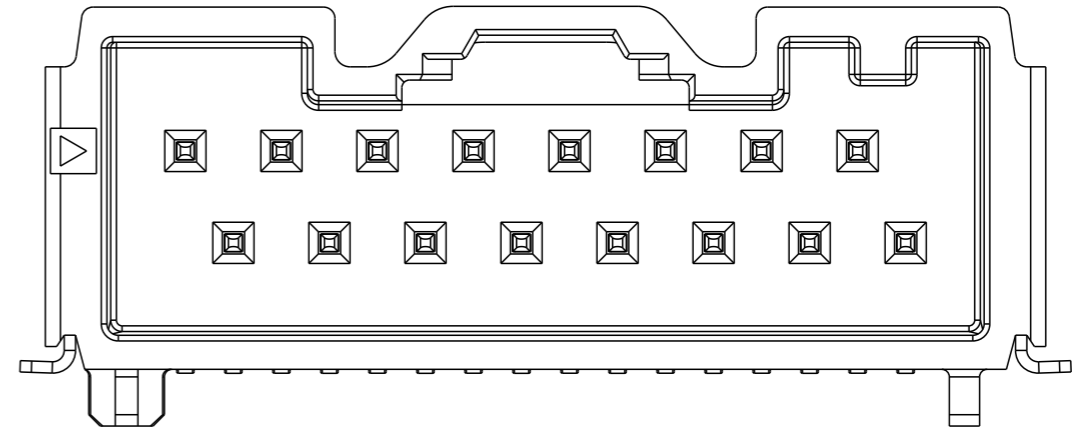
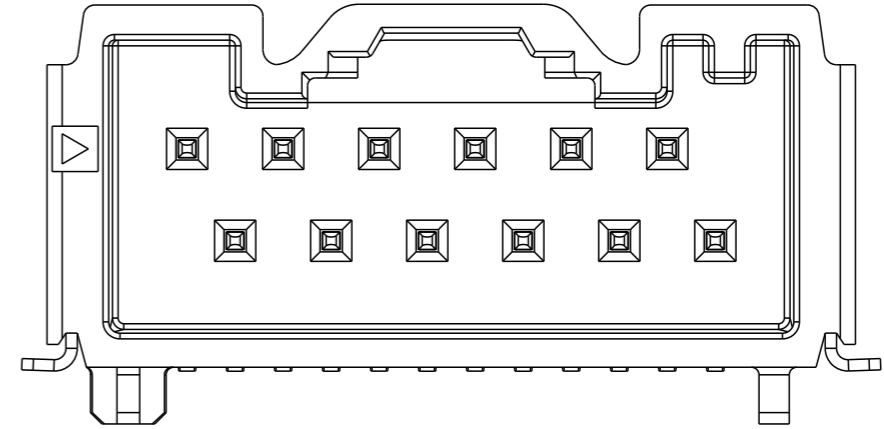

GROOVES ILLUSTRATION : FOR 12 TO 16-POS VERSION

spec ref	GS-12-1634			dr	Sawanth, Ambaa	2020/06/01	projection 	mm ←→	size	A3	scale	5:1	
tolerance std	ISO 406 ISO 1101			eng	Canque, Vincen	2023/04/24			ecn no	ELX-F-47927-1			
TOLERANCES UNLESS OTHERWISE SPECIFIED				chr	Hyppias, Arnau	2023/04/28			rel level	Released			
surface	linear	0.X	±0.1	Amphenol FCi	amphenol-icc.com	cat. no.	-	Product - Customer Drw	sheet 3 of 4	dwg no	10155500	rev	E
ISO 1302		0.XX	±0.1										
	angular	0°	±2°										

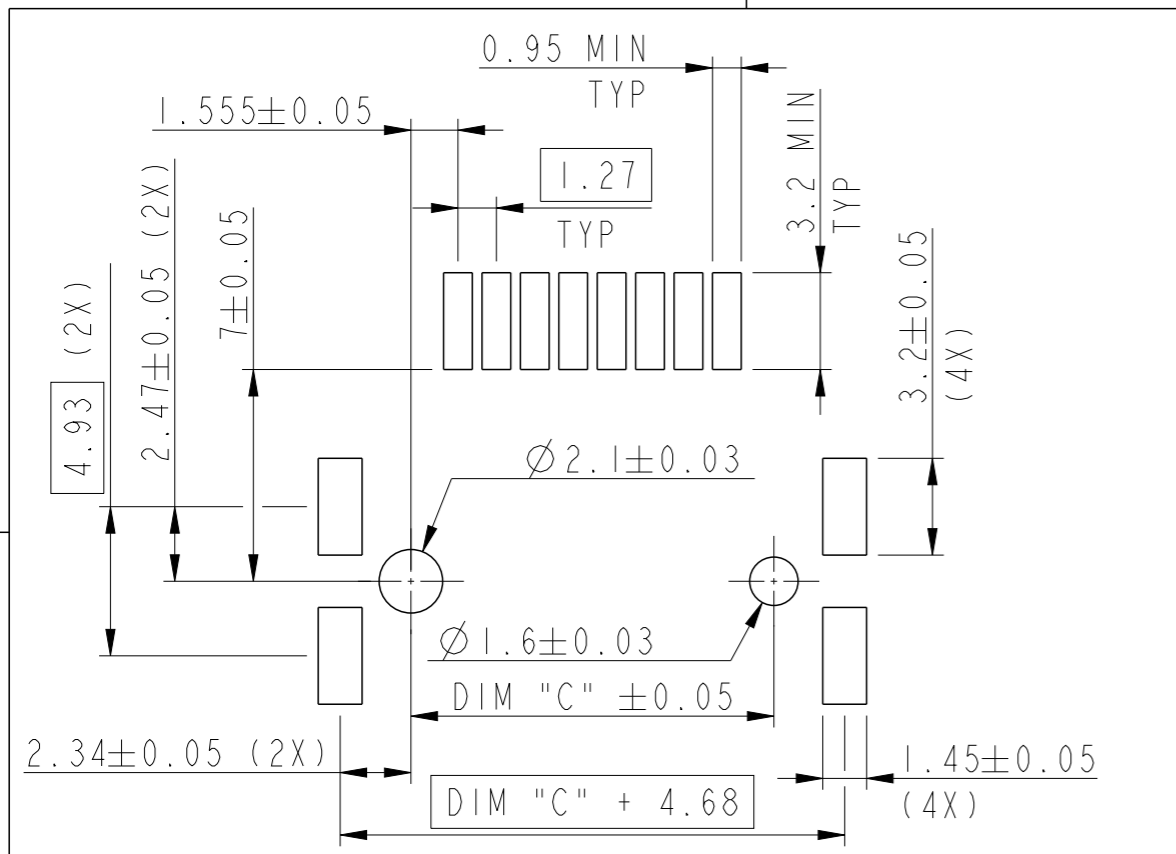

RECOMMENDED PCB LAYOUT FOR 4 pos to 16 pos  
FOR STENCIL THICKNESS SEE APPLICATION SPEC

PART NO.	AVAILABILITY	NO. OF POSN	DIM "A"	DIM "B"	DIM "C"	DIM "D"	DIM "E"
10155500-AX02KLF	ON DEMAND	02	09.22	10.56	N/A	N/A	N/A
10155500-AX03KLF	ON DEMAND	03	09.95	11.29	N/A	0.59	N/A
10155500-AX04KLF	ON DEMAND	04	11.22	12.56	06.92	0.76	N/A
10155500-AX05KLF	ON DEMAND	05	12.49	13.83	08.19	0.72	N/A
10155500-AX06KLF	ON DEMAND	06	13.76	15.10	09.46	0.76	N/A
10155500-AX07KLF	ON DEMAND	07	15.03	16.37	10.73	0.76	N/A
10155500-AX08KLF	TOOLED	08	16.30	17.64	12.00	0.76	N/A
10155500-AX09KLF	ON DEMAND	09	17.57	18.91	13.27	0.76	N/A
10155500-AX10KLF	TOOLED	10	18.84	20.18	14.54	0.76	N/A
10155500-AX11KLF	ON DEMAND	11	20.11	21.45	15.81	0.76	N/A
10155500-AX12KLF	ON DEMAND	12	21.38	22.72	17.08	N/A	1.10
10155500-AX13KLF	ON DEMAND	13	22.65	23.99	18.35	N/A	1.10
10155500-AX14KLF	ON DEMAND	14	23.92	25.26	19.62	N/A	1.50
10155500-AX15KLF	TOOLED	15	25.19	26.53	20.89	N/A	1.50
10155500-AX16KLF	ON DEMAND	16	26.46	27.80	22.16	N/A	1.50

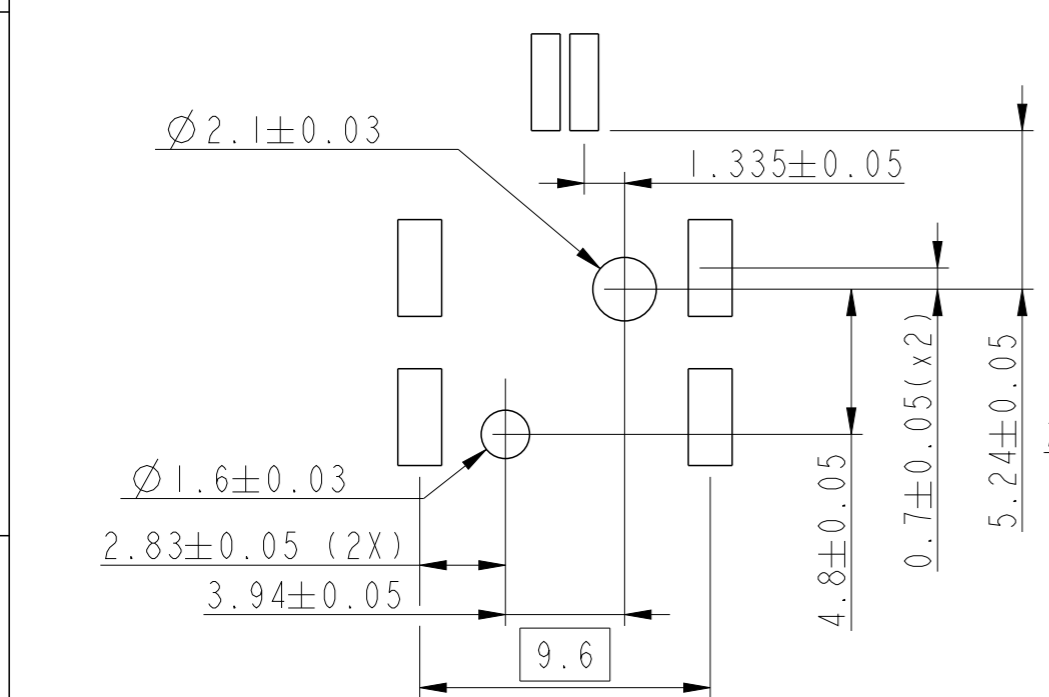

RECOMMENDED PCB LAYOUT FOR 2 pos  
FOR STENCIL THICKNESS SEE APPLICATION SPEC

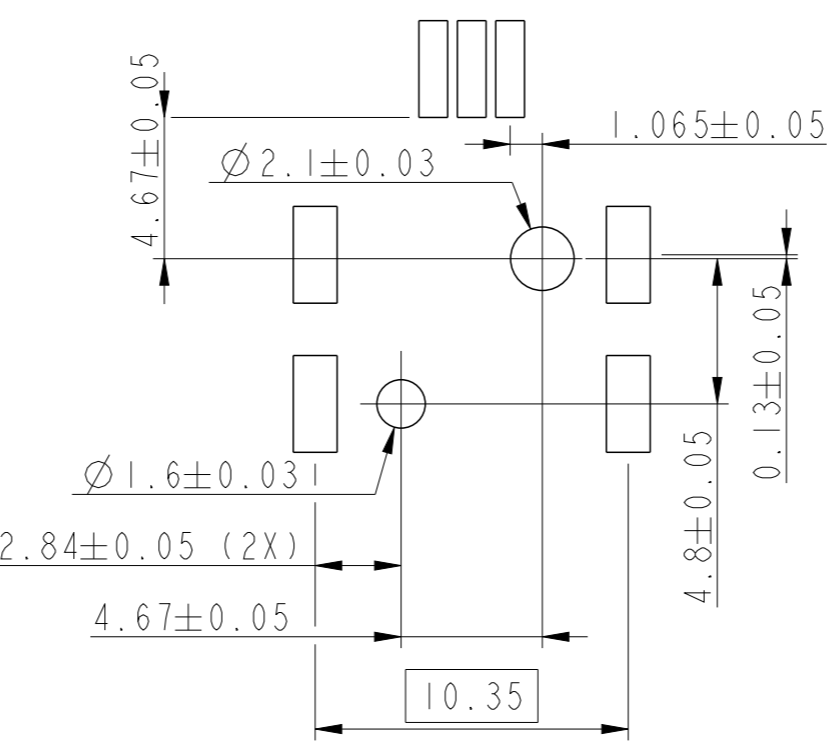

RECOMMENDED PCB LAYOUT FOR 3 pos  
FOR STENCIL THICKNESS SEE APPLICATION SPEC

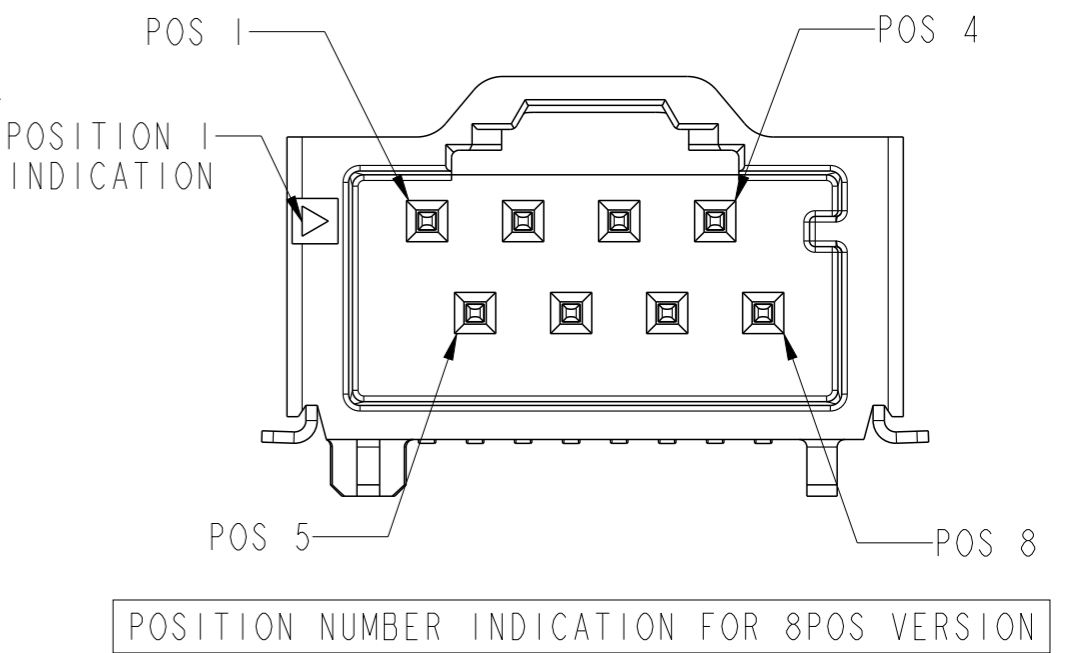

spec ref	GS-12-1634	dr	Sawanth, Ambaa	2020/06/01	projection	mm	size	A3	scale	5:1
tolerance std	ISO 406 ISO 1101	eng	Canque, Vincen	2023/04/24			ecn no	ELX-F-47927-1		
TOLERANCES UNLESS OTHERWISE SPECIFIED		chr	Hyppias, Arnau	2023/04/28				rel level	Released	
surface	linear	0.X	±0.3	<b>Amphenol FCI</b>	product family		dwg no	10155500		rev
		0.XX	±0.1		MINITEK MicroSpaceXS					
	angular	0°	±2°		cat. no.	-				