

ELECTRICAL SPECIFICATION

PARAMETER	SYMBOL	CONDITIONS	VALUE	UNIT
Nominal Frequency	f_o	$V_{CC} \pm 5\%$	26.000	MHz
Supply Voltage, nom.	V_{CC}	$V_{CC} \pm 5\%$	3.3	VDC
Supply Current, max	I_S	$V_{CC} \pm 5\%$	1.5	mA
Operating Temperature Range	T_a		-40 ~ +85	°C
Storage Temperature Range	$T(stg)$	Absolute max	-40 ~ +85	°C
Frequency Stability vs. Temperature	$\Delta f/f_o(T_a)$	Reference to +25°C ±2°C (-30 ~ +85°C)	±0.5	ppm
		Reference to +25°C ±2°C (-40 ~ -30°C)	±1.0	ppm
Frequency Stability vs. Supply Voltage	$\Delta f/f_v$	$V_{CC} \pm 5\%$	±0.2	ppm
vs. Load	$\Delta f/f_L$	Load ±10%	±0.2	ppm
vs. Aging max	$\Delta f/f_o(\text{year})$	Per Year at +25°C ± 2°C	±1.0	ppm
Initial Frequency Calibration, max		Measured at 25°C, after 2 reflows	±2.0	ppm
Output Level, Clipped Sine Wave		10 kΩ // 10 pF ±10%	0.8	V _{P-P}
Start-up Time			2.0	ms
Phase Noise, typ	$\mathcal{L}(\Delta f)$	@10 Hz	-88	dBc/Hz
	$\mathcal{L}(\Delta f)$	@100 Hz	-112	dBc/Hz
	$\mathcal{L}(\Delta f)$	@1 kHz	-133	dBc/Hz
	$\mathcal{L}(\Delta f)$	@10 kHz	-145	dBc/Hz
	$\mathcal{L}(\Delta f)$	@100 kHz	-148	dBc/Hz

MECHANICAL SPECIFICATION

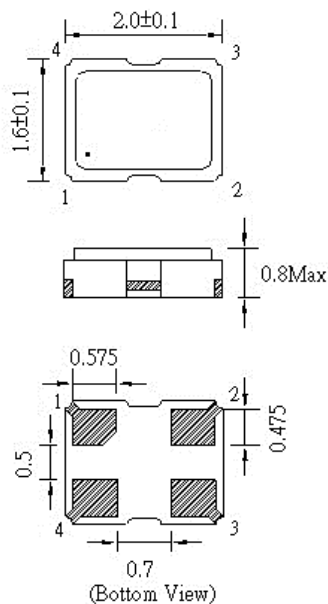

Pin Connections
 1 : Gnd
 2 : Gnd
 3 : Output
 4 : V_{CC}

REFLOW PROFILE

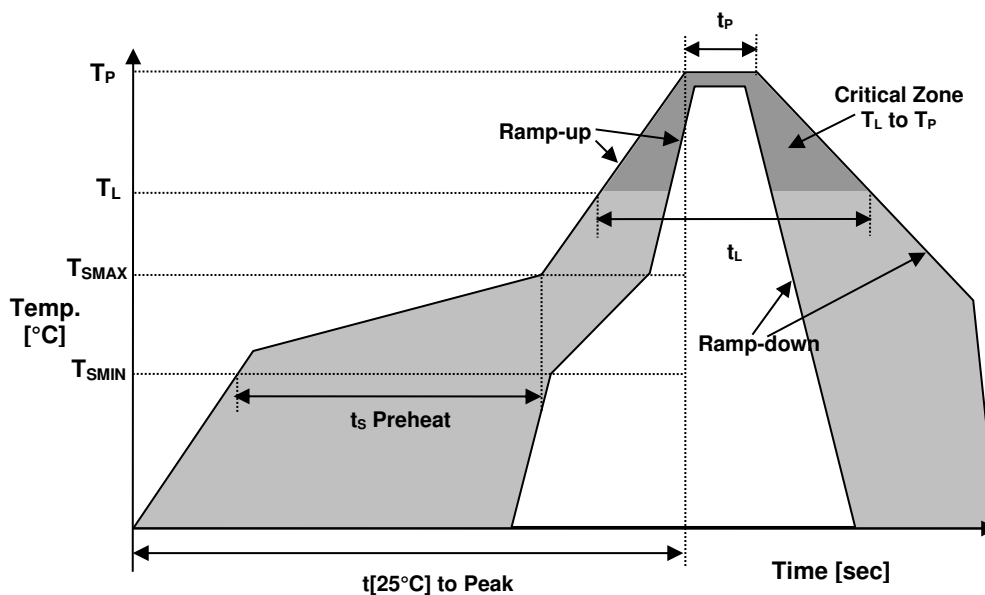

Reflow profile		
Temperature Min Preheat	T_{SMIN}	150°C
Temperature Max Preheat	T_{SMAX}	200°C
Time (T_{SMIN} to T_{SMAX})	t_s	60-120 sec.
Temperature	T_L	217°C
Peak Temperature	T_P	260°C
Ramp-up rate	R_{UP}	3°C/sec max.
Ramp-down rate	R_{DOWN}	6°C/sec max.
Time within 5°C of Peak Temperature	t_P	30 sec.
Time $t[25^\circ\text{C}]$ to Peak Temperature	$t[25^\circ\text{C}] \text{ to Peak}$	480 sec.
Time	t_L	60-150 sec.

• ENVIRONMENTAL

PARAMETER	VALUE
MOISTURE SENSITIVITY LEVEL	1
REACH	Compliant
RoHS	Compliant
TERMINATION FINISH	Au



MARKING

Rx16.36

•AD3yw

x – Internal Production ID code

y – Year code

w – Week code

YEAR CODE	
Year	Code
2015	5
2016	6
2017	7
2018	8
2019	9
2020	0
2021	1
2022	2
2023	3

ALPHA WEEK CODE TABLE					
Week	Code	Week	Code	Week	Code
1	a	19	s	37	K
2	b	20	t	38	L
3	c	21	u	39	M
4	d	22	v	40	N
5	e	23	w	41	O
6	f	24	x	42	P
7	g	25	y	43	Q
8	h	26	z	44	R
9	i	27	A	45	S
10	j	28	B	46	T
11	k	29	C	47	U
12	l	30	D	48	V
13	m	31	E	49	W
14	n	32	F	50	X
15	o	33	G	51	Y
16	p	34	H	52	Z
17	q	35	I		
18	r	36	J		

APPROVALS

RALTRON	
Created by, date:	CP, January 20, 2020
Eng. approval, date:	JL, January 20, 2020
Revision:	A

Raltron Electronics / RAMI Technology USA, LLC, including its affiliates, employees, agents and other persons acting on its behalf (collectively Raltron/RAMI Tech), disclaim any and all liability for any errors or inaccuracies contained in this data sheet. While Raltron/RAMI Tech has made every reasonable effort to ensure the accuracy of all product information, specifications and data contained herein, Raltron/RAMI Tech does not guarantee that the information is accurate, reliable or current. The product information is provided only for reference purposes only and is subject to change, correction or revision, at any time without notice. Raltron/RAMI Tech does not assume any liability arising out of an application or use of any product described herein and disclaims any warranties expressed or implied. The user of products in such applications shall assume all risks of such use and will agree to hold Raltron/RAMI Tech, harmless against all damages.

Copyright © 2016, Raltron Electronics / RAMI Technology USA, LLC. All rights reserved. No part of this document may be reproduced in any form without the prior written permission of Raltron Electronics / RAMI Technology USA, LLC.