

Squba 1.80 and 3.60mm-Pitch Sealed Wire-To-Wire Connector System

molex

Squba 1.80 and 3.60mm-Pitch Sealed Wire-to-Wire Connector Systems are designs that offer an IP67-seal rating and carry up to 14.0A of current to deliver reliable power in a wide range of space-constrained applications

Features and Advantages

Protected, low-profile positive latch

Prevents wire from getting caught on latch and damaging it. Minimizes latch size to prevent latch from adding to connector's package size

Mated housings

Offers receptacle and plug housings to fit design need

Seal caps

Protect seals from damage during shipping, handling and use. Align terminals to prevent seal from being punctured during assembly

Sealed components with proven performance

Delivers an IP67-sealed rating. Prevents ingress of dust and water to ensure reliable connection

Voided circuit options (1.80mm-pitch version)

Offers design flexibility for 3, 5, 7 and 9 circuit needs

Clean-body terminals

Avoids seal punctures

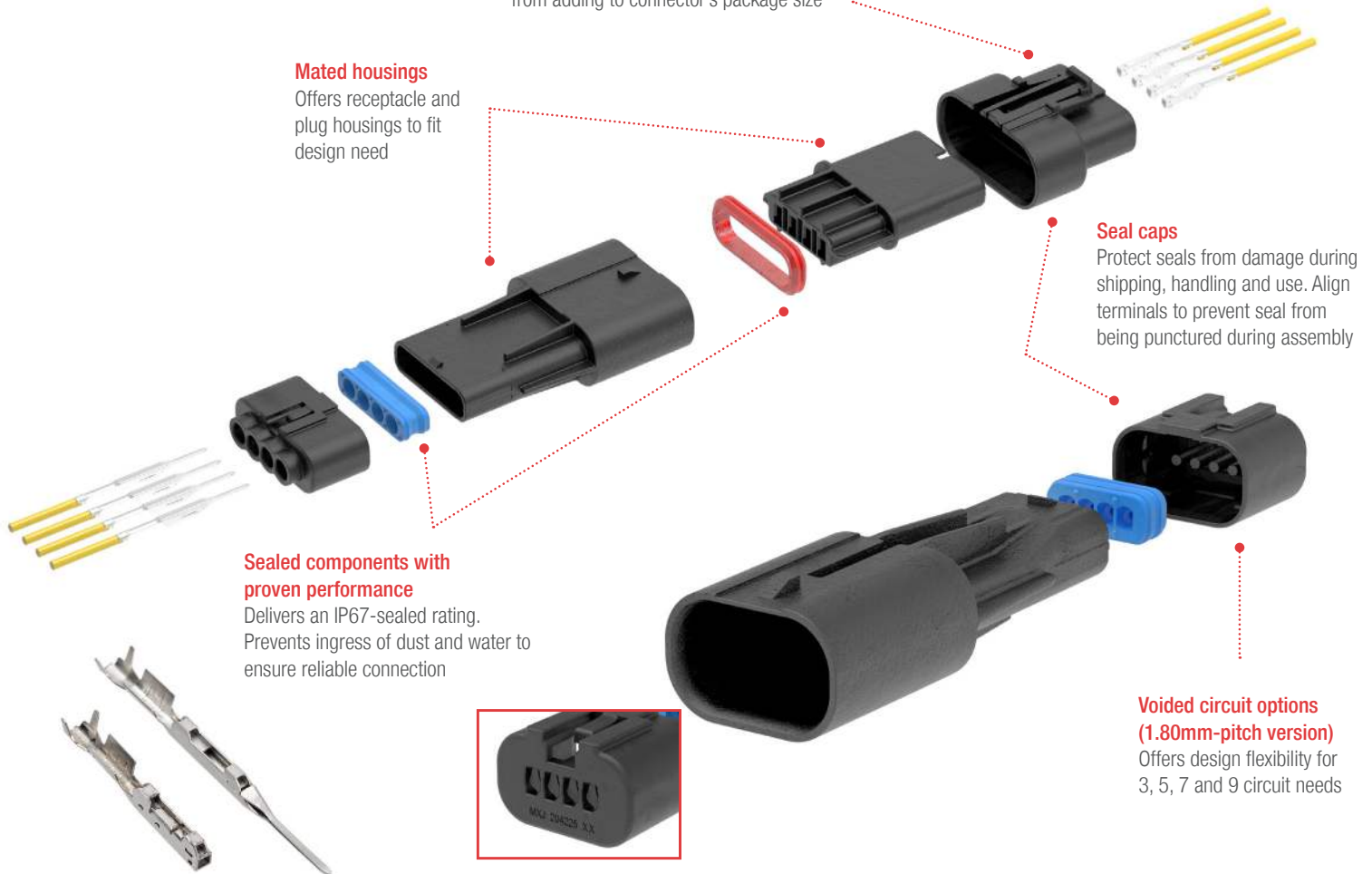

Squba 3.60mm-Pitch Sealed Connector Family, Fully Mated, 2 to 4 Circuits, with a Current of up to 14.0A

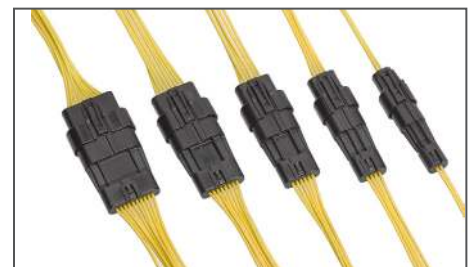

Squba 1.80mm-Pitch Sealed Connector Family, Fully Mated, 2 to 10 circuits, Void Options Available for 3-, 5-, 7- and 9-Circuit Needs, with a Current of up to 6.0A

Squba 1.80 and 3.60mm-Pitch Sealed Wire-To-Wire Connector System

molex

Markets and Applications

Consumer

Liquid dispensing equipment
HVAC equipment
Landscaping equipment

Commercial vehicle

ATV
Marine: under-dash wiring, lighting
Forklifts
Trucks
Buses
Recreational vehicles

Industrial

Robotics
Industrial machines and motors
Food processing equipment/plants
Industrial controls

Connected Home

Security and surveillance
Smart appliance
Home health and wellness
Home automation



Security Systems



HVAC



Robotic Arm



ATV

Specifications

REFERENCE INFORMATION

Receptacle Packaging: Tray
Plug Packaging: Bulk
Crimp Terminal Packaging: Reels
UL File No.: TBD
CSA File No.: TBD

	<u>1.80mm</u>	<u>3.60mm</u>
Use With:	22 to 24 AWG	16 to 20 AWG
Insulation Diameter:	0.95 to 1.40mm	1.50 to 2.40mm
Designed In:	Millimeters	
RoHS:	Yes	
Halogen Free:	No	
Glow Wire Compliant:	TBD	
IP Rating:	IP67	

ELECTRICAL

	<u>1.80mm</u>	<u>3.60mm</u>
Voltage (max.):	125V	600V
Current (max.):	6.0A	14.0A
Contact Resistance:	10 milliohms	
Dielectric Withstanding Voltage:	Leakage < 5mA	
Insulation Resistance (min.):	100 Megohms	

MECHANICAL

Terminal Retention to Housing (min.): 30N
Mating Force (max.): 45N
Unmating Force (max.): 35N
Durability (max.): 10 Cycles

PHYSICAL

Housing: Plastic
Contact: Copper Alloy
Plating:
Overall — Tin
Underplating — Nickel
Operating Temperature: -40 to +105°C

Squba 1.80 and 3.60mm-Pitch Sealed Wire-To-Wire Connector System



Ordering Information

Squba 1.80mm Receptacles

Parts	Description	Circuits	Seal Plug Position
2042200002	Sealed Receptacles	2	none
2042200004		4	
2042200006		6	
2042200008		8	
2042200010		10	
2042201110		9	10
2042204004		3	4
2042206006		5	6
2042208008		7	8

Squba 1.80mm Plugs

Parts	Description	Circuits	Seal Plug Position
2042230002	Sealed Plugs	2	none
2042230004		4	
2042230006		6	
2042230008		8	
2042230010		10	
2042231110		9	10
2042234004		3	4
2042236006		5	6
2042238008		7	8

Squba 1.80mm Terminals

Parts	Description	Wire Gauge (AWG)
Receptacle Terminals		
2043010001	Matte Tin Plating	22-24
Plug Terminals		
2042261001	Matte Tin Plating	22-24

Squba 3.60mm Receptacles

Part No.	Component	Circuits
2077820002	Sealed Receptacles	2
2077820003		3
2077820004		4

Squba 3.60mm Terminals

Series		Wire Gauge (AWG)	
Receptacle Terminals			
2077770001	Matte Tin Plating	16	Reel
2077770002		18-20	
Plug Terminals			
2077760001	Matte Tin Plating	16	Reel

Squba 3.60mm Plugs

Part No.	Component	Circuits
2077780002	Sealed Plugs	2
2077780003		3
2077780004		4

www.molex.com/link/squba.html

Molex is a registered trademark of Molex, LLC in the United States of America and may be registered in other countries; all other trademarks listed herein belong to their respective owners.