

Recommended P.C. Board Layout

SCALE 8:1

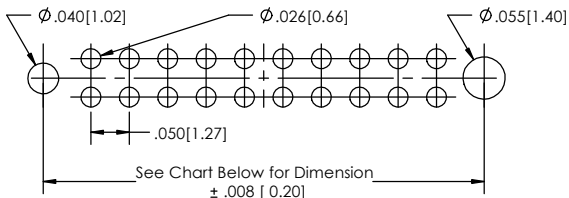

Pins Per Row	Dimension	Pins Per Row	Dimension	Pins Per Row	Dimension	Pins Per Row	Dimension	Pins Per Row	Dimension		
04	0.274	6.96	15	0.824	20.93	26	1.374	34.9	37	1.924	48.87
05	0.324	8.23	16	0.874	22.2	27	1.424	36.17	38	1.974	50.14
06	0.356	9.05	17	0.924	23.47	28	1.474	37.44	39	2.024	51.41
07	0.424	10.77	18	0.974	24.74	29	1.524	38.71	40	2.074	52.68
08	0.474	12.04	19	1.024	26.01	30	1.574	39.98	41	2.124	53.95
09	0.524	13.31	20	1.074	27.28	31	1.624	41.25	42	2.174	55.22
10	0.574	14.58	21	1.124	28.55	32	1.674	42.52	43	2.224	56.49
11	0.624	15.85	22	1.174	29.82	33	1.724	43.79	44	2.274	57.76
12	0.674	17.12	23	1.224	31.09	34	1.774	45.06	45	2.324	59.03
13	0.724	18.39	24	1.274	32.36	35	1.824	46.33	46	2.374	60.3
14	0.774	19.66	25	1.324	33.63	36	1.874	47.6	47	2.424	61.57

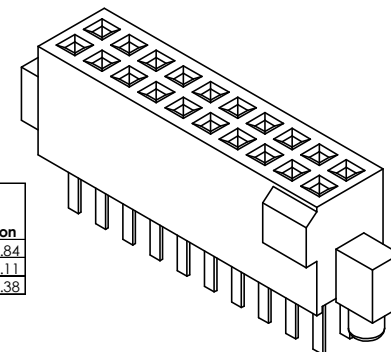

APPLICATION

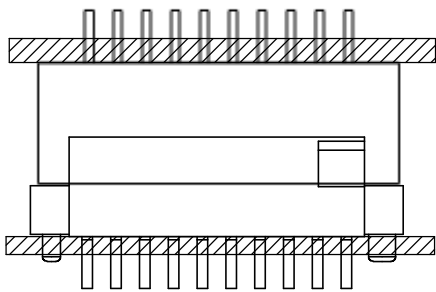

PSSHS-5XX-D-02-H-SE

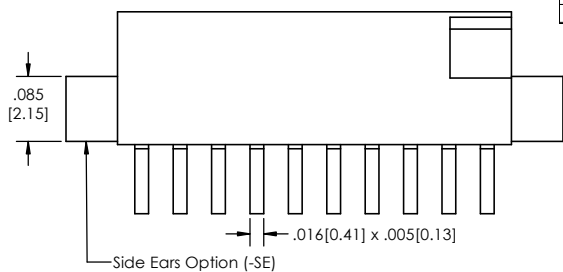

PSSHS-5XX-D-02-H-LC

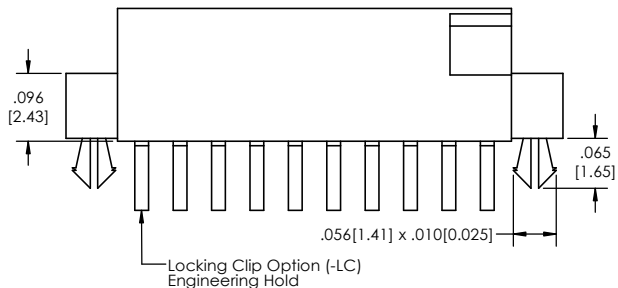

PSSHS-5XX-D-02-H-AP

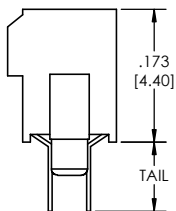
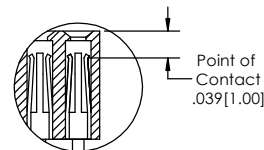
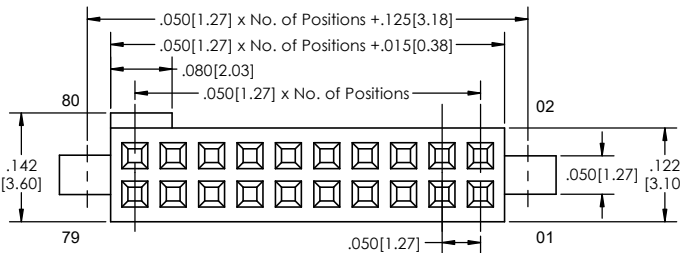
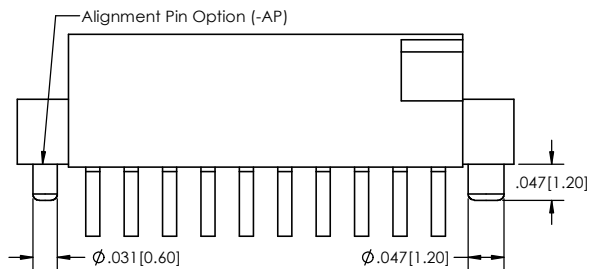

PSSHS-5 **XX** - **D** - **XX** - **X** - **X** - **XX** - **XX** - **XXX** - **LF**
(A) (B) (C) (D) (E) (F) (G) (H) (I)

- A. Pins Per Row
- 1 through 40
- B. Row Specification
- D= Double Row
- C. Pin Options
- See Pin Options below
- D. Plating Options
- See Plating Options below
- E. Locking Clip Option
- Leave blank if not needed
- C= With
- F. Alignment Pin Option
- Leave blank if not needed
- AP= With
- G. Side Ears "SE" Option
- Leave blank if not needed
- SE= With
- H. Polarized Position
- Leave blank if not needed
- If required, specify empty pin position
- e.g. 012 for Pin 12
- I. Lead Free

Mates with:
PTSHS
PTSHSM

Plating options		Pin Options	
GT	-10µ Gold on Contact Area/ Matte Tin on Tail	Tail Length	
H	-30µ Gold on Contact Area/ Matte Tin on Tail	.090	2.29mm 02
F	-Gold Flash over Entire Pin	.120	3.05mm 04

Specifications:
Current Rating: 1.0 Ampere
Insulation Resistance: 1000M Ohms Min.
Dielectric Withstanding: 300V AC
Contact Resistance: 20M Ohms Max.
Operation Temperature: -40°C to $+105^{\circ}\text{C}$
Max. Process Temperature
Peak: 260°C up to 10 secs.
Process: 230°C up to 60 secs.
Wave: 260°C up to 6 secs.
Manual Solder: 350°C up to 5 secs.

Materials:
Contact Material: Phosphor Bronze
Insulator Material: Nylon 6T

Tails may be clipped to achieve specific dimensions.

Products cut to specific sizes are uncancellable/ nonreturnable.
Parts are subject to change without notice.



PROPRIETARY AND CONFIDENTIAL
THE INFORMATION CONTAINED IN THIS DRAWING IS THE SOLE PROPERTY OF Major League Electronics. ANY REPRODUCTION IN PART OR AS A WHOLE WITHOUT THE WRITTEN PERMISSION OF Major League Electronics IS PROHIBITED.

UNLESS OTHERWISE SPECIFIED:		NAME		DATE	
DIMENSIONS ARE IN INCHES		DRAWN	EOW	05/18/16	
TOLERANCES:		CHECKED	GWE	05/18/16	
ONE DECIMALS $\pm .100$		ENG APPR.			
TWO DECIMAL $\pm .100$		MFG APPR.			
THREE DECIMAL $\pm .005$		ADDRESS:			
FOUR DECIMAL $\pm .002$		2533 Centennial Blvd. Jeffersonville, IN 47130 Phone: 812-670-4174 Fax: 812-670-4175 E-Mail: mle@mlelectronics.com			
NEXT ASSY	USED ON	MATERIAL		TITLE: PSSHS-5 SERIES	
		FINISH		SIZE	DWG. NO.
APPLICATION	DO NOT SCALE DRAWING			C	D
				SCALE 8:1	SHEET 1 OF 1

