



Electrical specifications

Center Frequency: 52.5 MHz.
Bandwidth: 35 MHz
Passband: 35-70 MHz
Insertion Loss: 1.0 dB Max
Return Loss: 14 dB Min
Ripple: 0.1 dB
Rejection: >50 dB @ 0-10 MHz
 >50 dB @ 150-1000 MHz

Mechanical

Dimensions: 2.5 x 1.0 x 0.6 inches

Environmental

Operating Temperature: -55 to +85° C
Shock: 30 G. 11ms
Vibration: 10 G. 5 to 1000 Hz

Outline Drawing:

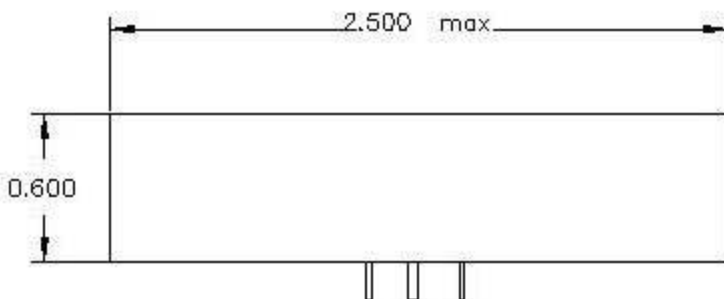

IN/OUT pin 0.02" dia, GND pin 0.040" dia

