

THIS DRAWING IS UNPUBLISHED. RELEASED FOR PUBLICATION 20  
 © COPYRIGHT 20 BY - ALL RIGHTS RESERVED.

LOC		DIST		REVISIONS			
P	LTR	DESCRIPTION	DATE	DWN	APVD		
-	-	A	FIRST RELEASED	16AUG2019	WH	DZ	

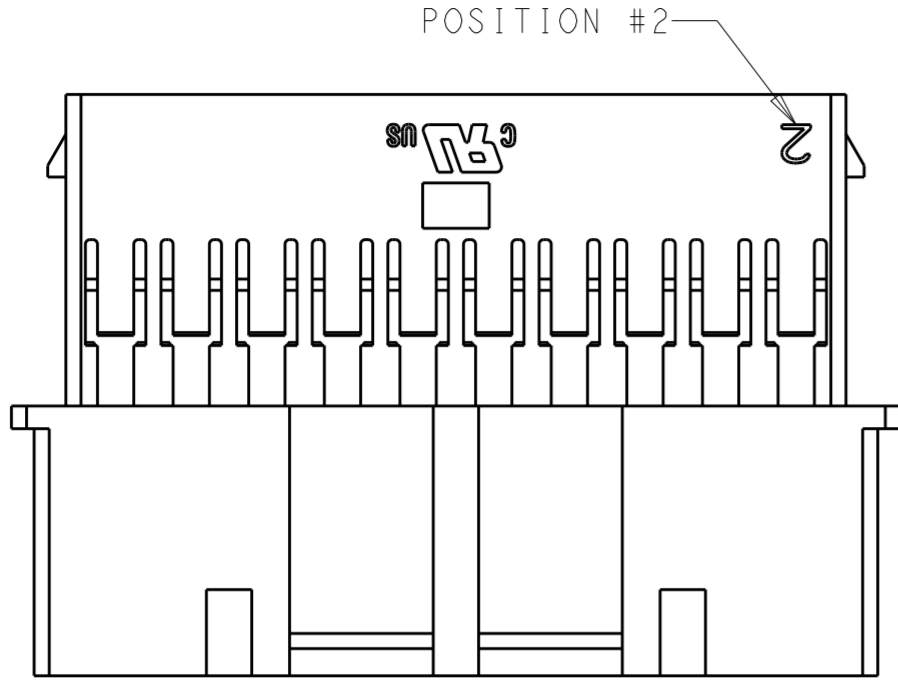

DUAL LATCH DETAIL FOR  
1-2324201-8 THROUGH 4-2324201-0

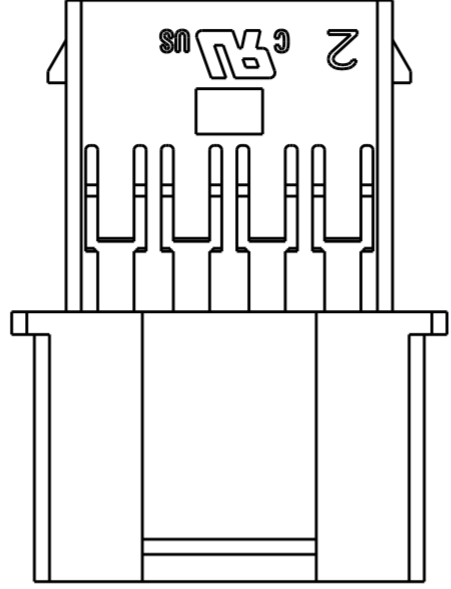

SINGLE LATCH DETAIL FOR  
2324201-8 & 1-2324201-0

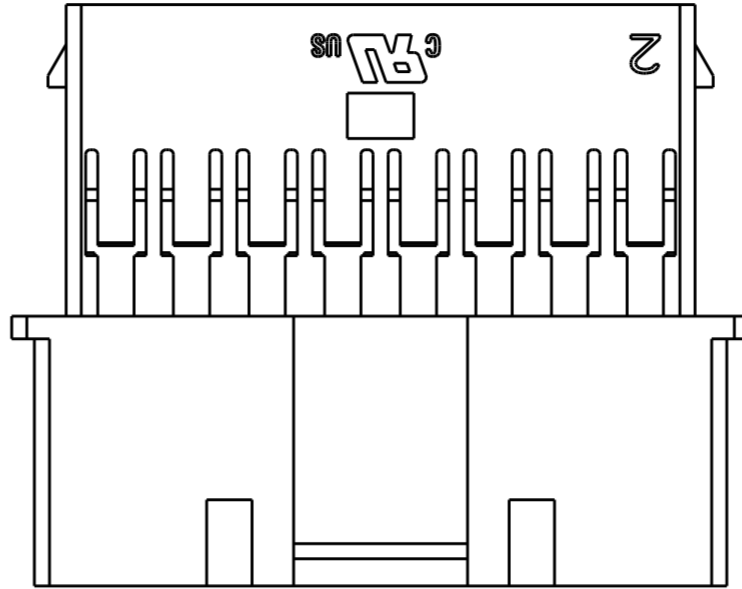

SINGLE LATCH DETAIL FOR  
1-2324201-2 THROUGH 1-2324201-6

NOTES:

1. MATERIAL: NYLON 66, UL94-V0, COLOR: NATURAL
2. DIMENSIONS SHOWN REPRESENT PRODUCT IN DRY, AS MOLDED, CONDITION. ADDITIONAL 2% GROWTH DUE TO SUBSEQUENT MOISTURE ABSORPTION MAY OCCUR AND SHOULD BE ACCOUNTED FOR.
3. RECOMMENDED MATING PLUG: [ ]-2323743-[ ]
4. THE HOUSING ACCEPTS TERMINALS: 2238007-1 OR 2238008-1
5. ACCEPTS OPTIONAL TPA: [ ]-1969541-[ ] OR [ ]-2315219-[ ]
6. COMPLY WITH GLOW WIRE REQUIREMENTS FOR PARTS OF NON-METALLIC MATERIAL SUPPORTING A CURRENT-CARRYING CONNECTION DETAILED IN IEC 60335-1, SECTION 30(GWT)

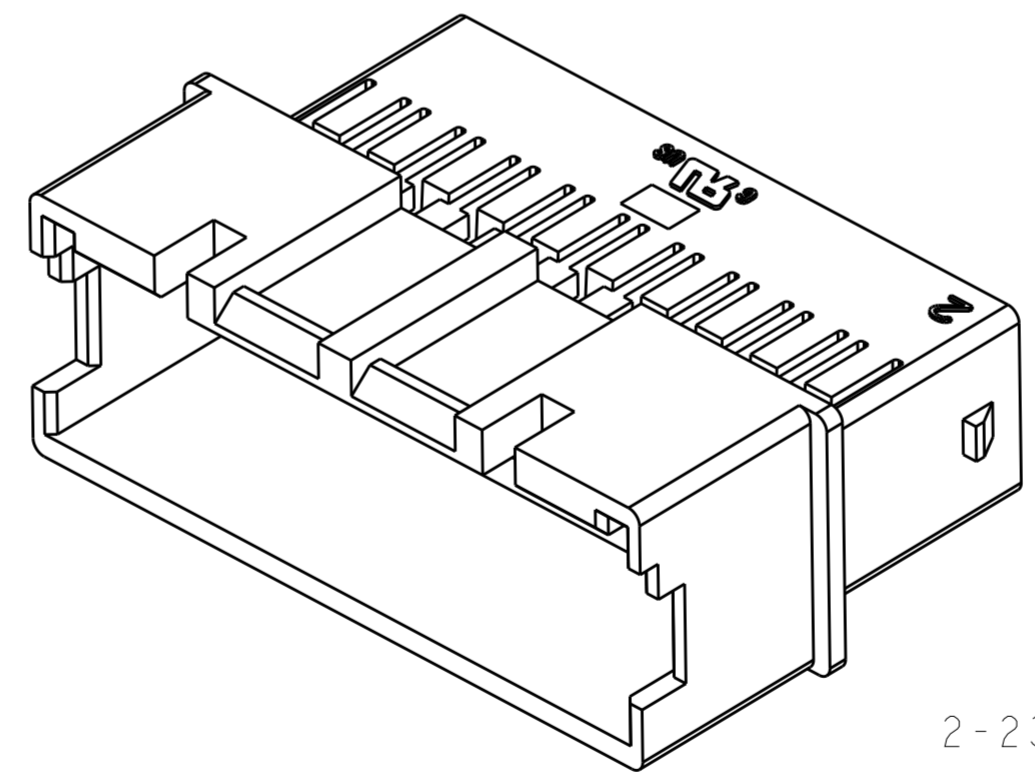
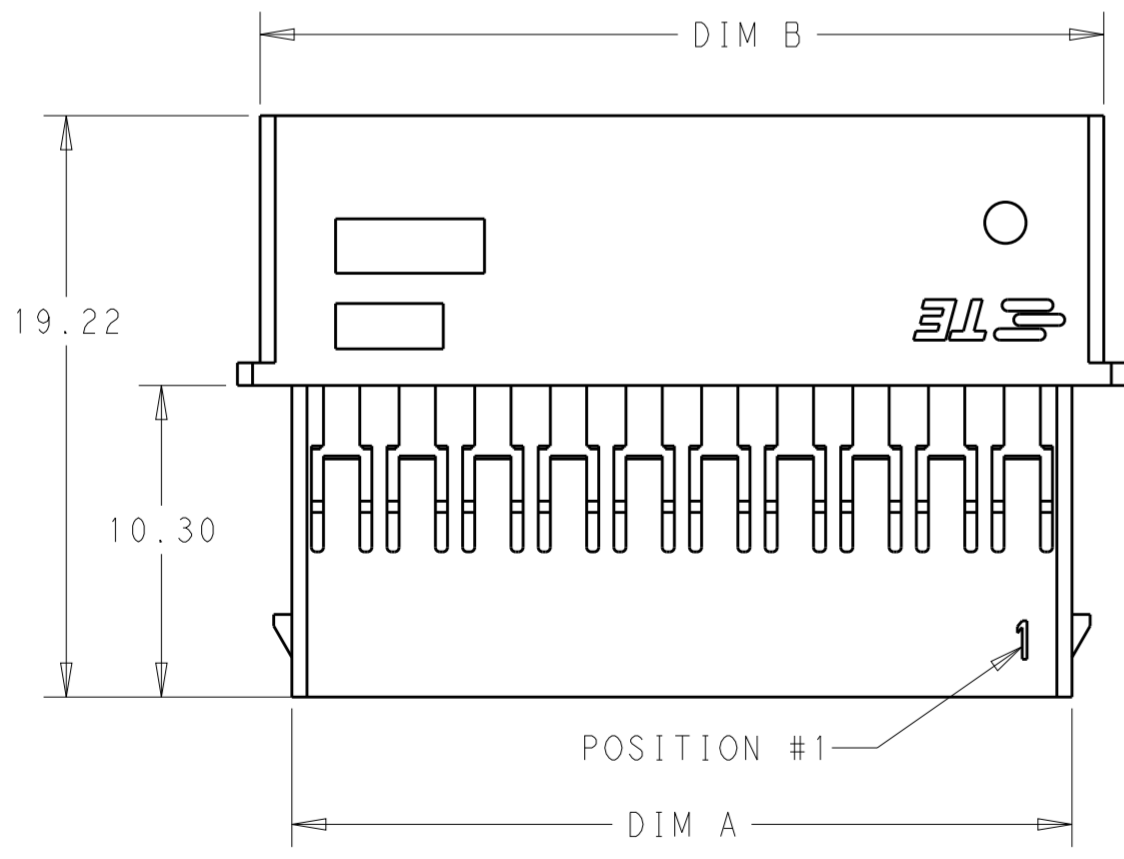
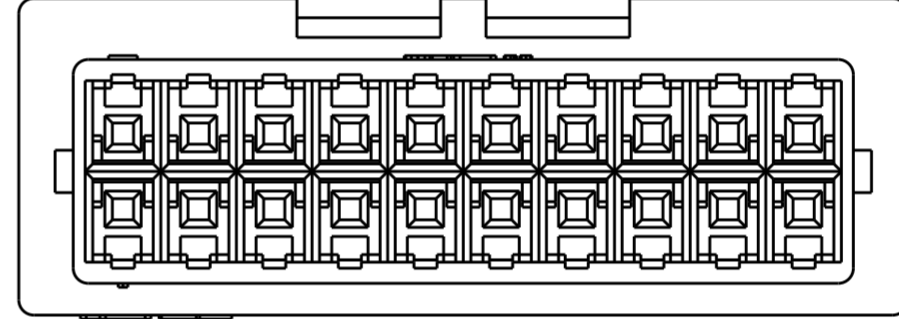
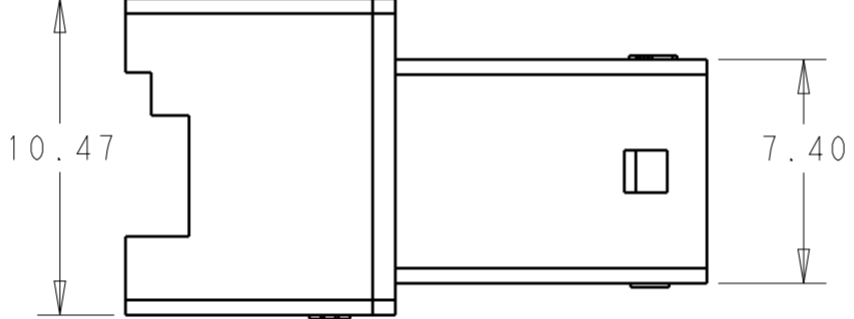
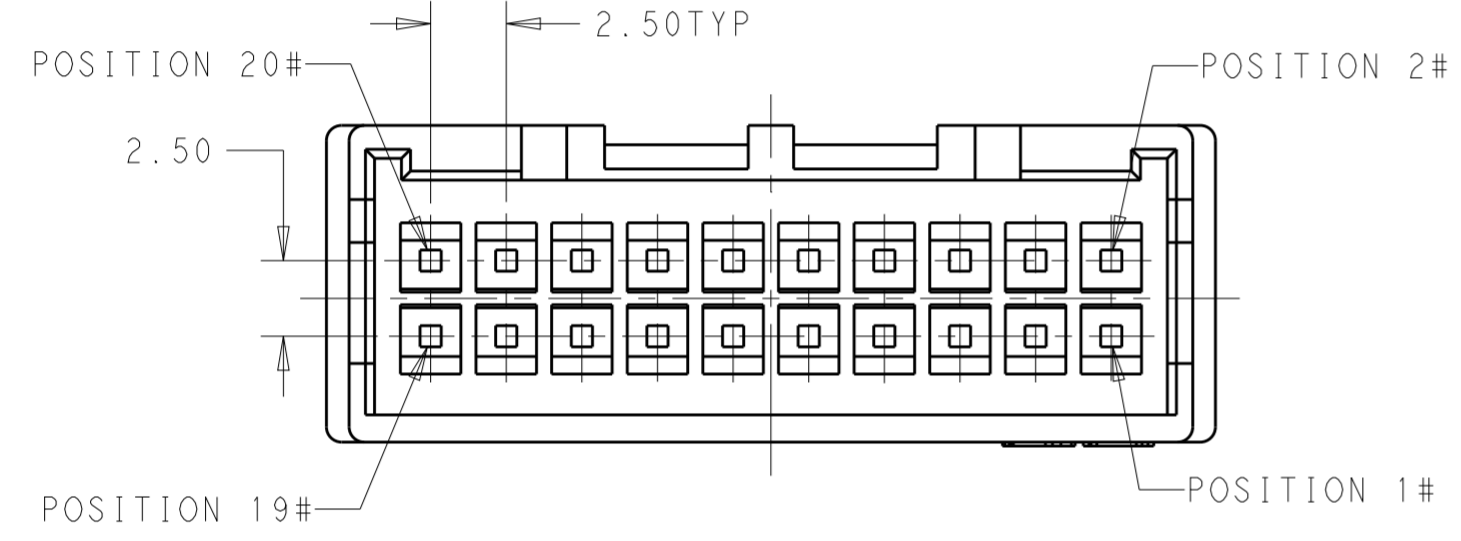

POS	DIM.B	DIM.A	PART NO.
40	52.89	50.79	4-2324201-0
38	50.39	48.29	3-2324201-8
36	47.89	45.79	3-2324201-6
34	45.39	43.29	3-2324201-4
32	42.89	40.79	3-2324201-2
30	40.39	38.29	3-2324201-0
28	37.89	35.79	2-2324201-8
26	35.39	33.29	2-2324201-6
24	32.89	30.79	2-2324201-4
22	30.39	28.29	2-2324201-2
20	27.89	25.79	2-2324201-0
18	25.39	23.29	1-2324201-8
16	22.89	20.79	1-2324201-6
14	20.39	18.29	1-2324201-4
12	17.89	15.79	1-2324201-2
10	15.39	13.29	1-2324201-0
8	12.89	10.79	2324201-8

THIS DRAWING IS A CONTROLLED DOCUMENT.

DWN: WARREN HUO 26AUG2018  
 CHK: DANIEL ZHANG 27AUG2018  
 APVD: DANIEL ZHANG 27AUG2018

TE Connectivity

NAME: CAP HOUSING, EP2.5 DUAL ROW WIRE TO WIRE, FREE HANGING, GWT

PRODUCT SPEC: 108-106357  
 APPLICATION SPEC: 114-13315

SIZE: A2 CAGE CODE: 00779 DRAWING NO: C-2324201 RESTRICTED TO: -

MATERIAL: NYLON 66, UL94-V0, COLOR: NATURAL

TOLERANCES UNLESS OTHERWISE SPECIFIED:  
 0 PLC ±  
 1 PLC ±  
 2 PLC ±0.25  
 3 PLC ±  
 4 PLC ±  
 ANGLES ±5°  
 FINISH

CUSTOMER DRAWING SCALE: N/A SHEET 1 OF 1 REV A