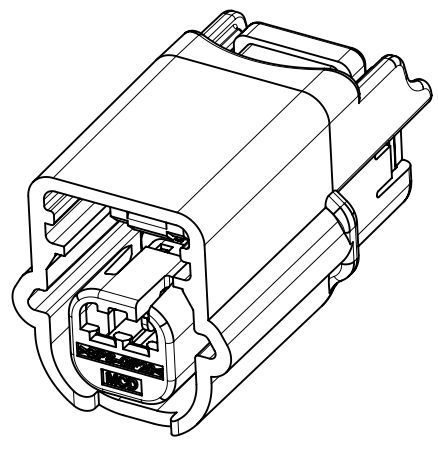
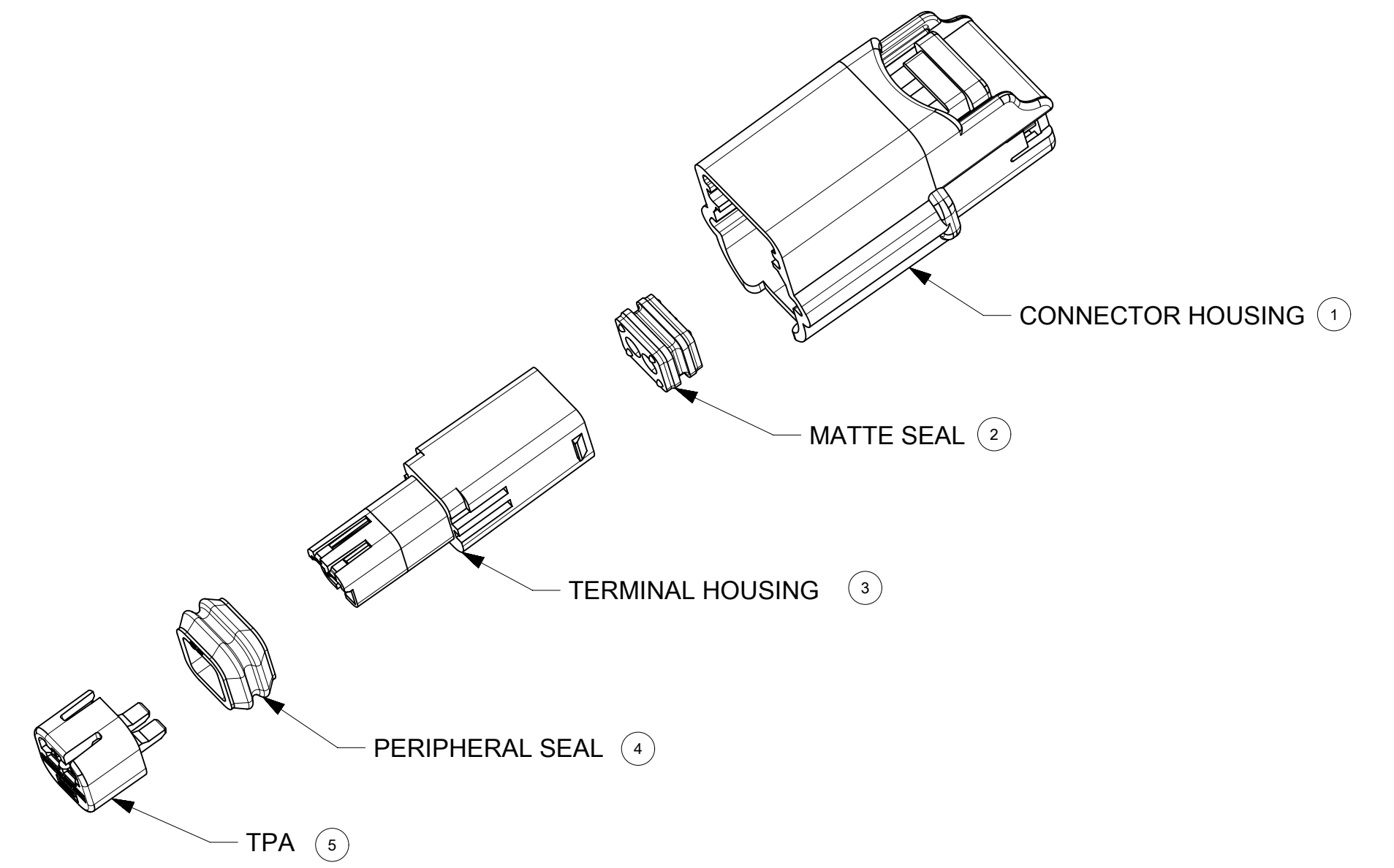
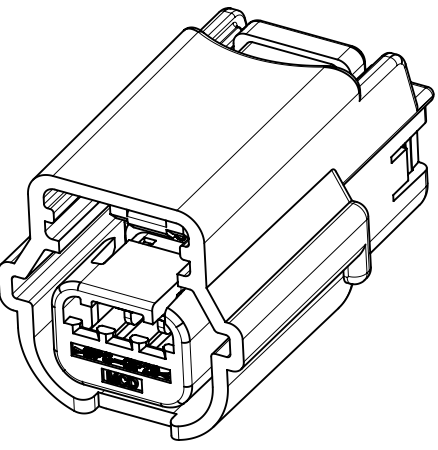

TABLE OF CONTENTS	
SHEET NO.	SHEET DESCRIPTION
1	NOTES AND BOM
2	CONNECTOR ASSEMBLY
3	KEY CONFIGURATIONS AND BOM

MATING INTERFACE DRAWING	
DESCRIPTION	INTERFACE DEFINITION
1X2	*064-S-002-1-Z02
1X3	*064-S-003-1-Z01



1X2



1X3

NOTES: VALID UNLESS OTHERWISE SPECIFIED

1. GENERAL:

- a. APPLICATION SPECIFICATION SEE: 2035110001-RAS
 - DESIGNED TO MATE WITH DEVICE OR CONNECTOR AS SPECIFIED IN THE MATING INTERFACE DRAWINGS CHART.
 - *DENOTES DRAWINGS THAT CAN BE ACCESSED AT <http://ewcap.uscarteams.org/>.
 - ASSEMBLY SHIPPED WITH TPA IN PRE-LOCK POSITION (SEE TPA PRE-LOCK VIEW ON SHEET 2 SECTION A-A).
- b. PRODUCT SPECIFICATION SEE: 2035110001-RPS
 - CONTAINS: PRODUCT INTRODUCTION, PRODUCT SUMMARY RATINGS AND PRODUCT VALIDATION
- c. PACKAGING SPECIFICATION PER MOLEX DRAWING:2035119000
- d. TPA'S MAY BECOME SEATED DURING TRANSIT. IF THIS OCCURS, TPA'S SHOULD BE MOVED TO THE PRE-LOCKED POSITION PRIOR TO FEMALE TERMINAL INSTALLATION. REFERENCE PRODUCT SPECIFICATION: 2035110001-RAS
- e. PARTS MUST BE IN COMPLIANCE TO MOLEX CHEMICAL SUBSTANCES FOR PRODUCTS AND PACKAGING SPECIFICATION
- f. DATA MUST BE SUBMITTED UNDER THE MOLEX PART NUMBER TO IMDS (COMPANY ID#13255)
- g. SYSTEM TO BE USED WITH OUTSIDE WIRE DIAMETERS RANGING FROM 1.20MM TO 2.06MM WITHIN RANGE OF:
 - SAE 22AWG TO 18AWG PER ESB-M1L123-A2
 - ISO 0.35MM² TO 0.75MM² PER GMW15626 AND ES-AU5T-1A348-AA
 TERMINAL FOR THIS ASSEMBLY: SEE TERMINAL TABLE
 FOR MORE INFORMATION ON TERMINAL SEE MOLEX DRAWING SD-33468-001,SD-33468-002 AND TERMINAL PRODUCT SPECIFICATION PS-33468-001

2. DESIGN - GEOMETRY:

- a. THE 3-D CAD DATA IS BASIC (WITHOUT TOLERANCE) AND MASTER FOR THIS PART WITH THE EXCEPTION OF UNDERLINED DIMENSIONS. DIMENSIONAL INFORMATION NOT SHOWN ON THIS DRAWING IS DEFINED BY THE DATA FILE AT ITS LATEST REVISION.
- b. GEOMETRIC DIMENSIONS AND TOLERANCES PER ASME Y14.5M-2009
- c. EDGES AND UNDIMENSIONED DETAILS PER ISO13715
- d. CORNERS SHOWN AS SHARP TO BE R 0.2 MAX.
- e. LETTERING SHALL BE 0.15 MAX RAISED IN 0.25 MAX RECESS PAD.
THIS INCLUDES RECYCLING CODE, CAVITY ID, VENDOR IDENTIFICATION, AND CUSTOMER MATERIAL NUMBER.
- f. VISUAL DEFECTS SHALL MEET COSMETIC STANDARD PS-45499-002 (Class B).
- g. DATE CODE: FIRST TWO DIGITS ARE THE CALENDAR YEAR (EXAMPLE: 04 = 2004). THIRD THROUGH 5TH DIGIT DAY # OF THE CALENDAR YEAR (EXAMPLE: FEB. 3RD = '034').

ITEM	DESCRIPTION	COLOR	MATERIAL
1	CONNECTOR HOUSING	BLACK	PBT GF15
2	TERMINAL HOUSING	BLACK	SPS/PA66 GF30
3	TPA	NATURAL	SPS/PA66 GF20
4	MATTE SEAL	SEE CHART	SILICONE RUBBER
5	PERIPHERAL SEAL	SEE CHART	SILICONE RUBBER

TERMINAL TABLE					
TERMINAL P/N	REEL PAYOFF DIRECTION	PLATING TYPE	GRIP SIZE	WIRE SIZE	WIRE INSULATION OD(mm)
33468-0001	B	SN	SMALL	22AWG	1.50-1.65
33468-0002	D	SN	SMALL	22AWG	1.50-1.65
33468-0003	B	SN	LARGE	18/20AWG	1.70-2.06
33468-0004	D	SN	LARGE	18/20AWG	1.70-2.06
33468-0021	D	SN	SMALL	0.35mm ²	1.20-1.65
33468-0022	B	SN	SMALL	0.35mm ²	1.20-1.65
33468-0023	D	SN	LARGE	0.50-0.75mm ²	1.40-2.06
33468-0024	B	SN	LARGE	0.50-0.75mm ²	1.40-2.06

A1	UPDATE NOTE INFORMATION OF APPLICATION SPECIFICATION AND PRODUCT SPECIFICATION
A	INITIAL RELEASE
REV	REV DESCRIPTION

SYMBOLS = 0 mm = 0 GENERAL TOLERANCES (UNLESS SPECIFIED) = 0 ANGULAR TOL ± ° = 0 4 PLACES ± = 0 3 PLACES ± = 0 2 PLACES ± = 0 1 PLACE ± = 0 0 PLACES ± = 0 DRAFT WHERE APPLICABLE MUST REMAIN WITHIN DIMENSIONS	THIS DRAWING CONTAINS INFORMATION THAT IS PROPRIETARY TO MOLEX ELECTRONIC TECHNOLOGIES, LLC AND SHOULD NOT BE USED WITHOUT WRITTEN PERMISSION DIMENSION UNITS: mm SCALE: 2:1 CURRENT REV DESC: EC NO: 178442 DRWN: MCHEN37 2018/06/26 CHK'D: GLI04 2018/07/03 APPR: JDENG02 2018/07/04 INITIAL REVISION: DRWN: MCHEN37 2017/08/08 APPR: JDENG02 2017/08/15 THIRD ANGLE PROJECTION 	 0.64 USCAR SEALED SINGLE ROW CONNECTOR PRODUCT CUSTOMER DRAWING DOCUMENT NUMBER: 2035110001 DOC TYPE: PSD DOC PART: 000 REVISION: A1 MATERIAL NUMBER: 203511 CUSTOMER:
	DRIVING A1-SIZE SERIES 203511	SHEET NUMBER 1 OF 3

