



SIGN	DATE	DESCRIPTION	APPROVER
△	06/15/11	Add "cULus" Safety Approval logo	Aaron
△	06/15/11	The mark 5.08 is added	Aaron

THIS IS CAD DRAWING, DO NOT REVISE MANUALLY!!!

- Material:
- Item a Terminal(Up housing): Thermoplastic (UL94V-0)
 - Item b Terminal(Down housing): Thermoplastic (UL94V-0)
 - Item c Terminal(Lever): Thermoplastic (UL94V-0)
 - Item d Spring clamp: Stainless steel
 - Item e Female contact: PhBz Tin Plated.

- Electrical: cULus
- Voltage rating: 300 V
 - Current rating: 12 A
 - Wire range:
 - Solid wire(AWG): 14-24
 - Stranded wire(AWG): 14-24
 - Wire strip length: 11-12 mm
 - Withstanding Voltage: 1.6 KV
 - Operating temperature: -40°C to +115°C
 - Safety Approval: 
 - Critical dimension: 

KD xx 5 0 x 0 xxxx G

- No. OF POLES
- 02: 2 POLES
 - 03: 3 POLES
 - :
 - 24: 24 POLES
- COLOR
- 0 Black (RAL9005)
 - 2 Red (RAL3001/D)
 - 3 Orange(RAL2011/P)
 - 4 Yellow(RAL1018/A)
 - 5 Green(RAL6018/T)
 - 6 Blue (RAL5015/A)
 - 8 Grey(RAL7035/D)
 - 9 White(RAL1102)
 - C Green(RAL6018/U)
- G: Pb<40000ppm
- 0000: "@ Logo (Standard)
- 000A: "ANYTEK" Mark
- Any special item by customer request. please contact sales department.

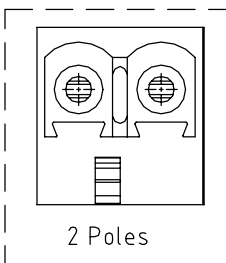
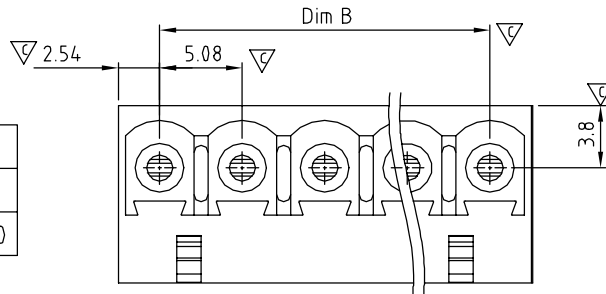
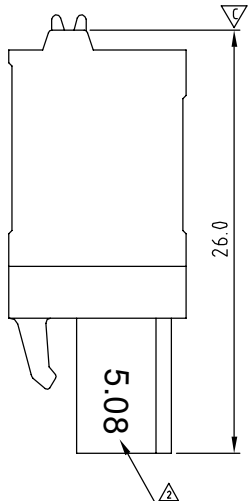
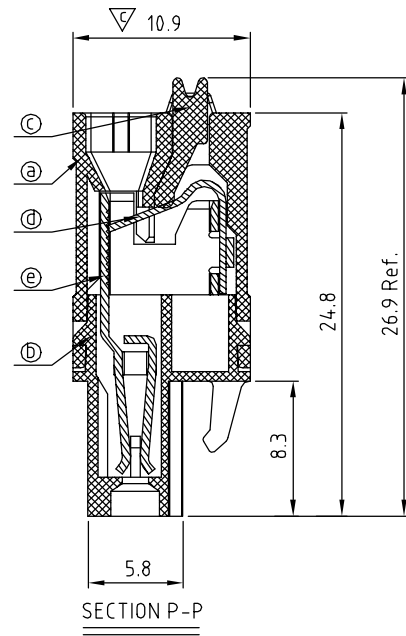
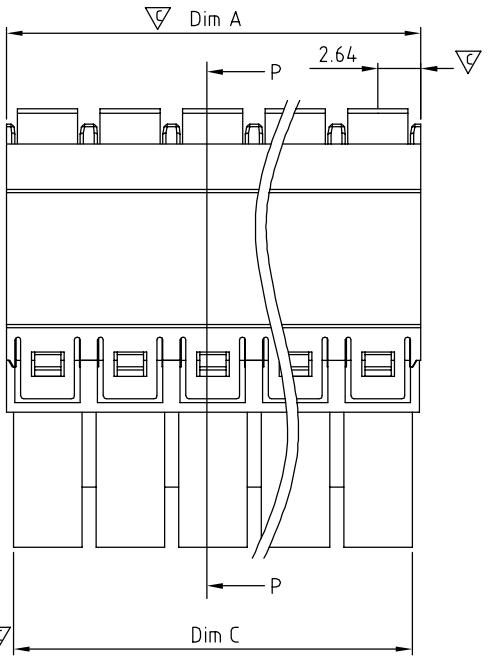
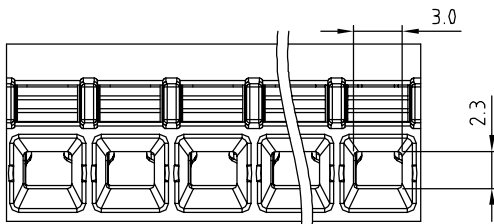

Dimension

DIM A	N×5.08+0.1
DIM B	(N-1)×5.08
DIM C	(N-1)×5.08+4.20

N=Number of poles

	TOL			
	2p-6p	7p-12p	13p-18p	19p-24p
Dim A	±0.15	±0.25	±0.35	±0.40
Dim B	±0.15	±0.25	±0.35	±0.40

ANYTEK		CUSTOMER COPY	
TITLE	KD 5.08mm W/O Flange Series (2P-24P)		
PART NO.	KDxx50x0xxxxG	DWG NO.	8KD0201
APPROVED	CHECKED	DESIGNED	DRAWN
		Aaron 2011.06.15	Jacke 2009.08.26
SHEET: 01/01		Tolerance	
UNIT: mm SCALE: NONE REV.: C		X.	±0.50
		X.X	±0.30
SHEET: 01/01 REV.: C		X.XX	±0.10
		X°	±1°