

PROPER USE GUIDELINES

Cumulative Trauma Disorders can result from the prolonged use of manually powered hand tools. Hand tools are intended for occasional use and low volume applications. A wide selection of powered application equipment for extended-use, production operations is available.



Figure 1

1. INTRODUCTION

The SOLARLOK Torque Screwdriver and Adapter Assembly 2161345-1 are designed to be used with Hexagon Spanner Head 523229-1 (not included) to tighten the clamp nut on SOLARLOK connectors.

2. DESCRIPTION (Figure 1)

This assembly contains a torque screwdriver (2161353-1) and an installed adapter (2161353-1) to mount the spanner head shown in Figure 2. The screwdriver is preset to produce 1.4 Nm [12.39 lbf-in.] of torque.



Figure 2

3. INSTALLATION

To install the spanner head onto the adapter, push the square end of the spanner head onto the adapter until the ball detent on the adapter engages the retention feature on the head.

4. OPERATION

To use the screwdriver and adapter assembly, first install the spanner head and then proceed as follows:

1. Begin threading the clamp nut onto the connector housing and continue until the nut will go no further.
2. Inspect the screwdriver to ensure the torque setting is set at 1.4 Nm [12.39 lbf-in.]. Adjust the torque if required by following the procedure in Section 5, TORQUE SETTING ADJUSTMENT.
3. Place the spanner head onto the clamp nut with the cable protruding from the cutout in the spanner head.

4. Tighten the clamp nut onto the connector housing until the torque indication feature on the screwdriver indicates the nut has reached a torque of 1.4 Nm [12.39 lbf-in.].

5. TORQUE SETTING ADJUSTMENT (Figure 3)

To adjust the torque setting, pull the adjustment knob toward the handle and rotate until the arrow on the knob is aligned with the required setting.

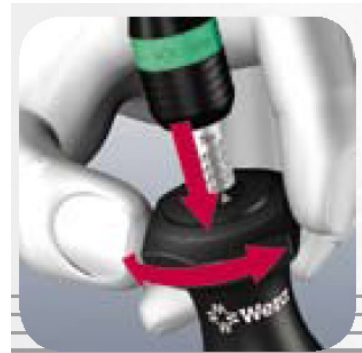

Figure 3

6. ORDERING INFORMATION

Order replacement parts through your TE Connectivity Representative, or call 1-800-526-5142, or send a facsimile of your purchase order to 1-717-986-7605, or write to:

CUSTOMER SERVICE (038-035)
TYCO ELECTRONICS CORPORATION
PO BOX 3608
HARRISBURG PA 17105-3608

7. REVISION SUMMARY

- Initial release of document