

PRODUCT SPECIFICATION: GS-12-307  
 PACKAGING SPECIFICATION: EUR-14-010  
 APPLICATION SPECIFICATION: GS-20-049

NOTES:

1. BODY MATERIAL: LIQUID CRYSTAL POLYMER 30% GLASS  
FLAME RETARDANT ACC. UL 94 V0
2. COVER MATERIAL: ZINC ALLOY
3. TERMINAL MATERIAL: TINBRONZE
4. GROUND SPRING MATERIAL: STAINLESS STEEL
5. CONTACT STRIP MATERIAL: STAINLESS STEEL
6. PCB THICKNESS: 1.8-2.4 mm.
7. PRODUCT MARKING: PART NUMBER & MANUFACT. DATE

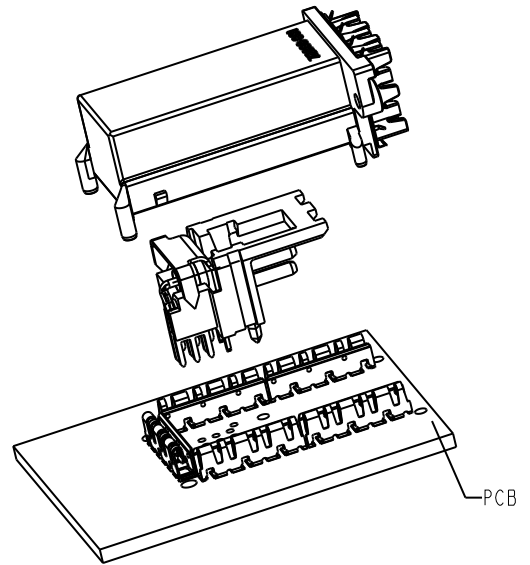

8-ROHS INFORMATION:

-This product meets European Union Directives and other country regulations as described in GS-22-008.

-The housing will withstand exposure to 260°C peak temperature for 10 second in a wave solder application with a 1.6mm minimum thick circuit board. See Application notes/procedures if they are available.

-Packaging spec: see GS-14-920.



Copyright FCI.

rev	ecn no	dr	date
H	LS06-0143	LGO	2006/09/26
J	LS07-0255	JTA	2007/11/12
-	-	-	-
D	SW 8165	SDc	1998/08/31
E	SW 9143	HCA	1999/11/25
F	LS4129	JTA	2004/12/15
G	LS05-0080	JTA	2005/09/07

Performance level	
72846-1XXLF	Telcordia CO.
72846-2XXLF	Customer Special

www.fciconnect.com			surface ISO 1302	✓	tolerance std ISO 406 ISO 1101	projection mm	← →
TOLERANCES UNLESS OTHERWISE SPECIFIED							
Dr	JJA	1998/03/20	ANGULAR	LINEAR	0.X	±0.3	size A4
Eng	J.Grek	1998/03/23			0.XX	±0.1	
Chr	H.Carneling	1998/03/24	0°	±2°	0.XXX	±0.05	ECN LS08-0234
Appr	J Jacobsson	1998/03/25	Product family			SOFIX	Spec ref RELEASED
FCI	title SOFIX POWER RA HDR WITH FILTER STB SHIELDED I/O				dwg no 72846_C	Rev. K	
	catalog no					CUSTOMER	sheet 1 of 3

REV F - 2006-04-17

PDM: Rev:K

STATUS: Released

Printed: Aug 01, 2010

# CONNECTOR

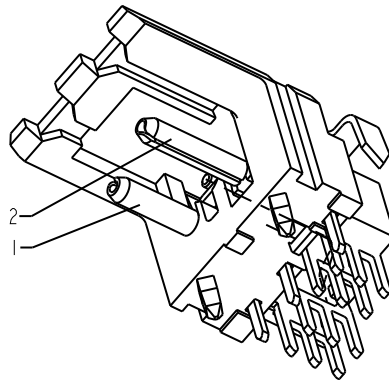
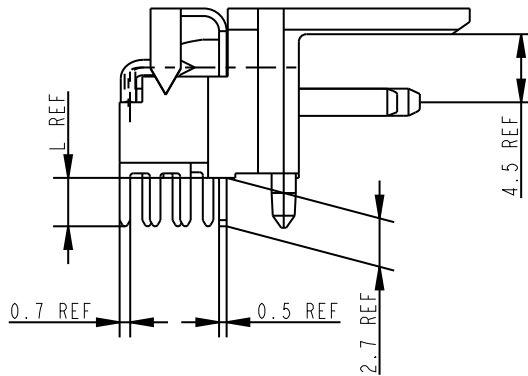
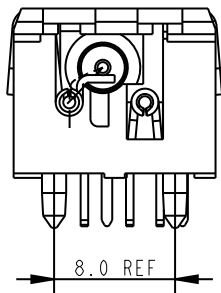
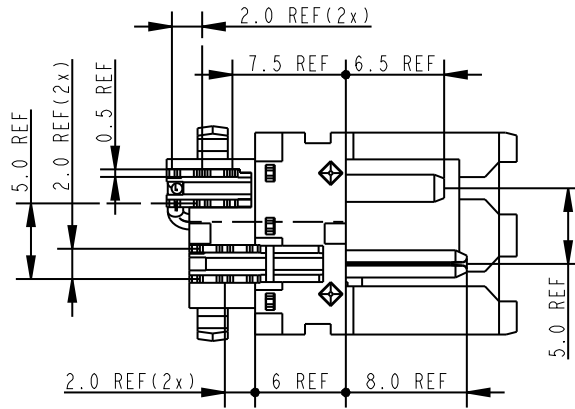

Product number	L
72814-X04LF	2.2
72814-X05LF	2.7



Copyright FCI.

www.fciconnect.com			surface ISO 1302		tolerance std ISO 406 ISO 1101		projection 		mm 		
			TOLERANCES UNLESS OTHERWISE SPECIFIED								
Dr	JJA	1998/03/20	ANGULAR	LINEAR	0.X	±0.3	size A4	Scale 2:1			
Eng	J.Grek	1998/03/23			0.XX	±0.1					
Chr	H.Carneling	1998/03/24	0°	±R°	0.XXX	±0.05	ECN	LS08-0234			
Appr	J.Jacobsson	1998/03/25	Product family			SOFIX		Spec ref	RELEASED		
		title SOFIX POWER RA HDR WITH FILTER STB SHIELDED I/O				dwg no 72846_C		Rev. K			
catalog no						CUSTOMER		sheet 2 of 3			

REV F - 2006-04-17

PDM: Rev:K

STATUS: Released

Printed: Aug 01, 2010

LEAD-FREE PRODUCTS: (see note 8)

Kit: 72846-X0XLF	
COMPONENTS	QTY
GROUP SPRING	1
SHIELD COVER	1
CONNECTOR	1
CONTACT SPRING	5

Dimension with oval around are critical dimensions including any attached geometrical tolerance. Other features or stand-alone geometrical tolerances being critical have a note "CRITICAL FEATURE" below the item

A symbol  $\triangle x$  (x: drawing current revision) will be next to any dimension, view or note which has been modified with the current drawing revision



Copyright FCI.

www.fciconnect.com			surface ISO 1302	<input checked="" type="checkbox"/>	tolerance std ISO 406 ISO 1101	projection 	mm 	
			TOLERANCES UNLESS OTHERWISE SPECIFIED					
Dr	JJA	1998/03/20	ANGULAR	LINEAR	0.X	$\pm 0.3$	size A4	Scale 2:1
Eng	J.Grek	1998/03/23			0.XX	$\pm 0.1$		
Chr	H.Carneling	1998/03/24	0°	$\pm R^\circ$	0.XXX	$\pm 0.05$	ECN	LS08-0234
Appr	J.Jacobsson	1998/03/25	Product family			SOFIX	Spec ref	RELEASED
	title SOFIX POWER RA HDR WITH FILTER STB SHIELDED I/O				dwg no 72846_C		Rev. K	
catalog no				CUSTOMER			sheet 3 of 3	

REV F - 2006-04-17

PDM: Rev:K

STATUS: Released

Printed: Aug 01, 2010