

DIRECTION OF UNREELING →

REFERENCE ONLY

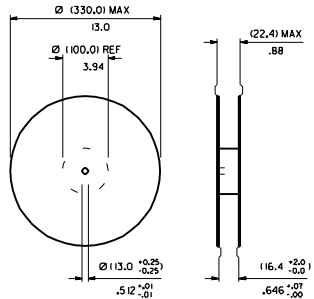

REEL DIMENSIONS
DO NOT SCALE

(1400) PIECES PER REEL
(7) REELS PER CARDBOARD BOX (PCTN-38)
(9800) PIECES PER CARDBOARD BOX

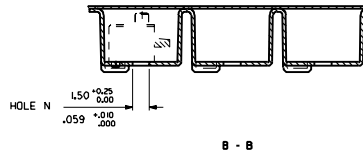

TO CUSTOMER ASSEMBLY MACHINE →

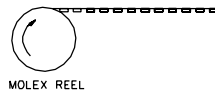

NOTES:

- 1) MATERIAL : CARRIER TAPE : VOLUME CONDUCTIVE POLYCARBONATE (0.33) .013 REF THICK , BLACK
COVER TAPE : COLD SEAL POLYESTER (0.06) .002 REF THICK , TRANSPARENT
- 2) PITCH TOLERANCE OVER ANY 10 PITCHES : (0.2) .008
- 3) PEEL FORCE OF THE COVER TAPE IS 0.1N TO 1.0N AT A MAXIMUM PEEL SPEED OF (300) (1.8) / min ±10%
- 4) PACKAGING SPEC. TBA
- 5) REFERENCE TO IEC 286-3

FOR PREVIOUS DRAWING ISSUES SEE MRL.	VARIOUS MARKS	DATE	REVISE ONLY ON CAD SYSTEM		SHA. PREP.
	CON. ENGR.	DAB	DATE	REVISION	DATE
	ISSUED	BY	FILE	NO.	DATE
	REVISIONS	NO.	NO.	NO.	NO.
A 1	DESCRIPTION	SCALE	PART NO.		DATE
	COLON EXPRESSION	5:1	90868-0001		94/11/16
	EDWARDS EXPANSION		MOLEX EUROPE		10/1
	SECURITY		BLISTER PACKING FOR 90868-0001		D