

SAW Filter: 1435.0MHz
Part No: MP05309

Model: TA1654A
Rev No: 1

A. MAXIMUM RATING:

Electrostatic Sensitive Device (ESD)

1. Input Power Level: 15dBm
2. DC Voltage: 3V
3. Operating Temperature: -40°C to +85°C
4. Storage Temperature: -40°C to +85°C

B. ELECTRICAL CHARACTERISTICS:

1. Terminating source impedance: $Z_S = 50\Omega$
2. Terminating load impedance: $Z_L = 50\Omega$

Item	Unit	Min.	Typ.	Max.	Note
Center Frequency Fc	MHz	-	1435	-	-
Max. Insertion Loss (1410 ~ 1460MHz) IL	dB	-	4.2	5.0	-
Passband ripple (1410 ~ 1460MHz)	dB	-	1.7	3.0	-
2dB BW	MHz	50	57	-	-
Group Delay Variation (1410 ~ 1460MHz)	nsec		10	15	
VSWR (1410 ~ 1460MHz)			1.6	2.4	
Source Impedance (single ended)	Ω	-	50	-	-
Load Impedance (single ended)	Ω	-	50	-	-
Attenuation					
D.C ~ 1360MHz	dB	40	46	-	-
1360 ~1385MHz	dB	20	42	-	-
1485 ~ 1565MHz	dB	18	26	-	-
1565 ~ 2900MHz	dB	40	43	-	-
Package size	mm	SMD 3.0x3.0			

SAW Filter: 1435.0MHz
Part No: MP05309

Model: TA1654A
Rev No: 1

C. FREQUENCY CHARACTERISTICS:

1. S21 Response: (span 400MHz)

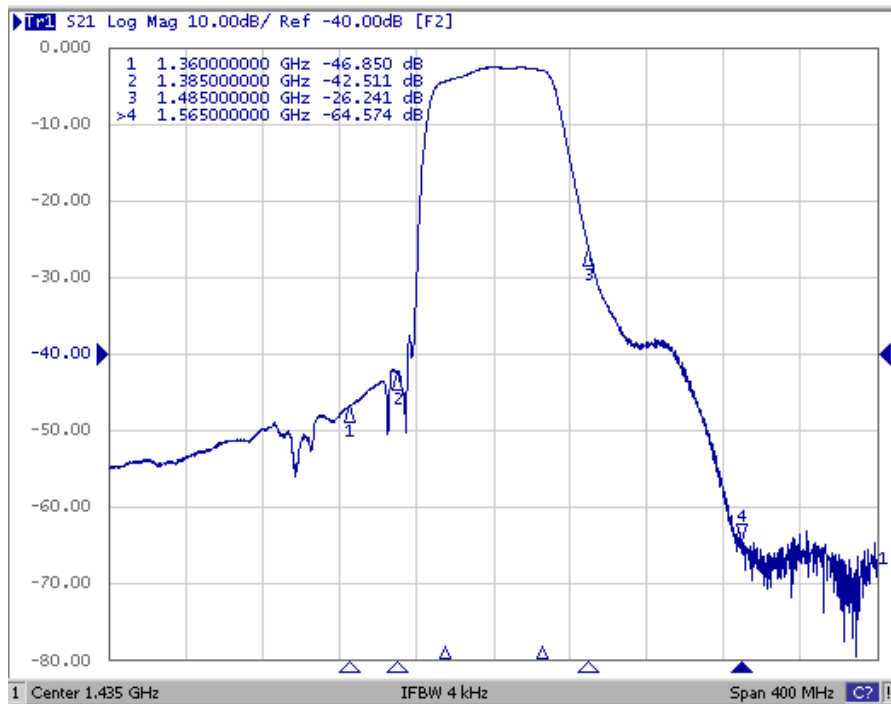

2. Pass band Response: (span 120MHz)

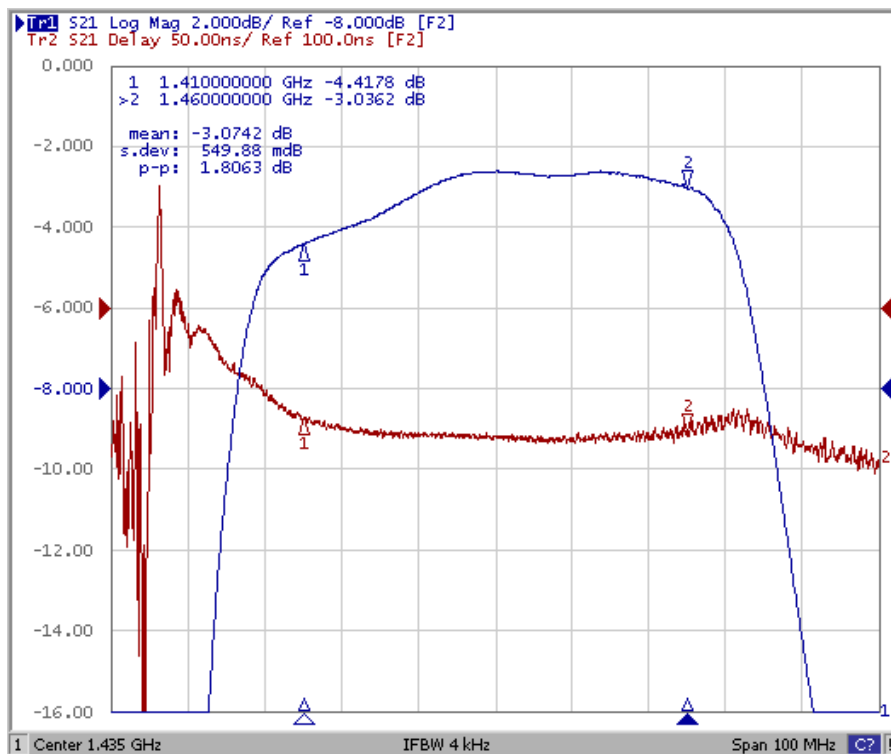

SAW Filter: 1435.0MHz
Part No: MP05309

Model: TA1654A
Rev No: 1

3. S11 & S22 VSWR Response: (span 100MHz)

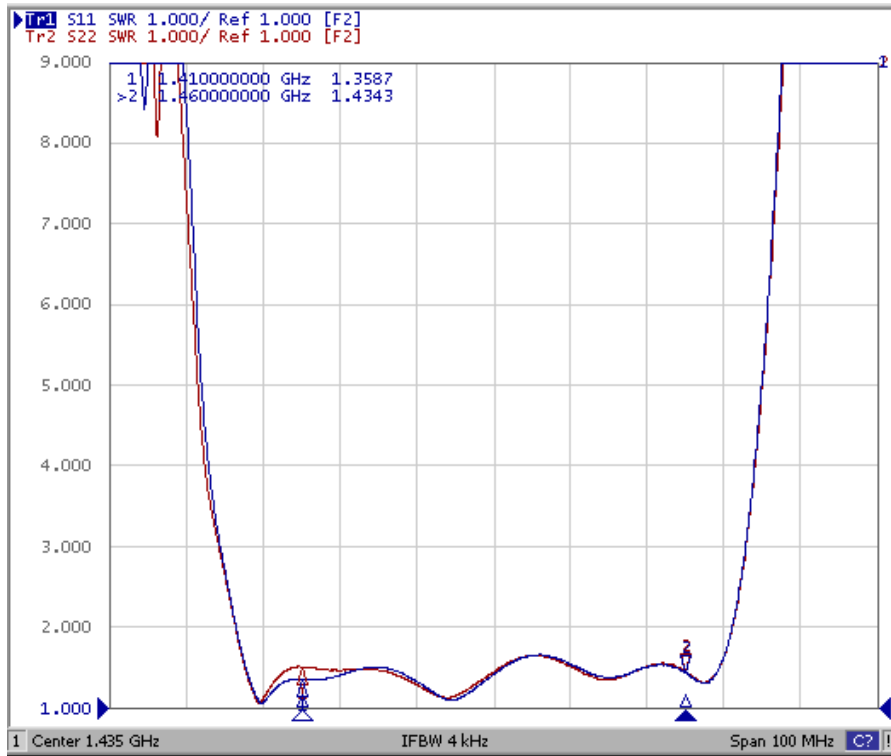

D. MEASUREMENT CIRCUIT:

TESTING ENVIRONMENT

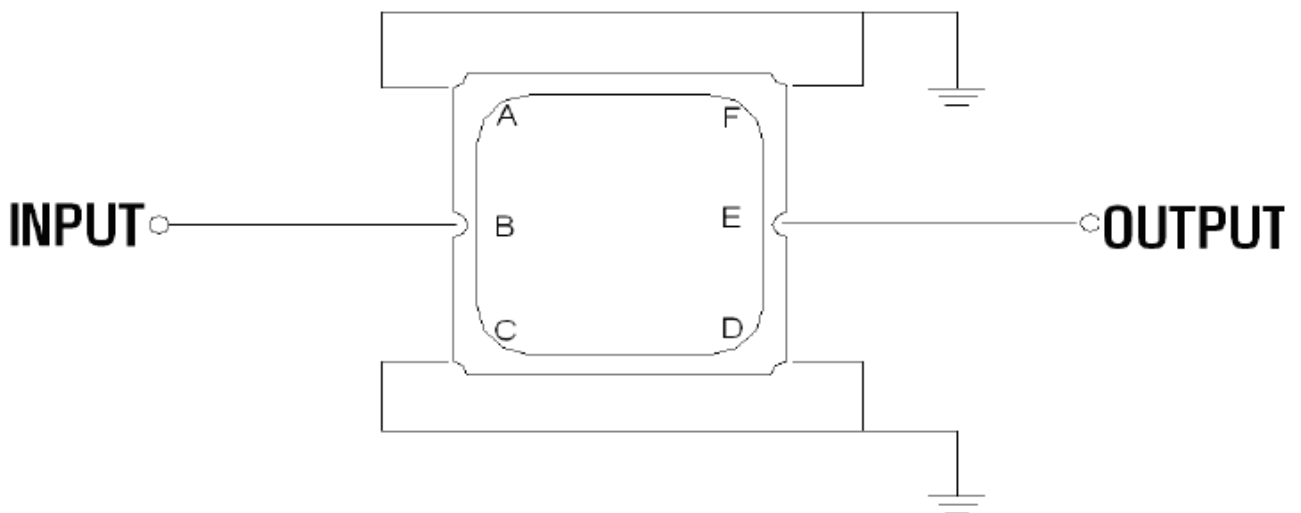

SAW Filter: 1435.0MHz
Part No: MP05309

Model: TA1654A
Rev No: 1

E. OUTLINE DRAWING:

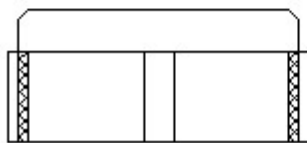
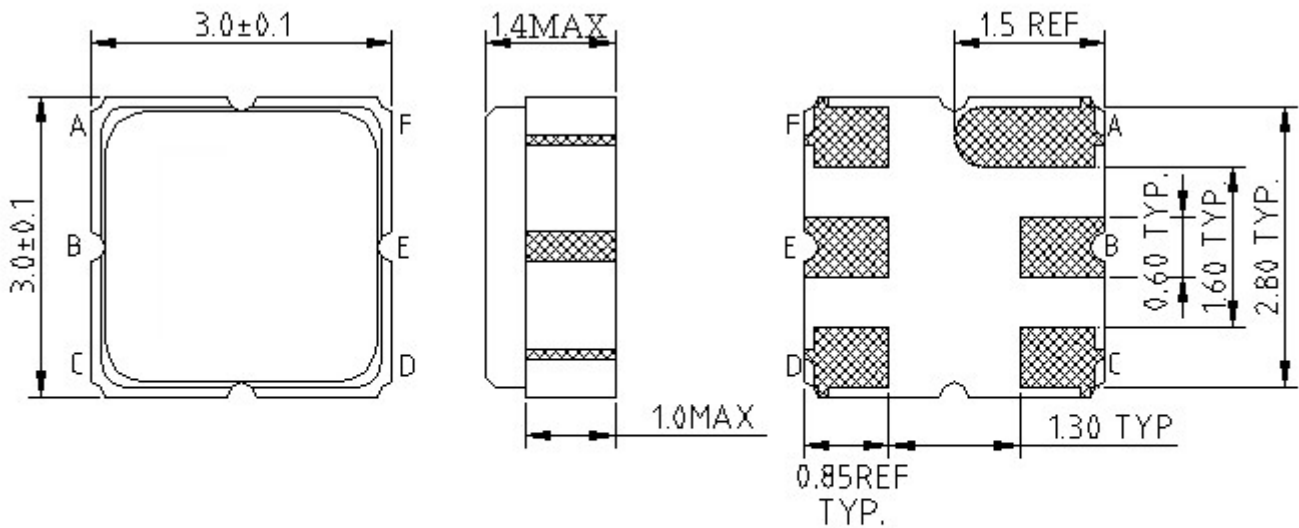

B: Input
 E: Output
 A, C, D, F: Ground
 Unit: mm

F. PCB FOOTPRINT:

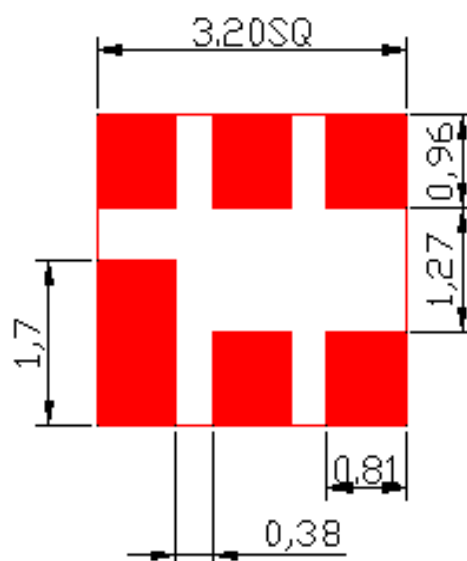

SAW Filter: 1435.0MHz
Part No: MP05309

Model: TA1654A
Rev No: 1

G. PACKING:

1. Reel Dimension

(Please refer to FR-75D10 for packing quantity)

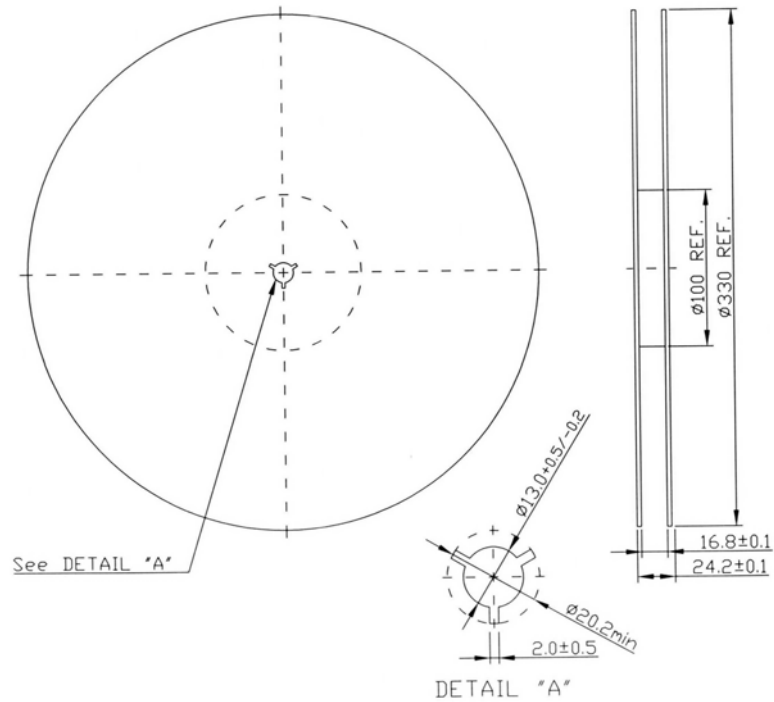

2. Tape Dimension

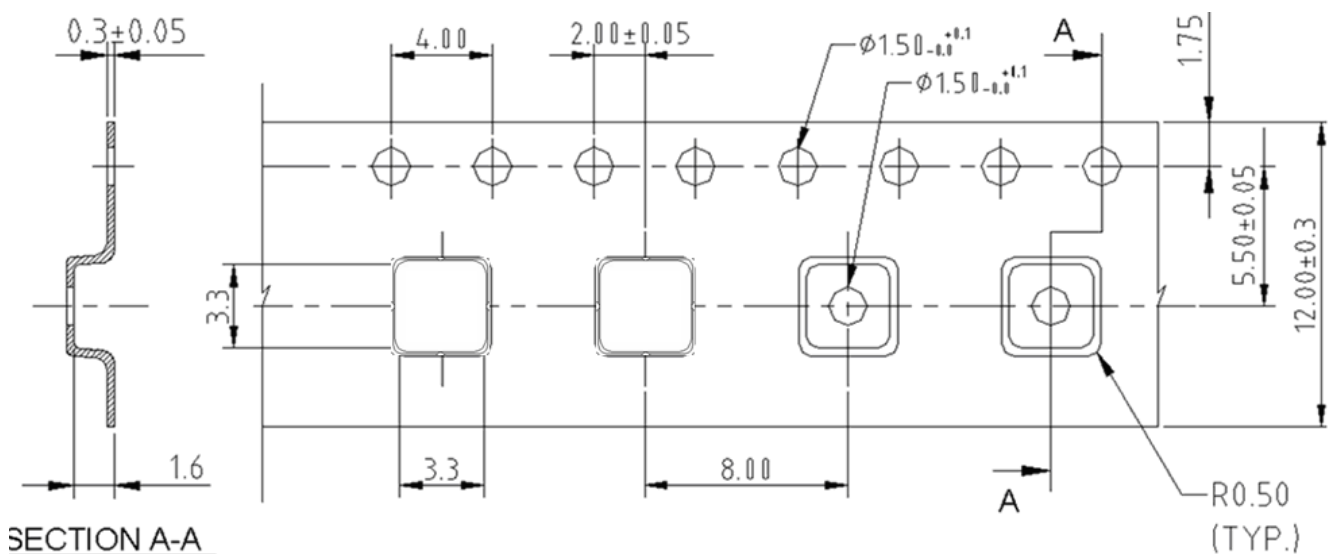

SAW Filter: 1435.0MHz
Part No: MP05309

Model: TA1654A
Rev No: 1

H. RECOMMENDED REFLOW PROFILE:

