

SF series

Washable miniature toggle switches •
insulated threaded bushing



DISTINCTIVE FEATURES

- Process sealed
- Front and rear sealing
- Optional ESD protection



ENVIRONMENTAL SPECIFICATIONS

- Operating temperature : -20 °C to +85 °C (-4 °F to +185 °F)
- Storage temperature : -40 °C to +85 °C (-40 °F to +185 °F)
- Moisture : The insulating materials employed and the complete seal permit the switches to withstand a 56 days moisture test (IEC 68-2-3).
- Solderability : The switches are tested at 235 °C (455 °F) according to IEC 68-2-20 after accelerated aging.



ELECTRICAL SPECIFICATIONS

- Max. current/voltage rating with resistive load :
 - silver contacts (A) : 4 A 30 VDC
 - gold plated brass contacts (CD) : 0.4 VA 20 VAC or DC
 - gold plated silver contacts (AD) : 4 A 30 VDC (300 mA 30 VDC for gold plating)
- Initial contact resistance : 10 mΩ max.
- Insulation resistance : 1,000 MΩ min.
- Dielectric strength : 1,000 Vrms 50 Hz min.
- Electrical life at full load :

Contacts	Number of cycles	
	2 positions	3 positions
A	40,000	40,000
CD	100,000	50,000
AD	40,000	40,000

The company reserves the right to change specifications without notice.



SF series

Washable miniature toggle switches • insulated threaded bushing



GENERAL SPECIFICATIONS

- Mechanical strength : Terminals are strengthened by a bracket or a ground plate ensuring the rigidity of the switch on the board. Actuator strength is 10 N max.
- Iron soldering : 300 °C (572 °F) 5 sec. max.
- Max. torque : 0.25 Nm (.184 Ft.lb)
- Max. panel thickness : 2.5 mm (.098) with 2 nuts, 4 mm (.157) with 1 nut



MATERIALS

- Case and cover : UL94-VO, polyamide, glass filled or PES
- Actuator : brass, nickel plated
- Contacts
CD : brass, gold plated
A : silver
AD : silver, gold plated
- Terminal seal : epoxy



TERMINALS

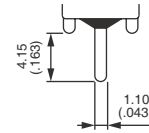

Straight PC

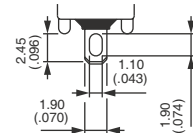

Solder lug / quickconnect



ELECTRICAL FUNCTIONS

→ KEYWAY



PANEL CUT-OUT

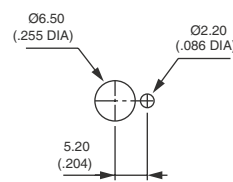

SF series

Washable miniature toggle switches •
insulated threaded bushing



BUILD YOUR PART NUMBER

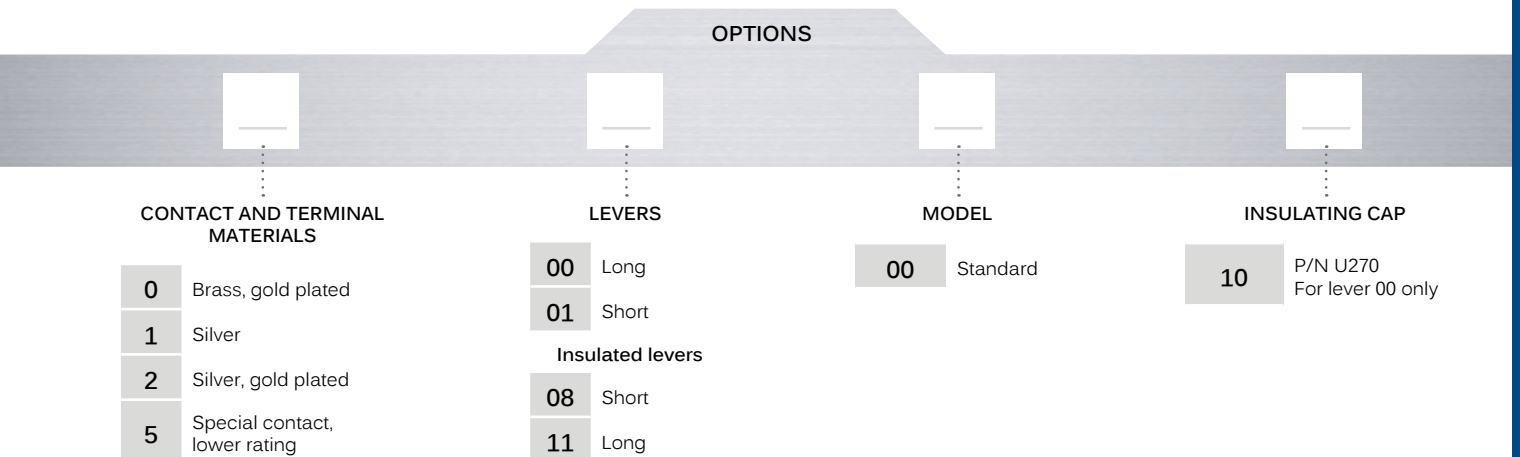
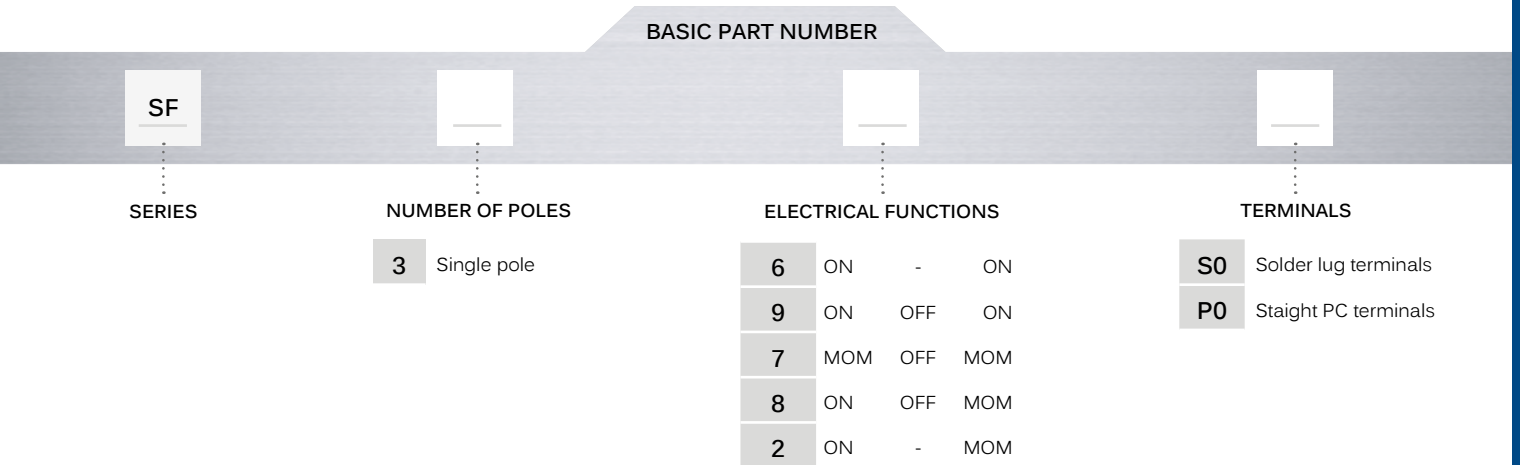

ABOUT THIS SERIES

On the following pages, you will find successively basic part numbers of switches and options in the same order as in above chart.

- ⚠ **Notice** : please note that not all combinations of above numbers are available. Refer to the following pages for further information.
- 🔧 **Mounting accessories** : 2 hex nuts 8 mm (.314) across flats, 1 locking ring and 1 lockwasher. Standard and special hardware available is presented in the "Accessories" section of website.

SF series

Washable miniature toggle switches • insulated threaded bushing

SOLDER LUGS TERMINALS



	III 2-3	II	I 1-2
SF36S0	ON	-	ON
SF39S0	ON	OFF	ON
SF37S0	MOM	OFF	MOM
SF38S0	ON	OFF	MOM
SF32S0	ON	-	MOM

Shown with standard lever 00

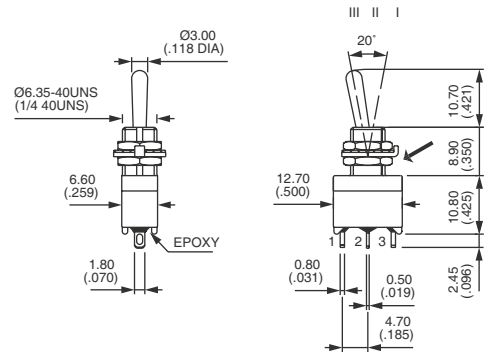

STRAIGHT PC TERMINALS



	III 2-3	II	I 1-2
SF36P0	ON	-	ON
SF39P0	ON	OFF	ON
SF37P0	MOM	OFF	MOM
SF38P0	ON	OFF	MOM
SF32P0	ON	-	MOM

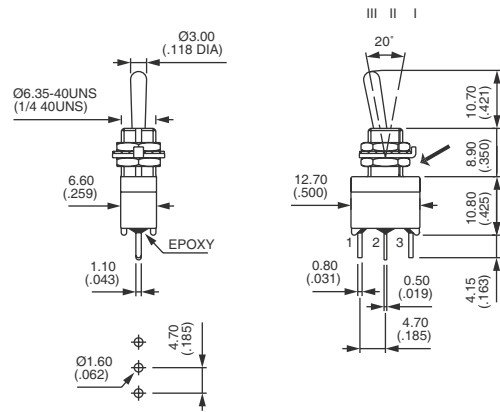

CONTACT & TERMINAL MATERIALS



- 0 Brass, gold plated (standard)
- 1 Silver
- 2 Silver, gold plated
- 5 Special contact, lower rating, minimum quantity : consult factory.

LEVERS

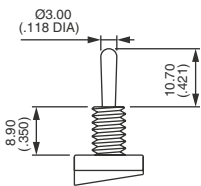
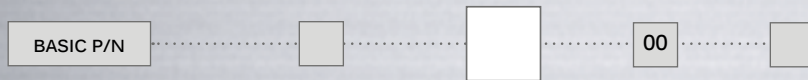

00
Standard

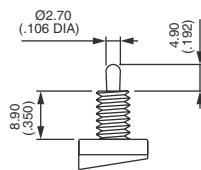

01
Short

INSULATED LEVERS

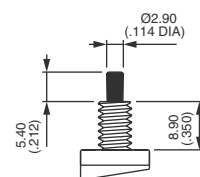

08
Short

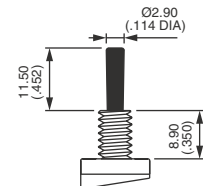

11
Long

Protected against electrostatic discharges (ESD) up to 12 KV. Black color.

SF series

Washable miniature toggle switches •
insulated threaded bushing

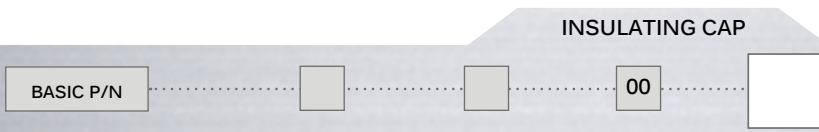

Blank Without caps
10 P/N U270 - For lever 00

For cap colors, replace "0" with number :

- 1 Blue
- 1/4 Dark blue
- 2 Black
- 3 Green
- 4 Grey
- 5 Yellow
- 6 Red
- 7/1 White
- 9 Orange

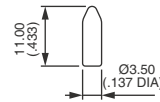

10

To order cap separately, use its part number (U270).