

PIN	1	2	3	4	5	6	7	8	9	10	11	12	13	14	15	16			
COM	COM	1E	1D	1C	DP1	2E	2D	2C	DP2	3E	3D	3C	DP3	4E	4D	4C			
PIN	17	18	19	20	21	22	23	24	25	26	27	28	29	30	31	32			
COM	DP4	5E	5D	5C	DP5	6E	6D	6C	6B	6A	6F	6G	5B	5A	5F	5G			
PIN	33	34	35	36	37	38	39	40	41	42	43	44	45	46	47	48	49	50	
COM	COL2	4B	4A	4F	4G	3B	3A	3F	3G	COL1	2B	2A	2F	2G	1B	1A	1F	1G	

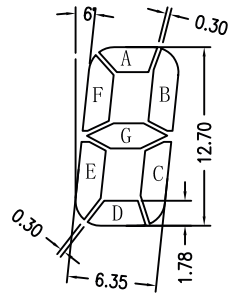
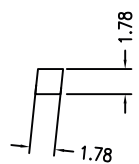

- NOTES:
1. DISPLAY TYPE: TN
  2. VIEWING DIRECTION: 6:00
  3. POLARIZER MODE: POSITIVE/REFLECTIVE
  4. DRIVER METHOD: STATIC
  5. OPERATING VOLTAGE: 5.0 V
  6. OPERATING TEMP: -20°C~80°C
  7. STORAGE TEMP: -30°C~80°C
  8. CONNECTOR: PIN