

PRODUCT NUMBER  
89009-XYX(L)LF

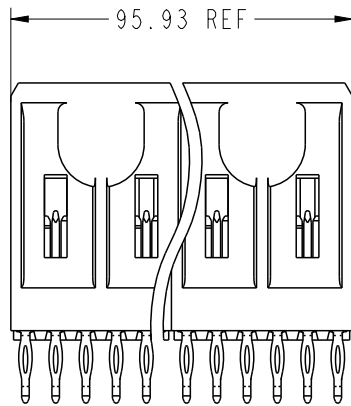
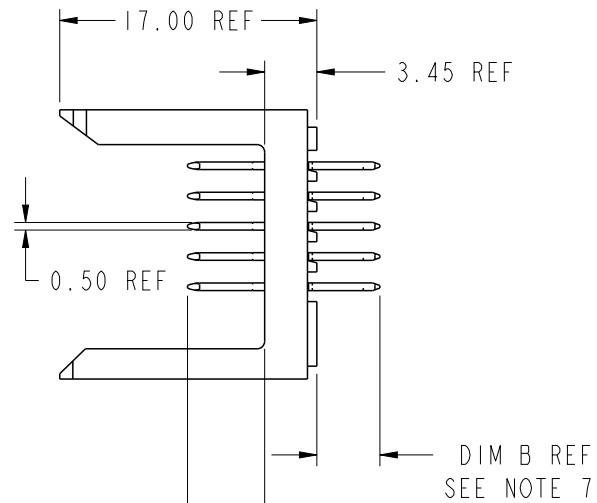
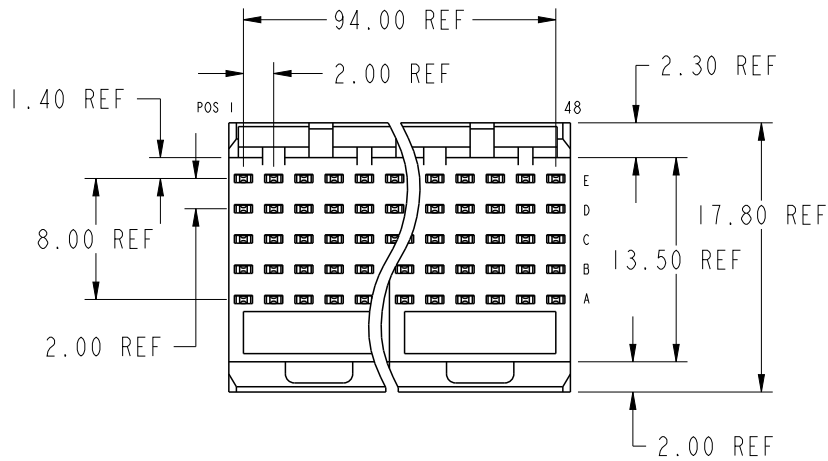

PART NUMBER : 89009-XYX(L)LF

L REFER LUBRICATED (OPTIONAL)  $\triangle$   
SEE NOTE 3

X REFER PLATING PERFORMANCE  $\triangle$   
SEE NOTE 3

spec ref	*	dr	Terran Huang	2010/07/09	projection 	MM $\longleftrightarrow$	size	A4	scale	1:10
tolerance std	TOLERANCES UNLESS OTHERWISE SPECIFIED	eng	Rahul Mohan-M	2021/07/21			ecn no	ELX-I-41741-1		
		chr	-	-				rel level	Released	
surface	3.200	appr	Kuriakose, San	2021/08/16	product family	METRAL	rel level	Released		
ASME Y14.5	linear	0.X	$\pm 0.3$	Amphenol FCI	title	METRAL SIGNAL HEADER	dwg no	89009	rev	W
		0.XX	$\pm 0.13$							
		0.XXX	$\pm 0.051$							
	angular	0°	$\pm 2^\circ$	amphenol-icc.com	cat. no.	-	Product - Customer Drw	sheet 1 of 25		

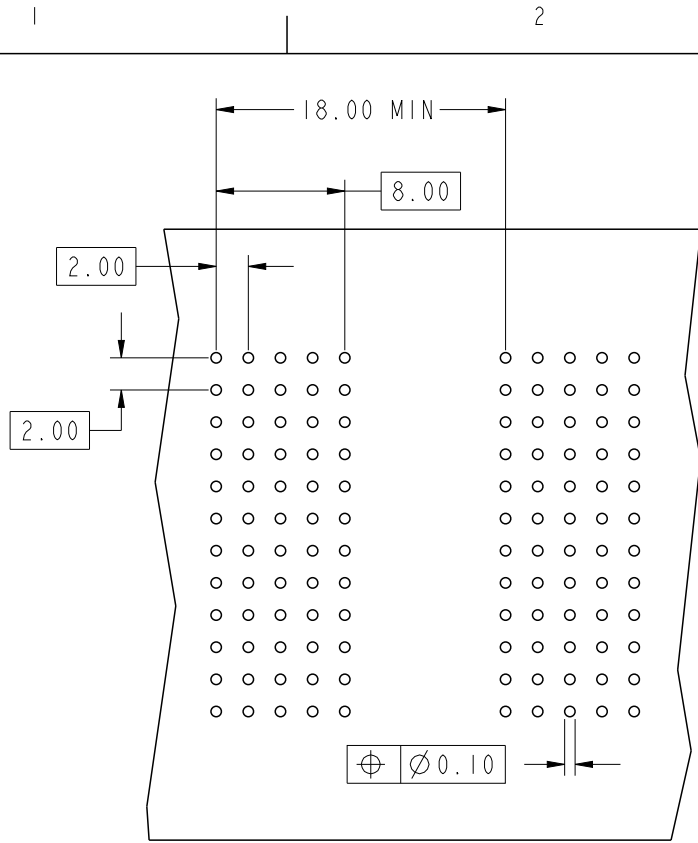

KEY		
CODE	DIMENSIONS	
	DIM "A" MATE	DIM "B" TAIL
1	5.00	4.30
2	5.75	4.30
3	6.50	4.30
4	7.25	4.30
5	5.00	13.60
6	5.75	13.60
7	6.50	13.60
8	7.25	13.60
9	5.00	17.00
10	5.75	17.00
11	6.50	17.00
12	7.25	17.00
13	8.25	4.30
14	8.25	13.60
15	8.25	17.00
16	7.00	4.30
17	7.00	13.60
18	7.00	17.00
19	8.00	4.30
20	8.00	13.60
21	8.00	17.00

REQUIRED PC BOARD LAYOUT  
COMPONENT SIDE  
SEE PRINT 58351 FOR  
ADDITIONAL PCB INFORMATION

spec ref	*	dr	Terran Huang	2010/07/09	projection 	MM 	size	A4	scale	21:10
tolerance std	TOLERANCES UNLESS OTHERWISE SPECIFIED	eng	Rahul Mohan-M	2021/07/21			ecn no	ELX-I-41741-1		
		chr	-	-						
surface	ASME Y14.5	appr	Kuriakose, San	2021/08/16	product family	METRAL	rel level	Released		
linear	0.X	±0.3	Amphenol FCi	title	METRAL SIGNAL HEADER	dwg no	89009	rev	W	
	0.XX	±0.13								
	0.XXX	±0.051								
angular	0°	±2°	amphenol-icc.com	cat. no.	*	Product - Customer Drw	sheet 2 of 25			

Creo F114-ELX-NC-AAC\_REV F\_2020-12-21



















































PRODUCT NUMBER  
SEE SHEET 1

NOTES:

1. FOR DIM A AND B SEE SHEET 2 AND UP.
2. MATERIAL : BODY : THERMOPLASTIC UL94-V0.  
: CONTACT : COPPER ALLOY.
3. FOR PLATING PERFORMANCE REFER DRAWING # 10159408.
4. ALL PRODUCTS WITH PART NUMBERS SHOWN IN SUBSEQUENT TABLES WILL BE PACKAGED IN TUBES.  
IF TRAY PACKAGING IS REQUIRED, A SUFFIX "P" WILL BE ADDED TO THE END OF THE PART NUMBER.  
EXAMPLE: XXXXX-XXXPLF
5. PRODUCT SPECIFICATION GS-12-180
6. APPLICATION SPECIFICATION BUS-20-073
7. AFTER INSERTION INTO CIRCUIT BOARD WITH QUALIFIED TOOL.
8. THE PRODUCTS MEET THE EUROPEAN UNION DIRECTIVES AND OTHER COUNTRY REGULATIONS  
AS DESCRIBED IN GS-47-0004.
9. ALL PRODUCTS WILL WITHSTAND EXPOSURE TO 260°C FOR 60 SECONDS IN A CONVECTION, INFRA-RED OR  
VAPOR PHASE REFLOW OVEN. THE Au CONTACT SURFACE OF THE CONTACTS SHALL BE EXPOSED TO A MAXIMIM 140°C FOR  
NO LONGER THAN 15 SECONDS IN A WAVE SOLDER APPLICATION.
10. A  $\triangle$  SYMBOL WILL BE NEXT TO ANY DIMENSION, VIEW, OR NOTE WHICH HAS BEEN MODIFIED WITH THE  
CURRENT DRAWING REVISION.

spec ref *		dr <b>Terran Huang</b>		2010/07/09	projection 	MM 	size A4	scale 11:10
tolerance std		eng <b>Rahul Mohan-M</b>		2021/07/21			ecn no <b>ELX-I-41741-1</b>	
TOLERANCES UNLESS OTHERWISE SPECIFIED		chr -		-			rel level <b>Released</b>	
surface		appr <b>Kuriakose, San</b>		2021/08/16	product family METRAL	rel level	rev	
ASME Y14.5 ✓	linear	0.X	±0.3	<b>Amphenol FCi</b>	title METRAL SIGNAL HEADER		dwg no 89009	rev <b>W</b>
		0.XX	±0.13		8 MOD, 5 ROW PRESS-FIT			
		0.XXX	±0.051		cat. no. *			
angular	0°	±2°	amphenol-icc.com	Product - Customer Drw			sheet 25 of 25	