

## SURFACE MOUNT BATTERY CLIPS/CONTACTS

AVAILABLE ON TAPE AND REEL

- "Flow-Hole" SMT solder tail design for increased joint strength
- Tin-Nickel plating is ideal for lead free, high temperature soldering
- Matte Tin Plate for lower soldering temperatures ideal where other temperature sensitive components are being used



Refer to page 34 for Battery Contact Layout & Mounting Details

"AAAA" - "A27"

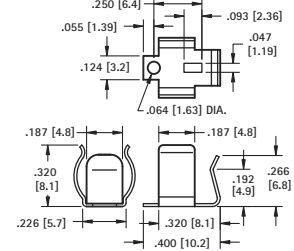

**MATERIAL:** .010 (.25) Spring Steel

TIN-NICKEL PLATE		MATTE TIN PLATE	
CAT. NO.	ON TAPE & REEL	CAT. NO.	ON TAPE & REEL
<b>50</b>	<b>50TR</b>	<b>550</b>	<b>550TR</b>

**Tape & Reel Spec's:** 24mm wide; 16mm pitch; 13 inch reel, (500 pieces per reel)

Pad Layout

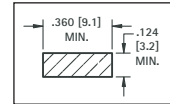

"AAA" - "N" - "A23"

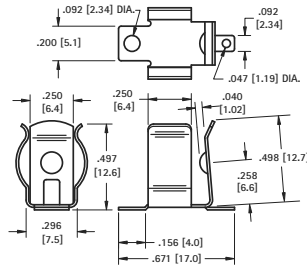

**MATERIAL:** .010 (.25) Spring Steel

TIN-NICKEL PLATE		MATTE TIN PLATE	
CAT. NO.	ON TAPE & REEL	CAT. NO.	ON TAPE & REEL
<b>55</b>	<b>55TR</b>	<b>555</b>	<b>555TR</b>

**Tape & Reel Spec's:** 32mm wide; 16mm pitch; 13 inch reel, (300 pieces per reel)

Pad Layout

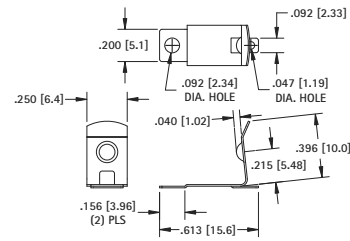
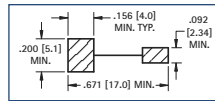

**MATERIAL:** .010 (.25) Spring Steel

TIN-NICKEL PLATE		MATTE TIN PLATE	
CAT. NO.	ON TAPE & REEL	CAT. NO.	ON TAPE & REEL
<b>56</b>	<b>56TR</b>	<b>556</b>	<b>556TR</b>

**Tape & Reel Spec's:** 32mm wide; 20mm pitch; 13 inch reel, (250 pieces per reel)

Pad Layout

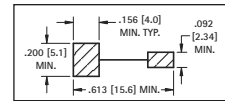

"AA" - "CR2" - "A"

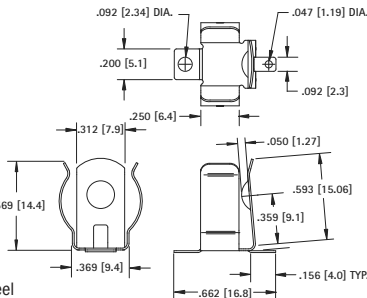

**MATERIAL:** .012 (.30) Spring Steel

TIN-NICKEL PLATE		MATTE TIN PLATE	
CAT. NO.	ON TAPE & REEL	CAT. NO.	ON TAPE & REEL
<b>53</b>	<b>53TR</b>	<b>553</b>	<b>553TR</b>

**Tape & Reel Spec's:** 32mm wide; 24mm pitch; 13 inch reel, (150 pieces per reel)

Pad Layout

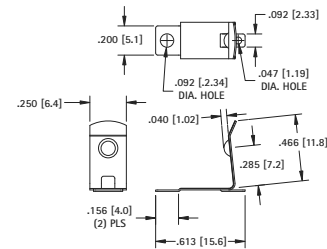
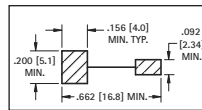

**MATERIAL:** .010 (.25) Spring Steel

TIN-NICKEL PLATE		MATTE TIN PLATE	
CAT. NO.	ON TAPE & REEL	CAT. NO.	ON TAPE & REEL
<b>57</b>	<b>57TR</b>	<b>557</b>	<b>557TR</b>

**Tape & Reel Spec's:** 32mm wide; 20mm pitch; 13 inch reel, (250 pieces per reel)

Pad Layout

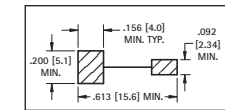

## SURFACE MOUNT LEAF-SPRING CONTACTS

AVAILABLE ON TAPE AND REEL

- Economical & reliable contacts are ideal for surface mount applications
- Unique spring tension contacts adjust to variations in battery length
- Reliable spring tension contacts assure low contact resistance
- SMT solder tail with "flow-hole" design for increased joint strength

"AAA" - "AAAA" - "A23" - "N"

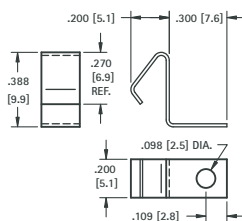

**MATERIAL:** .010 (.25) Spring Steel

TIN-NICKEL PLATE		MATTE TIN PLATE	
CAT. NO.	ON TAPE & REEL	CAT. NO.	ON TAPE & REEL
<b>5230</b>	<b>5230TR</b>	<b>5330</b>	<b>5330TR</b>

**Tape and Reel Spec's:** 24mm wide; 12mm pitch; 13 inch reel (400 pieces per reel)

"AA" - "CR2" - "A" - "9V"

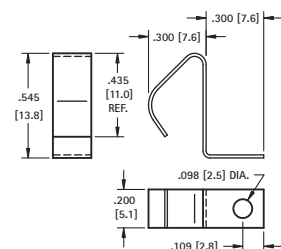

**MATERIAL:** .010 (.25) Spring Steel

TIN-NICKEL PLATE		MATTE TIN PLATE	
CAT. NO.	ON TAPE & REEL	CAT. NO.	ON TAPE & REEL
<b>5231</b>	<b>5231TR</b>	<b>5331</b>	<b>5331TR</b>

**Tape and Reel Spec's:** 32mm wide; 16mm pitch; 13 inch reel (250 pieces per reel)